

FUJI EnviroMAX[®]



POWER FOR LIFE. RESPECT FOR NATURE.



FUJI
EnviroMAX



**MAXIMUM POWER.
MINIMUM IMPACT.**

SUPER ALKALINE



DIGITAL ALKALINE



EXTRA HEAVY DUTY



Ni-MH RECHARGEABLE





MARKET FACTS:

- The market for traditional batteries is approaching \$14 billion at retail.
- 89% of this multi-billion dollar industry is made up of alkaline battery sales.
- Rechargeable battery sales have been growing consistently.
- Eco-Retailing is a \$230 billion industry which will grow another \$87 billion in the next 12 months.
- Six out of ten consumers say they are more likely to purchase "green" products this year.
- 40% of Americans would rather buy environmentally friendly products.



THE FUJI ENVIROMAX DIFFERENCE

Fuji EnviroMAX batteries are designed for the environment.

THE FUJI ENVIROMAX BRAND HAS POWER

FUJI ENVIROMAX VS COMPETITORS

Fuji EnviroMAX packaging has excellent contrast against its competitors:

- Highest attention-grabbing value
- Best overall design value
- Attractive colors
- Relevant package info

Consumer "Hot Buttons"

- "MAXIMUM Power, Minimum Impact"
- "Big world" thematic
- Bold color palette
- Mercury and Cadmium free

ENVIRONMENTAL

- Mercury and Cadmium free
- Packaged with over 75% recycled materials
- PET Plastic is used for the packaging and battery jacket
- Manufacturing does not release any ozone-depleting compounds
- Disposable in most landfills*

PERFORMANCE

- One of the longest shelf lives in the industry
- One of the longest-lasting alkaline batteries available (independent lab tested)
- Priced competitively with the market leaders
- Power meets or exceeds the competition
- Designed for digital devices
- One of the strongest anti-leak protection technologies in the industry.

*Please follow your state and local regulations regarding the proper disposal of all batteries.



THE 3Rs

REDUCE, REUSE, RECYCLE

Fuji Batteries, Inc., is working to conserve energy and natural resources by following the practices of the 3R approach: Reduce, Reuse, Recycle.

CO₂ Emissions

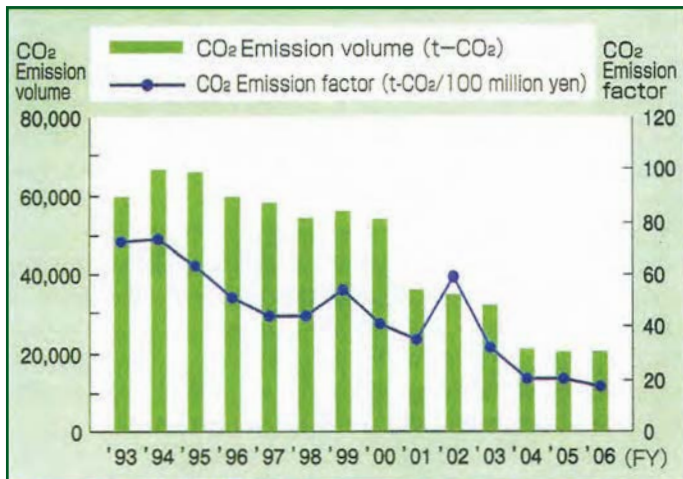

Wastes & Recycling Ratio

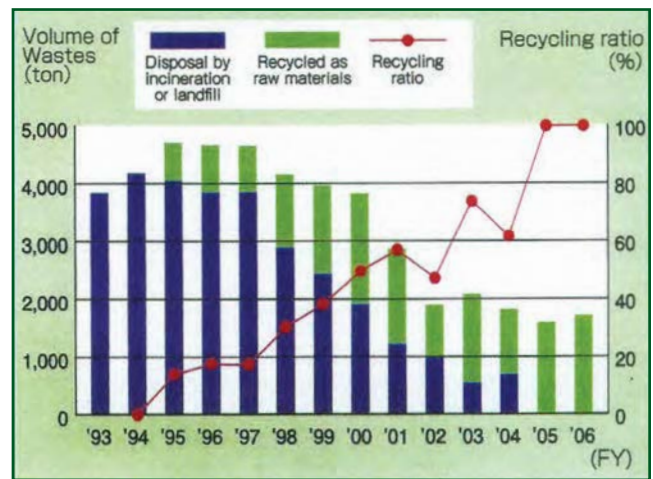

INCREASE PRODUCTIVITY – REDUCE WASTE

Fuji EnviroMAX batteries are manufactured under an ISO 14001 certified management system that is respectful of the environment.

- Most of the resources utilized in the manufacturing process are reused and recycled.
- Fuji Batteries, Inc., has reduced VOC emissions by 30%.
- Substances totally abolished in the manufacturing of all Fuji EnviroMAX products: Mercury, Cadmium, and Lead.

FUJI
Enviro**MAX**®

MEDIA CAMPAIGN

Gain national exposure to build product recognition and sales momentum:

- Magazine Ads
- TV Spots
- Web Advertising
- TV Network Sponsorship
- News Media Exposure
- Corporate Endorsements/Affiliations
- Media Product Placement

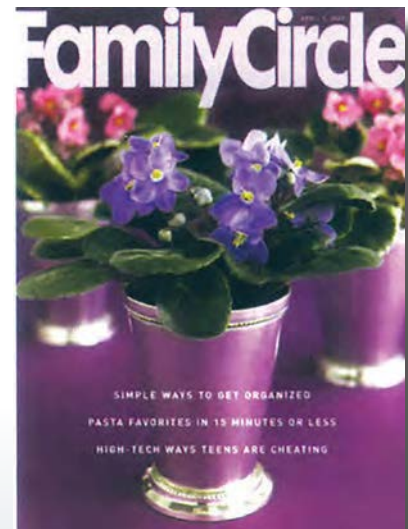

FUJI **EnviroMAX**® SUPER ALKALINE





Product Code	Type	Size	Voltage (V)	Dimensions (Max) (Inch)		Packaging	Packing					Product UPC	Inner Case UPC	Case UPC
				Height	Diameter		Inner Box (Packs)	Master Case (Packs)	Weight (lbs.)	Dimensions (Max) (Inch) W x H x D	Cu. Ft. (cft)			
4100	LR20/AM1	D	1.5	61.5	34.2	2 pcs. in a Blister	12	48	31.5	8.1 x 9.8 x 13.1	0.598	791058410025	60791058410027	70791058410024
						4 pcs. in a Clamshell	12	24	33.1	17.8 x 13.0 x 7.9	0.937	791058410049	60791058410041	70791058410048
						12 pcs. in a Box	1	6	30.9	11.4 x 3.9 x 12.8	0.329	791058410018	60791058410010	70791058410017
4200	LR14/AM2	C	1.5	50	26.2	2 pcs. in a Blister	12	48	16.5	8.1 x 6.8 x 12.0	0.379	791058420024	60791058420026	70791058420023
						4 pcs. in a Clamshell	12	24	17.6	15.9 x 11.8 x 5.8	0.63	791058420048	60791058420040	70791058420047
						12 pcs. in a Box	1	12	15.4	9.1 x 10.3 x 5.5	0.298	791058420017	60791058420019	70791058420016
4300	LR6/AM3	AA	1.5	50.5	14.5	2 pcs. in a Blister	12	48	5.3	11.5 x 8.6 x 4.8	0.275	791058430023	60791058430025	70791058430022
						4 pcs. in a Blister	12	48	10.8	11.5 x 8.6 x 4.8	0.275	791058430047	60791058430049	70791058430046
						8 pcs. in a Blister	12	48	21.1	15.8 x 7.9 x 6.5	0.468	791058430085	60791058430087	70791058430084
						10 pcs. in a Blister	12	48	27	15.8 x 7.9 x 6.5	0.468	791058430054	60791058430056	70791058430053
						12 pcs. in a Blister	12	48	33.9	26.0 x 6.4 x 8.8	0.848	791058430016	60791058430018	70791058430015
						15 pcs. in a Blister	8	32	31.1	11.2 x 18.2 x 12.9	1.52	791058430061	60791058430063	70791058430060
						24 pcs. in a Blister	6	24	30.2	12.9 x 9.9 x 10.1	0.744	791058430030	60791058430032	70791058430039
						48 pcs. in a Box	1	12	31.7	15.9 x 15.5 x 2.5	0.352	791058430009	60791058430001	70791058430008
4400	LR03/AM4	AAA	1.5	44.5	10.5	2 pcs. in a Blister	12	48	3.3	10.9 x 6.5 x 4.7	0.193	791058440022	60791058440024	70791058440021
						4 pcs. in a Blister	12	48	5.5	10.9 x 6.5 x 4.7	0.193	791058440046	60791058440048	70791058440045
						8 pcs. in a Blister	12	48	11	15.8 x 6.1 x 6.3	0.353	791058440084	60791058440086	70791058440083
						10 pcs. in a Blister	12	48	13.75	15.8 x 6.1 x 6.3	0.353	791058440053	60791058440055	70791058440052
						12 pcs. in a Blister	12	48	15.9	11.8 x 10.7 x 4.6	0.334	791058440015	60791058440017	70791058440014
						15 pcs. in a Blister	8	32	17.9	9.7 x 17.8 x 12.9	1.248	791058440060	60791058440062	70791058440069
						24 pcs. in a Blister	6	24	18.1	12.0 x 8.7 x 8.8	0.527	791058440039	60791058440031	70791058440038
						48 pcs. in a Box	1	12	17.5	12.0 x 11.3 x 2.0	0.156	791058440008	60791058440000	70791058440007
4500	LR1/AM5	N	1.5	30.2	12	1	48	22	7.2 X 9.6 X 4.7	0.367	791058201098	60791058201090	70791058201097	
4600	6LF22	9V	9	48.5	(L) 26.5 x (W) 17.5	1 pc. in a Blister	12	48	6.6	11.4 x 4.7 x 10.4	0.326	791058460013	60791058460015	70791058460012
						2 pcs. in a Blister	12	48	13.2	11.4 x 4.7 x 10.4	0.326	791058460020	60791058460022	70791058460029
						6 pcs. in a Box	12	48	30.9	12.2 x 10.1 x 5.4	0.385	791058460068	60791058460060	70791058460067

FUJI **EnviroMAX**® DIGITAL ALKALINE



Product Code	Type	Size	Voltage (V)	Dimensions (Max) (Inch)		Packaging	Packing					Product UPC	Inner Case UPC	Case UPC
				Height	Diameter		Inner Box (Packs)	Master Case (Packs)	Weight (lbs.)	Dimensions (Max) (Inch) W x H x D	Cu. Ft. (cft)			
8100	LR20/AM1	D	1.5	61.5	34.2	2 pcs. in a Blister	12	48	31.5	8.1 x 9.8 x 13.1	0.598	791058810023	60791058810025	70791058810022
8200	LR14/AM2	C	1.5	50.0	26.2	2 pcs. in a Blister	12	48	16.5	8.1 x 6.8 x 12.0	0.379	791058820022	60791058820024	70791058820021
8300	LR6/AM3	AA	1.5	50.5	14.5	4 pcs. in a Blister	12	48	5.3	11.5 x 8.6 x 4.8	0.275	791058830045	60791058830047	70791058830044
						10 pcs. in a Blister	12	48	27	15.8 x 7.9 x 6.5	0.468	791058830052	60791058830054	70791058830051
8400	LR03/AM4	AAA	1.5	44.5	10.5	4 pcs. in a Blister	12	48	3.3	10.9 x 6.5 x 4.7	0.193	791058840044	60791058840046	70791058840043
						10 pcs. in a Blister	12	48	13.75	15.8 x 6.1 x 6.3	0.353	791058840051	60791058840053	70791058840050
8600	6LF22	9V	9.0	48.5	(L) 26.5 x (W) 17.5	1 pc. in a Blister	12	48	6.6	11.4 x 4.7 x 10.4	0.326	791058860011	60791058860013	70791058860010

FUJI EnviroMAX®

Extra Heavy Duty



Product Code	Type	Size	Voltage (V)	Dimensions (Max) (Inch)		Packaging	Packing					Product UPC	Inner Case UPC	Case UPC
				Height	Diameter		Inner Box (Packs)	Master Case (Packs)	Weight (lbs.)	Dimensions (Max) (Inch) W x H x D	Cu. Ft. (cft)			
3300BP4	Super Heavy Duty	AA-4	1.5	1.98	0.57	4 pcs in Blister	12	48	9.50 kg / 20.9 lbs	11 x 8 x 5	0.3	791058330040	60791058330042	70791058330049
3400BP4	Super Heavy Duty	AAA-4	1.5	1.75	0.413	4 pcs in Blister	12	48	5.10 kg / 11.2 lbs	10.40 x 8 x 4	0.2	791058340049	60791058340041	70791058340048
3200BP2	Super Heavy Duty	C-2	1.5	1.97	1.032	2 pcs in Blister	12	48	4.00 kg / 8.8lbs.	11.7 x 8 x 7.6	0.4	791058320027	60791058320029	70791058320026
3100BP2	Super Heavy Duty	D-2	1.5	2.42	1.347	2 pcs in Blister	12	48	2.35 kg / 5.21lbs	13.4 x 8.3 x 9.4	0.6	791058310028	60791058310020	70791058310027
3600BP1	Super Heavy Duty	9V-1	9	1.91	1.044L x .689W	1 pc in Blister	12	48	2.00 kg / 4.4 lbs	10.9 x 8 x 5.6	0.3	791058360016	60791058360018	70791058360015
6V1	Super Heavy Duty	6V1	6	4.37	2.6	1 Pc	0	48	14. kg / 30.80	17.2 x 11.7 x 5.2	0.6	791058201159	60791058201151	70791058201158

FUJI EnviroMAX®

Zinc-air Hearing Aid



Product Code	Size	Nominal Capacity	Voltage (V)	Packaging	Packing					Service Life (Continuous Discharge)	Product UPC	Inner Case UPC	Case UPC	
					Inner Box (Packs)	Master Case (Packs)	Weight (lbs.)	Dimensions (Max) (Inch) W x H x D	Cu. Ft. (cft)					
4700BP8	A13	255 mAh	1.05	8 per Blister	100	300	13.1	10 x 6 x 10.5	0.364	1.5KΩ 25°C 60%RH	260 hrs. or longer	791058470081	60791058470083	70791058470080
4800BP8	A312	255 mAh	1.05	8 per Blister	100	300	8.05	8.5 x 6 x 8.5	0.25	1.5KΩ 25°C 60%RH	170 hrs. or longer	791058480080	60791058480082	70791058480089
4900BP8	A10	90 mAh	1.05	8 per Blister	100	300	9.75	8 x 6 x 8.5	0.236	3KΩ 25°C 60%RH	180 hrs. or longer	791058490089	60791058490081	70791058490088



FUJI EnviroMAX[®] Ni-MH Rechargeable



V89E Charger

Product Code	Type	Size	Voltage (V)	mAh	Packaging	Packing				Product UPC	Inner Case UPC	Case UPC	
						Inner Box (Packs)	Master Case (Packs)	Weight (lbs.)	Dimensions (Max) (Inch) W x H x D				Cu. Ft. (cft)
9100	NI-MH	D	1.2	8000mAh/2	2 pcs. in a Blister	12	48	14.15	8.1 x 9.8 x 13.1	0.598	791058201111	60791058201113	70791058201110
9200	NI-MH	C	1.2	4000mAh/2	2 pcs. in a Blister	12	48	10.60	8.1 x 6.8 x 12.0	0.379	791058021128	60791058021120	70791058021127
9300	NI-MH	AA	1.2	2300mAh/2	2 pcs. in a Blister	12	48	6.85	11.5 x 8.6 x 4.8	0.275	791058930028	60791058930020	70791058930027
					4 pcs. in a Blister	12	48	12.70	11.5 x 8.6 x 4.8	0.275	791058930042	60791058930044	70791058930041
9400	NI-MH	AAA	1.2	1000mAh/2	2 pcs. in a Blister	12	48	2.60	10.9 x 6.5 x 4.7	0.193	791058940027	60791058940029	70791058940026
					4 pcs. in a Blister	12	48	6.30	10.9 x 6.5 x 4.7	0.193	791058940041	60791058940043	70791058940040
9500	NI-MH	9V	9V	2200mAh	1 pc. in a Blister	12	48	13.5	11.4 x 4.7 x 10.4	0.326	791058201135	60791058201137	70791058201134
Chargers			Charge Time										
V89E	Overnight	AA/AAA	Overnight		1 pc in clamshell	20	20	8.81	12 x 10.9 x 9.1	6.9	791058940447	60791058940449	70791058940446
KCR-6688BP4	1 Hour		1 Hour with 4AA		1 pc in clamshell	6	24	18.04	18.43 x 12.6 x 12.9	1.73	791058930011	60791058930013	70791058930010
KCR-6611BP4	30 Min		30 Min with 2AA & 2AAA		1 pc in clamshell	6	24	20.79	24.3 x 13.4 x 12.9	2.44	791058940430	60791058940432	70791058940439

DISPLAYS



PDQ Display – AA and AAA



FD-3



FD-8



Side Panel



FD-12



FD-14



FD-24

Item	Dimensions (Max) (Inch)			Assortment	Weight (lbs.)	Cu. Ft.	Product UPC
	Width	Height	Diameter				
PDQ-24AA	6.34	9.34	15.61	24 packs AA24	30.2	0.54	7079105800010
PDQ-24AAA	5.87	7.7	11.82	24 packs AAA24	18.1	0.31	70791058000249
FD-3 WIRE COUNTER DISPLAY	20	16	14	AA-4 x 24; AAA-4 x 12; C-2 x 12; D-2 x 12; 9V-1 x 12	23	2.593	70791058000034
FD-8 CLIP STRIP	24	14 1/2	6	AA-4 x 48; AAA-4 x 24; C-2 x 24; D-2 x 24; 9V-1 x 24	42	1.208	70791058000089
SIDE PANEL	16 1/2	34 1/2	7 1/2	AA-4 x 60; AAA-4 x 24; C-2 x 24; D-2 x 12; 9V-1 x 12	33	2.457	70791058000041
FD-12 PRE-PACKED	17	35	7	AA-4 x 60; AAA-4 x 36; C-2 x 12; D-2 x 18; 9V-1 x 18	47	2.39	70791058000126
FD-24 PRE-PACKED	30	14 1/2	8	AA-24 x 28; AAA-24 x 12	50	2.102	70791058000119
FD-14 PRE-PACKED	21	55	5	2 Sided (Total 144 pcks) AA60, AAA36, C12, D18, 9V18	48	2.4	70791058000133
PDQ4100BP2	12	10.7	6.02	D-2 x 3 in a PDQ tray x 6	12.34	0.446	N/A
PDQ4200BP2	12	10.7	6.02	C-2 x 4 in a PDQ tray x 6	8.81	0.446	N/A
PDQ4300BP4	12	10.7	6.02	AA-4 x 7 in a PDQ tray x 6	11.02	0.446	N/A
PDQ4400BP4	12	10.7	6.02	AAA-4 x 9 in a PDQ tray x 6	6.61	0.446	N/A
PDQ4600BP1	12	10.7	6.02	9V-1 x 6 in a PDQ tray x 6	4.96	0.446	N/A

ALKALINE BATTERY

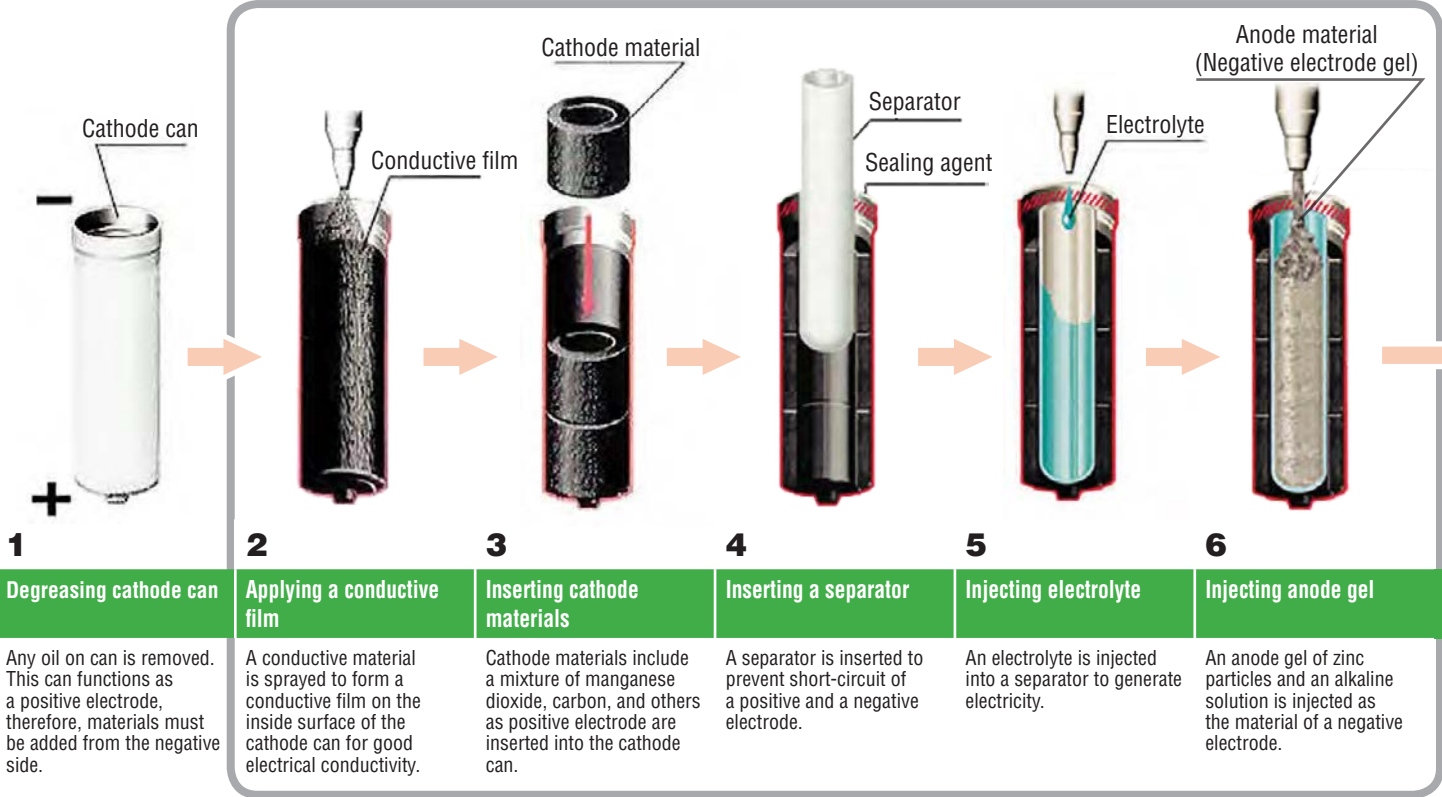

Extra Heavy Duty Battery

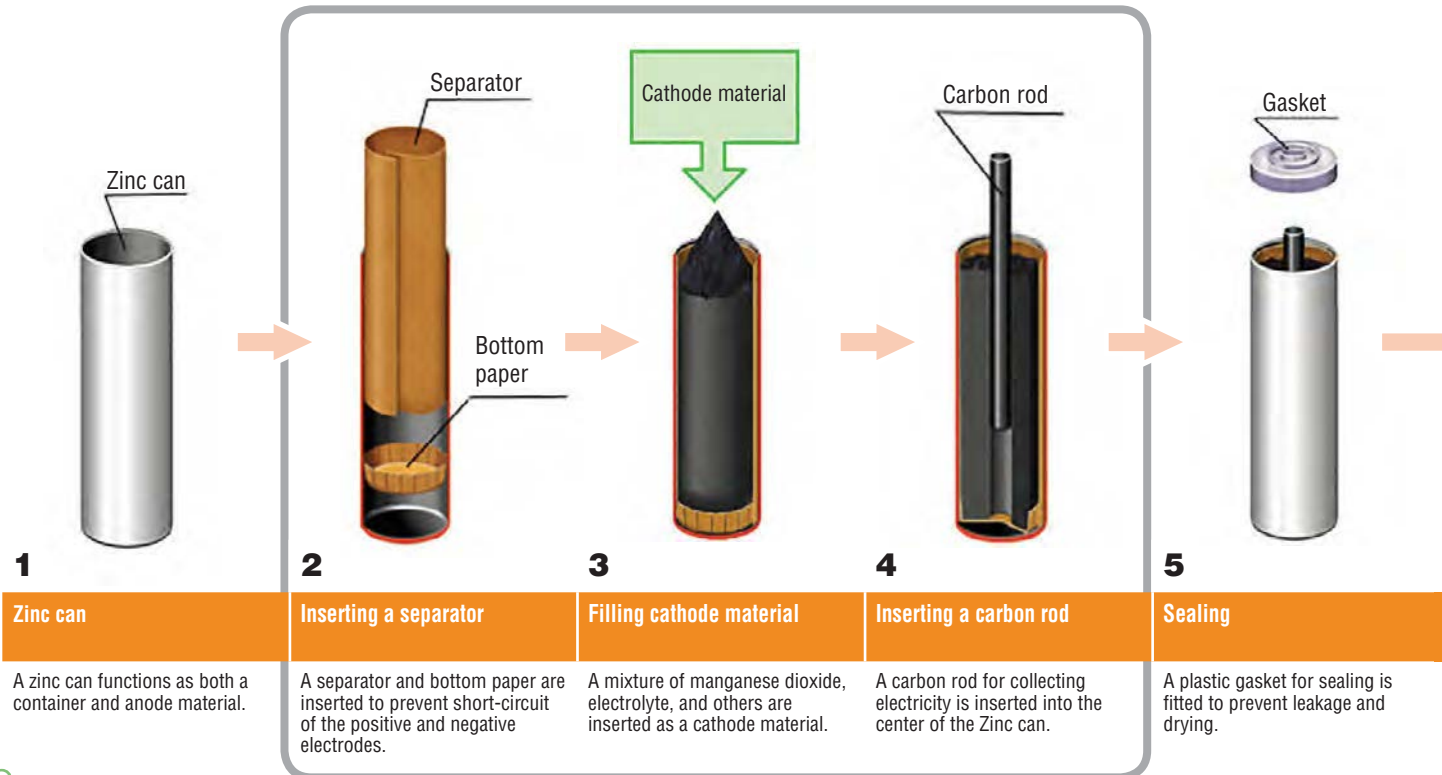

Alkaline

Strictly speaking, the Alkaline battery is called an Alkaline-Manganese Dry Battery. It looks nearly the same as the conventional carbon-zinc battery in shape and profile, but its performance is vastly different; it can deliver high-level power (up to seven times or more as that of the manganese battery) for many hours of continuous use with a small voltage drop.

Extra Heavy Duty

Made with manganese dioxide and zinc as prime materials, the carbon-zinc, battery is one of the most widely used batteries. When a voltage drop begins after hours of use, you can continue using the battery at a satisfactory level of performance by letting it operate and rest at intervals. This battery is suitable for use in powerful lights, flash lights, calculators, etc.

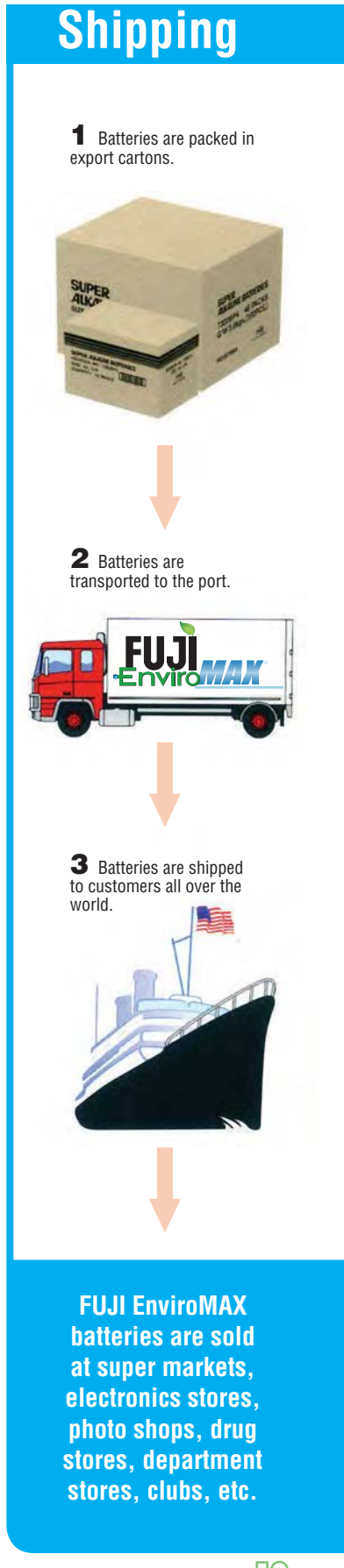
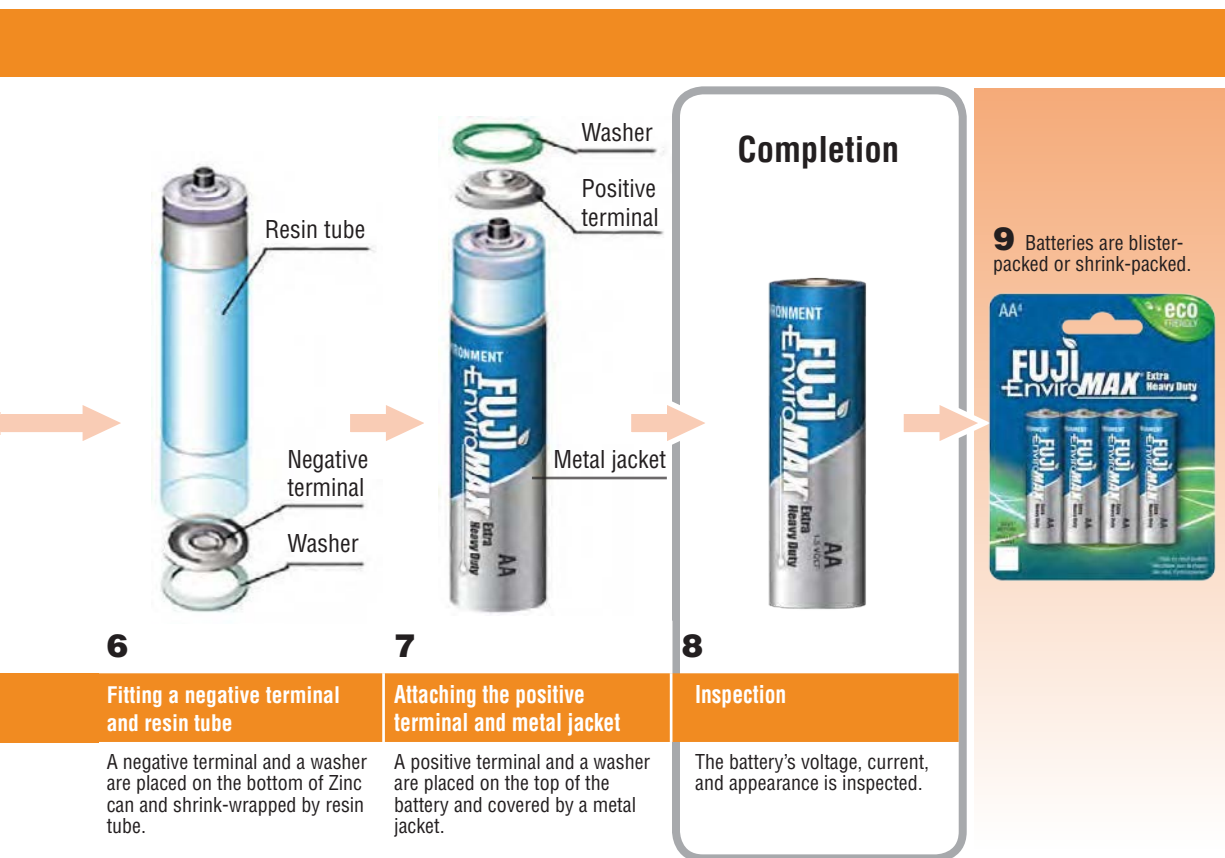
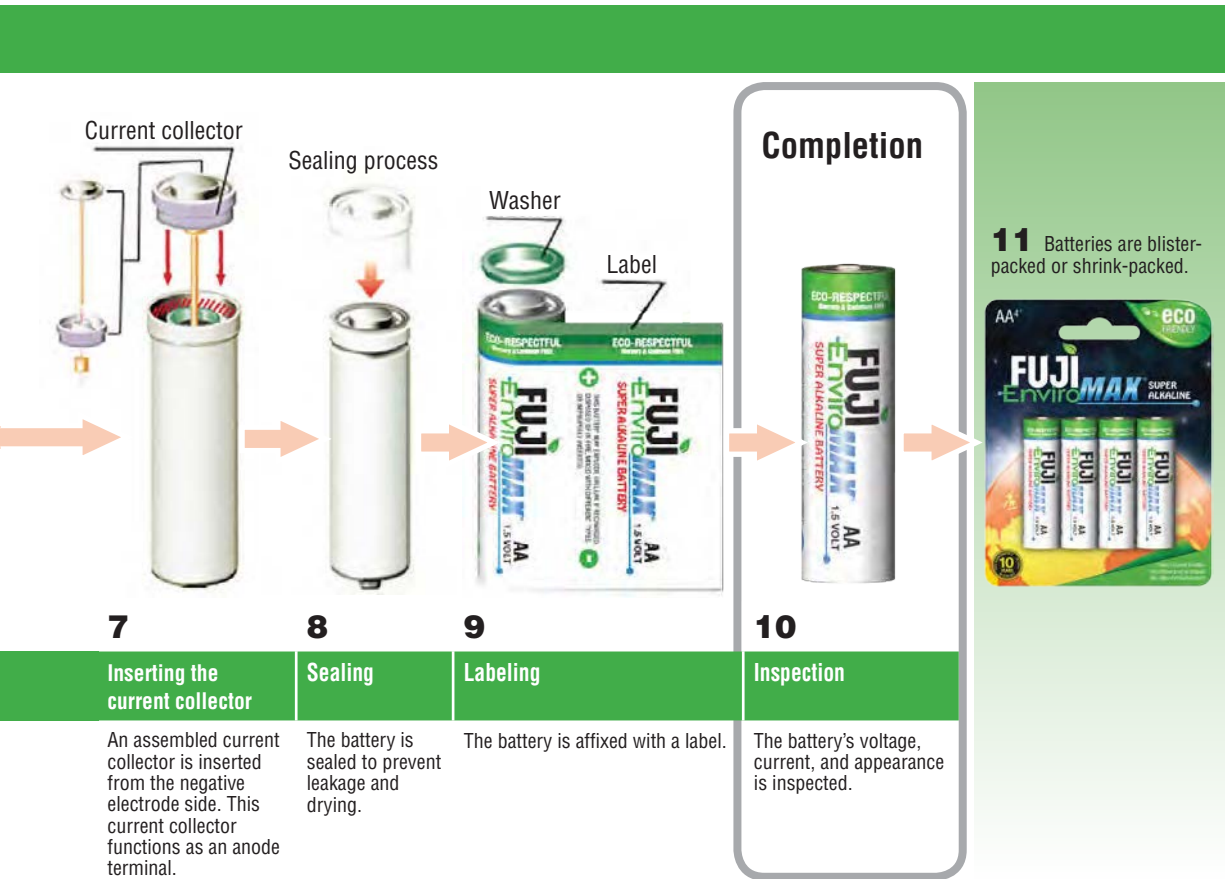



126



127



128



129



130



131



132



133

Product Code	Type	Size	Description	Dimensions (Max) (Inch)		Packaging	Packing					Product UPC	Inner Case UPC	Case UPC
				Height	Dia.		Inner Box (Packs)	Master Case (Packs)	Weight (lbs.)	Dimensions (Max) (Inch) W x H x D	Cu. Ft. (cft)			
126	LED	3-AAA	Aerospace aluminum alloy Cree XPE + 4SMD	8.07	1.91	Color box	24	48	35.27	16.5 x 12.4 x 8.6	1.018	791058201296	60791058201298	70791058201295
127	LED	4-AAA	Rotates 90 degrees, ABS polymer Lamp: 1W + 3WCOB	11.02	0.48	display board	12	48	16.53	18.9 x 11.8 x 15.7	2.026	791058201302	60791058201304	70791058201301
128	LED	2-AAA	Magnet ABS polymer Lamp: 1W + 3WCOB + 5RED	7.28	1.37	Color box	50	100	26.45	18.1 x 8.46 x 13.6	1.205	791058201319	60791058201311	70791058201318
129	LED	2-D	High, low, strobe output, aerospace aluminum alloy, 1 Cree XPE	9.92	2.48	Color box	24	48	46.29	16.5 x 21.6 x 11.6	2.39	791058201326	60791058201328	70791058201325
130	LED	4-AAA	Zoom adjustable head, aerospace aluminum alloy, Cree XPE + 3WCOB	6.89	1.77	Color box	25	50	33.07	15.7 x 10.6 x 10.6	1.02	791058201333	60791058201335	70791058201332
131	LED	4-AAA	Magent, pull up head, aerospace aluminum alloy, Cree XPE + 2COB	7.87	1.57	Color box	24	48	22.04	13.9 x 8.7 x 11.4	0.79	791058201340	60791058201342	70791058201349
132	LED	3-AAA	Zoom sliding head, aerospace aluminum alloy, Cree XML T6	5.91	1.77	Color box	24	48	19.84	13.2 x 8.9 x 13	0.884	791058201357	60791058201359	70791058201356
133	LED	4-AAA	Tough ABS spotlight, 3WLED for hand or stand	7.00	6.85	Color box	24	12	13.23	4.9 x 10.6 x 14.6	1.3344	791058201463	60791058201465	70791058201462

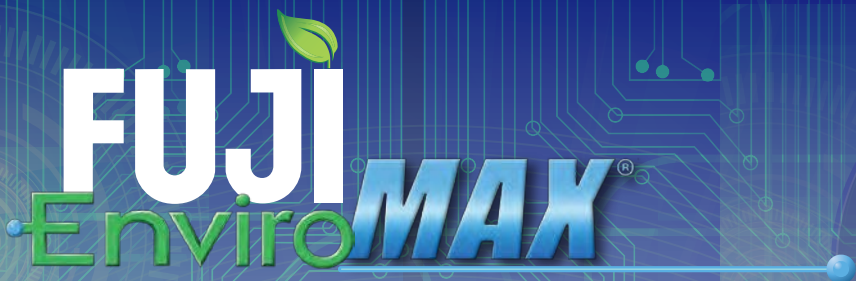

PHOTO BATTERIES & BUTTON CELLS



Product Code	Voltage (V)	Chemical System	Dimensions (Max) (mm)		Packaging	Packing					Product UPC	Inner Case UPC	Case UPC
			Height	Diameter		Inner Box (Packs)	Master Case (Packs)	Weight (lbs.)	Dimensions (Max) (Inch) W x H x D	Cu. Ft. (cft)			
LITHIUM PHOTO BATTERIES													
CR2	3.0	Li.	27.0	15.6	1 pc. in Blister 1 pc. in Pillow Pack	10 70	200 700	8.4 14.6	19.0 x 10.3 x 8.1 11.1 x 8.0 x 13.8	0.917 0.705	791058201166 N/A	60791058201168 N/A	70791058201165 N/A
CR-P2	6.0	Li.	36.0	(Length) 35.0 (Width) 19.5	1 pc. in Blister 1 pc. in Pillow Pack	10 16	200 160	18.7 13.2	22.5 x 10.3 x 8.1 12.4 x 11.7 x 5.3	1.079 0.449	791058201173 N/A	60791058201175 N/A	70791058201172 N/A
2CR5	6.0	Li.	45.0	(Length) 34.0 (Width) 17.0	1 pc. in Blister 1 pc. in Pillow Pack	10 20	200 200	20.9 18.7	20.0 x 10.3 x 8.1 12.4 x 11.7 x 5.3	0.960 0.449	791058201180 N/A	60791058201182 N/A	70791058201189 N/A
CR123A	3.0	Li.	34.5	17.1	1 pc. in Blister 2 pcs. in Blister 1 pc. in Pillow Pack	10 20 40	200 400 400	10.4 18.1 15.4	18.0 x 10.3 x 8.1 18.0 x 10.3 x 8.1 12.4 x 11.7 x 5.3	0.865 0.865 0.449	791058201197 791058201203 N/A	60791058201199 60791058201205 N/A	70791058201196 70791058201202 N/A
PHOTO BATTERIES													
LR6	1.5	Alk.	50.5	14.5	2 pcs. in Blister 4 pcs. in Blister	12 12	48 48	5.3 10.8	11.5 x 8.6 x 4.8 11.5 x 8.6 x 4.8	0.275 0.275	791058201210 791058201227	60791058201212 60791058201229	70791058201219 70791058201226
LR03	1.5	Alk.	44.5	10.5	2 pcs. in Blister	12	48	3.3	10.9 x 6.5 x 4.7	0.193	791058201234	60791058201236	70791058201233
BUTTON CELLS													
LR44	1.5	Alk.	5.4	11.6	2 pcs. in Blister	20	800	9.3	12.5 x 9.6 x 9.5	0.658	791058201241	60791058201243	70791058201240
LITHIUM COIN CELLS													
CR2016	3.0	Li.	1.6	20.0	1 pc. in Blister x 5	100	1,000	6.2	12.3 x 10.0 x 6.1	0.436	791058201258	60791058201250	70791058201257
CR2025	3.0	Li.	2.5	20.0	1 pc. in Blister x 5	100	1,000	7.5	12.3 x 10.0 x 8.7	0.615	791058201265	60791058201267	70791058201264
CR2032	3.0	Li.	3.2	20.0	1 pc. in Blister x 5	100	1,000	8.8	12.3 x 10.0 x 8.7	0.615	791058201272	60791058201274	70791058201271
CR2430	3.0	Li.	2.5	24.5	1 pc. in Blister x 5	100	1,000	11.9	12.3 x 10.0 x 8.7	0.615	791058201289	60791058201281	70791058201288

BATTERY STRUCTURE

ALKALINE

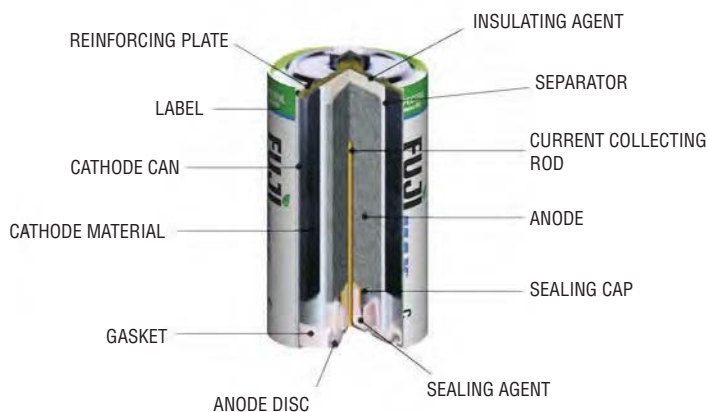

EXTRA HEAVY DUTY

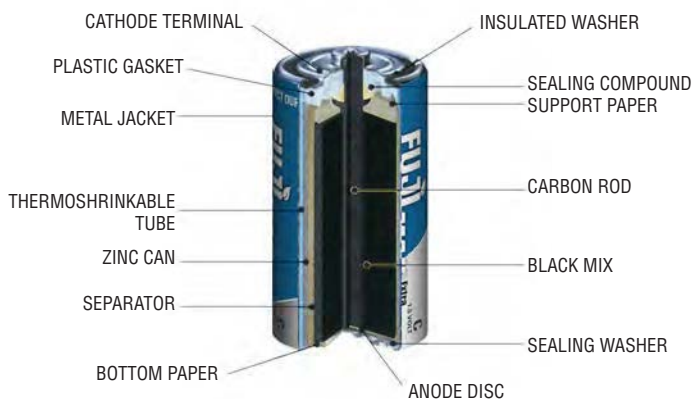

CROSS REFERENCE GUIDE

PRODUCT CODE	TYPE	SIZE	ANSI/NEDA	IEC NO.	VOLTAGE (V)	CHEMICAL SYSTEM	DIMENSIONS (MAX) (MM)		DURACELL	EVEREADY	RAY-O-VAC	PANASONIC
							HEIGHT	DIAMETER				
SUPER ALKALINE BATTERIES												
4100	LR20/AM1	D	13A	LR20	1.5	Alk.	61.5	34.2	MN1300	E95	813	AM1
4200	LR14/AM2	C	14A	LR14	1.5	Alk.	50.0	26.2	MN1400	E93	814	AM2
4300	LR6/AM3	AA	15A	LR6	1.5	Alk.	50.5	14.5	MN1500	E91	815	AM3
4400	LR03/AM4	AAA	23A	LR03	1.5	Alk.	44.5	10.5	MN2400	E92	824	AM4
4500	LR1/AM5	N	910A	LR1	1.5	Alk.	30.2	12.0	MN9100	E90	810	AM5
4600	6LR61(6LF22)	9V	1604A	6LR61	9.0	Alk.	48.5	(L)26.5x(W)17.5	MN1604	522	A1604	6AM6
DIGITAL ALKALINE BATTERIES												
8100	LR20/AM1	D	13A	LR20	1.5	Alk.	61.5	34.2	MN1300	E95	813	AM1
8200	LR14/AM2	C	14A	LR14	1.5	Alk.	50.0	26.2	MN1400	E93	814	AM2
8300	LR6/AM3	AA	15A	LR6	1.5	Alk.	50.5	14.5	MN1500	E91	815	AM3
8400	LR03/AM4	AAA	23A	LR03	1.5	Alk.	44.5	10.5	MN2400	E92	824	AM4
8500	LR1/AM5	N	910A	LR1	1.5	Alk.	30.2	12.0	MN9100	E90	810	AM5
8600	6LR61(6LF22)	9V	1604A	6LR61	9.0	Alk.	48.5	(L)26.5x(W)17.5	MN1604	522	A1604	6AM6
LITHIUM PHOTO BATTERIES												
CR2	CR2	-	1166A	CR15H270	3.0	Li.	27	15.6	DLCR2	EL1CR2	-	CR2
CR-P2	CR-P2	-	5024LC	-	6.0	Li.	36	(L)35x(W)19.5	DL223A	EL223AP	-	CR-P2
2CR5	2CR5	-	5032LC	-	6.0	Li.	45	(L)34x(W)17	DL245	EL2CR5	-	2CR5M
CR123A	CR123A	-	5018LC	-	3.0	Li.	34.5	17.1	DL123A	EL123A	-	CR123A
LITHIUM COIN CELLS												
CR2016	CR2016	-	5000LC	CR2016	3.0	Li.	1.60	20.0	DL2016	E-CR2016	-	CR2016
CR2025	CR2025	-	5003LC	CR2025	3.0	Li.	2.5	20.0	DL2025	E-CR2025	CR2025	CR2025
CR2032	CR2032	-	5004LC	CR2032	3.0	Li.	3.20	20.0	DL2032	E-CR2032	CR2032	CR2032
CR2430	CR2430	-	5011L	CR2430	3.0	Li.	3.00	24.5	DL2430	E-CR2430	CR2430	CR2430
BUTTON CELLS												
LR44	LR44	-	1166A	LR44	1.5	Alk.	5.4	11.6	PX76A	A76	-	LR44
EXTRA HEAVY DUTY												
3100	R20/UM-1	D	13F	R20	1.5	C-Z	61.5	34.2	M13F	950	2D	UM-1
3200	R14/UM2	C	14F	R14	1.5	C-Z	50.5	26.2	M14F	935	1C	UM-2
3300	R6/UM3	AA	15F	R6	1.5	C-Z	50.5	14.5	M15F	1015	7AA	UM-3
3400	R03(EC)	AAA	24F	R03	1.5	C-Z	44.5	10.5	M24F	912	400	-
3600	6F22/006P	9V	1604	6F22	9.0	C-Z	48.5	(L)26.5x(W)17.5	M1604	216	1604	006P
4FZ	4R25	Lantern	915	4R25	6.0	C-Z	111.0	(L)66.0x(W)66.0	M915	510S	942	-
NICKEL METAL HYDRIDE												
9300	HR-3UA	AA	1.2H2	HR03	1.2	Ni-MH	50.5	14.5	-	NH12	NM724	-
9400	HR-4UZ	AAA	1.2H1	HR6	1.2	Ni-MH	44.5	10.5	-	NH15	NM715	-

Alk.=Alkaline; Li=Lithium; C-Z=Carbon-Zinc

A night sky with the Milky Way galaxy visible, framed by trees with autumn foliage in the foreground. The text is overlaid on the upper portion of the image.

**MAXIMUM POWER.
MINIMUM IMPACT.**



6-9 The Square,
Stockley Park
Uxbridge
UB11-1FW

Tel: 02074772180

sales@fujienviromax.co.uk

www.fujienviromax.co.uk