



TAURUS

Rail-System



_ INNOVATION: SPEED-CONTROL

**_ tested in accordance with EN 353-1
+ CNB/P/11.073 + EN 795**

**_ 3 different ball bearing mounted travelling eyebolts:
horizontal-, vertical- and allround travelling eyebolt
(Butterfly)**

**_ allround trolley stops in all directions; passes corners
and arcs horizontal and vertical**

_ large fastening distance for the rail (5 meters)

_ availability on request!

SPEED CONTROL: An automatic speed reduction brake which detects the speed of the trolley in case of a fall is included at the vertical- and allround travelling eyebolt.

MAINTENANCE FREE: Due to the application of sealed ball bearings the trolleys are maintenance free.

TAURUS GLEIT H-10

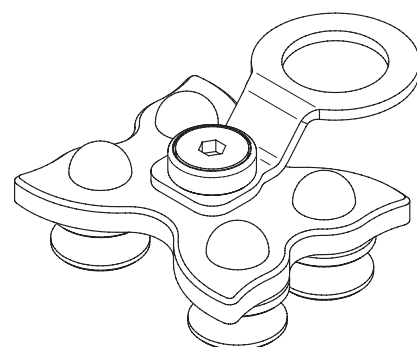

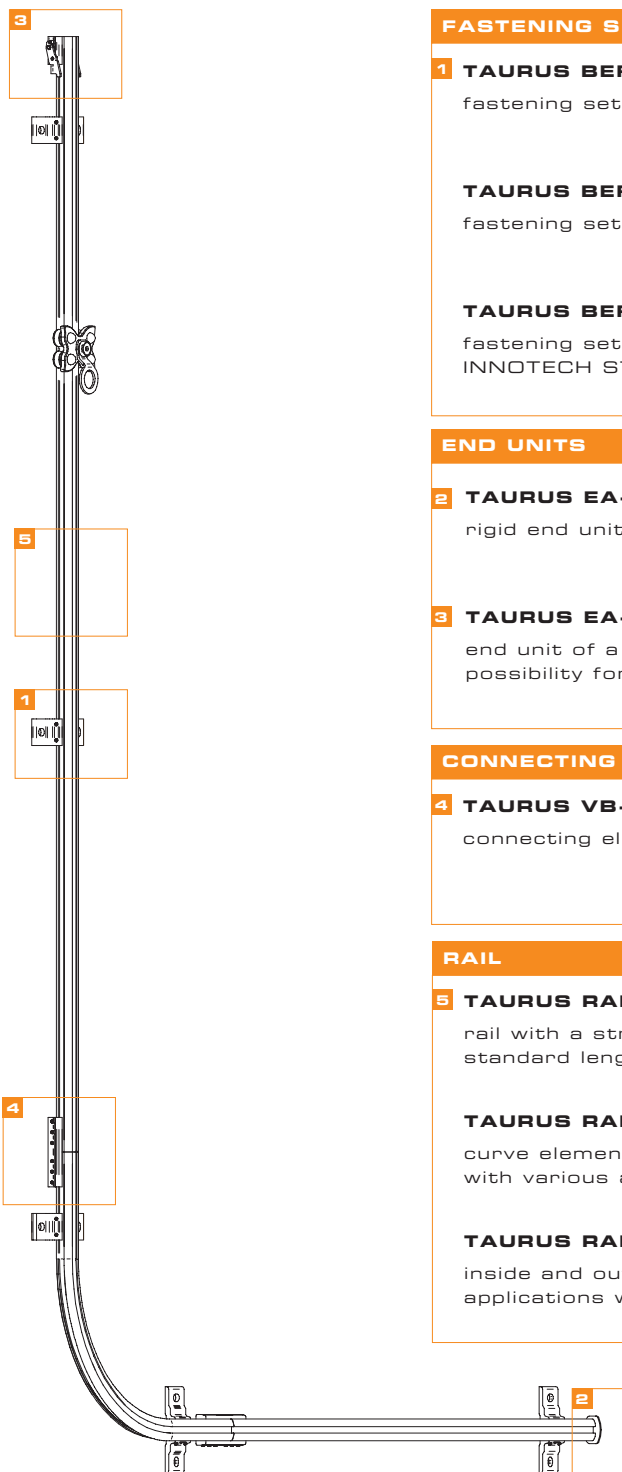

FASTENING SETS

1 TAURUS BEF-10

fastening set for concrete and steel construction

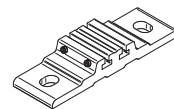

TAURUS BEF-12

fastening set for steel construction



TAURUS BEF-30

fastening set for assembling on the INNOTECH STA-standard post

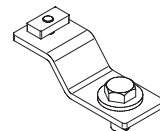

END UNITS

2 TAURUS EA-10

rigid end unit of a rail system - no entrance possibility



3 TAURUS EA-11

end unit of a rail system with entrance and exit possibility for the shuttle

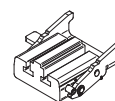

CONNECTING ELEMENT

4 TAURUS VB-10

connecting element for a rigid connection of two rails

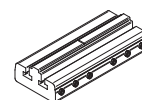

RAIL

5 TAURUS RAIL-10

rail with a straight run (available in various lengths)
standard lengths: 3m/6m

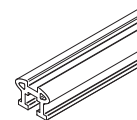

TAURUS RAIL-20 (15-90°)

curve element for horizontal rail systems
with various angles: 15°, 30°, 45°, 60°, and 90°

TAURUS RAIL-30 /-40 (90°)

inside and outside curve element for horizontal and vertical applications with an angle of 90°

SHUTTLES

TAURUS GLEIT

TAURUS GLEIT H-10

shuttle for horizontal usage

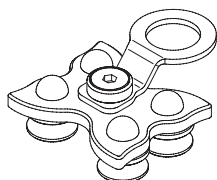

TAURUS GLEIT H-11

shuttle for horizontal usage
and for overhead systems

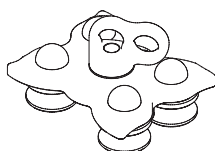

TAURUS GLEIT A-30

shuttle for horizontal and
vertical usage
(estimated sales start
march 2013)

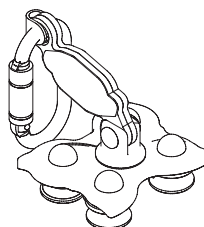

TAURUS GLEIT V-20

shuttle for vertical usage
(estimated sales start
march 2013)

