



PNEUMAX



HP SERIES

HIGH PRESSURE
PUSH-IN FITTINGS



Brass high pressure push-in fittings

HP Series



The High Pressure brass push-in fittings series can be used with oils and greases in lubrication and greasing systems, with a maximum pressure of 250 bar thanks to a special crimping gripper. They are available with different threads UNI ISO 7/1 UNI ISO 228/1 and are suitable for rigid and semi-rigid hoses commonly used in lubrication.

Ordering code

01 HP 04 018C

MODEL TYPE

- 01** = Straight male push-in fitting
- 15** = Swivel elbow push-in fitting

SERIES

- HP** = High pressure push-in fitting

TUBE CONNECTION

- 04** = Tube diameter (mm)
- 06** = Tube diameter (mm)

THREADED CONNECTION

- 018C** = Gc 1/8" (UNI ISO7/1)
- 014C** = Gc 1/4" (UNI ISO7/1)
- 0516** = 5/16" 24UNF
- 675D** = M6x0,75 Parallel
- 0061** = M6x1 Tapered
- 0081** = M8x1 Tapered
- 081D** = M8x1 Parallel
- 0101** = M10x1 Tapered
- 101D** = M10x1 Parallel
- 0121** = M12x1 Tapered
- 0010** = M10x1 with O-Ring
- 0018** = G1/8" with O-Ring

Advantages



Higher productivity:
designed to minimize downtimes



Less wear and tear:
monitored dosage to avoid risks of excessive or partial lubrication.



Reduced operating costs:
less energy consumption (less friction), less spare parts, less maintenance.



Better security:
no need for the operator to get close to dangerous or inaccessible areas



The ideal solution for all lubrication and greasing systems

The High pressure push-in fittings are fundamental components to avoid leakages in systems that operate with fluids at high pressures, guaranteeing safety and efficiency in the circuits. They are suitable for different environments such as:

- **Air-oil lubrication circuits**
- **Control of critical flows**
- **Minimal lubrication**
- **Lubrication of oil catenaries and bearings**
- **High pressure sterilization and cleaning processes**



Application sectors

- Energy
- Machine Tools
- Agricultural machinery
- Woodworking
- Glass, Stone
- Earthmovers
- Packaging
- Off- shore
- Transports
- Iron and Steel



Data sheet

FLUIDS		Oil and grease for lubrication.
APPLICATIONS		Centralised lubrication and greasing systems such as in: industrial automation, heavy industry, heavy transport, construction machinery and agricultural vehicles.
WORKING PRESSURE		0 ... 150 Bar
MAXIMUM PRESSURE*		250 Bar
RECOMMENDED TUBES**		PA6-6; High pressure hose with metal end terminal.
TUBE TOLERANCES		±0,07 mm until Ø6 mm
TEMPERATURE		-20°C ... +80°C
THREAD TYPE		M5; M6x0,75; M6x1; M8x1; M10x1; M12x1. ISO7/1 (BSPT): R1/8" - R1/4" ISO 228/1 (BSPP) G1/8" - G1/4"
MATERIALS	Body	Nickel plated brass
	Spring	Brass
	Seals	NBR
IMPORTANT NOTE	*	The maximum working pressure value is influenced by the type of hose used and by the temperature, which can significantly reduce the burst pressure of the hose.
	**	If the fitting is used with a metal terminal, in case of disassembly, it is not recommended to use the same fitting with plastic pipes.

Components

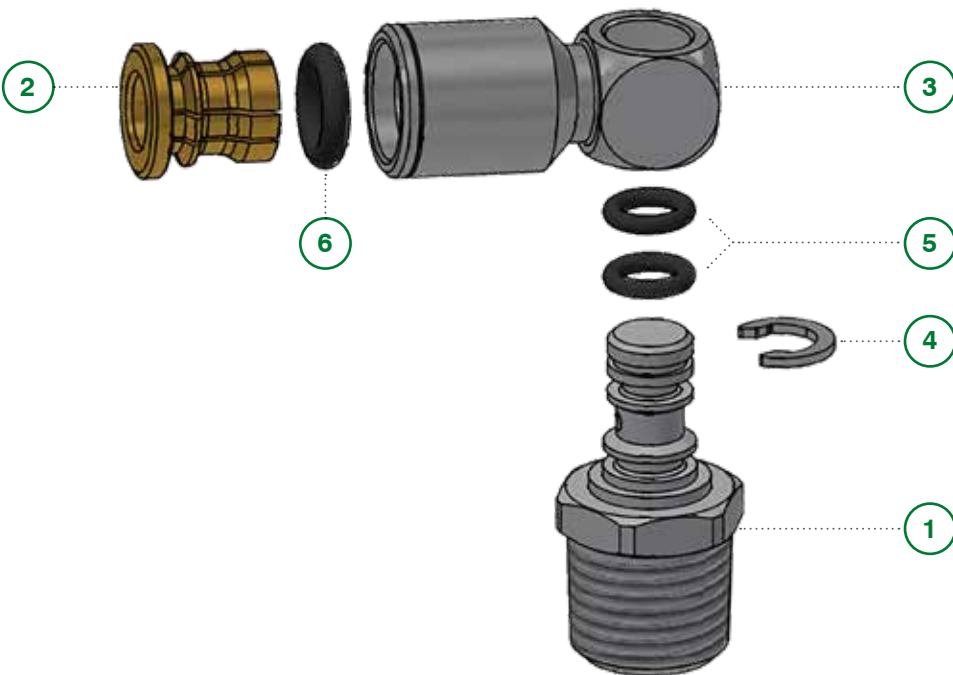
					
1	Stem for swivel banjo - Steel	3	Swivel banjo - Brass	5	OR - NBR
2	Crimping gripper - Brass	4	Locking ring - Steel	6	OR - NBR

ART. **01HP**

Straight male



COD.	ØD	G	ØB	H	L	Tav.				
01HP04675D	4	M6x0,75 Parallel	*	6,0	25,0	A	10	2,5	100	10,00
01HP040061	4	M6x1	*	8,0	27,0	A	10	2,5	100	10,00
01HP040081	4	M8x1	*	8,0	24,0	A	10	3,0	100	10,00
01HP040516	4	5/16"	*	8,0	24,0	A	10	3,0	100	10,00
01HP040101	4	M10x1	*	8,0	23,0	A	11	3,0	100	10,00
01HP040010	4	M10x1	13,5	7,5	24,0	B	10	3,0	100	10,00
01HP040018	4	G1/8"	13,5	7,5	24,0	B	10	3,0	100	12,00
01HP04018C	4	R1/8"	*	7,5	23,0	A	10	3,0	100	10,00
01HP060061	6	M6x1	*	8,0	29,0	A	12	2,5	100	10,00
01HP060081	6	M8x1	*	8,0	29,0	A	12	4,0	100	14,00
01HP060516	6	5/16"	*	8,0	29,0	A	12	4,0	100	14,00
01HP060101	6	M10x1	*	8,0	25,0	A	12	4,0	100	10,00
01HP060010	6	M10x1	13,5	7,5	27,0	B	12	4,0	100	15,00
01HP060121	6	M12x1	*	9,0	26,0	A	13	4,0	100	20,00
01HP06018C	6	R1/8"	*	7,5	25,0	A	12	4,0	100	10,00
01HP06014C	6	R1/4"	*	11,0	27,0	A	14	4,0	100	20,00
01HP060018	6	G1/8"	13,5	7,5	27,0	B	12	4,0	100	14,00

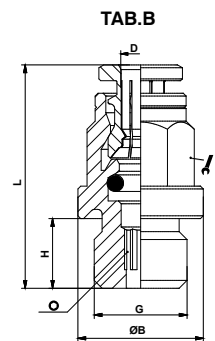
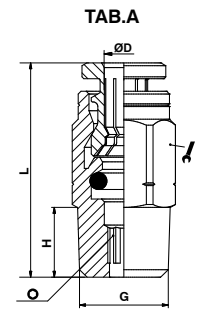

ART. **15HP**

Swivel elbow



COD.	ØD	G	ØB	H	L	L1	L2	Tav.			
15HP04675D	4	M6x0,75 Parallel	10,0	6,0	23,0	24,0	13,0	A	6	100	18,00
15HP040061	4	M6x1 Tapered	10,0	8,0	23,0	26,0	13,0	A	6	100	20,00
15HP040081	4	M8x1 Tapered	10,0	8,0	23,0	26,0	15,0	A	6	100	19,00
15HP040516	4	5/16"	10,0	8,0	23,0	26,0	15,0	A	6	100	19,00
15HP040101	4	M10x1 Tapered	10,0	8,0	23,0	26,0	15,0	A	6	100	20,00
15HP040010	4	M10x1 Parallel	13,0	7,5	23,0	28,0	17,0	B	6	100	22,00
15HP04018C	4	R1/8"	10,0	7,5	23,0	25,0	14,0	A	6	100	20,00
15HP040018	4	G1/8"	13,0	7,5	23,0	27,0	16,0	B	6	100	20,00
15HP060061	6	M6x1 Tapered	10,0	8,0	25,0	26,0	15,0	A	6	100	20,00
15HP060081	6	M8x1 Tapered	10,0	8,0	25,0	26,0	15,0	A	6	100	20,00
15HP060516	6	5/16"	10,0	8,0	25,0	26,0	15,0	A	6	100	20,00
15HP060101	6	M10x1 Tapered	10,0	8,0	25,0	26,0	15,0	A	6	100	20,00
15HP060010	6	M10x1 Parallel	13,0	7,5	25,0	28,0	17,0	B	6	100	20,00
15HP060121	6	M12x1 Tapered	13,0	8,0	25,0	26,0	15,0	A	6	100	24,00
15HP06018C	6	R1/8"	10,0	7,5	25,0	25,0	14,0	A	6	100	20,00
15HP060018	6	G1/8"	13,0	7,5	25,0	27,0	16,0	B	6	100	23,00
15HP06014C	6	R1/4"	*	11,0	25,0	28,0	20,5	A	14	100	27,00

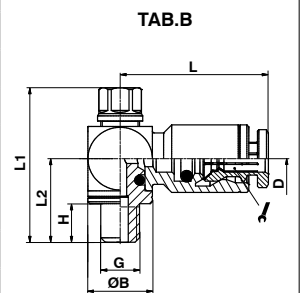
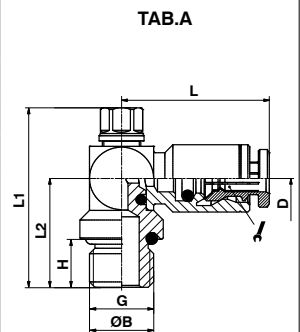



PNEUMAX

PNEUMAX S.p.A.

Via Cascina Barbellina, 10
24050 Lurano (BG) - Italy
P. +39 035 41 92 777
info@pneumaxspa.com
www.pneumaxspa.com