



Mechanical



The WPT® mechanical power take-off consists of a lever-actuated clutch with a shaft and bearings mounted in a rigid cast housing. The mechanical PTO is designed for inline and sload applications on all internal combustion engines with standard SAE industrial flywheel/flywheel housing dimensions.

- Sealed-for-life pilot bearings eliminate lubrication problems.
- Ball bearing throwout collars are optional on 10", 11 1/2", 14" and 18". Standard on the 311 PTO.
- Heavy-duty, laminated, gear tooth friction disc is available for heavy shock load applications that require extra friction disc tooth strength.
- All drive rings are ductile (nodular) iron or steel.
- Roller pilot bearings are available for higher sload requirements in select sizes.

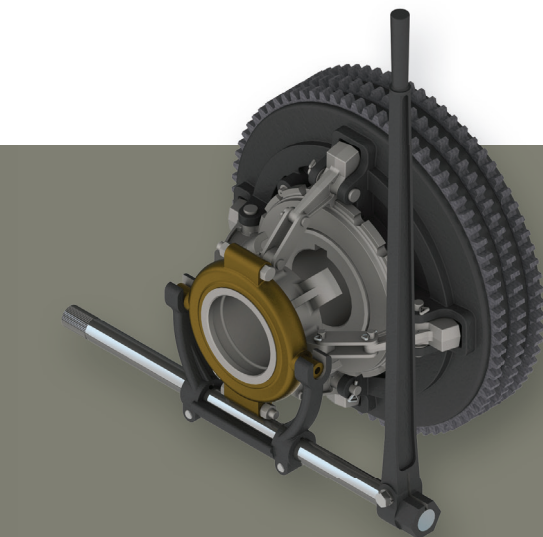

OEM Mechanical Clutch Packs

OEM over-center clutch packs are available for manufacturers of gear boxes requiring a disconnect clutch. WPT Power can furnish a complete package under one part number that includes the clutch and all needed accessories.

Mechanical

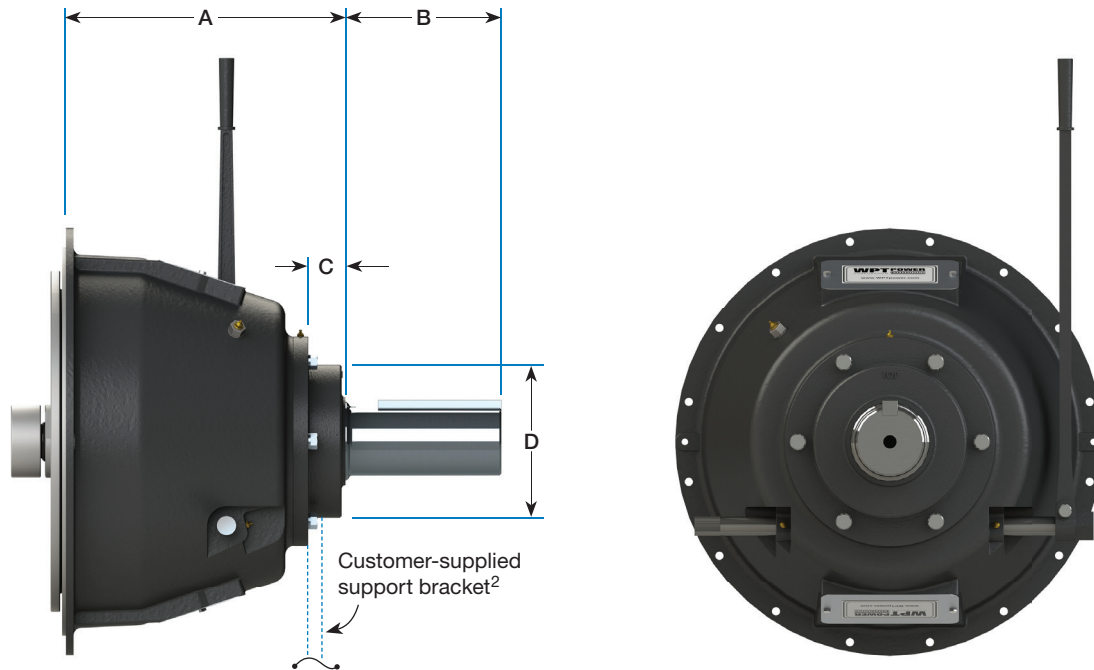

| Model | SAE Housings | A | Output Shaft | | | C | D | Weight lb (kg) | # of Teeth |
|---------------------|--------------|----------------|---------------|----------------|--------------------------|--------------|----------------|----------------|------------|
| | | | B | Dia | Keyway | | | | |
| C106 | 6, 5, 4 | 5 9/16 (141.3) | 3 1/2 (88.9) | 1.438 (36.53) | 3/8 x 3/16 (9.5 x 4.8) | 7/8 (22.2) | 4 1/2 (114.3) | 60 (27) | 42 |
| C106 ¹ | 6, 5, 4 | 7 1/8 (181.0) | 3 1/2 (88.9) | 1.438 (36.53) | 3/8 x 3/16 (9.5 x 4.8) | 2 1/8 (54.0) | 4 5/8 (117.5) | 65 (30) | 42 |
| C107 | 6, 5, 4 | 5 9/16 (141.3) | 3 1/2 (88.9) | 1.438 (36.53) | 3/8 x 3/16 (9.5 x 4.8) | 7/8 (22.2) | 4 1/2 (114.3) | 72 (33) | 47 |
| C107 ¹ | 6, 5, 4 | 7 1/8 (181.0) | 3 1/2 (88.9) | 1.438 (36.53) | 3/8 x 3/16 (9.5 x 4.8) | 2 1/8 (54.0) | 4 5/8 (117.5) | 78 (35) | 47 |
| C108 | 5, 4, 3 | 7 1/8 (181.0) | 6 (152.4) | 1.750 (44.45) | 1/2 x 1/4 (12.7 x 6.4) | 2 1/4 (57.2) | 5 (127.0) | 82 (37) | 51 |
| C110 | 4, 3 | 8 5/8 (219.1) | 5 1/2 (139.7) | 2.250 (57.15) | 5/8 x 5/16 (15.9 x 7.9) | 3 3/4 (95.3) | 5 5/8 (142.9) | 117 (53) | 63 |
| SP111 | 3, 2, 1 | 9 1/4 (235.0) | 6 1/2 (165.1) | 2.250 (57.15) | 5/8 x 5/16 (15.9 x 7.9) | 3 3/4 (95.3) | 5 3/4 (146.1) | 143 (65) | 72 |
| SP211 | 3, 2, 1 | 9 5/8 (244.5) | 6 1/2 (165.1) | 2.500 (63.50) | 5/8 x 5/16 (15.9 x 7.9) | 3 (76.2) | 6 1/4 (158.8) | 157 (71) | 72 |
| SP311 ² | 3, 2 | 13 7/8 (352.4) | 10 (254.0) | 3.500 (88.90) | 7/8 x 7/16 (22.2 x 11.1) | 3 3/8 (85.7) | 7 1/2 (190.5) | 233 (106) | 72 |
| SP114 | 1 | 12 1/8 (308.0) | 8 1/2 (215.9) | 3.000 (76.20) | 3/4 x 3/8 (19.1 x 9.5) | 3 1/8 (79.4) | 6 5/8 (168.3) | 263 (119) | 59 |
| SP214 ² | 1, 0 | 13 3/4 (349.3) | 10 (254.0) | 3.500 (88.90) | 7/8 x 7/16 (22.2 x 11.1) | 3 3/8 (85.7) | 7 1/2 (190.5) | 332 (151) | 59 |
| SP314 ² | 1, 0 | 14 1/2 (368.3) | 10 (254.0) | 3.938 (100.01) | 1 x 1/2 (25.4 x 12.7) | 3 3/8 (85.7) | 7 1/2 (190.5) | 413 (187) | 59 |
| IBF314 ² | 1, 0 | 16 3/4 (425.5) | 10 (254.0) | 3.938 (100.01) | 1 x 1/2 (25.4 x 12.7) | 3 5/8 (92.1) | 12 1/2 (317.5) | 595 (270) | 59 |
| SP318 ² | 0 | 18 1/4 (463.6) | 10 (254.0) | 4.500 (114.30) | 1 x 1/2 (25.4 x 12.7) | 2 5/8 (66.7) | 10 (254.0) | 897 (407) | 75 |

¹ Double main bearings

² Support plate for 311, 214, 314 is required for sideload applications and recommended for inline applications. Support plate for 318 is required for both sideload and inline applications.