

HOLZ-HER *Times*

THE MAGAZINE FOR WOOD AND PLASTIC PROCESSORS IN TRADE AND INDUSTRY

WWW.HOLZHER.CO.UK



2019-1

Automation Pro – the new dimension in machine networking

With Automation Pro, HOLZ-HER shows new ways for the networking of the whole production process from the STORE-MASTER panel storage system to finished furniture over the complete range of HOLZ-HER machinery.

- Workshop of the future
- Networked cutting solutions
- Intelligent CNC technology
- Digital edging technology

RETURN-MASTER 5920

The perfect addition in edgbanding.

More on page 2

The LUMINA 4.0 Edition

The megatrend of digitization combined with perfect invisible joints.

More on page 3

NEXTEC 4.0

The local solution for your transparent production control.

More on page 4

ZENTREX 6215

Unbeatable with the STORE-MASTER panel storage system.

More on page 7

RETURN-MASTER 5920 – efficient material handling

Is a
RETURN-MASTER
worthwhile for me?
Efficiency calculation:
+49 (0) 07022 702 207



The perfect addition in edgebanding

Automation is becoming increasingly important even in smaller workshops, to ensure they remain competitive and operate profitably. The RETURN-MASTER is a building block for automated edgebanding, regardless of whether in mass production or lot sizes of one.



HERE IS THE LINK TO THE VIDEO
www.holzher.de/return



Low-maintenance and durable

With its high-quality drives and guides, the RETURN-MASTER is very low-maintenance and extremely durable.



Stable design

In comparison to many rival products, the RETURN-MASTER, with 2 tonnes of unladen weight, is characterized by its particularly stable design.



Highest safety standard

The safety package, which meets the latest safety standards, networked with your HOLZ-HER edgebander, guarantees a safe workplace in future too.



One-person operation

The return unit enables efficient one-person operation for higher productivity and maximum flexibility.



Automation with the focus on customer benefits

Perfect solutions for every target group



Gregor Baumbusch,
CEO of WEINIG AG

developments in the WEINIG Group, we therefore focus right from the start on high transparency of production processes and particularly easy operation of the new applications, as well as on the obvious increase in efficiency. We are showing the proof that this is possible with our solutions and products via live demonstrations at LIGNA 2019. Under the motto THINK WEINIG, we are presenting innovations and further developments which cover the entire value added chain.

Both artisan businesses moving towards digitization and companies that are already digitized will find the right technology for their production tasks on the joint trade fair stand of WEINIG and HOLZ-HER. With us, you can not only

experience networked solutions of the highest standard, but also modern individual machines with automation of every stage of performance. 50 exhibits over an area of more than 5,000 square meters promise many highlights. Three new developments in the planing product area, a world premiere for the WEINIG CNC machining centers and innovations in end machining are just a few examples which no visitor should miss.

At HOLZ-HER, Automation Pro means the next big step towards automated production. The concept is the logical continuation of the innovative NEXTEC solutions and networks the whole production process, even in large interior finishing companies and in industrial

LIGNA 2019
Hall 27 | Stand C66

manufacturing. New HOLZ-HER machines can of course be integrated as well. This means the HOLZ-HER brand is further along the road to success and a key player in the WEINIG corporate strategy to be the technology leader for customers in processing solid wood and derived timber products. Come and see for yourself and visit us at LIGNA 2019.

Gregor Baumbusch

Best regards,
Gregor Baumbusch

The new edge highlights of the LUMINA 1596

The edgebanders of the LUMINA series are a byword for perfect invisible joint technology with laser edges and PUR. The LUMINA 1596 4.0 Edition impresses with further highlights. For example, with the latest generation of NC servo-axes. Further top themes for efficient edgebanding are "set-up in the gap" and the new, intelligent user guidance.

Barcodescanner
Rüsten in der Lücke Multifunktionstechnik
 Top-Kantenqualität **Wiederholgenauigkeit**

Einfache Bedienung **Nullfuge**
 und Wartung Megatrend Digitalisierung

LUMINA 4.0 Edition

Programmübernahme **Flexibilität**

Intelligentes Rüsten

Energieeffizienz **Auftragsspitzen**

Dünnschichttechnologie

Bezahlbare Technik



Set-up in the gap

In addition to iTronic, multi-function tool technology and fast servo-axes, "set-up in the gap" is one of the top themes for efficient edgebanding. "Set-up in the gap" enables you to run different machining processes at the same time in the edgebander. For example, the corner rounding unit or pivoting of the trimming unit can be intelligently switched on, without having to empty the machine for the set-up procedure.

Longitudinal machining

Corner rounding

Set-up in the gap

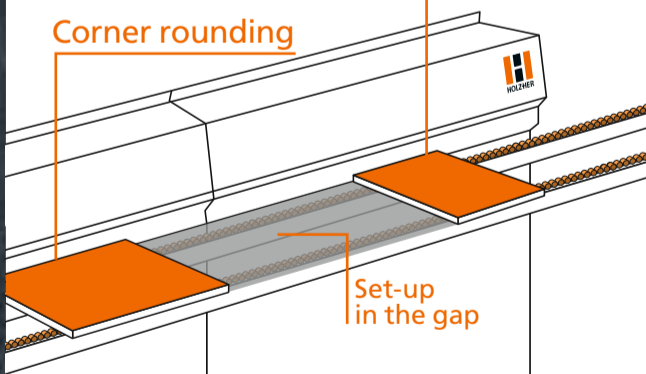

Intelligent user guidance

The new, intelligent user guidance allows an even more intuitive adjustment of all milling and scraping processes. At all times, the operator can identify which corrections are being made in which direction on a graphic display. The values for horizontal and vertical tool feed entered on the control unit are converted fully automatically to the actual axis values in the background. This makes sample workpieces a thing of the past.

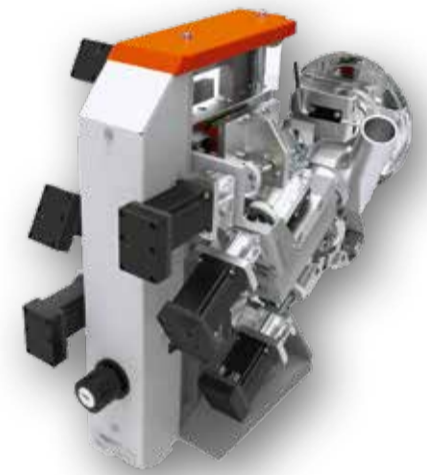

Fast servo-axes generation

At HOLZ-HER we are currently installing more than 8,000 NC servo-axes of the latest generation every year. These axes ensure lightning fast changeover on your edgebander to a really wide range of your applications: with repetition accuracy, durability and high precision. In combination with the intelligent iTronic package, you have a thoroughly smart edgebander as an efficient partner.

PUR invisible joints with HOLZ-HER Glu Jet

Advantages

- Top quality
- Invisible joint with PUR glue
- High-strength glued joint
- Waterproof quality
- High resistance to heat
- Simple cleaning

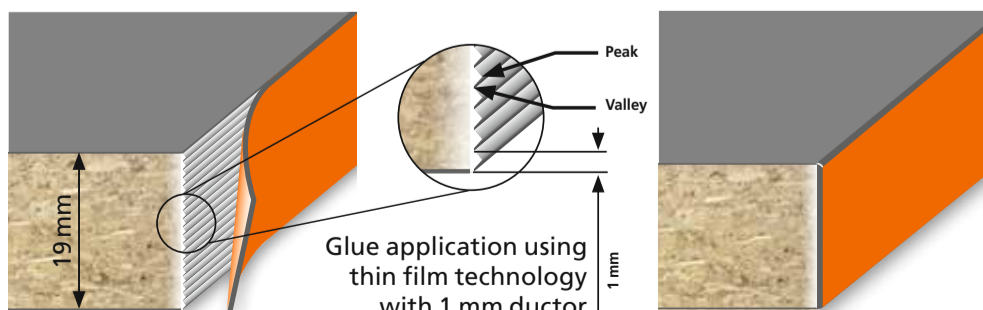

The new Glu Jet thin film technology means the glue penetrates deep into the panel structure.

You get a high-strength joint and an invisible look at the same time.

Added value for you – an invisible joint with every edge and all types of glue!

NEXTEC 4.0

The local solution for your production control.

NEXTEC 4.0 – the smart factory network PC for efficient, transparent and traceable manufacturing in your workshop of the future.

Now online at www.holzher.de/nextec7735 or www.holzher.de/nextec7707.

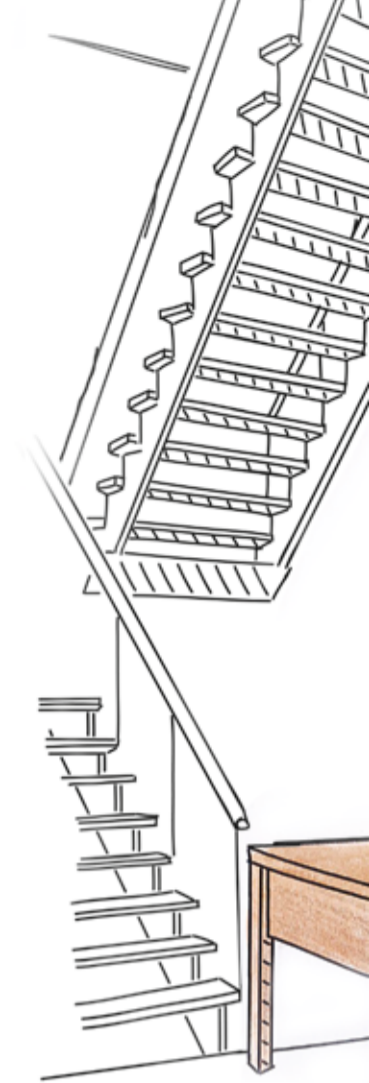

CAD/
CAM

Planning software
of leading manufacturers, such as RSO, Pytha, TopSolid, Pallete CAD, etc.

CabinetControl
HOLZ-HER planning software for fitted kitchens, cabinets to fit below pitched roofs, complete room solutions.

CabinetSelect
400 carcass furniture items ready for production – fully customizable.

What would your NEXTEC 4.0 solution look like?

▶ Small businesses

Furniture construction and interior fittings

- **Planning software:**
 - CabinetSelect + CabinetControl PRO as a carcass generator for standard carcasses.
- **Machine recommendation:**
 - NEXTEC 7707 classic
 - NEXTEC 4.0 solution
 - CAMPUS office license



▶ Medium-sized businesses

Designer furniture and online shop for end customers

- **Planning software:**
 - CAD/CAM systems of leading manufacturers
- **Machine recommendation:**
 - NEXTEC 7735 push
 - NEXTEC 4.0 solution

The interface to the CAD/CAM system is via the HOLZ-HER Warehouse Production List (CSV) and the post processor of the 3D CAD/CAM systems to NC-HOPS.



▶ Large businesses

Series-production furniture and supply businesses for carpentry shops

- **Planning software:**
 - 3D CAD/CAM systems for freely-planned furniture and kitchens for customer presentation.
 - CabinetSelect + CabinetControl PRO as a carcass generator for standard carcasses.
- **Machine recommendation:**
 - NEXTEC 7735 lift
 - NEXTEC 4.0 automatic host computer and software package.

The interface to the CAD/CAM system is via the HOLZ-HER Warehouse Production List (CSV) and the post processor of the 3D CAD/CAM systems to NC-HOPS.



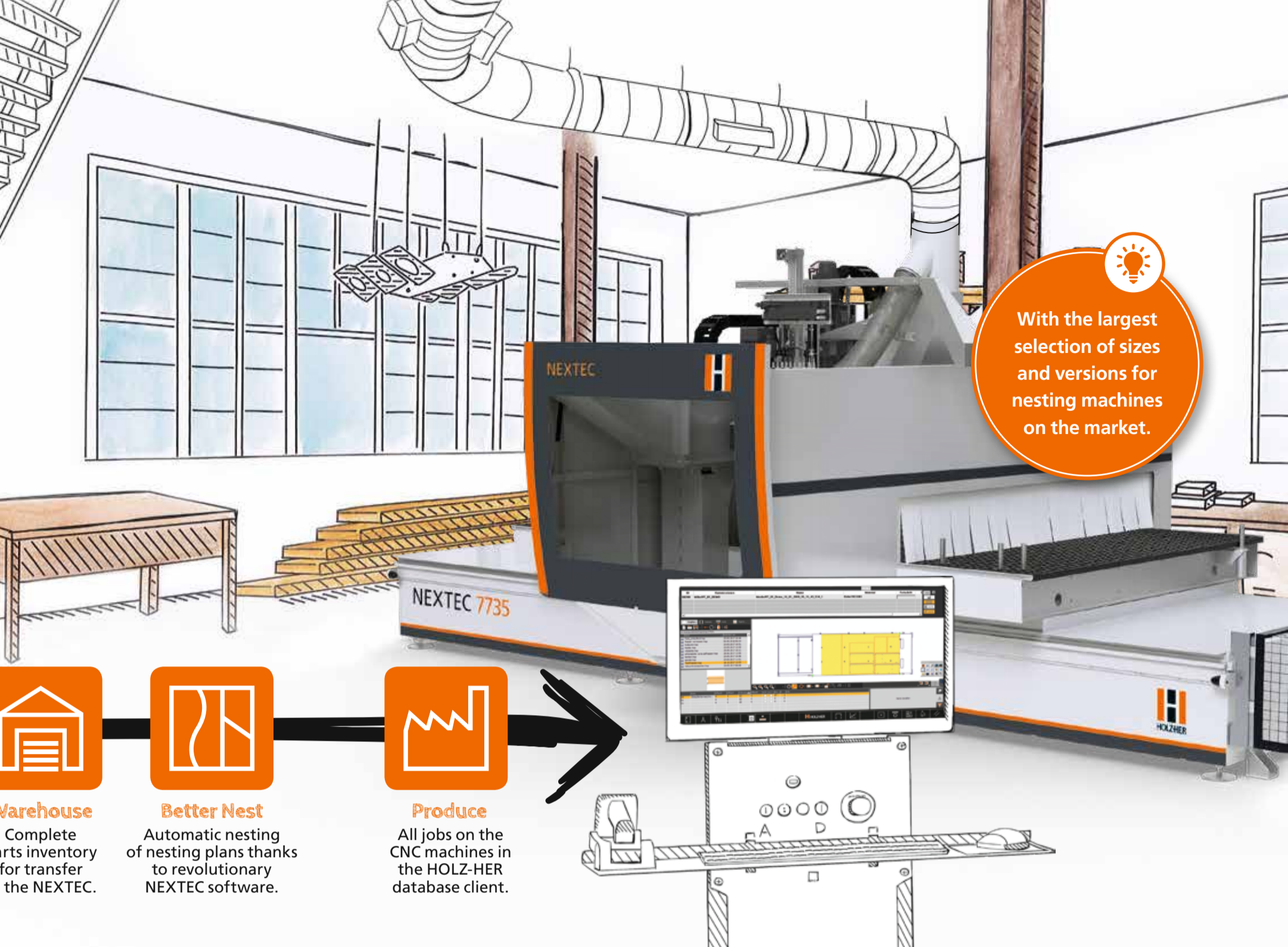

With the largest selection of sizes and versions for nesting machines on the market.



Warehouse
Complete parts inventory for transfer to the NEXTEC.



Better Nest
Automatic nesting of nesting plans thanks to revolutionary NEXTEC software.



Produce
All jobs on the CNC machines in the HOLZ-HER database client.

NEXTEC 7735 - the universal CNC machining center

Suction cup positioning

A 2D ceiling laser enables perfect indication of the position and angle of the specially developed suction cups on the nesting table.



Door machining

Perfect machining of door leaves with the flexible 5-axis head and 100 mm nesting suction cups.



Solid wood application

Universal machining options for staircase components, solid wood panels, etc.

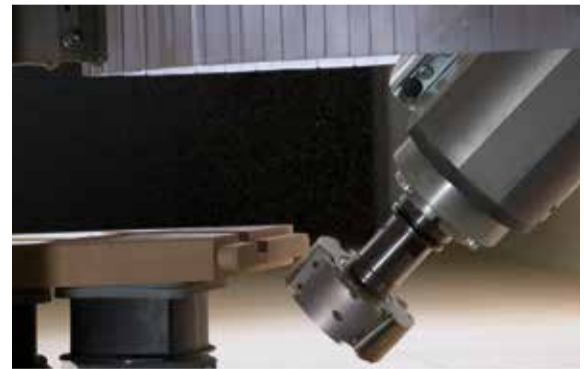

Material variety

Thanks to flexible options, the NEXTEC 7735 means you are ideally prepared for processing a really wide variety of materials.

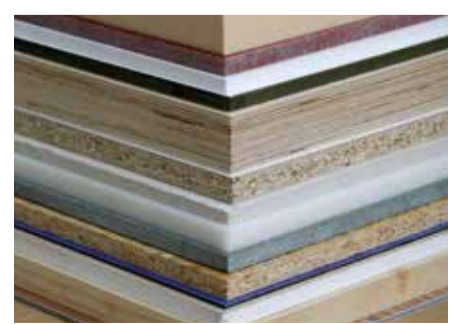

DirectCut

The virtual formatting saw: the fastest way to format workpieces on the CNC machines.



NOW NEW WITH DOOR PACKAGE

The EVOLUTION 7405 – efficient CNC machining in the smallest of spaces

It would be really difficult to imagine rational production without CNC machining centers, even in smaller carpentry workshops. There is room for it even in the smallest of spaces: with its EVOLUTION series, HOLZ-HER offers complete vertical machining in a compact format. The machining options of the vertical CNC machining centers in the EVOLUTION series are virtually unlimited. Even curved workpieces and furniture fronts can be machined. Profiling, milling and drilling, engraving or complete processing of counter tops are other possible applications. The vacuum-based clamping system is gentle on materials and is equipped with fully-automatic suction cup positioning. The 7405 4mat is capable of even more thanks to the integrated 6-fold tool changer: milling, cutouts, profiling, furniture connectors,

door machining, etc. It is the right model for everyone who wants a fully flexible machine for complex carcass construction.

Enthusied by the all-round talent EVOLUTION 7405

Customers appreciate the machining options and the versatility of the EVOLUTION series – and they are particularly delighted with greater efficiency in production. At HOLZ-HER, we often get feedback like this: “Our HOLZ-HER Evolution 7405 frees up 1.5 employees for other work every day and has significantly improved the quality of our products.” Facts that cannot be valued highly enough when competitive pressure is constantly growing and end customers rightly expect a first-class product with perfect dimensions and surface quality.



Highlights



Connection technology – free choice!

Perfect, completely milled and drilled workpieces for a really wide variety of connection technologies are no problem for the EVOLUTION 7405 connect. Lamello Clamex connector or OVVO connector technology.



Complete formatting on all four workpiece edges

The EVOLUTION 7405 4mat is an extremely flexible CNC machining center for a very wide range of materials and machining processes.



Ingenuous door package “Doors Ready”

A completely new, optional EVOLUTION door package, comprising a specially developed angle drive for lock sockets and a lock socket milling tool, supplements the capabilities offered by HOLZ-HER’s vertical CNC machines.



EVOLUTION 7405 4mat with XL passage

The EVOLUTION 7405 4mat and connect models are now more versatile than ever in terms of workpiece height thanks to an increased passage size of 1,200 mm. Possible material thicknesses from 8 to 70 mm mean the vertical machining centers are complete all-rounders.



HERE IS THE LINK TO THE VIDEO

www.holzher.de/doors

Premium WEINIG customer NorDan® relies on HOLZ-HER 5-axis technology

The NorDan Group is one of Scandinavia’s leading companies in the development, marketing and production of secure, attractive and environmentally friendly windows and doors. The company was founded in Norway in 1926 and today 1,700 employees work in ten factories and 25 sales offices in the group. NorDan has trusted in the state-of-the-art technology of the WEINIG Group for many years. The latest acquisition in the Swedish door works in Bor is a PRO-MASTER 7225 5-axis CNC machine with a machining length of more than 7 m. Managing Director, Dr. Dag Kroslid: “The new CNC machine from HOLZ-HER replaces an old one and is used to manufacture door leaves. The new CNC machine has a very high level of efficiency and

uses the state-of-the-art machine and control systems which NorDan needs in its efforts to achieve digitization and a smart factory. In addition, the PRO-MASTER 7225 is also used for NorDan’s additive manufacturing concept. The NorDan Group has recently invested in a large-format 3D printer for manufacturing doors and windows in the Bor factory. The CNC machine from HOLZ-HER is used for specific machining processes on the 3D printer products. The 3D printer uses granulates in a wide variety of materials, e.g. bio-composites, ABS and TPE. The integration of 3D printers and CNC machines is very interesting and offers more possibilities for additive manufacturing.”

www.nordan.no

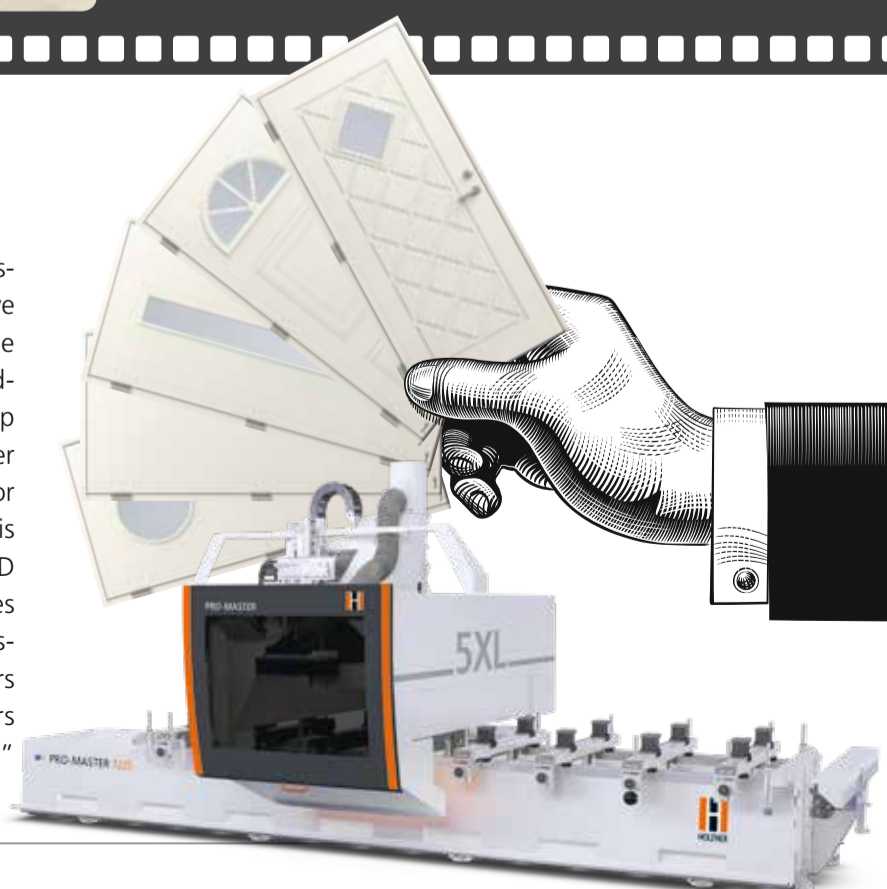

TECTRA 6120 – high performance with a new design

With the new look in “black”, the TECTRA 6120 pressure beam saw is perfectly suited to the design of the HOLZ-HER machines.



The integrated linear guide concept is the unbeatable highlight. For example, the sawing carriage moves completely on linear guides inside the machine. This provides absolute production reliability, speed and performance. The new TECTRA series is also way ahead of the game when it comes to safety. The DGUV* certification means it meets the highest safety standards – your guarantee of a safe workplace.

The TECTRA models cover the versions for manual loading, clas-

sic or power, the lift version with elevating table through to the dynamic, which is served by the STORE-MASTER storage system. The floating HOLZ-HER clamps mounted on linear guides prevent pressure points on the material. The main sawing motor, with up to 15 kw of power, manages the jobs with peak speeds of up to 130 m/min. The EasyPlan software enables the optimization and movement of production parts and even the creation of expanded front views.

* German Social Accident Insurance

Unbeatable as a team

ZENTREX 6215 and the STORE-MASTER panel storage system

Your customers' requirements have changed. Modern society with its diverse cultural influences is reflected in highly differing tastes. Custom solutions which take people's personal lifestyle into consideration are the strength of artisans. However, economical handling even of small lot sizes is expected from industrial businesses today as well. This is the specific point which HOLZ-HER addresses with its saw-storage combination, comprising the STORE-MASTER system and ZENTREX 6215 dynamic.

You get a flexible, future-oriented system solution for high-performance panel handling and thus significantly increase the capacity and profitability of your business.

With the trend to “one-piece-flow”, i.e. continuously decreasing lot sizes and custom solutions for individual customers, the HOLZ-HER STORE-MASTER system offers the perfect solution in this area for all sizes of businesses. Particularly in combination with the HOLZ-HER pressure beam saws and/or nesting CNC machines, companies get just what they need for continuing success in the future as well.



2-stage evacuation management system: maximum evacuation power using the synergistic effects of individual “Clean Protection” and “Dust Control” features

NEW

Clean Protection – for scoring cuts

When scoring cuts, an intelligent evacuating unit which moves behind the blade with the saw prevents dust and chips from flying off uncontrollably during the cutting process. This keeps your machine table clean, even during extremely narrow scoring cuts.

NEW

Dust Control – for program-controlled evacuation

The cutting position recognition feature optimally controls all evacuation openings in the pressure beam. This always ensures maximum evacuation power directly at the saw blade, keeping your machine table clean at all times. Evacuation openings that are not required are closed automatically – but can be adapted manually via the control unit if needs be.

NEW

Laser positioning system with accuracy down to the last millimeter

For panel sizes which are difficult to differentiate in terms of length or width in spite of 3D simulation on screen, the ZENTREX 6215 offers a laser positioning system with accuracy down to the last millimeter. Your advantage: makes remeasuring panels or incorrect positioning in the machine a thing of the past. Moreover, you minimize incorrect cuts and rejected parts.

The HOLZ-HER Edition|19 models

Our best sellers at promotional prices!



The smart workshop in the smallest of spaces

Edgebanders



STREAMER 1054

Impressive range of features, including HOLZ-HER Glu Jet thin film technology.

Edition|19 Price
from **26,650 EUR***



SPRINT 1329 premium

Flexible for every edging trend through variable feeds and shortest workpiece intervals.

Edition|19 Leasing
from **726.00 EUR****
monthly installment



LUMINA 1375

Your entry into the high-end invisible joint solution. Edgebanding without compromises for artisans – at an industrial level.

Edition|19 Leasing
from **633.00 EUR****
monthly installment

CNC machining centers



NEXTEC 7705

Smart CNC manufacturing now with NEXTEC 4.0.

Edition|19 Leasing
from **809.00 EUR****
monthly installment



PRO-MASTER 7125 | 7225

Maximum flexibility through state-of-the-art 5-axis technology.

Edition|19 Leasing
from **1,140.00 EUR****
monthly installment



EVOLUTION 7405 4mat

Complete machining on all four workpiece edges and surfaces.

Edition|19 Leasing
from **551.00 EUR****
monthly installment

Automation Pro – the new dimension in machine networking

live at **LIGNA**
Hall 27 | Stand C66

HOLZ-HER UK Hotline



Tel 01235 557600

Contact our resident HOLZ-HER specialist or one of our certified agents across the UK.



HOLZ-HER UK Head Office

Paul Nightingale, HOLZ-HER Sales Manager
Mob. 07717 411332 | paul_nightingale@holz-her.co.uk
Weinig Expo UK, Abingdon, OXON, OX14 1DY



Certified HOLZ-HER dealers across



Calderbrook Woodworking Machinery (1)

New Line Industrial Estate
The Sidings, Bacup, OL13 9RW
Tel: 01706 873344
sales@woodworkmachinery.co.uk



Groewood Machines (2)

Unit 12, Lion Court, Daneshill East,
Basingstoke, Hampshire RG24 8QU
Tel: 01256 818235
info@groewoodmachines.co.uk



MS Wood Machines (3)

20 Hadrian Road, Woodlands Park,
Blyth, Northumberland, NE24 3XA
Tel: 01670 355824
malcolm@mswoodmachines.co.uk

IMPRESSUM

HOLZ-HER GmbH
Plochinger Straße 65 • 72622 Nürtingen • Germany
Telephone +49 (0) 70 22 702-0 • kontakt@holzher.com • www.holzher.com
Responsible for content: Robert Terzer (General Sales Manager)

Production: Friends Media Group, Augsburg

Picture credits: Shutterstock.com – universe © Vadim-Sadovskii; Shutterstock.com – Room © ittoilmatar; AdobeStock.com – dark concrete floor © Leo Lintang; AdobeStock.com – Large hall © astragal

The technical data specified are intended for reference only. We reserve all rights to change design and features without prior notification. Some illustrations show special versions or equipment not included as standard features and are not binding. For clarity, some of the machines are shown without protective hood.



www.facebook.com/holzher.gmbh



www.youtube.com/holzhervideos

