

NOS



Lifting chains & accessories - Grade 8 & 10
Løftekæder & tilbehør - Klasse 8 & 10





Index

Information for safe use and maintenance	2.4	LIFTING COMPONENTS GRADE 10:	2.18
WLL Chart Grade 8 - ton	2.5	Master link	2.18
WLL Chart Grade 10 - ton	2.5	Master link assembly	2.18
CHAINSLINGS – Grade 8/10	2.7	Coupling link	2.19
Lifting Chain - Grade 8	2.8	Clevis safety hook	2.19
Lifting chain - Grade 10	2.8	Eye safety hook	2.19
Chain - Short link	2.8	Swivel safety hook	2.19
Chain - Long link	2.9	Clevis sling hook w. Latch	2.20
Chain - Short linked AISI 316	2.9	Eye sling hook w. Latch	2.20
Chain - Long linked AISI 316	2.9	Grab hook	2.20
LIFTING COMPONENTS GRADE 8:	2.10	Roundsling hook	2.20
Master link	2.10	Safe locking hook - with eye grip	2.21
Master link assembly	2.10	Swivel safe locking hook - with eye grip	2.21
Master link - HD XL	2.10	GUNNEBO GRABIQ LIFTING EQUIPMENT	2.22
Master link assembly - HD XL	2.11	GUNNEBO GRABIQ LIFTING COMPONENTS:	2.23
Connection link	2.11	GRABIQ Chainslings	2.23
Half link (incl. Locking set)	2.11	GRABIQ Master link	2.24
Roundsling coupling	2.11	GRABIQ Master link	2.24
Clevis safety hook	2.12	GRABIQ Master link assembly	2.24
Eye safety hook	2.12	GRABIQ Connection link	2.25
Swivel safety hook	2.12	GRABIQ Master grab	2.25
Clevis sling hook w. Latch	2.13	GRABIQ Master grab duo	2.25
Eye sling hook w. Latch	2.13	GRABIQ C-loc	2.26
Swivel hook w. Latch	2.13	GRABIQ C-loc duo	2.26
Foundry hook	2.14	GRABIQ C-Grab	2.26
Clevis grab hook	2.14	GRABIQ C-Grab duo	2.27
Grab hook	2.14	GRABIQ Grab hook OG	2.27
Container hook	2.14	GRABIQ Grab hook	2.27
Weld-on hook	2.15	GRABIQ Clevis safety hook	2.28
Weldable lifting point	2.15	GRABIQ Clevis safety hook	2.28
Pear shape master link (closed)	2.15	GRABIQ Eye safety hook	2.28
Pear shape master link (Open)	2.15	GRABIQ Eye safety hook	2.29
DV hook	2.16	GRABIQ Clevis sling hook	2.29
ROV eye sling hook	2.16	GRABIQ Eye sling hook	2.29
Slip hook	2.16	GRABIQ Container hook	2.30
Quick release hook - RAM H44-3	2.17	GRABIQ Swivel latch hook	2.30
Barrel sling	2.17	GRABIQ Swivel latch hook	2.30
		GRABIQ Swivel safety hook	2.31
		GRABIQ Swivel safety hook	2.31



Indhold

Information for sikker brug og vedligeholdelse	2.4
WLL Belastningstabel Klasse 8 - ton	2.5
WLL Belastningstabel Klasse 10 - ton	2.5
KÆDESLING - Klasse 8/10	2.7
Løftekæde - Klasse 8	2.8
Løftekæde - Klasse 10	2.8
Kæde - Kortleddet	2.8
Kæde - Langeddet	2.9
Kæde - Kortleddet AISI 316	2.9
Kæde - Langeddet AISI 316	2.9
LØFTEKOMPONENTER KLASSE 8:	2.10
Ovalring	2.10
Garniturering	2.10
Ovalring - HD XL	2.10
Garniture ring - HD XL	2.11
Samleled	2.11
Halvt samleled (inkl. Låse sæt)	2.11
Rundslingskobling	2.11
Gaffel sikkerhedskrog	2.12
Sikkerhedskrog m. øje	2.12
Sikkerhedskrog m. Svirvel	2.12
Gaffel lastkrog m. Pal	2.13
Lastkrog m. Pal	2.13
Svirvelkrog m. Pal	2.13
Støberikrog	2.14
Gaffel opkorter krog	2.14
Opkorter krog	2.14
Containerkrog	2.14
Gravemaskine krog	2.15
Transportring til svejsning	2.15
Pæreformet ovalring (lukket)	2.15
Pæreformet ovalring (Åben)	2.15
DV krog	2.16
ROV lastkrog med øje	2.16
Slipkrog	2.16
Udløserkrog - RAM H44-3	2.17
Tønde sling	2.17

LØFTEKOMPONENTER KLASSE 10:	2.18
Ovalring	2.18
Garniturering	2.18
Samleled	2.19
Gaffel sikkerhedskrog	2.19
Sikkerhedskrog m. øje	2.19
Sikkerhedskrog m. Svirvel	2.19
Gaffellastkrog m. Pal	2.20
Lastkrog m. Pal	2.20
Opkorter krog	2.20
Rundslingskrog	2.20
Sikkerhedskrog - med udløser håndtag	2.21
Svirvel sikkerhedskrog - med udløser håndtag	2.21
GUNNEBO GRABIQ LØFTEUDSTYR	2.22
GRABIQ Kædesling	2.23
GUNNEBO GRABIQ LØFTEKOMPONENTER:	2.23
GRABIQ Ovalring	2.24
GRABIQ Ovalring	2.24
GRABIQ garniturering	2.24
GRABIQ Samleled	2.25
GRABIQ Topkrog enkelt	2.25
GRABIQ Topkrog dobbelt	2.25
GRABIQ Topkrog enkelt	2.26
GRABIQ Topkrog dobbelt	2.26
GRABIQ Topkrog enkelt	2.26
GRABIQ Topkrog dobbelt	2.27
GRABIQ Topkrog OG	2.27
GRABIQ Opkorter krog	2.27
GRABIQ Gaffel sikkerhedskrog	2.28
GRABIQ Gaffel sikkerhedskrog	2.28
GRABIQ Sikkerhedskrog m. øje	2.28
GRABIQ Gaffel sikkerhedskrog m. øje	2.29
GRABIQ Gaffel lastekrog	2.29
GRABIQ Lastkrog	2.29
GRABIQ Containerkrog	2.30
GRABIQ Svirvellastkrog m. Pal	2.30
GRABIQ Svirvellastkrog m. pal	2.30
GRABIQ Svirvelsikkerhedskrog	2.31
GRABIQ Svirvel sikkerhedskrog	2.31



Information for safe use and maintenance

Extreme temperature conditions

The in-service temperature of the G8 & G10 components affects the WLL as following:

Temp. of sling (°C)	Reduction of WLL
-40 to 200	None

Surface treatment

Note! Hot-dip galvanizing or plating is not allowed outside the control of the manufacturer.

Asymmetrical loading conditions

For asymmetric lift, the WLL is determined as follows:

- 2-leg slings calculated as the corresponding 1-leg sling
- 3 and 4-leg slings calculated as the corresponding 1-leg sling. If it is certain that 2-legs are equally carrying the major part of the load, it can be calculated as the corresponding 2-leg sling.

Severe environment

Chain and components must not be used in alkaline (>pH10) or acidic conditions (<pH6).

Comprehensive and regular examination must be carried out when used in severe or corrosive inducing environments. In uncertain situations consult your lifting supplier.

Information for sikker brug og vedligeholdelse

Forbehold ved ekstreme temperaturer

Påvirkningen på G8 & G10 komponenter, mens de er i brug under ekstreme temperaturer er som følgende:

Temp. på sling (°C)	Reduktion of WLL
-40 til 200	Ingen

Overfladebehandling

Bemærk! Varmgalvanisering og belægning, er ikke tilladt uden producentens godkendelse / kontrol.

Asymmetriske belastninger

For asymmetriske løft, skal følgende forbehold tages:

- 2-strengt sling beregnes som tilsvarende 1-strengt
- 3- og 4-strengt sling beregnes som tilsvarende 1-strengt, men hvis de 2 af strengene bærer hovedparten af byrden ligeligt, må det samlede sling beregnes som 2-strengt sling.

Agressive miljøer

Kæde og komponenter må ikke anvendes under basisk (>pH10) eller syre (<pH6) lignende forhold.

Omfattende og regelmæssige undersøgelser skal foretages, ved anvendelse under disse forhold. Ved tvivl kontakt din leverandør.

WLL Chart Grade 8 - ton

WLL Belastningstabel Klasse 8 - ton

Chain dim.	1-Leg	2-Leg		3- & 4-Leg		Choked endless sling
		β 0-45° a 0-90°	β 45-60° a 90-120°	β 0-45° a 0-90°	β 45-60° a 90-120°	
6	1,12	1,60	1,12	2,36	1,70	1,80
7	1,50	2,12	1,50	3,15	2,24	2,50
8	2,00	2,80	2,00	4,25	3,00	3,15
10	3,15	4,25	3,15	6,70	4,75	5,00
13	5,30	7,50	5,30	11,20	8,00	8,50
16	8,00	11,20	8,00	17,00	11,80	12,50
19	11,20	16,00	11,20	23,60	17,00	18,00
22	15,00	21,20	15,00	31,50	22,40	23,60
26	21,20	30,00	21,20	45,00	31,50	33,50
32	31,50	45,00	31,50	67,00	47,50	50,00

Safety factor 4:1.

WLL are based upon equally loaded and disposed sling legs.

Sikkerhedsfaktor 4:1.

WLL er baseret på ligeligt fordelt vægt og vinkling på strengene.

WLL Chart Grade 10 - ton

WLL Belastningstabel Klasse 10 - ton

Chain dim.	1-Leg	2-Leg		3- & 4-Leg	
		β 0-45° a 0-90°	β 45-60° a 90-120°	β 0-45° a 0-90°	β 45-60° a 90-120°
6	1,50	2,12	1,50	3,15	2,24
8	2,50	3,50	2,50	5,20	3,70
10	4,00	5,60	4,00	8,40	6,00
13	6,70	9,50	6,70	14,00	10,00
16	10,00	14,00	10,00	21,00	15,00
20	16,00	22,40	16,00	33,60	24,00
22	20,00	28,20	20,00	42,00	30,00
26	27,00	38,00	27,00	56,70	40,00
32	40,00	56,40	40,00	84,00	60,00

Safety factor 4:1.

WLL are based upon equally loaded and disposed sling legs.

Sikkerhedsfaktor 4:1.

WLL er baseret på ligeligt fordelt vægt og vinkling på strengene.



Maintenance

Periodic thorough examination must be carried out at least every 12 months or more frequently according to statutory regulations, type of use and past experience.

1. Overloaded chain slings must be taken out of service.
2. Chain and components incl. load pins which has been damaged, deformed, elongated, bent or showing signs of cracks or gauges all be replaced. Carefully grind away small sharp cuts and burrs. Additional testing by magnetic particle inspection and/or proof loading at max. 2 x WLL may be carried out.
3. Check the function of latches, triggers and retaining pins / bushes, replace when necessary. Always use original spare parts.
4. Max. clearance between hook and latch.
Note: For a Grip-latch hook measure the difference between dimension A with unloaded spring and dimension A when the latch is pressed against the hook. Clearance B not applicable.

Vedligeholdelse

Grundigt eftersyn, skal foretages mindst en gang hver 12 måned eller oftere i henhold til lovmæssige bestemmelser, form for anvendelse eller tidligere erfaringer.

1. Overbelastede kædesæt, skal tages ud af brug.
2. Kæde og komponenter inkl. låsepinde som er skadet, deformeret, forlænget eller som viser tegn på revner eller lignende, skal udskiftes. Små skarpe kanter og grater slibes væk. Ekstra test i form af magnetisk partikel inspektion eller en prøve last på maks. 2 x WLL kan udføres.
3. Tjek funktionen af paler, udløsere og låsepinde, udskiftes om nødvendigt. Brug altid originale reservedele.
4. Maks. afstand mellem krog og pal.
Bemærk: For en krog med gribe-pal, måles difference mellem mål A med en u-lastet fjeder og mål A når pal'en er presset mod krogen. Frihøjden B kan ikke anvendes.

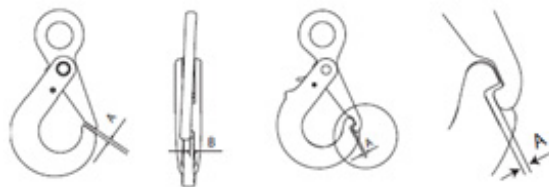

Size	Max. A (mm)	Max. B (mm)
6	2,2	3,5
7-8	2,7	4,5
10	3	6
13	3,3	7
16	4	9
20	5,5	10

5. The wear of the chain and component shall in no place exceed 10% of the original dimensions. The chain link wear - max. 10% - is defined as the reduction of the mean diameter measured in two directions.

5. Slitage på kæde og komponenter må på intet tidspunkt overskride 10% af de oprindelige mål. Kædeleddets slitage - maks. 10% - defineres som reduktionen, når målt i to retninger.

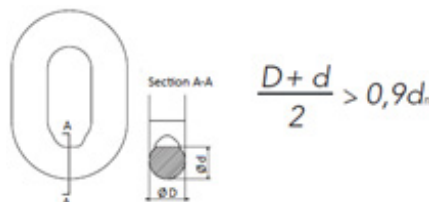

Sikkerhedsfaktor 4:1
Safety factor 4:1



CHAINSLINGS – Grade 8/10

When ordering please advise chain dimension, length of chain per leg and which grade you want.

KÆDESLING – Klasse 8/10

Ved bestilling oplys venligst kæde dimension, længde på kæde per ben og hvilken klasse det skal være.

Type: 1.1
 m. lastkrog
 w. Latch hook



Type: 1.2
 m. lastkrog & opkorter
 w. latch hook & grab hook



Type: 1.3
 m. sikkerhedskrog
 w. safety hook



Type: 1.4
 m. sikkerhedskrog & opkorter
 w. safety hook & grab hook



Type: 2.1
 m. lastkrog
 w. Latch hook



Type: 2.2
 m. lastkrog & opkorter
 w. latch hook & grab hook



Type: 2.3
 m. sikkerhedskrog
 w. safety hook



Type: 2.4
 m. sikkerhedskrog & opkorter
 w. safety hook & grab hook



Type: 4.1
 m. lastkrog
 w. Lashhook



Type: 4.2
 m. lastkrog & opkorter
 w. latch hook & grab hook



Type: 4.3
 m. sikkerhedskrog
 w. safety hook



Type: 4.4
 m. sikkerhedskrog & opkorter
 w. safety hook & grab hook



Other combinations on request

Andre kombinationer på forespørgsel



Lifting Chain - Grade 8

- EN 818-2 :2008
- Black painted

Løftkæde - Klasse 8

- EN 818-2 :2008
- Sort malet

Art. No.	Model	WLL ton*	Dimensions - mm			Weight appr. kg/m
			D	E	H ₁	
02 03 0001	LC-6-8E	1,12	6	18	8,5	0,8
02 03 0002	LC-7-8E	1,5	7	21	10	1,1
02 03 0003	LC-8-8E	2,0	8	24	11	1,4
02 03 0004	LC-10-8E	3,15	10	30	14	2,2
02 03 0005	LC-13-8E	5,3	13	39	18	3,7
02 03 0006	LC-16-8E	8,0	16	48	22	5,8
02 03 0007	LC-20-8E	20,0	20	66	28	9,0
02 03 0008	LC-22-8E	15,0	22	66	30	11,0
02 03 0009	LC-26-8E	21,2	26	78	35	14,3
02 03 0010	LC-32-8E	31,5	32	96	43	23,0



Lifting chain - Grade 10

- EN 818-2 :2008
- Blue painted
- In service max tempature 200°C

Løftkæde - Klasse 10

- EN 818-2 :2008
- Blå malet
- Ved brug, max tempatur 200°C

Art. No.	Model	WLL ton*	Dimensions - mm			Weight kg/m
			D nom.	L	E	
03 15 0001	KLA 6-10	1,5	6	18	8,5	0,87
03 15 0002	KLA 8-10	2,6	8	24	11,0	1,45
03 15 0003	KLA 10-10	4,0	10	30	14,0	2,25
03 15 0004	KLA 13-10	6,8	13	39	17,7	3,76
03 15 0005	KLA 16-10	10,3	16	48	21,9	5,64
03 15 0006	KLA 20-10	16,0	20	60	27,0	9,40
03 15 0007	KLA 22-10	20,0	22	66	29,0	11,90
03 15 0008	KLA 26-10	27,0	26	78	35,0	16,40



*Safety factor 4:1

*Sikkerhedsfaktor 4:1

Chain - Short link

- Galvanized
- DIN 766
- Not approved for lifting
- Delivered in lengths of 30-50 mtr, depending on dia. of the chain

Kæde - Kortleddet

- Galvaniseret
- DIN 766
- Ikke godkendt til løft
- Leveres i længder af 30-50 mtr, alt efter dia. på kæden

Art. No.	MBL ton	Size	Dimensions - mm			Weight kg
			D	C	B	
04 55 0001	0,28	3	3	16,0	11,0	0,17
04 55 0002	0,60	4	4	16,0	13,7	0,32
04 55 0003	1,00	5	5	18,5	17,0	0,51
04 55 0004	1,40	6	6	18,5	20,2	0,75
04 55 0005	2,50	8	8	24,0	27,2	1,44
04 55 0006	4,00	10	10	28,0	34,0	2,37
04 55 0007	6,40	13	13	36,0	44,2	4,02
04 55 0008	10,0	16	16	45,0	54,4	5,97
04 55 0009	18,3	19	19	53,0	64,6	8,20

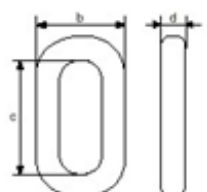

Chain - Long link

- Galvanized
- DIN 763
- Not approved for lifting
- Delivered in lengths of 30-50 mtr, depending on dia. of the chain

Kæde - Langeddet

- Galvaniseret
- DIN 763
- Ikke godkendt til løft
- Leveres i længder af 30-50 mtr, alt efter dia. på kæden

Art. No.	MBL ton	Dimensions - mm				Weight kg
		Size	D	C	B	
04 56 0001	0,28	3	3	26	12	0,10
04 56 0002	0,60	4	4	32	16	0,28
04 56 0003	1,00	5	5	36	20	0,43
04 56 0004	1,40	6	6	42	24	0,65
04 56 0005	2,50	8	8	54	32	1,13
04 56 0006	4,00	10	10	66	40	1,80
04 56 0007	6,40	13	13	82	50	3,04
04 56 0008	10,0	16	16	100	60	4,58
04 56 0009	18,3	19	19	123	70	6,25

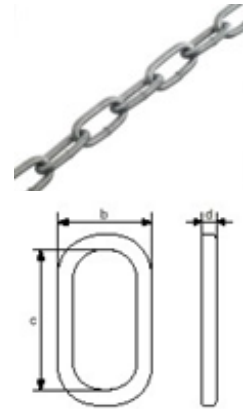

Chain - Short linked AISI 316

- DIN 766
- Stainless steel
- Not approved for lifting

Kæde - Kortleddet AISI 316

- DIN 766
- Rustfrit stål
- Ikke godkendt til løft

Art. No.	MBL ton	Dimensions - mm				Weight kg/100m
		Size	Dim. D	Dim. C	Dim. B	
08 15 0001	0,13	2	2	12	8	4,85
08 15 0002	0,28	3	3	16	11	16,5
08 15 0003	0,60	4	4	16	14	32,0
08 15 0004	1,00	5	5	18,5	17	50,0
08 15 0008	1,40	6	6	18,5	20	75,0
08 15 0006	2,50	8	8	24	26	135
08 15 0007	4,00	10	10	28	34	225
08 15 0008	6,40	13	13	36	44	380



Chain - Long linked AISI 316

- DIN 763
- Stainless steel
- Not approved for lifting

Kæde - Langeddet AISI 316

- DIN 763
- Rustfrit stål
- Ikke godkendt til løft

Art. No.	MBL ton	Dimensions - mm				Weight kg/100m
		Size	Dim. D	Dim. C	Dim. B	
08 14 0001	0,13	2	2	22	8	6,10
08 14 0002	0,28	3	3	26	12	15,0
08 14 0003	0,60	4	4	32	16	27,0
08 14 0004	1,00	5	5	36	20	43,0
08 14 0005	1,40	6	6	42	24	63,0
08 14 0006	2,50	8	8	54	32	110,0
08 14 0007	4,00	10	10	66	40	175,0
08 14 0008	6,40	13	13	82	50	295,0

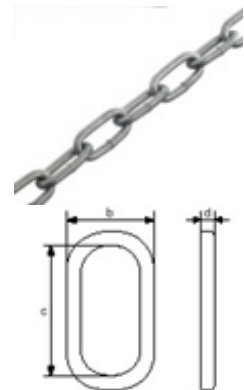



LIFTING COMPONENTS GRADE 8:

Master link

Art. No.	Model	WLL ton*	Dimensions - mm			Weight appr. kg
			A	B	D	
02 01 0001	ML-7/6-8	1,6	110	60	13	0,34
02 01 0002	ML-8/7-8	2,12	110	60	16	0,54
02 01 0003	ML-10/8-8	3,15	135	75	18	0,82
02 01 0004	ML-13/10-8	5,3	160	90	22	1,5
02 01 0005	ML-16/13-8	8	180	100	26	2,3
02 01 0006	ML-18/16-8	11,2	200	110	32	3,95
02 01 0007	ML-20/18-8	14	260	140	36	6,34
02 01 0008	ML-22/20-8	17	300	160	40	8,96
02 01 0009	ML-26/22-8	21,2	340	180	45	12,8
02 01 0010	ML-32/26-8	31,5	350	190	50	16,55
02 01 0011	ML-36/32-8	45	400	200	56	23,28

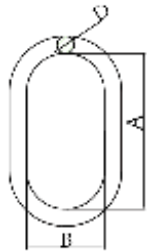

LØFTEKOMPONENTER KLASSE 8:

Ovalring

Master link assembly

Art. No.	Model	WLL ton*	Dimensions - mm							Weight appr. kg
			A	B	D	a	b	d	s	
02 02 0001	MLA-6-8	2,4	100	60	14	85	40	12	6	0,82
02 02 0002	MLA-7-8	3,2	160	90	18	100	60	14	7,6	1,60
02 02 0003	MLA-8-8	4,2	160	90	20	100	60	14	7,6	1,95
02 02 0004	MLA-10-8	8	180	100	22	150	70	18	8,4	3,16
02 02 0005	MLA-13-8	12	270	140	28	160	90	22	13,5	6,75
02 02 0006	MLA-16-8	17	270	140	32	180	100	25	16	9,31
02 02 0007	MLA-19-8	25	300	160	40	270	140	31	19	18,40
02 02 0008	MA-22-8	31,5	340	180	45	285	155	36	22	26,60
02 02 0009	MA-26-8	40	350	190	51	340	180	45	25	42,91

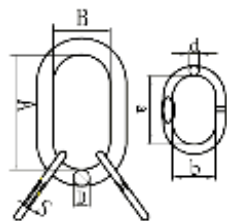

Garniturering

Master link - HD XL

Art. No.	MBL ton	WLL ton*	Dimensions - mm			Weight kg
			A	B	C	
04 28 0010	525	105	80	450	250	62
04 28 0011	655	131	90	460	300	75
04 28 0012	785	157	100	500	300	103
04 28 0013	1250	250	115	600	400	190
04 28 0014	1500	300	115	600	300	154
04 28 0015	2000	400	115	700	250	166



Ovalring - HD XL

*Safety factor 4:1

*Sikkerhedsfaktor 4:1

Master link assembly - HD XL

Garniture ring - HD XL

Art. No.	WLL ton*	Dimensions - mm						Weight kg
		D	L	B	d	l	b	
04 29 0001	70	68	460	220	68	430	300	117
04 29 0002	100	80	500	250	80	460	330	178
04 29 0003	125	90	560	270	90	500	330	249
04 29 0004	175	100	600	270	100	560	330	330
04 29 0005	250	115	600	400	115	600	400	505
04 29 0006	300	115	600	300	115	600	400	492

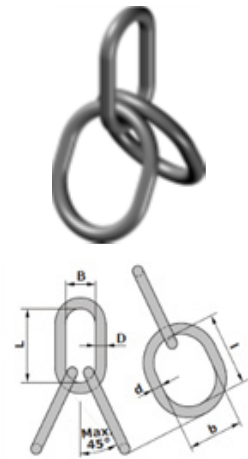

Connection link

Samleled

Art. No.	Model	WLL ton*	Dimensions - mm						Weight appr. kg
			Chain size	A	B	L	K	H	
02 04 0001	CL-6-8	1,12	6	15	7,5	58	42	7	0,08
02 04 0002	CL-7/8-8	2,0	7,8	18	9,5	79,5	60,5	8,5	0,146
02 04 0003	CL-10-8	3,15	10	25	12	90,5	68	11,5	0,3
02 04 0004	CL-13-8	5,3	13	29	15	117	87	15	0,65
02 04 0005	CL-16-8	8,0	16	34,5	19,8	148	108,4	19,8	1,15
02 04 0006	CL-20-8	12,5	19	41	24	169,5	121,5	24	2,1
02 04 0007	CL-22-8	15,0	22	48	26	193,5	141,5	26	2,87
02 04 0008	CL-26-8	21,2	26	57,5	31	220	158	30	4,5
02 04 0009	CL-32-8	31,5	32	67	38	281	205	37	8,21



Half link (incl. Locking set)

Halvt samleled (inkl. Låse sæt)

Art. No.	Model	WLL ton*	Dimensions - mm				Weight aapr. kg
			L	B	G	E	
02 19 0001	HCL-7/8-8	2,0	28	18	9	22	0,094
02 19 0002	HCL-10-8	3,15	34	25	12	26	0,182
02 19 0003	HCL-13-8	5,3	44	29	15	33	0,393
02 19 0004	HCL-16-8	8,0	52	36	19	40	0,675
02 19 0005	HCL-18/20-8	12,5	63	43	22	48	1,084
02 19 0006	HCL-22-8	15,5	76	50	24	60	1,745
02 19 0007	HCL-26-8	21,6	80	58	29	61	2,843
02 19 0008	HCL-32-8	32	100	70	36	78	5,317

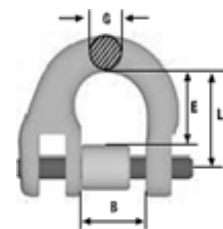

Roundsling coupling

Rundslingskobling

Art. No.	Model	WLL ton*	Dimensions - mm						Weight appr. kg
			A	B	K	W	G	E	
02 18 0001	RCL-7/8-8	2,0	20	61,5	63,7	40	24	9,5	0,30
02 18 0002	RCL-10-8	3,15	24	66	83	39	30,5	11	0,68
02 18 0003	RCL-13-8	5,3	28	88	93,7	55	36,8	16,5	1,47
02 18 0004	RCL-16-8	8,0	34,5	108	120	65,5	45,2	19,8	2,30
02 18 0005	RCL-18/20-8	12,5	41	129	138	80	51,8	23	3,30
02 18 0006	RCL-22-8	15	50	191	180	126	70	26	6,89
02 18 0007	RCL-26-8	21,2	58	228,4	209,5	152	86	30	10,62

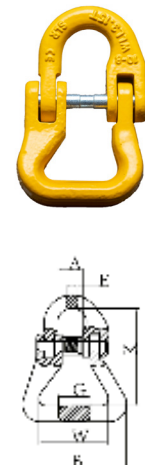

*Safety factor 4:1

*Sikkerhedsfaktor 4:1



Clevis safety hook

Art. No.	Model	WLL ton*	Dimensions - mm							Weight appr. kg
			Chain size	L	L1	A	B	E	E1	
02 05 0101	CSH-06-8	1,12	6	131	96	8	32	35	28	0,44
02 05 0102	CSH-7/8-8	2,0	7,8	161,8	119,3	9,5	38,5	40	35,8	0,80
02 05 0103	CSH-10-8	3,15	10	195	142	12,5	46	50	45	1,38
02 05 0104	CSH-13-8	5,3	13	249	179	15	59	60	52,5	2,81
02 05 0105	CSH-16-8	8,0	16	310	224,8	18,5	77	65	63,3	6,0
02 05 0106	CSH-20-8	12,5	19	335	238,3	25	77	80	86	7,25
02 05 0107	CSH-22-8	15,0	22	392	277	25	97,5	83	76	12,8
02 05 0108	CSH-26-8	21,2	26	450	312	30	118	106	96	21,8
02 05 0109	CSH-32-8	31,5	32	589,6	416	35	150	140	135	49,6

Gaffel sikkerhedskrog

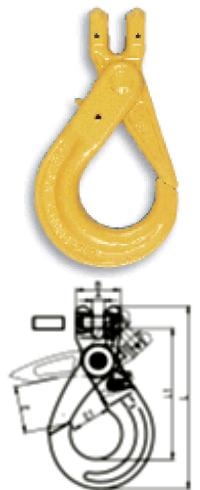

Eye safety hook

Art. No.	Model	WLL ton*	Dimensions - mm						Weight appr. kg
			Chain size	Ø	E	E1	L1	L	
02 05 0001	SH-6-8	1,12	6	21	35	28	110	140	0,50
02 05 0002	SH-7/8-8	2,0	7,8	25	40	35	136	175	0,88
02 05 0003	SH-10-8	3,15	10	34,5	48	45	168	213	1,58
02 05 0004	SH-13-8	5,3	13	40	65	52,5	207	268	3,00
02 05 0005	SH-16-8	8,0	16	50	65	63	254	332	5,90
02 05 0006	SH-20-8	12,5	19	64,5	85	85	278	360	7,00
02 05 0007	SH-22-8	15,0	22	72	80	76	319	415	12,3
02 05 0008	SH-26-8	21,2	26	80	120	96	362	472	20,0
02 05 0009	SH-32-8	31,5	32	105	140	133	470	614	44,0

Sikkerhedskrog m. øje

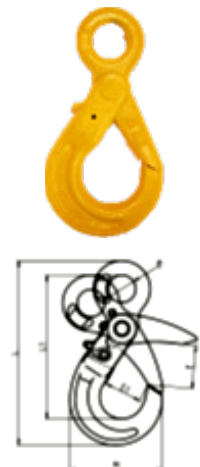

Swivel safety hook

Art. No.	Model	WLL ton*	Dimensions - mm							Weight appr. kg
			Chain size	A	B	E	E1	L1	L	
02 08 0001	SSH-6-8	1,12	6	32,5	24	35	28	152,5	184	0,71
02 08 0002	SSH-7/8-8	2,0	7,8	36	29,5	40	35,8	189	228	1,15
02 08 0003	SSH-10-8	3,15	10	42	35	50	48	224	270	1,86
02 08 0004	SSH-13-8	5,3	13	50	41	60	52,5	267	324	3,51
02 08 0005	SSH-16-8	8,0	16	61	56,8	65	63,3	355,6	406	7,33
02 08 0006	SSH-20-8	12,5	19	72	63	80	86	378,2	460,5	10,3
02 08 0007	SSH-22-8	15	22	97	98	83	76	466	564	17,5
02 08 0008	SSH-26-8	21,2	26	123	115	106	96	544	661	23,0
02 08 0009	SSH-32-8	31,5	32	140	146	140	135	679	892	81,0

Sikkerhedskrog m. Svirvel

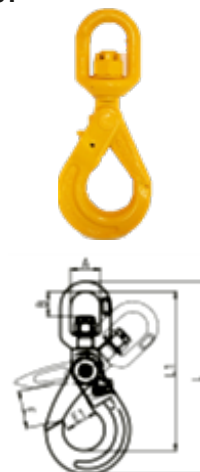

*Safety factor 4:1

*Sikkerhedsfaktor 4:1



Clevis sling hook w. Latch

Gaffel lastkrog m. Pal

Art. No.	Model	WLL ton*	Dimensions - mm							Weight appr. kg
			Chain size	A	B	D	H	L	E	
02 07 0001	GSH-06-8	1,12	6	8	32	35	23	76	26	0,32
02 07 0002	GSH-7/8-8	2,0	7,8	9,5	37	37	32,5	85,5	29	0,48
02 07 0003	GSH-10-8	3,15	10	13	49	46	35	104	39	0,95
02 07 0004	GSH-13-8	5,3	13	16,5	56,5	56	42,5	128	47	1,80
02 07 0005	GSH-16-8	8	16	21,5	70,5	60	54	150	55	3,40
02 07 0006	GSH-20-8	12,5	19	24	77	79	58	180	61	6,00
02 07 0007	GSH-22	15	22	27	91	101	62	213	72	10,4
02 07 0008	GSH-26	21,2	26	30	117	115	75	250	85	14,5
02 07 0009	GSH-32	31,5	32	35	150	140	88	317	106	27,0



Eye sling hook w. Latch

Lastkrog m. Pal

Art. No.	Model	WLL ton*	Dimensions - mm						Weight appr. kg
			Chain size	B	E	D	A	L	
02 06 0001	ESH-6-8	1,12	6	9	24	21	20	108	0,32
02 06 0002	ESH-7/8-8	2,0	7,8	11	30	26	25	133	0,48
02 06 0003	ESH-10-8	3,15	10	15	34	39	38	167	0,95
02 06 0004	ESH-13-8	5,3	13	19	39	54	43	213	1,80
02 06 0005	ESH-16-8	8,0	16	23	46	64	50	255	3,40
02 06 0006	ESH-20-8	12,5	19	24	48	80,4	63	305	6,00
02 06 0007	ESH-22-8	15	22	32	71	100	62	348	10,4
02 06 0008	ESH-26-8	21,2	26	35	81	82	64	394	14,5
02 06 0009	ESH-32-8	31,5	32	37	102	112	88	480	27,0



Swivel hook w. Latch

Svirvelkrog m. Pal

Art. No.	Model	WLL ton*	Dimensions - mm								Weight appr. kg
			Chain size	A	E	B	H	K	L	M	
02 09 0001	SLH-6-8	1,12	6	32	22	17	9	109	137	16	0,34
02 09 0002	SLH-7/8-8	2,0	7,8	42	21,5	35	15,8	150	192	21	1,02
02 09 0003	SLH-10-8	3,15	10	42,5	26	35	15,8	162,5	208,5	23	1,24
02 09 0004	SLH-13-8	5,3	13	48	32,5	39	18	191	246	31	3,60
02 09 0005	SLH-16-8	8,0	16	620	43	53	25	243,5	313	34	4,66
02 09 0006	SLH-20-8	12,5	19	68	49,5	51	28,5	276,5	363,5	41,5	7,40
02 09 0007	SLH-22-8	15	22	79	54,5	65	32	332	431	55,7	10,6
02 09 0008	SLH-26-8	21,2	26	105	81	114	40	429,5	545,5	70	21,4
02 09 0009	SLH-32-8	31,5	32	105	100	96	40	465,3	596	76,2	32,0

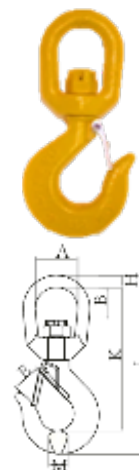

*Safety factor 4:1

*Sikkerhedsfaktor 4:1



Foundry hook

Støberikrog

Art. No.	Model	WLL ton*	Dimensions - mm							Weight appr. kg
			Chain size	L	B	E	F	G	H	
02 10 0001	FH-6-8	1,12	6	102,7	49	20,5	26	17	19	0,382
02 10 0002	FH-7/8-8	2,0	7,8	120,5	62	24	22	19	26	0,72
02 10 0003	FH-10-8	3,2	10	153,2	73	31,5	19	25	31	1,25
02 10 0004	FH-13-8	5,3	13	184	90	44	15	33	38,5	2,32
02 10 0005	FH-16-8	8,0	16	216	105	49	12	37	41	3,45
02 10 0006	FH-20-8	12,5	19	247	114	60	10	46	57	6,42

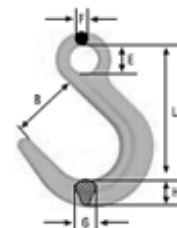

Clevis grab hook

Gaffel opkorterkrög

Art. No.	Model	WLL ton*	Dimensions - mm				Weight appr. kg
			Chain size	M	E	F	
02 11 0101	CGH-6-8	1,12	6	8	13	8	0,25
02 11 0102	CGH-7/8-8	2,0	7,8	11	16	9,5	0,4
02 11 0103	CGH-10-8	3,15	10	13	20	12	0,6
02 11 0104	CGH-13-8	5,3	13	16	25	15	1,2
02 11 0105	CGH-16-8	8,0	16	20	28,5	19	2,7
02 11 0106	CGH-20-8	12,5	19	25	36	20	4,3
02 11 0107	CGH-22-8	15,0	22	26	42	27	6,4

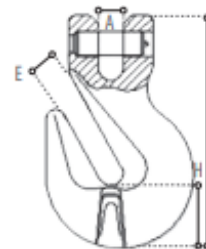

NB Optional we have a model with pin

NB Som option har vi en model med pin

Grab hook

Opkorterkrög

Art. No.	Model	WLL ton*	Dimensions - mm				Weight appr. kg
			Chain size	B	E	F	
02 11 0001	EGH-6-8	1,12	6	8	13	8	0,25
02 11 0002	EGH-7/8-8	2,0	7,8	11	16	9,5	0,4
02 11 0003	EGH-10-8	3,15	10	13	20	12	0,6
02 11 0004	EGH-13-8	5,3	13	16	25	15	1,2
02 11 0005	EGH-16-8	8,0	16	20	28,5	19	2,7
02 11 0006	EGH-20-8	12,5	19	25	36	20	4,3
02 11 0007	EGH-22-8	15,0	22	26	42	27	6,4

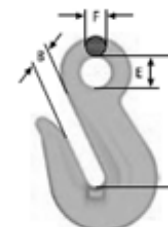

NB Optional we have a model with pin

NB Som option har vi en model med pin

Container hook

Containerkrög

Art. No.	Model	WLL ton*	Dimensions - mm					Weight appr. kg
			Chain size	L	B	E	F	
02 12 0001	SCH-3	12,5	187	70	46	47	75	3,8
02 12 0002	SCH-3 Turned 45° left	12,5	187	70	46	47	75	3,8
02 12 0003	SCH-3 Turned 45° right	12,5	187	70	46	47	75	3,8

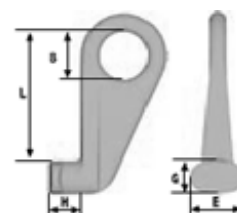

*Safety factor 4:1

*Sikkerhedsfaktor 4:1



Weld-on hook

Gravemaskinekrog

Art. No.	Model	WLL ton*	Dimensions - mm							Weight appr. kg
			B	C	E	H	M	P	L	
02 13 0001	WOH-2	2,0	92	67	30	81	23,3	34	114	0,83
02 13 0002	WOH-3	3,0	106	73,5	33,2	116	33,6	36	129	1,20
02 13 0003	WOH-5	5,0	133	94	35	159	44	43,5	171	2,46
02 13 0004	WOH-8	8,0	136,5	94	33,31	159	44	51	177	3,26
02 13 0005	WOH-10	10,0	169,5	134,5	50,54	194	54,7	53	223	5,17

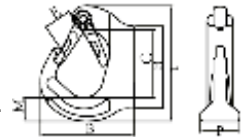

Weldable lifting point

Transportring til svejsning

Art. No.	Model	WLL ton*	Dimensions - mm				Weight appr. kg
			B	D	G	L	
02 14 0001	WLP-1,12T	1,12	35,5	13	29,5	40	0,385
02 14 0002	WLP-2T	2,0	40	14	32	47,5	0,47
02 14 0003	WLP-3,15T	3,15	43,5	17	35	48	0,69
02 14 0004	WLP-5,3T	5,3	50	22	46	56	1,46
02 14 0005	WLP-8T	8,0	66,5	26,5	51	69	2,5
02 14 0006	WLP-15T	15,0	90	34	67	94	5,79

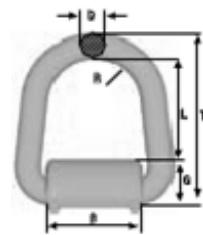

Can be supplied with or without spring, for stay up function

Kan leveres med eller uden fjeder, for at holde oprejst funktion

Pear shape master link (closed)

Pæreformet ovalring (lukket)

Art. No.	Model	WLL ton*	Dimensions - mm						Weight appr. kg
			Chain size	H	K	L	T	W	
02 15 0001	SKG-7/8-8	2,0	7,8	15	100	78	15	50	0,3
02 15 0002	SKG-10-8	3,15	10	19	127	101	19	65	0,7
02 15 0003	SKG-13-8	5,30	13	22	145	113	23	72	1,1
02 15 0004	SKG-16-8	8,00	16	26	174	137	25	80	1,7
02 15 0005	SKG-18/20-8	12,50	18,20	36	202	165	31	104	3,0

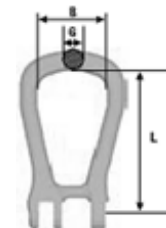

Pear shape master link (Open)

Pæreformet ovalring (Åben)

Art. No.	Model	WLL ton*	Dimensions - mm						Weight appr. kg
			Chain size	A	H	K	T	W	
02 16 0001	SKO-7/8-8	2,0	7,8	15	15	100	15	50	0,3
02 16 0002	SKO-10-8	3,15	10	19	19	127	19	66	0,6
02 16 0003	SKO-13-8	5,30	13	25	22	145	23	72	1,0
02 16 0004	SKO-16-8	8,00	16	30	26	174	25	80	1,6
02 16 0005	SKO-18/20-8	12,50	18,20	36	36	202	31	104	2,8

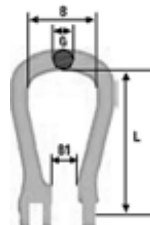

*Safety factor 4:1

*Sikkerhedsfaktor 4:1



DV hook

- Safety factor 5:1

Art. No.	Model	WLL ton	Dimensions - mm					Weight appr. kg
			B	E	H	L	Ø	
02 20 0001	DV1,5	1,5	61	3	35	102	28	0,50
02 20 0002	DV3	3	72	3	41	119	30	0,73
02 20 0003	DV5	5	84,5	3	42	137	35	1,20
02 20 0004	DV8	8	96	3	42	153	42	1,60

DV krog

- Sikkerhedsfaktor 5:1

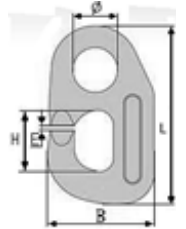

ROV eye sling hook

- High tensile steel
- Safety factor 4:1
- Painted white

Art. No.	WLL ton	Dimensions - mm									Weight kg
		A	D	d	E	H	K	P	R	T	
04 39 0001	3.0	32	25	15	20	29	122	25	8	24	1.0
04 39 0002	5.0	40	31	18	20	37	149	31	8	31	2.1
04 39 0003	7.0	51	39	24	20	46	192	39	8	37	4.0
04 39 0004	11.0	62	57	28	30	58	232	57	8	48	7.0
04 39 0005	15.0	72	62	32	30	66	256	62	8	56	9.4
04 39 0006	22.0	90	81	40	50	77	318	81	10	68	18.6
04 39 0007	30.0	90	83	45	50	92	357	83	10	76	31.2

ROV lastkrog med øje

- Højstyrkestål
- Sikkerhedsfaktor 4:1
- Hvid malet

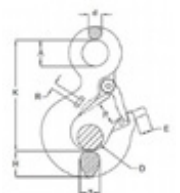
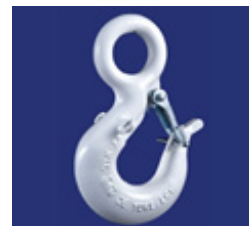

Slip hook

- Blue painted / galvanized

Art. No.	Size	WLL ton	Dimensions - mm			Weight kg
			A	B	C	
04 38 0001	6"	1.0	165	18	32	0.84
04 38 0002	10"	1.5	254	19	48	2.05
04 38 0003	12"	2.8	320	27	49	3.85
04 38 0004	14"	4.8	350	27	50	5.75
04 38 0005	15"	7.0	385	36	40	9.61
04 38 0006	16"	11.0	385	36	64	17.80
04 38 0007	16"	14.0	400	42x46	65	19.50

Slipkrog

- Blå malet / galvaniseret



To order the galvanized version please state: Art. No. + G

For at bestille den galvaniseret version, oplys da: Art. No. + G



Quick release hook - RAM H44-3

- Carbon steel

Udløserkrog - RAM H44-3

- Kulstofstål



Art. No.	Model	WLL ton*	Dimensions - mm							Weight appr. kg
			A	B	C	D	E	F	G	
04 60 0001	H44-3	2	155,2	118,8	22,8	84	23,8	38,1	25,4	0,9

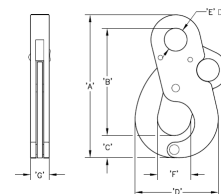

Barrel sling

- 1- & 2-legged model
- For lifting steel barrels and drums
- Safety factor 4:1

Tønde sling

- 1- & 2-Grenet model
- Til løft af stål tromler og tønder
- Sikkerheds faktor 4:1

Art. No.	Model	WLL ton	Weight kg
02 24 0001	1-Legged for 1 Barrel / Drum	1	4
02 24 0002	2-Legged for 2 Barrels / Drums	2	8





LIFTING COMPONENTS GRADE 10:

LØFTEKOMPONENTER KLASSE 10:

Master link

Ovalring

Art. No.	Model	WLL ton*	Dimensions - mm			Weight appr. kg
			A	B	D	
03 17 0101	ML-8/6-10	2,50	120	70	14	0,40
03 17 0103	ML-10/8-10	4,00	140	80	17	0,70
03 17 0104	ML-13/10-10	7,50	160	95	22	1,50
03 17 0105	ML-16/13-10	10,00	190	110	25	2,20
03 17 0106	ML-20/18-10	17,00	240	140	34	5,10
03 17 0107	ML-22/20-10	25,00	250	150	38	7,20

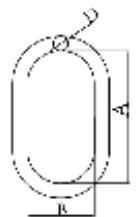

Master link assembly

Garniturering

Art. No.	Model	WLL ton*	Dimensions - mm						Weight appr. kg
			A	B	D	a	b	d	
03 19 0101	MLA-6-10	3,50	150	90	19	120	70	14	1,8
03 19 0103	MLA-8-10	5,00	160	95	22	140	80	17	3
03 19 0104	MLA-10-10	11,5	200	120	30	160	95	22	6,5
03 19 0105	MLA-13-10	17	250	150	40	190	110	25	15
03 19 0106	MLA-16-10	28	300	200	50	200	120	32	23

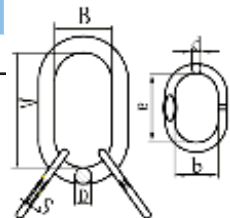

*Safety factor 4:1

*Sikkerhedsfaktor 4:1



Coupling link

Samleled

Art. No.	Model	WLL ton*	Dimensions - mm					Weight appr. kg
			Chain size	A	L	K	H	
03 16 0102	CL-8-10	2,5	8	18,5	84,5	61,5	10,0	0,22
03 16 0103	CL-10-10	4,0	10	23,0	97,2	72,0	12,6	0,45
03 16 0104	CL-13-10	6,7	13	27,5	127,0	89,0	16,8	1,15
03 16 0105	CL-16-10	10,0	16	33,5	145,0	103,0	21,0	1,75



Clevis safety hook

Gaffel sikkerhedskrog

Art. No.	Model	WLL ton*	Dimensions - mm							Weight appr. kg
			A	B	E	∅	H	K	L	
03 30 0102	CSH-8-10	2,5	9,5	37,5	35,0	45,0	21,0	138,0	12,0	0,75
03 30 0103	CSH-10-10	4,0	12,5	47,5	46,0	56,0	30,5	169,0	15,0	1,42
03 30 0104	CSH-13-10	6,7	15,0	52,0	56,0	64,0	39,0	205,0	20,0	2,56
30 30 0105	CSH-16-10	10,0	18,5	67,5	86,0	86,0	45,0	250,0	27,0	4,21

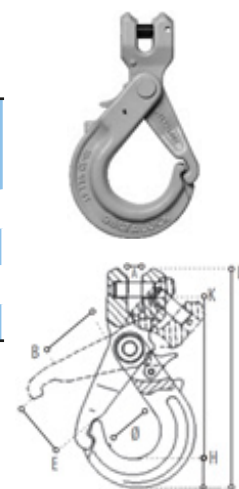

Eye safety hook

Sikkerhedskrog m. øje

Art. No.	Model	WLL ton*	Dimensions - mm						Weight appr. kg
			B	E	∅	H	K	L	
03 34 0102	SH-8-10	2,5	37,5	35,0	45,0	21,0	138,0	12,0	0,81
03 34 0103	SH-10-10	4,0	47,5	46,0	56,0	30,5	169,0	15,0	1,41
03 34 0104	SH-13-10	6,7	52,0	56,0	64,0	39,0	205,0	20,0	2,61
03 34 0105	SH-16-10	10,0	67,5	64,0	77,0	45,0	250,0	27,0	4,45



Swivel safety hook

Sikkerhedskrog m. Svirvel

Art. No.	Model	WLL ton*	Dimensions - mm						Weight appr. kg
			B	C	D	L	T	E	
03 37 0102	SSH-8-10	2,5	36,0	29,0	13,0	214,0	37,0	32,0	1,03
03 37 0103	SSH-10-10	4,0	42,0	39,0	15,5	264,0	47,5	46,0	1,80
03 37 0104	SSH-13-10	6,7	49,0	46,0	19,0	334,0	52,5	56,0	3,34
03 37 0105	SSH-16-10	10,0	60,0	69,0	23,0	400,0	70,0	91,0	5,83



*Safety factor 4:1

*Sikkerhedsfaktor 4:1



Clevis sling hook w. Latch

Art. No.	Model	WLL ton*	Dimensions - mm					Weight appr. kg
			A	B	E	M	L	
03 29 0102	GSH-8-10	2,5	9,5	37,0	25,0	88,0	134,0	0,70
03 29 0103	GSH-10-10	4,0	12,0	48,0	28,0	105,5	161,5	1,30
03 29 0104	GSH-13-10	6,7	15,0	59,0	38,0	134,0	203,0	2,30
03 29 0105	GSH-16-10	10,0	17,5	70,0	44,0	160,5	248,0	3,60

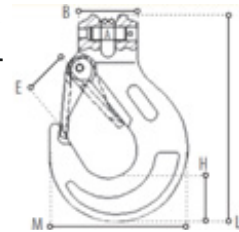

Eye sling hook w. Latch

Art. No.	Model	WLL ton*	Dimensions - mm					Weight appr. kg
			D	E	H	∅	L	
03 33 0102	ESH-8-10	2,5	11,0	25,0	27,5	25,0	137,5	0,60
03 33 0103	ESH-10-10	4,0	16,0	28,0	33,0	34,0	171,5	1,20
03 33 0104	ESH-13-10	6,7	19,0	38,0	43,5	43,0	219,0	2,20
03 33 0105	ESH-16-10	10,0	24,5	44,0	50,0	50,0	260,0	3,50

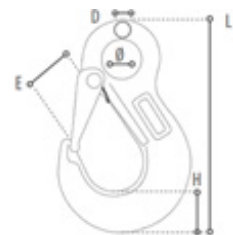

Grab hook

Art. No.	Model	WLL ton*	Dimensions - mm					Weight appr. kg
			E	∅	∅D	M	L	
03 40 0101	EGH-8-10	2,5	11	17,5	37	53	93	0,3
03 40 0102	EGH-10-10	4	13,5	22	48,5	74	129	0,79
03 40 0103	EGH-13-8	6,7	16,5	28	59	96	166	1,67
03 40 0104	EGH-16-8	10	19	36	75	116	186	2,74

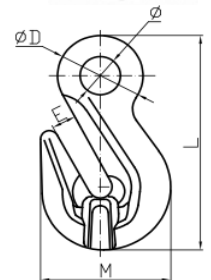

Roundsling hook

Art. No.	Model	WLL ton*	Dimensions - mm						Weight kg
			B	E	G	L	H	M	
03 44 1001	RH-1-10	1	24	35	16,6	84	19	8	0,4
03 44 1002	RH-2-10	2	28	40	17	96	22	10	0,8
03 44 1003	RH-3-10	3	33	47	24	117	30	12	1,4
03 44 1004	RH-5-10	5	43	73	27	155	36	16,5	3,4



Gaffellastkrog m. Pal

Lastkrog m. Pal

Opkorterkrög

Rundslingskrög

*Safety factor 4:1

*Sikkerhedsfaktor 4:1



Safe locking hook
 - with eye grip

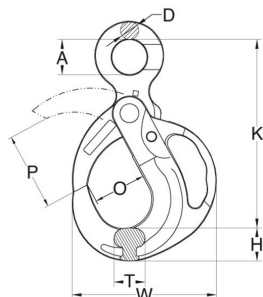

Sikkerhedskrog -
 med udløser håndtag

Art. No.	Model	WLL ton*	Dimensions - mm								Weight kg
			K	W	P	O	A	T	D	H	
04 63 0001	SHEG-10	4,0	175	139	71	49	32	27	13	31	1,9
04 63 0002	SHEG-13	6,7	227	174	80	57	40	34	16	39	3,0
04 63 0003	SHEG-16	10,0	277	212	114	78	50	39	21	47	6,3
04 63 0004	SHEG-20	16,0	329	250	127	91	60	54	23	56	11,7
04 63 0005	SHEG-22	20,0	350	260	151	105	70	56	24	59	14,5

Swivel safe locking hook
 - with eye grip

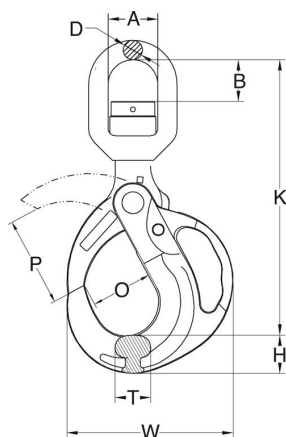

Svirvel sikkerhedskrog
 - med udløser håndtag

Art. No.	Model	WLL ton*	Dimensions - mm									Weight kg
			K	W	P	O	A	B	T	D	H	
04 64 0001	SHG-10	4,0	225	139	71	49	41	34	27	16	31	2,4
04 64 0002	SHG-13	6,7	285	174	80	57	46	44	34	21	39	5,2
04 64 0003	SHG-16	10,0	345	212	114	78	61	50	39	23	47	8,4
04 64 0004	SHG-20	16,0	433	250	127	91	74	82	54	25	56	14,5
04 64 0005	SHG-22	20,0	475	260	151	105	97	95	56	33	59	19,9



Lifting chains & accessories - grade 8 & 10
Løftekæder & tilbehør - klasse 8 & 10

2

GUNNEBO GRABIQ
LIFTING EQUIPMENT

GUNNEBO GRABIQ
LØFTEUDSTYR



GUNNEBO GRABIQ
LIFTING COMPONENTS:

GRABIQ Chainslings

When ordering please advise chain dimension and length of chain per lag
 NB - Other combinations on request

GUNNEBO GRABIQ
LØFTEKOMPONENTER:

GRABIQ Kædesling

Ved bestilling oplys venligst kæde dimension og længde kæde per ben.
 NB - Andre kombinationer på forespørgsel

Type: MG1-EGKN



Type MG1-GBK



TG1-EGKN



TG1-GBK



MG2-EGKN



MG2-GBK



TG2-EGKN



TG2-GBK



TG3-EGKN



TG3-GBK



TG4-EGKN



TG4-GBK



MG2-CL

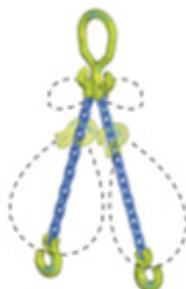

*Safety factor 4:1

*Sikkerhedsfaktor 4:1



GRABIQ Master link

- For 1-, 2-, 3- & 4-leg slings

Art. No.	Model	WLL ton*	For chain size, mm			Dimensions - mm			Weight kg
			1-leg	2-leg	3- & 4- leg	L	E	D	
03 17 0001	MF-86-10	2,5	6,8	6	-	125	70	14	0,4
03 17 0002	MF-108-10	4	10	8	6	140	80	17	0,8
03 17 0003	MF-1310-10	7,5	13	10	8	160	95	22	1,5
03 17 0004	MF-1613-10	10	16	13	10	190	110	28	2,8
03 17 0005	MF-2016-10	17	20	16	13	240	140	34	5,3
03 17 0006	MF-2220-10	25	22	20	16	250	150	40	7,8

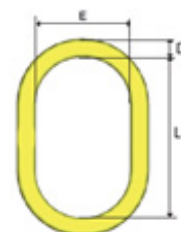

GRABIQ Ovalring

- Til 1-, 2-, 3- & 4-Strengt

GRABIQ Master link

- Designed for crane hooks, DIN 15401

Art. No.	Model	WLL ton*	For chain size, mm			Dimensions - mm			Weight kg
			1-leg	2-leg	3- & 4- leg	L	E	D	
03 18 0001	MFH-1310-10	7,5	13	10	8	230	125	22	2,1
03 18 0002	MFH-1613-10	10	16	13	10	250	135	28	3,7
03 18 0003	MFH-2016-10	17	20	16	13	280	135	32	5,3
03 18 0004	MFH-2220-10	28	26	20	16	320	175	40	9,8



GRABIQ Ovalring

- Designet til kran kroge, DIN 15401

GRABIQ Master link assembly

- Designed for use with chain or wire rope
- For 3- and 4-leg slings

Art. No.	Model	WLL ton*	Dimensions - mm							Weight kg
			L1	L	E	D	l	e	d	
03 19 0001	MT-6-10	3,5	270	150	90	19	125	70	14	1,9
03 19 0002	MT-8-10	5,2	300	160	95	22	140	80	17	3
03 19 0003	MT-10-10	11,5	360	200	120	30	160	95	22	6,4
03 19 0004	MT-13-10	17	440	250	150	40	190	110	28	13,6
03 19 0005	MT-16-10	28	500	300	200	50	200	120	32	22,8
03 19 0006	MT-20-10	35	550	300	200	55	250	150	40	33,5
03 19 0007	MT-22-10	53	610	350	200	60	260	140	45	44,5
03 19 0008	MT-26-10	70	730	450	250	70	280	160	50	69
03 19 0009	MT-32-10	90	730	450	260	80	280	160	55	89,5

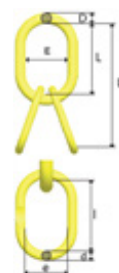

GRABIQ garniturering

- Designet til brug med kæde eller wire
- Til 3- og 4-strengt sæt

*Safety factor 4:1

*Sikkerhedsfaktor 4:1



GRABIQ Connection link

GRABIQ Samleled

Art. No.	Model	WLL ton*	Dimensions - mm				Weight kg
			L	B	F	C	
03 16 0001	G-6-10	1,5	45	15	8	16	0,1
03 16 0002	G-8-10	2,6	56	18	9	22	0,2
03 16 0003	G-10-10	4	68	25	12	26	0,3
03 16 0004	G-13-10	6,8	89	29	15	33	0,8
03 16 0005	G-16-10	10,3	106	36	19	40	1,4
03 16 0006	G-20-10	16	125	43	23	44	2,7
03 16 0007	G-22-10	20	152	50	26	59	3,6
03 16 0008	G-26-10	27,3	161	58	32	61	5,7
03 16 0009	G-32-10	40	200	70	38	77	9,5

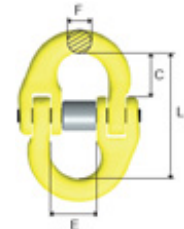

GRABIQ Master grab

- All-in-one compact top link

GRABIQ Topkrog enkelt

- Til 1-strengt kædesæt

Art. No.	Model	WLL ton*	Dimensions - mm				Weight kg
			L	A	E	H	
03 23 0001	MG-6-10	1,5	145	88	60	15	0,5
03 23 0002	MG-8-10	2,6	171	92	60	18	1
03 23 0003	MG-10-10	4	211	113	75	22	1,9
03 23 0004	MG-13-10	6,8	261	138	90	26	3,6
03 23 0005	MG-16-10	10,3	311	157	105	31	6



GRABIQ Master grab duo

- All-in-one compact top link for 2-leg slings
- Max degree angel = 45°

GRABIQ Topkrog dobbelt

- Til 2-strengt kædesæt
- Max vinkel = 45°

Art. No.	Model	WLL ton*	Dimensions - mm				Weight kg
			L	A	E	H	
03 24 0001	MGD-6-10	2,1	144	90	60	17	0,7
03 24 0002	MGD-8-10	3,5	171	100	75	21	1,4
03 24 0003	MGD-10-10	5,6	211	124	90	24	2,4
03 24 0004	MGD-13-10	9,5	262	149	105	31	4,8
03 24 0005	MGD-16-10	14	310	175	120	35	8,2



*Safety factor 4:1

*Sikkerhedsfaktor 4:1



GRABIQ C-loc

- For use with master links

Art. No.	Model	WLL ton*	Dimensions - mm				Weight kg
			L	B	E	H	
03 25 0001	CL-6-10	1,5	43	11	24	18	0,2
03 25 0002	CL-8-10	2,6	58	12	32	24	0,5
03 25 0003	CL-10-10	4	74	15	40	29	1,0
03 25 0004	CL-13-10	6,8	94	18	52	38	2,1
03 25 0005	CL-16-10	10,3	119	22	64	48	3,7

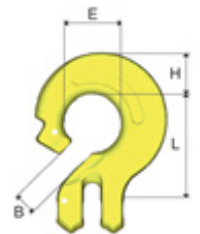

GRABIQ Topkrog enkelt

- Til brug med ovalring

GRABIQ C-loc duo

- For use with master links

Art. No.	Model	WLL ton*	Dimensions - mm				Weight kg
			L	B	E	H	
03 26 0001	CLD-6-10	2,1	43	11	24	22	0,4
03 26 0002	CLD-8-10	3,5	58	12	32	29	0,7
03 26 0003	CLD-10-10	5,6	74	15	40	37	1,4
03 26 0004	CLD-13-10	9,5	94	18	52	46	2,7
03 26 0005	CLD-16-10	14	119	25	64	57	5,4

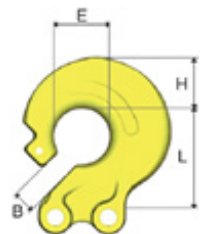

GRABIQ Topkrog dobbelt

- Til brug med ovalring

GRABIQ C-Grab

- For use with master link

Art. No.	Model	WLL ton*	Dimensions - mm				Weight kg
			L	B	E	H	
03 27 0001	CG-6-10	1,5	80	11	24	19	0,4
03 27 0002	CG-8-10	2,6	107	12	32	24	0,8
03 27 0003	CG-10-10	4	134	15	40	29	1,6
03 27 0004	CG-13-10	6,8	172	18	52	38	3,3
03 27 0005	CG-16-10	10,3	215	22	64	47	6,1



GRABIQ Topkrog enkelt

- Til brug med ovalringe

*Safety factor 4:1

*Sikkerhedsfaktor 4:1



GRABIQ C-Grab duo

- For use with master link
- Max angle = 45°

GRABIQ Topkrog dobbelt

- Til brug med ovalring
- Max vinkel = 45°

Art. No.	Model	WLL ton*	Dimensions - mm				Weight kg
			L	B	E	H	
03 28 0001	CGD-6-10	2,1	79	11	24	22	0,5
03 28 0002	CGD-8-10	3,5	107	12	32	29	1,2
03 28 0003	CGD-10-10	5,6	134	15	40	37	2,4
03 28 0004	CGD-13-10	9,5	173	19	48	48	5,5
03 28 0005	CGD-16-10	14	215	22	64	57	9,4

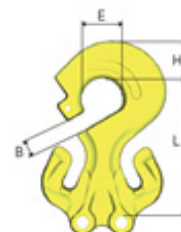

GRABIQ Grab hook OG

GRABIQ Topkrog OG

Art. No.	Model	WLL ton*	Dimensions - mm				Weight kg
			L	B	E	F	
03 40 0101	OG-7/8-10	2,6	65	10	17	10	0,322
03 40 0102	OG-10-10	4,0	85	12	20	12	0,641
03 40 0103	OG-13-10	6,8	104	16	26	16	1,532
03 40 0104	OG-16-10	10,3	131	20	32	19	2,69
03 40 0105	OG-20-10	16,0	167	26	41	23	5,96
03 40 0106	OG-22-10	20,0	187	26	46	26	7,75
03 40 0107	OG-26-10	27,3	228	32	55	38	14,01
03 40 0108	OG-32-10	40,0	229	40	50	27	20,7

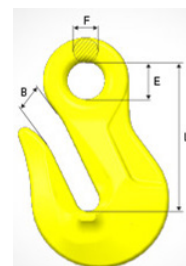

GRABIQ Grab hook

GRABIQ Opkorter krog

Art. No.	Model	WLL ton*	Dimensions - mm		Weight kg
			L	B	
03 40 0000	GG-6-10	1,5	54	8	0,2
03 40 0001	GG-8-10	2,6	57	10	0,4
03 40 0002	GG-10-10	4	76	12	0,8
03 40 0003	GG-13-10	6,8	97	16	1,8
03 40 0004	GG-16-10	10,3	114	20	3,1
03 40 0005	GG-20-10	16	147	26	7,3

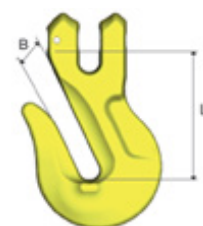

*Safety factor 4:1

*Sikkerhedsfaktor 4:1



GRABIQ Clevis safety hook

Art. No.	Model	WLL ton*	Dimensions - mm				Weight kg
			L	B	G	H	
03 31 0001	BKG-6-10	1,5	91	29	15	21	0,5
03 31 0002	BKG-8-10	2,6	121	37	17	26	0,9
03 31 0003	BKG-10-10	4	144	45	21	30	1,5
03 31 0004	BKG-13-10	6,8	180	55	30	40	3,2
03 31 0005	BKG-16-10	10,3	219	62	37	50	5,8
03 31 0006	BKG-20-10	16	240	68	44	62	9,7

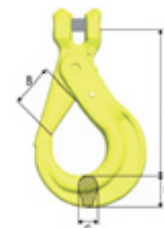

GRABIQ Gaffel sikkerhedskrog

GRABIQ Clevis safety hook

• W. Latch

Art. No.	Model	WLL ton*	Dimensions - mm				Weight kg
			L	B	G	H	
03 30 0001	GBK-6-10	1,5	87	26	15	17	0,4
03 30 0002	GBK-8-10	2,6	119	36	20	22	0,8
03 30 0003	GBK-10-10	4	149	47	22	29	1,4
03 30 0004	GBK-13-10	6,8	172	53	29	38	2,7
03 30 0005	GBK-16-10	10,3	208	68	30	45	4,4

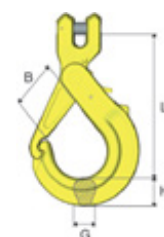

GRABIQ Gaffel sikkerhedskrog

• M. Pal

GRABIQ Eye safety hook

Art. No.	Model	WLL ton*	Dimensions - mm							Weight kg
			A	L	B	E	P	G	H	
03 34 0001	BK-6-10	1,5	12	109	29	22	10	15	21	0,5
03 34 0002	BK-7/8-10	2,6	14	138	37	28	11	17	26	0,9
03 34 0003	BK-10-10	4,0	16	168	45	34	13	21	31	1,5
03 34 0004	BK-13-10	6,8	20	207	55	44	16	30	40	3,0
03 34 0005	BK-16-10	10,3	26	254	62	56	20	37	50	5,7
03 34 0006	BK-20-10	16	30	289	68	60	22	44	64	9,2
03 34 0007	BK-22-10	20,0	32	320	80	70	24	50	64	11,4
03 34 0008	BK-26-10	27,3	35	342	100	80	25	54	68	16,5



GRABIQ Sikkerhedskrog m. øje

*Safety factor 4:1

*Sikkerhedsfaktor 4:1



GRABIQ Eye safety hook

· W. Latch

Art. No.	Model	WLL ton*	Dimensions - mm							Weight kg
			A	L	B	E	F	G	H	
03 32 0001	OBK-6-10	1,5	12	103	26	22	9	15	17	0,4
03 32 0002	OBK-7/8-10	2,6	14	139	37	28	10	20	22	0,8
03 32 0003	OBK-10-10	4	16	170	47	34	13	22	29	1,3
03 32 0004	OBK-13-10	6,8	21	206	53	44	15	28	38	2,5
03 32 0005	OBK-16-10	10,3	26	251	68	56	19	29	45	4,4
03 32 0006	OBK-18/20-10	16	28	293	74	60	22	44	56	8,3



GRABIQ Gaffel sikkerhedskrog m. øje

· M. Pal

GRABIQ Clevis sling hook

· W. Latch

Art. No.	Model	WLL ton*	Dimensions - mm				Weight kg
			L	B	G	H	
03 29 0001	EGKN-6-10	1,5	86	25	17	20	0,4
03 29 0002	EGKN-8-10	2,6	95	28	17	23	0,5
03 29 0003	EGKN-10-10	4	121	35	23	31	1,1
03 29 0004	EGKN-13-10	6,8	145	42	28	38	2,1
03 29 0005	EGKN-16-10	10,3	170	53	36	46	4
03 29 0006	EGKN-20-10	16	209	65	42	60	7,7



GRABIQ Gaffel lastekrog

· M. Pal

GRABIQ Eye sling hook

· W. Latch

Art. No.	Model	WLL ton*	Dimensions - mm						Weight kg
			L	B	E	F	G	H	
03 33 0001	EKN-6-10	1,5	93	25	23	10	17	20	0,4
03 33 0002	EKN-7/8-10	2,6	108	26	28	12	17	23	0,6
03 33 0003	EKN-10-10	4	134	37	34	14	23	30	1,0
03 33 0004	EKN-13-10	6,	166	42	44	18	28	38	2,1
03 33 0005	EKN-16-10	10,3	203	53	56	22	36	47	4,1
03 33 0006	EKN-20-10	16	229	61	61	26	42	60	6,4
03 33 0007	EKN-22-10	20	267	73	64	31	43	67	8,7
03 33 0008	EKN-26-10	27,3	301	82	66	32	51	75	13,2
03 33 0009	EKN-32-10	40	353	96	90	38	61	98	25

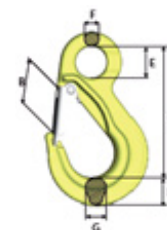

GRABIQ Lastekrog

· M. Pal

*Safety factor 4:1

*Sikkerhedsfaktor 4:1



GRABIQ Container hook

Art. No.	Model	WLL ton*	Dimensions - mm						Weight kg
			A	L	E	B	H	G	
03 45 0001	CH-3	12,5	25	187	70	46	47	75	3,8
03 45 0002	CH-3, 45° left	12,5	25	187	70	46	47	75	3,8
03 45 0003	CH-3, 45° right	12,5	25	187	70	46	47	75	3,8

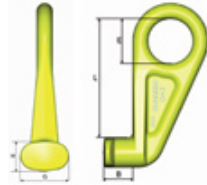

GRABIQ Containerkrog

GRABIQ Swivel latch hook

- W. Ball bearing

Art. No.	Model	WLL ton*	Dimensions - mm							Weight kg
			L	B	C	E	A	G	H	
03 41 0001	LKNK-7/8-10	2,6	154	28	28	38	12	18	24	0,9
03 41 0002	LKNK-10-10	4,0	191	35	35	44	15	23	31	1,56
03 41 0003	LKNK-13-10	6,8	236	40	45	48	19	28	38	3,19
03 41 0004	LKNK-16-10	10,3	293	53	62	61	25	34	43	5,33
03 41 0005	LKNK-22-10	20,0	400	74	80	80	35	43	67	15,11

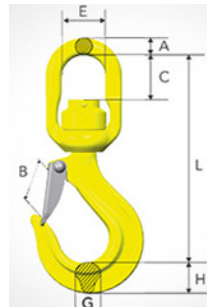

GRABIQ Svirvellastkrog m. Pal

- M. Kugleleje

GRABIQ Swivel latch hook

Art. No.	Model	WLL ton*	Dimensions - mm							Weight kg
			L	B	C	E	A	G	H	
03 42 0001	LKN-7/8-10	2,6	155	28	28	38	12	18	24	0,83
03 42 0002	LKN-10-10	4,0	192	35	37	44	15	23	31	1,5
03 42 0003	LKN-13-10	6,8	238	40	47	48	19	28	38	3
03 42 0004	LKN-16-10	10,3	295	53	65	61	25	34	43	5,06

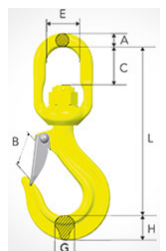

GRABIQ Svirvellastkrog m. pal

*Safety factor 4:1

*Sikkerhedsfaktor 4:1



GRABIQ Swivel safety hook

- W. Latch

Art. No.	Model	WLL ton*	Dimensions - mm							Weight kg
			L	B	C	E	A	G	H	
03 37 0001	BKL-6-10	1,5	149	29	23	33	11	15	21	0,7
03 37 0002	BKL-7/8-10	2,6	183	37	27	38	12	17	26	1,2
03 37 0003	BKL-10-10	4	218	45	37	44	15	21	31	2,0
03 37 0004	BKL-13-10	6,8	282	55	49	48	19	30	40	4,0
03 37 0005	BKL-16-10	10,3	341	62	65	61	25	37	50	7,4
03 37 0006	BKL-18/20-10	16	368	68	70	72	31	44	65	11,9



GRABIQ Swivel safety hook

- W. Latch
- W. Ball bearing

Art. No.	Model	WLL ton*	Dimensions - mm							Weight kg
			L	B	C	E	A	G	H	
03 38 0001	BKLN-6-10	1,5	149	29	24	33	11	15	21	0,7
03 38 0002	BKLN-7/8-10	2,6	183	37	27	38	12	17	26	1,2
03 38 0003	BKLN-10-10	4	218	45	35	44	15	21	31	2,0
03 38 0004	BKLN-13-10	6,8	280	55	45	48	19	30	40	4,2
03 38 0005	BKLN-16-10	10,3	339	62	62	61	25	37	50	7,3
03 38 0006	BKLN-18/20-10	16	368	68	60	72	31	44	62	12,4
03 38 0007	BKLN-22-10	20	436	79	80	80	35	50	62	16,8
03 38 0008	BKLN-26-10	27,3	486	100	110	102	45	54	68	26,5



*Safety factor 4:1

*Sikkerhedsfaktor 4:1



We are supplier to BUILDING & CONSTRUCTION

We supply equipment for assignments within building & construction. We deliver products for lifting, lashing, cranes, safety etc.

We find solutions with our customers to ensure they get the right equipment for their assignment.

For lifting & lashing equipment and other crane equipment it is important the products are:

- Easy and practical to work with
- Safe and compliant with all legal requirements
 - At the right price

Because we are supplier to the Building & construction industry, we have extensive experience in the industry and we have been able to negotiate attractive deals with our suppliers. This will benefit you by getting quality products, fast delivery and extra qualified service.

Within the building and construction sector, our client list includes:

- Contractors
- Engineering/machine manufacturers
- Transport industry and transport and logistics companies
 - Ports
- Construction companies

Vi er leverandør til INDUSTRI & BYGGERI

Vi sørger for udstyr til opgaver indenfor industri og byggeri.

Vi leverer produkter til løft, surring, kraner, sikkerhed mm.

Vi finder løsninger sammen med vores kunder, så de får det rette udstyr til deres opgave.

Indenfor løftegrej og surringsgrej og andet kranudstyr er det vigtigt at produkterne er:

- Hensigtsmæssige at arbejde med
- Sikre og overholder alle lovkrav
 - Til den rigtige pris

Fordi vi er leverandør til industri og byggeri, betyder vores brancheerfaring og gode købmandskab, at vi har forhandlet attraktive aftaler på plads med vores leverandører. Dette kommer dig til gode ved at få, kvalitetsprodukter, hurtig levering og ekstra god service.

Inden for industri- og byggebranchen tæller vores kundeliste:

- Entreprenører
- Maskinfabrikker
 - Vognmænd
- Transportbranchen
 - Havne
- Byggefirmaer