



# *Pipe grinders & Pipe notchers*

*The art to make the technique work*



# ALMI<sup>®</sup> PIPE GRINDERS

The right pipe grinder for every application

ALMI Pipe grinders offer you added value through the security of years of trouble-free, accurate and to edit pipes fast. Because ALMI sells the pipe grinders worldwide in 60 different countries, this proves the guarantee of high-quality products. In addition, ALMI strives for continuity of product development processes and innovations. To provide you with the most recent and best developed pipe grinders at all times.

ALMI Pipe grinders are solid build, because these machines run at high speeds. Therefore the stability is a major influence on the final result. Processing stainless steel profiles and pipes at high speeds goes smoothly and fast. And without grinding burrs and discoloration of the material. Changing grinding belts can be done quickly. No tools are required, therefore you save a lot of valuable work time.

## Multifunctional

Replacing the grinding belt is also simple and can be done on one side of the machine. After grinding of profiles and pipes, they can be burred on the handy burring table at the top or back of the machine. The ALMI machines with lever control are both suitable for left-handed and right-handed employees. With a simple operation, the lever can be placed both sides, right and left.

## ALMI Pipe grinders guarantee:

- Stable and accurate working
- Fast and almost heat-free grinding of stainless steel
- No grinding frames and discoloration of the material
- Grinding rolls that can be exchanged quickly without tools
- Quick change of grinding belts
- Handy burring by means of a burring table
- Left-handed and right-handed use
- Cutting out any desired material
- Grind any desired diameter at any desired angle between 20°-90°
- Success, durability and high quality composite materials
- Optional length stop
- Possibility to grind out of the center by means of optional filler plates
- Quick change from lever to handwheel operation within 1 minute

Thousands of satisfied users have already experienced it, ALMI machines are an investment that makes you money!

## Benefits

- + Grinds any desired diameter
- + Grinds all common materials
- + Tubes and profiles
- + Very accurate
- + Sustainable
- + Cuts inconel and aluminum
- + Connection point for dust extraction
- + Can be operated with one key



**TECHNICAL SPECIFICATIONS AL 150HS**

Engine	4KW
Voltages	230V 3F 400V 3F of 460V 3F
Belt speed	45 meter p/sec. /4300 rpm
Belt size	150x2000 mm
Grinding diameters	20,0 / 114,3 mm
Grinding angle	20° - 90°
Weight	275 kg.
Operation	Lever and handwheel operation
Dimensions	1450x1260x900 mm



Now also grind angle 20°

Easy change of grinding rolls without tools



Burring table

Connection point for dust extraction

With handy storage space in column

Lever and handwheel operation

video  
click here

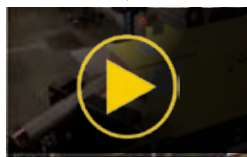

## TECHNICAL SPECIFICATIONS **AL 150**

Engine	4KW
Belt speed	30 meter p/sec./2800 rpm
Belt size	150x2000 mm
Grinding diameters	20,0 / 114,3 mm
Grinding angle	20° - 90°
Weight	260 kg.
Operation	Lever and handwheel operation
Dimensions	1450x1200x850 mm

**TECHNICAL SPECIFICATIONS AL 100U-01 / AL 100U-02**

Engine	3KW
Belt speed	30 meter p/sec./2800 rpm
Belt size	100x2000 mm
Grinding diameters	20,0 / 76,1 mm
Grinding angle	30° - 90°
Weight	AL 100U-01 190 kg. / AL 100U-02 220 kg.
Operation	AL 100U-01 Only lever operation AL 100U-02 Lever and handwheel operation
Dimensions	1450x1150x650 mm



# ALMI<sup>®</sup> HIGH SPEED

Striving for maximum production

**ALMI is the inventor of the pipe grinder and the pipe notcher. The AL 150 High Speed is the new 2 in 1 machine: grinding machine and pipe grinder in one. This machine has a unique transmission that brings the belt speed to 45 meters per second. As a result, you grind 3 times faster and the grinding belt has up to 3 times longer life than other grinders. This machine is suitable for steel, stainless steel, aluminum, inconel and plastics.**

## Benefits

- + Grinds 45 meters p/sec. - belt speed 4300 rpm.
- + Grinds any desired diameter
- + Grinds all common materials, incl. aluminum and inconel
- + Pipes, tubes, profiles and strips
- + No fine dust
- + No discoloration
- + 3 times longer life of grinding belts
- + With optional dust extraction
- + Optional lifting plates
- + Optional length stop
- + 1400 rpm 30 sec. / 4300 rpm 6 sec. grinding time



*video  
click here*



***“The dust extraction is optional to assemble on each pipe grinder”***





2 in 1

Pipe grinder and grinding belt machine

# ALMI<sup>®</sup> PIPE NOTCHERS

The right notcher for every application

Almi is the inventor of the pipe notcher. In industries where pipes and profiles are welded together at an angle of 90°, ALMI Pipe notchers ensure the right notch extremely quickly and precisely. This applies to gas, steam, stainless steel, non-ferrous pipes and profile materials.

ALMI Pipe notchers are also very suitable for making double-corner connections. In addition, ALMI supplies a notcher for notching a sink outflow in round and rectangular metal tubes.

## Multifunctional

ALMI Pipe notchers are an added value and offer you the assurance of years of trouble-free, accurate and fast processing of tubes and profiles. Because ALMI sells the pipe notchers worldwide in 60 different countries, this proves the guarantee of high-quality products. In addition, ALMI strives for continuity of product development processes and innovations. To offer you the most recent and best developed pipe notchers at all times.

## ALMI Pipe notchers guarantee:

- High productivity
- A simple and quick operation
- Machining multiple diameters with one tool
- Make double corner connections without any problems
- Success and sustainability
- High-quality composite materials

Thousands of satisfied users have already experienced it, ALMI machines are an investment that makes money for you! ALMI Pipe grinders and ALMI Pipe notchers are investments with a return!



## Benefits

- + *High productivity*
- + *Low investment*
- + *Simple and fast operation*
- + *Ideal for double corner connections*
- + *Also for sink outflow*





## AL 1-2E



video  
click here

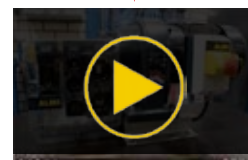

### TECHNICAL SPECIFICATIONS

Tube diameter	26,9 mm / ¾"
	33,7 mm / 1"
	42,4 mm / 1¼"
	48,3 mm / 1½"
	60,3 mm / 2"
Sink outflow	✗
Electrically powered	230/400/575 Volt
Maximum wall thickness	5 mm steel 3 mm stainless steel
Weight	87 kg.

## AL 1-2U



video  
click here



### TECHNICAL SPECIFICATIONS

Tube diameter	26,9 mm / ¾"
	33,7 mm / 1"
	42,4 mm / 1¼"
	48,3 mm / 1½"
	60,3 mm / 2"
Sink outflow	20 - 76,1 mm
Electrically powered	230/400/575 Volt
Maximum wall thickness	5 mm steel 3 mm stainless steel
Weight	93 kg.

## AL 1

video  
click here



### TECHNICAL SPECIFICATIONS

Tube diameter	26,9 mm / 3/4"
	33,7 mm / 1"
	42,4 mm / 1 1/4"
Maximum wall thickness	3 mm steel
	2,5 mm stainless steel
Weight	8 kg.

## AL 2



video  
click here

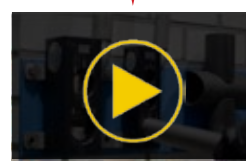

### TECHNICAL SPECIFICATIONS

Tube diameter	48,3 mm / 1 1/2"
	60,3 mm / 2"
Maximum wall thickness	3 mm steel
	2,5 mm stainless steel
Weight	15 kg.

## AL 3



video  
click here



### TECHNICAL SPECIFICATIONS

Tube diameter	42,4 mm / 1¼"
	48,3 mm / 1½"
Maximum wall thickness	3 mm steel
	2,5 mm stainless steel
Weight	15 kg.

## ALU



video  
click here

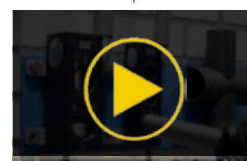

### TECHNICAL SPECIFICATIONS

Tube diameter	20-76,1 mm
Maximum wall thickness	3 mm steel
	2,5 mm stainless steel
Weight	7 kg.

# THEREFORE **ALMI**<sup>®</sup>

EUROTRUSS CAN REACT  
FASTER TO THE MARKET  
BECAUSE OF THE **ALMI**  
**HIGH SPEED**

**Eurotruss is worldwide supplier of Truss with the production location in Leeuwarden. The high speed of the AL 150HS is ideally suited for aluminum processing for Eurotruss.**

Because the aluminum is not burned, but freshly polished, it is directly applicable for welding.



THE **ALMI HIGH SPEED** IS  
INDISPENSABLE IN THE  
MEASURING PRODUCTION  
OF MFABRICATIONS

**MFabrications based in St. Jansteen in Zeeland, manufactures a variety of metal constructions and specializes in the production of roll cages and suspensions for motorsports.**

What MFabrications says about the ALMI High Speed: "Thanks to its excellent quality and minimal changeover times, the machine is now an integral part of our customized production. The threefold lifespan of the grinding belts play an important role in this".





## ALMI HIGH SPEED MAKES PROCESSING INCONEL A CONVENIENCE FOR STORK

**For Stork Hengelo it was not possible for years to process inconel easily. The ALMI High Speed changed that.**

Inconel is a product that is used in incinerators. It is a hard and wear-resistant material. With Stork it has become possible with the arrival of the AL 150HS to process inconel in a fast and very simple way.



## FREE WITH EVERY PIPE GRINDER:

- hexagonal key
- grinding roll 42,4 mm
- 5 stretch-free grinding belts









The grinding belt is unique because it is stretch-free during grinding. Due to this the belt tension remains equal. In addition these grinding belts are suitable for all materials.

Of course you can order these grinding belts per 5 or 10 pieces through our webshop [WWW.ALMI.NL](http://WWW.ALMI.NL)

The right **ALMI** product  
in the right place

## ALMI<sup>®</sup> Pipe notchers



	AL 1, AL 2, AL 3	AL 1-2E, AL 1-2-U	ALU
Possible profiles			
Right/variable angel			
Eccentric editing	-	-	-
Tube diameter*	AL 1    26,9 mm / 3/4" 33,7 mm / 1" 42,4 mm / 1 1/4" AL 2    48,3 mm / 1 1/2" 60,3 mm / 2" AL 3    42,4 mm / 1 1/4" 48,3 mm / 1 1/2"	<u>26,9 mm / 3/4"</u> <u>33,7 mm / 1"</u> <u>42,4 mm / 1 1/4"</u> <u>48,3 mm / 1 1/2"</u> <u>60,3 mm / 2"</u>	20 mm - 76,1 mm
Maximum wall thickness	3 mm steel and 2,5 mm stainless steel	5 mm steel and 3 mm stainless steel	3 mm steel and 2,5 mm stainless steel
Sink outflow	-	AL 1-2-U 	
Grinding belt	-	-	-
Handwheel/Lever	-	-	-
Electrical operation	-		-
3 year warranty**			
Dust extraction	-	-	-
Length stop	-	-	-

\* Other sizes on request

\*\* Warranty of 3 years upon registration. Normal warranty 1 year

## ALMI® Pipe grinders



**AL 100-U01**

**AL 100-U02**

**AL 150**

**AL 150HS**

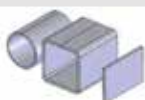
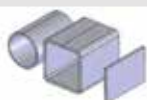

30° till 90°

30° till 90°

20° till 90°

20° till 90°

-

-

-

20 mm - 76,1 mm

20 mm - 76,1mm

20 mm - 114,3mm

20 mm - 114,3mm

Inapplicable

Inapplicable

Inapplicable

Inapplicable

-

-

-

100 mm x 2000 mm

100 mm x 2000 mm

150 mm x 2000 mm

150 mm x 2000 mm

Lever

Lever and handwheel

Lever and handwheel

Lever and handwheel



Optional

Optional

Optional

Optional

Optional

Optional

Optional

Optional

*The art to make the technique work*



### More info?

Visit our website [WWW.ALMI.NL](http://WWW.ALMI.NL)

or on

social media :

