

Industrial Audible Signal 104 dB (A) Series CN41



- > Max sound output 104 dB (A) / 1 m
- > 32 selectable tones meeting international regulations
- > Flame retardant ABS enclosure
- > 2 stage alarm by 2 wire bi-polar and 3 wire polarised control
- > Easy installation
- > Complies with BS 5839
- > Low current consumption
- > For 3 wire 2 stage alarm systems, line integrity maybe monitored via reverse polarity
- > Continuously rated
- > Sound selection via 5 way DIL switch



14605E00

www.stahl.de

Multi-purpose audible signalling device designed for indoor applications.

Approvals

Certificates		
 0086-CPD-96705	 KM 91259	BS EN 54-3 : 2001 incorporates amendment A 1 : 2002 + A 2 : 2006
		BS EN 54-3 : 2001 incorporates amendment A 1 : 2002 + A 2 : 2006

WebCode CN41A

Industrial Audible Signal 104 dB (A)

Series CN41



Selection Table

Version	Enclosure colour	Rated operational voltage	Order number	Art. no.	Weight kg
CN41 Sounder, BS EN 54-3, standard devices	red normal (RN)	10 ... 30 V DC	CN41/D/RN	205101	0.280

Note for indoor use only

Technical Data

Electrical data

Rated operational voltage	10 ... 30 V DC
Current consumption	36 mA Tone 1, 24 V DC
Line monitoring	3 wire, 2 stage or 2 wire, single stage: monitor via reverse polarity 2 wire, 2 stage i.e. bi-polar inputs: monitor via threshold (applied voltage < 1 V)

Acoustic data

Volume	max. 104 dB (A)
Volume control	18 dB (A) adjustment
Sound stages	2
Sound selection	via DIL switch

Ambient conditions

Operating temperature range	-25 ... +40 °C
Storage temperature	-40 ... +70 °C
Max. relative humidity	95 % at 40 °C

Mechanical data

Material	
Enclosure	flame retardant ABS
Assembly parts	stainless steel fixings
Labels	polyester foil, adhesive
Degree of protection	IP21C

Mounting / Installation

Assembly	Should be mounted to a reasonably flat wall or bulkhead of suitable material using the internal fixing holes (mounting gasket supplied). The recommended fixing screws are dia. 4.5 mm max. x 20 mm long. To maintain the integrity of the weather seal, the cable entry must be fitted using a suitable sealed gland.
Connection	2.5 mm ² terminals

Dimensional Drawings (All Dimensions in mm [inches]) - Subject to Alterations

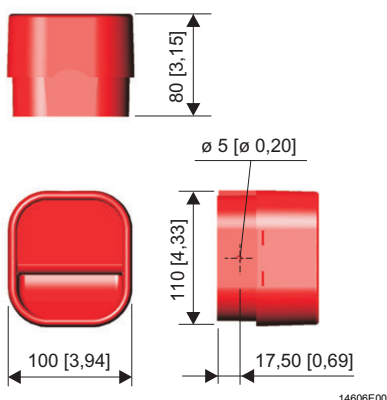

Sound signal selection is made by setting of the PCB mounted switches.

We reserve the right to make alterations to the technical data, dimensions, weights, designs and products available without notice. The illustrations cannot be considered binding.

E5