



|BGFIX®|

Safer building sites,
happier people...



Everything your
construction site
needs...



|BGFIX®|

Speedy, fast delivery

"They are really fast and very flexible - fast delivery and good prices; that is something we value here at Christiansen & Essenbæk!"



A bit more than the ordinary

"BGFIX for us is an approachable and professional business partner, that focuses on a quick response time."



Competitive

pricing

"I must say BGFIX have done it well. They always have new, innovative ideas and products, and they knock the prices right down..."



AARSLEFF

Personal

service

"It's nice that you can just ring and 'bark' an order... and it gives you a boost every time they deliver with a smile and sometimes something extra..."



M. J. ERIKSSON A/s

43 73 04 21

BGFIX Danmark ApS
CVR: 39174197

Sydvestvej 67,
2600 Glostrup

www.bgfix.dk

+45 53 73 95 40

order@bgfix.dk

AntiForce

strongest fencing

Features:

- HxL: 2000 x 3500 mm
- Tubing: Ø 38 mm
- Colours (in stock): galvanized and yellow
- Mesh: 40 x 262 mm
- No welds in the top corners
- Reinforced bottom corners
- AntiClimb mesh
- Central post for further stability
- Can be ordered in any colour

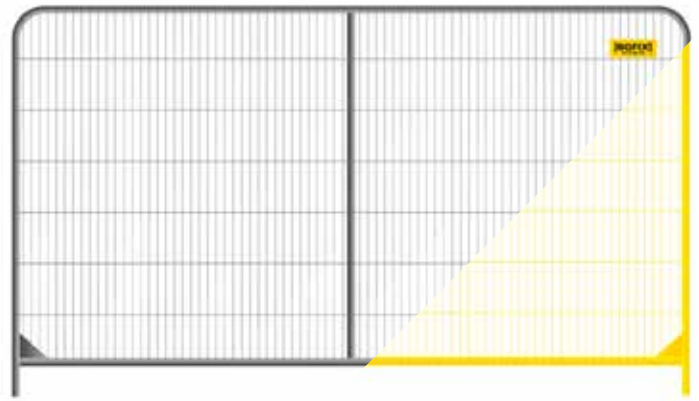

Roundtop

strong fencing

Features:

- HxL: 2000 x 3500 mm
- Tubing: Ø 38 mm
- Colours (in stock): galvanized
- Mesh: 100 x 262 mm
- No welds in the top corners
- Reinforced bottom corners
- Can be ordered in any colour

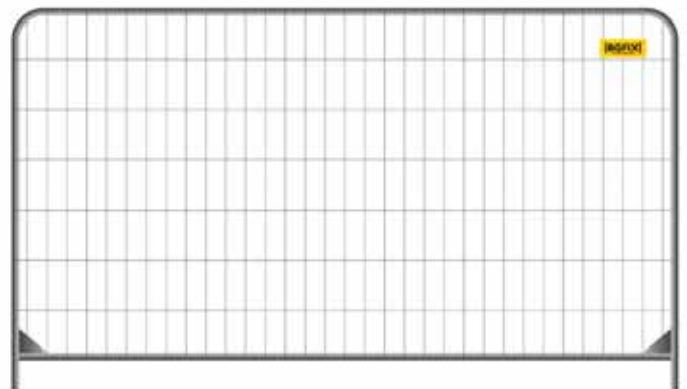

Roundtop Low

a low fencing solution

Features:

- HxL: 1100 x 3500 mm
- Tubing: Ø 38 mm
- Colours (in stock): galvanized
- Mesh: 86 x 262 mm
- No welds in the top corners

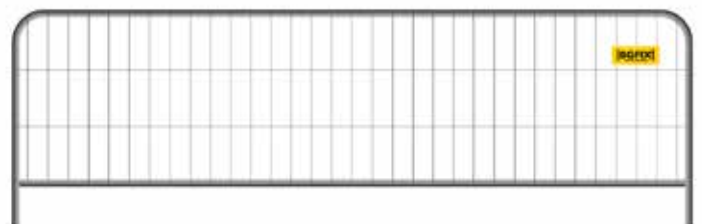

Basic+

better fencing

Features:

- HxL: 2000 x 3500 mm
- Tubing: Ø 38 mm
- Colours (in stock): galvanized
- Mesh: 100 x 262 mm
- Reinforced welds in the corners

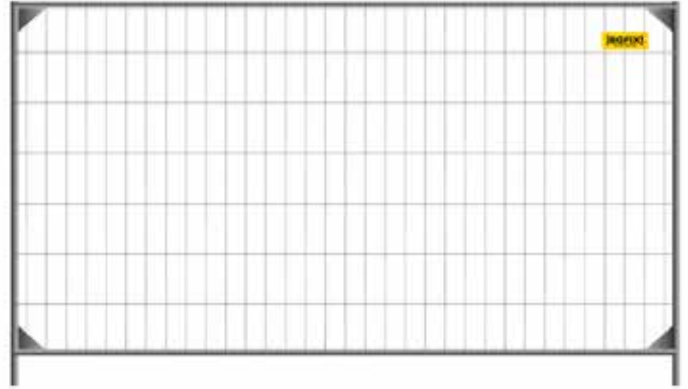

Basic

cheapest fencing

Features:

- HxL: 2000 x 3500 mm
- Tubing: Ø 38 mm
- Colours (in stock): galvanized
- Mesh: 100 x 262 mm
- Fencing that simply fulfills requirements

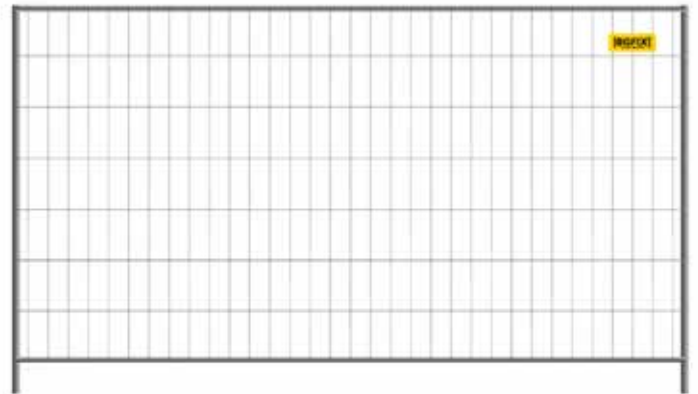

Extreme

temporary hoarding

Features:

- HxL: 2000 x 2200 mm
- Colours (in stock): grey/white
- A solid, closed fence
- Can be ordered in any colour
- Easy to move
- Can be reused and recycled
- Contact us for more information



18 kg

the visible plastic foot

Features:

- HxLxD: 120 x 770 x 205 mm
- Weight: 18 kg
- Material: recyclable plastic
- Hole dimension: Ø48 mm



20 kg

the strong plastic foot

Features:

- HxLxD: 135 x 690 x 255 mm
- Weight: 20 kg
- Material: recyclable plastic
- Hole dimension: Ø43 mm



26 kg

the stable plastic foot

Features:

- HxLxD: 150 x 680 x 243 mm
- Weight: 26 kg
- Material: recyclable plastic
- Hole dimension: Ø45 mm



32 kg

the concrete foot

Features:

- HxLxD: 130 x 590 x 220 mm
- Weight: 32 kg
- Material: concrete
- Hole dimension: Ø45 mm



Coupler

standard model

Features:

- HxLxD: 26 x 136 x 78 mm
- Weight: 0,22 kg
- Material: pre-galvanised steel
- Colours (in stock): yellow and galvanised



Lockable

coupler

Features:

- HxLxD: 35 x 140 x 80 mm
- Weight: 0,4 kg
- Material: galvanised steel
- Colours (in stock): galvanized
- Needs special tools to be opened



Standard

fence stabiliser

Features:

- HxBxL: 988 x 150 x 1487 mm
- Weight: 2,5 kg
- Material: pre-galvanised steel
- Is used normally with ground pegs



Double

fence stabiliser with footbase

Features:

- HxBxL (stabiliser): 988 x 150 x 1485 mm
- HxBxL (base): 45 x 520 x 460 mm
- Weight (stabiliser): 3,5 kg
- Weight (base): 2,7 kg
- Material: pre-galvanised steel
- Gives stability from both the top and bottom
- Fence feet are placed on the base as a weight



Cranked

fence stabiliser with base

Features:

- HxBxL (stabiliser): 988 x 150 x 1450 mm
- HxBxL (base): 178 x 225 x 102vv0 mm
- Vægt (stabiliser): 3 kg
- Vægt (base): 3,8 kg
- Material: pre-galvanised steel
- Gives stability to both the top and bottom
- Fence feet are placed on the base as a weight



Anti-Lift

stop fence being lifted up

Features:

- HxBxD: 350 x 40 x 260 mm
- Weight: 1 kg
- Material: galvanised steel
- A fitting that makes the fence unliftable
- Is resistant against wind
- Fits onto all fences and fence feet



50 kg ballast

heavy ballast-block

Features:

- HxBxD: 290 x 440 x 260 mm
- Weight: 50 kg
- Material: concrete
- Colours (in stock): yellow
- The 50 kg weight gives extra stability on the fence-foot
- It fits onto the 18kg fence-foot

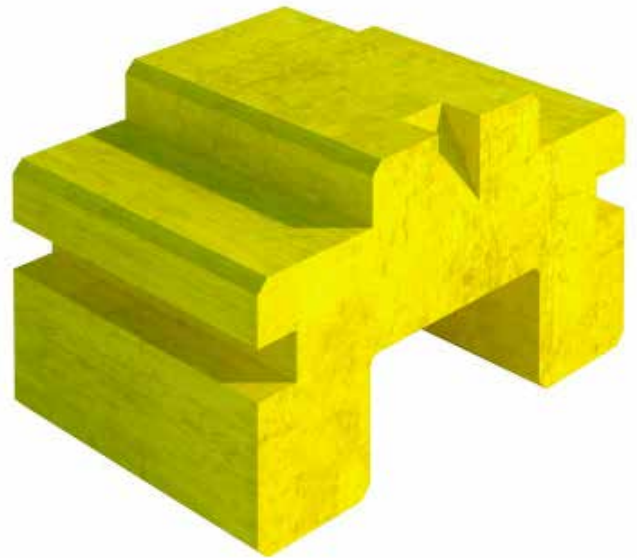

Pallet frame

for temporary fencing

Features:

- Yellow-painted steel frame
- Can hold up to 30 fence panels
- Temporary fence and gate panels fit this frame
- Two strong men can easily move it
- Optimal as there are holes instead of tubes sticking up- even used and broken fence panels fit into this frame



Accessories for the fencing

Your own logo on the fence

Features:

- Choose between plastic or aluminium
- We have our own sign machine in Sweden



Printed fence nets

Features:

- Net with print is delivered with eyelets
- Strong, wind resistant net
- It can be ordered in customer adapted length



Soundex sound mats

Features:

- Dampens up to 25 dB of unwanted noise
- HxL: 2100 x 3630 mm
- Weight: 14,7 kg
- It comes with eyelets and velcro



Slot block

in plastic for temporary fencing

Features:

- The plastic bases are available in red, white and yellow
- They can be filled with water or sand
- They can weigh up to 380kg per fence panel
- The bases weigh only 14kg each when empty
- Very visible



Concrete beam for fencing

Our personally developed concrete beams make the fence panels easy to install into the beams without wood. The beam is 3,5 meters long and is easy and efficient to move around by Manitou/truck.



Other fencing options

BGFIX has another alternative to the traditional plywood temporary fence. Plywood fencing on the traditional Hoffmann blocks has been a challenge as it has not been strong enough to withstand strong wind. BGFIX suggest another alternative by having screw-in foundations that are driven into the ground, then the poles get put on and the plywood simply get screwed onto that. This achieves a stable alternative that doesn't get blown over when there is a bit of wind. It is very fast and easy to install.



AntiForce on Hoffmann blocks

BGFIX AntiForce fencing is an amazing product to mount onto the popular Hoffmann concrete blocks. With a little wood, our clever installers can make a minimalistic, stable and maintenance-free fence around your building site.



7 m gate

for vehicles

Features:

- HxL: 2000 x 7000 mm
- Colours (in stock): galvanized and yellow
- Wire mesh: 40 x 260 mm
- Horizontal bar in the middle for stability
- Lockbolt for a padlock
- It is delivered with plastic wheels
- No welds in the top corners



4,2 m gate

for vehicles

Features:

- HxL: 2000 x 4200 mm
- Colours (in stock): galvanized and yellow
- Wire mesh: 40 x 260 mm
- Horizontal bar in the middle for stability
- Lockbolt for a padlock
- It is delivered with plastic wheels
- No welds in the top corners



1,2 m gate

for pedestrians

Features:

- HxL: 2000 x 1200 mm
- Colours (in stock): galvanized and yellow
- Wire mesh: 40 x 260 mm
- Horizontal bar in the middle for stability
- Lockbolt for a padlock
- It is delivered with plastic wheels



2,4 m gate

pedestrian gantry

Features:

- HxLxD: 2505 x 2432 x 598 mm
- Colours (in stock): galvanized and yellow
- Wire mesh: 40 x 260 mm
- A pole in the middle for stability
- Lockbolt for a padlock
- It can be ordered with/without door
- It can be ordered with/without signage



AccessLight

5 or 7m access gate

Features:

- Robust, manual swinging gate
- A frame of 40 x 80 mm industrial fencing
- The poles are 100 x 100 mm galvanized or yellow-painted steel
- The gate is locked with a chain lock
- It can be delivered with casting baskets
- It can alternatively be mounted to concrete blocks



AccessLight

personnel access gate

Features:

- Robust 1,2m manual swinging gate with handel
- A frame of 40 x 80 mm galvanized steel
- The poles are 60 x 60 mm galvanized or yellow-painted steel
- An option for mechanical code switch or SaltoLås
- It can be delivered with casting baskets or a steel plate for it to mount on



AccessSafe

We have a complete selection of strong manual and automatic gates. All of the automatic gate are delivered ready for Access Control System (ACS).



AccessSafe

bi-folding gate

BGFIX AccessSafe folding gate is a mobile gate installed on a strong steel plate to give the best results for your building site. The steel plate makes the gate is easy to install and gives it extra stability. The openings width of 5000/7500 mm means that most vehicles can enter the building site quickly and easily.

Features:

- HxL: 2400 x 5000 / 7500 mm
- Colours: RAL 1028, warm galvanized steel
- Ready for ACS
- Strong alloy panels
- Motor driving
- Installed on a steel plate

AccessSafe rotation gate

Features:

- A strong and reliable mobile rotation gate
- Solid steel construction
- Yellow painted in stock
- It is delivered with an alloy ramp with tracks for forklifts
- Ready for access control
- LxDxH: 1450 x 1450 x 2000 mm



AccessSafe personnel gate

Features:

- A strong and reliable mobile personnel gate
- Solid steel construction
- Yellow painted in stock
- It is delivered with an alloy ramp Ready for access control
- LxDxH: 1500 x 800 x 2000 mm



AccessSafe sliding gate

Features:

- HxL: 2000 x 5000 / 7500 mm
- Colour: RAL 1028
- A strong, manual or automatic solution
- Easy to move around
- Installed on a concrete pallet with forklift tracks



AccessSafe swing gate

Features:

- HxL: 2400 x 4000 - 10000 mm
- Colour: warm galvanized
- Ready for access control
- Motor driven or manual
- Installed onto a steel pallet
- It can be delivered with casting baskets for concrete



Strong

pedestrian barrier with T-foot

Features:

- Stabke and visible
- It is delivered with reflex strips and yellow T-feet
- The feet are removable
- 46 fence panels per transport frame



Yellow-painted

pedestrian barrier

Features:

- HxL: 1100 x 2300 mm
- Simple and fast to install
- A visible yellow colour
- 46 fence panels per transport frame
- Has A-shaped feet



Light barrier

with/without reflex strip

Features:

- HxL: 1100 x 2300 mm
- Simple and fast to install
- It is available with/without red and white reflex strips
- 46 fence panels per transport frame
- Has A-shaped feet



Frame

for pedestrian barriers

Features:

- It can hold 46-50 panels
- Yellow-painted
- Stackable
- Can be moved with a forklift



16 kg ballast

for pedestrian barriers

Features:

- Weight: 16 kg
- Colour (in stock): red
- Can be ordered in any colour
- Fits all types of our pedestrian barriers
- Filled with concrete



Gate

for pedestrian barriers

Features::

- Yellow painted and very visible
- It can be locked with a padlock
- Easy to move and install



Barrier solutions

"Danpæl" with board

Features::

- Red plastic cylinder with red/white type 3 reflex
- With handle and holes for boards
- Black 7 kg plastic foot
- Boards: 4m x 2cm x 7cm - painted red/white



Hoffmann concrete blocks

Features::

- New, grey Hoffmann blocks
- Weight: 560 kg
- Fast delivery
- We have sometimes used Hoffmann blocks for sale. Do not hesitate to ring us and find out
- You can also order them in your own colours



TA-Balk separate pedestrians and vehicles

Features::

- HxL: 1030 x 2900 mm
- Simple and fast to install
- Weight: 450 kg
- Comes with reflexes attached
- Extremely visible and can be used to divide traffic and pedestrians
- It can be easily moved about with a forklift



28 kg combi foot

Features::

- Weight: 28 kg
- Compatible with plastic fencing and N42
- Strong and solid



N42.2/3 delineators

Features::

- Made of robust plastic
- Double-sided reflex type 3
- 1m high
- It fits with 28kg combi feet and other building site feet



Plastic barrier

made of robust HDPE plastic

Features::

- Reflex type 3
- With handle
- HxL 1,1 x 2,1 m
- 20 hegn per transport frame
- Option for own company logo



Rebloc

road barrier

Features::

- HxWxL: 1200 x 670 x 8000
- Weight: 6.000 kg
- Movable by truck
- It can connected with other Reblocs to create a chain



Edge protection

When you need protection for your workers on the building site, a proper edge protection is a must! We have a complete system that will make your workers feel safe whilst they work.



AntiFall

edge protection system

BGFIX AntiFall is a complete system of strong edge protection for your building site. We have many different fittings and brackets, so the system, no matter what, will meet your need. All the combinations are CE - and EN-approved.

See all the products on our website or scan the QR-code here!



AntiFall edge protection

Features::

- Height: 1200 mm
- Length: 2600 mm
- Colour (in stock): yellow-painted
- It can be ordered in you own colour if ordered in larger quantities



AntiFall Posts

Features::

- Height: 1500 / 1900 mm
- Dimensions: 40x40mm
- Material: Steel
- "Click" system in the foot
- 1200 mm high post for planks as well as toe-board holders



AntiFall

Brackets

Wing Nut

- It fits 40x40 mm AntiFall posts
- Adjust the height of the fence
- Easy to mount



S-foot

- Easy to install
- Stable and safe
- It only needs one bolt!



Clamp Bracket

- No bolts
- 2 different configurations
- It is also available as a mini-model



AntiFall

Brackets

Fixed edge fittings

- Easy to mount
- Extremely solid and safe
- Other mounting options

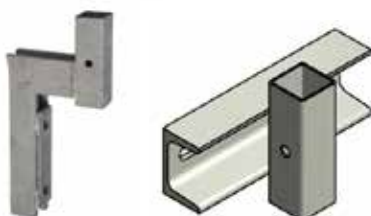

Door- window fittings

- Easy to mount
- A very flexible solution as dismantling is very easy and fast



Adjustable edge fitting

- Easy to mount
- Adjustable, flexible but safe



Safety products

Platform for accessing, loading and emptying trucks

BFIX are working closely with Safesmart on making safe products for accessing trucks.

The Safeloader platform is 6m long and you can connect two together to make a 12m platform. This means it is the full length of the truck.

TruckSafe makes accessing the back of the truck easy – simple but smart.



First aid on a movable trolley

A movable trolley with everything you need for first aid at your building site. They can be configured in many different ways so please reach out to us with your needs and requirements.

Fire extinguishing, first aid, spill control etc.



Staircase

a finished solution

Features:

- Warm-galvanised steel
- With bannisters on both sides
- Anti-slip steps
- Adjustable angle from 30 to 60 degrees
- Can be extended by putting stairs together



Steps

and bannisters

Features:

- We have the steps in a width of either 90 or 120 cm
- 20 cm breadth
- It is a fixed angle of 43 degrees
- The 120 cm model is adjustable between 15 and 65 degrees
- Anti-slip surface
- We also have to pool to hold the bannisters



Walkway

made of strong aluminum

Features:

- A strong metal construction
- Anti-slip alloy base-plate
- The edge protection can be folded up
- Width: 1000 / 1400 mm
- Length: 1700 / 2200 / 2700 / 3200 / 4000 / 5000 / 6000 mm



Goods on the ground!

Ramp / bump heavy duty

Features::

- The pipe crossing ramp has space for cables and wires with a diameter up to Ø 110 mm
- It is made of recycled plastic
- Weight: 52 kg



Speed-bump with grooves

Features::

- Height of either 50 or 75 mm
- With reflexes
- Colours (in stock): yellow and black
- Length: 500 mm
- Weight: 8 kg
- Groove: 40 x 20 mm
- 100 pieces per pallet
- End pieces are also available
- 100% recycled plastic



Plastic sheets for pedestrians and vehicles

Features::

- Made of LDPE plastic
- Are available from 10 to 20 mm thick
- Are up to 1500 x 3500 mm
- Eyelets and hooks can also be purchased
- They are available in many different colours
- Standard size in stock: 1100 x 3000 x 10 mm
- 31 kg per sheet
- A handle in each end
- 40 sheets per pallet



Building site

signs printed in your own design

BGFIX have their own sign machine and can therefore provide customized construction site signs of all sizes with very short delivery time.



INVESTOR
www.investor.dk

ARKITEKT
www.arkitekt.dk

INGENIØR
www.ingenior.dk

INVESTOR
CVR:123456
www.investor.dk

ARKITEKT
CVR:123456
www.arkitekt.dk

INGENIØR
CVR:123456
www.ingenior.dk



Signs for the building site

Road signs of all types

Download our brochure with prices by going on to our website under "sortiment" and "skilte" and open the PDF with road signs. Alternatively you can scan the QR-code below.

Ring to 53 73 95 40 for pricing on larger quantities.



BulkX

innovative og effective excavation system

BulkX is a system that allows contractors to excavate and transfer the waste directly into waste management vehicles.

Scan the QR code of have a look on www.cqegroup.com to see more.



How does it work?



Configurations

Direct-to-Truck

- The most simple solution
- Faster than traditional methods
- It can take up to 12t / 8.000L



Free Standing Gantry

- The frame can easily be moved by crane
- Fast and flexible
- It can take up to 24t / 12.000L



Fixed Gantry

- Requires minimal space
- It can take up to 24t / 12.000L



CantiDeck

innovative og effective material handling

The CantiDeck is the fastest access platform to move and install.
It is much cheaper than more complex scaffolding systems.
Scan the QR code of have a look on www.cqegroup.com to see more.



Configurations

Super Roller CantiDeck

- It can be rolled in and out
- It can be installed by one man and a crane
- Certified for up to 5t



Fixed Flush CantiDeck

- Fast og stable
- It can be moved quickly by crane
- Certified for up to 5t



Pod Lifting Frame

- A flexible solution for all floors
- Certified for up to 3,6t



Autolock

tipping container

Features::

- Hooks onto the forks
- Faster than the traditional tipping containers
- It's more safe as the driver doesn't have to leave the cab
- Available with or without wheels
- Available with or without crane lifting eyelets
- Strong and solid steel construction
- Available in 500 or 1200L



Boat skip

for cranes

Features::

- It has an automatic emptying function
- It can be emptied by the crane operator
- It doesn't require any assistance from the ground
- Strong and solid steel construction
- Models from 500 right up to 6000L capacity



Column skip

for concreting

Features::

- A bale arm means that it is stronger than traditional options
- A robust design for strength and safety
- It comes with a 3 m long reinforced rubber hose
- A strong spring ensures an automatic closing of the funnel when empty
- The funnel is reinforced and safer than other models
- Models from 500 to 4000L capacity



Goods cage

for cranes

Features::

- Strong wire mesh for transporting materials
- All the models are certified to lift up to 3t
- Reinforced crane lifting eyelets
- A hydraulic ramp makes it easier for lift materials in and out
- HxWxL (small): 1300 x 1360 x 1300 mm
- HxWxL (big): 1280 x 2645 x 1300 mm



Crane forks

for lifting materials

Features::

- Available with self levelling function
- Certified to lift up to 2t
- Available with fixed or telescopic height



Access cage

for cranes

Features::

- A safe way to transport personnel on site
- Easy and fast way to places with restricted access
- Many different size options
- Available as 1, 2, 4, 6 or 12-man cage



Boot wash

clean boots for clean building sites

Features::

- A free-standing wash station that makes sure that it is easy for workers and guests to keep offices clean
- It comes with in-built brushes and anti-slip mesh
- Hose with spray valve
- The stations can be connected together to make a longer station
- It is also available as a single station



Storage-frame

for crane equipment

Features::

- It is designed to sort the chains, hooks etc. neatly
- A smart, minimalistic design
- A box for smaller articles
- It can be easily moved around with a forklift or crane
- Designed to give maximum stability on sloping or uneven ground



Trench Box

for working underground

Features::

- Easy to install
- It can be customized according to need
- Standard depths from 2560 to 6490 mm
- Widths from 565 to 2465 mm
- Designed to be able to take up to 73 kN/m²



Crane lift

COSHH drum storage

Features::

- A safe way to store your dangerous goods and chemicals
- A lockable and approved solution for storing and transporting COSHH
- It has a drip tray for leaking chemicals, easy to clean
- It can hold up to 4 x 205L barrels with a shelf of other small tins and pots
- It can be easily moved and transported with a crane or forklift



Concrete

wash-out station

Features::

- An innovative solution for handling concrete water on the building site
- A unique, compact and simple solution for washing column skips etc.
- It makes sure the water gets recycled so it doesn't damage the environment



Who is

Conquip Engineering Group?

Conquip Engineering Group is a British company with many years of experience in the concrete industry, hiring out column skips etc. After goods were returned from hire, all products were analysed to see what could be improved. As a result, all products are uniquely innovative - they have all been value engineered.

The focus is on value, strength, durability and quality. All of the products are designed and manufactured in Great Britain.

Have a look at the whole range on www.cqegroup.com or scan the QR code.



A low-angle photograph of a tall building under construction. A crane is visible on the left side of the building. String lights with large, round, white bulbs are strung across the top of the frame. The sky is a clear, bright blue.

We are always
expanding our
selection.

Contact us if there is
something you are
missing, even if it is
not in the brochure...

|BGFIX[®]|