

# EXTENSION REELS

**ZECCA**

# EXTENSION REELS

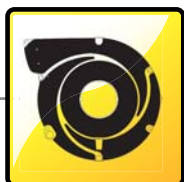

## SERIE 5000

pag. 58

### EXTENSION 11,5 m

EN 61242 EN 60335-1



2006/95/CE 2006/42/CE  
2002/95/CE

 Spring operated cable reels, suitable to be used as extension cord, allow the user to have always an available socket where needed.

#### reel features

- Swivelling bracket.
- Cable ratchet stop device.
- With incorporated thermic protection (except AL).
- Double earth contact.
- Working temperature: -5°/+40°C.

 Enrouleurs à ressort, convenables pour être utilisés comme prolongateurs, permettent à l'utilisateur d'avoir toujours une prise disponible où nécessaire.

#### caracteristiques de l'enrouleur

- Support pivotant pour la fixation.
- Cliquet d'arrêt du câble.
- Avec protecteur thermique incorporé (à l'exception AL).
- Double contact de terre.
- Temperature d'utilisation -5°/+40°C.

 Kabelaufroller mit Federantrieb, als Verlängerungsschnur geeignet, die dem Benutzer erlaubt, immer eine Steckdose zur Verfügung zu haben.

#### Eigenschaften Aufroller

- Schwenkbarer Bügel.
- Stoppvorrichtung.
- Mit Überhitzungsschutz (Ausser AL).
- Doppelerdungskontakte.
- Umgebungstemperatur -5°/+40°C.

 Enrolladores de cable, adapto para utilizacion como prolongadores y permiten à l'utilisador d'haber siempre una placa disponible.

#### características de l'enrollador

- Estribo orientable.
- Dispositivo de parada de cable.
- Con dispositivo termico incorporado (excepto AL).
- Doble contacto de tierra.
- Temperatura ambiente de utilizacion -5°/+40°C.

N.B.: You can find the complete range of cable reels, delivered with different cable type, starting from pag. 125. La gamme complète des enrouleurs de cable, livrables avec les differents types de cable, se trouve à partir de la page 125.

Die komplette Auswahl der Kabelaufroller, die mit unterschiedlichen Kabeltypen geliefert werden können, ist ab Seite 125 zu finden.

Ver la gama completa des enrolladores de cables, con los diferentes tipos de cable, a partir de la pag.125.

# TRADITION

#### dimensions

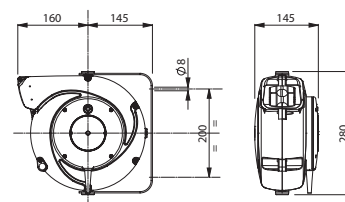

## SERIE 4000

pag. 59

EXTENSION 15 m

# BEST SELLER

## SERIE AM

pag. 60

EXTENSION 15 m

# ECONOMY

## SERIE AL

pag. 61

EXTENSION 15 m

# INNOVATION

ALUMINIUM BODY

dimensions

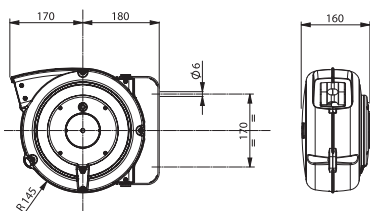

dimensions

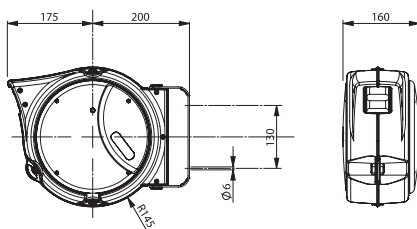

dimensions

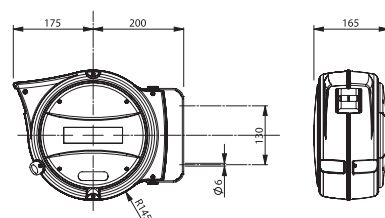

EXTENSION  
REELS



SERIE 5000

EXTENSION 11,5 m

**YELLOW COLOUR**  
**5827/XF GS**

**GREY COLOUR**  
**5527/XF GS**

**SCHUKO  
PLUG  
AND  
SOCKET**



**YELLOW COLOUR**  
**5827/XF**



**GREY COLOUR**  
**5527/XF**



Art. SILVER 5527/XF GS 5527/XF

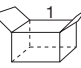

Art. YELLOW 5827/XF GS 5827/XF

Art. YELLOW	5827/XF GS	5827/XF
Description	Extension reel with Schuko plug and socket	Extension reel
m. coiled m. enroulés	11,5 m (10 + 1,5)	11,5 m (10 + 1,5)
cable	3G1,5-H05VV-F	3G1,5-H05VV-F
socket, plug, incoming cable Fiche, prise, cable en entrée	YES (Schuko plug and socket)	NO
W  (20°C)	230V 1200	1200
W  (20°C)	230V 1800	1800
thermic protection protecteur thermique	YES	YES
V max	500	500
	44	44
	mm 355x310x180 Kg 3,5	mm 355x310x180 Kg 3,5



SERIE 4000

EXTENSION 15 m

**BEST SELLER**

YELLOW COLOUR  
**4315**

GREY COLOUR  
**4315/S**



YELLOW COLOUR  
**4315/GS**

GREY COLOUR  
**4315/S GS**



SCHUKO  
PLUG  
AND  
SOCKET



EXTENSION  
REELS



**4315/GS3**

Art. SILVER	4315/S GS	4315/S	
Art. YELLOW	4315/GS3	4315/GS	4315
<b>Description</b>	Cable reel with 3 Schuko sockets and plug	Extension reel with Schuko plug and socket	Extension reel
<b>m. coiled m. enroulés</b>	15 m (14 + 1)	15 m (14 + 1)	15 m (14 + 1)
<b>cable</b>	3G1,5-H05VV-F	3G1,5-H05VV-F	3G1,5-H05VV-F
<b>socket, plug, incoming cable Fiche, prise, cable en entrée</b>	YES (Schuko plug and socket)	YES (Schuko plug and socket)	NO
<b>W</b> (20°C)	230V 1200	1200	1200
<b>W</b> (20°C)	230V 1800	1800	1800
<b>thermic protection protecteur thermique</b>	YES	YES	YES
<b>V max</b>	500	500	500
	44	44	44
	mm 335x310x185 Kg 5	mm 355x310x180 Kg 5	mm 355x310x180 Kg 5



SERIE AM



EXTENSION 15 m



AM40/315 GS3

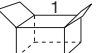

AM40/315

Art.	AM40/315 GS3	AM40/315
Description	Extension reel with 3 Schuko sockets and plug	Extension reel
m. coiled m. enroulés	15 m (14 + 1)	15 m (14 + 1)
cable	3G1,5-H05VV-F	3G1,5-H05VV-F
socket, plug, incoming cable Fiche, prise, cable en entrée	YES (Schuko plug and socket)	NO
W  (20°C)	1200	1200
W  (20°C)	1800	1800
thermic protection protecteur thermique	YES	YES
V max	500	500
	44	44
	mm 355x310x180 Kg 5	mm 355x310x180 Kg 5







AL41/315 GS3



AL41/315



Art.	AL41/315 GS3	AL41/315
Description	Extension reel with 3 Schuko sockets and plug	Extension reel
m. coiled m. enroulés	15 m (14 + 1)	15 m (14 + 1)
socket, plug, incoming cable Fiche, prise, câble en entrée	YES (Schuko plug and socket)	NO
W  (20°C)	1200	1200
W  (20°C)	1800	1800
thermic protection protecteur thermique	YES	NO
V max	500	500
	44	44
	mm 355x310x180 Kg 5	mm 355x310x180 Kg 5



SERIE 9000





EXTENSION 6 m

NECA

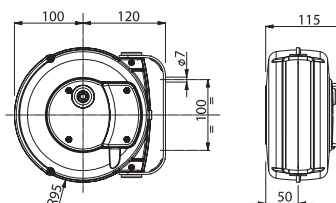

dimensions



Art.	9004/GS
Description	Extension reel with Schuko plug and socket
m. coiled m. enroulés	m 6 (5 + 1)
cable	3G1,5-H05VV-F
socket, plug, incoming cable Fiche, prise, cable en entrée	YES (Schuko plug and socket)
W  (20°C)	1400
W  (20°C)	1900
thermic protection protecteur thermique	YES
V max	500
	100
	mm 250x195x145 Kg 2,5







# SERIE 3500 HAND-OPERATED CABLE COILERS ENROULEURS MANUELS DE CÂBLE

## dimensions

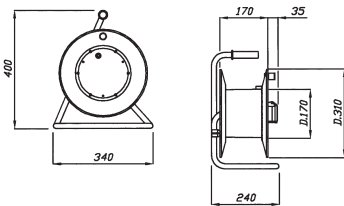

Brake  
Frein pour bloquer la bobine

Plastic drum for perfect insulation and a complete protection

Bobine en plastique résistante aux chocs et parfaitement isolée

Galvanized sheet iron flanges  
Brides en tôle zinguée

Base made by steel painted tube

Base en tuyau d'acier, verni a four



## HAND OPERATED CABLE COILERS

All the models are "CE" marked except incomplete models (without sockets and/or without cable), where "CE" marks must be placed by whom fits sockets and/or cables and puts on the market.

We can not supply cable reels with different lengths from those shown in the above schedule.

EN 61242 EN 60335-1



2006/95/CE 2002/95/CE



## ENROULEURS MANUELS

Tous les modèles sont marqués CE à l'exception des modèles fournis incomplets (sans prises et/ou sans câble) où le marquage "CE" doit être fait par celui qui les complète ou les met en commerce.

Nous ne pouvons pas fournir des enrouleurs avec des métrages différents de ceux indiqués dans le tableau ici-dessus.



## MANUELLE KABELTROMMELN

Alle Modelle sind CE gekennzeichnet, mit Ausnahme der nicht komplettierten Modelle (ohne Anschlüsse und/oder ohne Kabel). Für diese Modelle muss der Käufer für die CE Zeichen sorgen.

Diese Kabeltrommeln können nur mit der Kabellänge, wie in der Tabelle, geliefert werden.



## ENROLLADORES DE CABLES MANUALES

Todos los modelos tienen la marca CE, excepción hecha por los modelos suministrados sin tomas y/o sin cable, donde la marca "CE" está cargada de qui lo completa o de qui lo pone en comercio.

No es posible suministrar enrolladores con metros de cable diferentes

Socket type Type de prise Tipos de tomas Anschluss-typ	Cable section Section du câble	Metres of cable Mètres de câble enroulés	Article	Cable Câble	W	Thermic protection Protection thermique
no sockets sans prises	-	NO cable	<b>3501</b>	-	-	NO
4 sockets 10/16 A 2P+T Schuko (schuko/france plug)	-	NO cable	<b>3507</b>	-	-	YES
	3G1,5	25	<b>3508</b>	H05 VV-F	1400	YES
	3G1,5	40	<b>3509</b>	H05 VV-F	1200	YES
	3G2,5	25	<b>3510</b>	H05 VV-F	2100	YES
2 sockets 10/16 A 2P+T Schuko 1 socket (blue)CEE 16A (plug CEE 16A 2P+T)	-	NO cable	<b>3512</b>	-	-	YES
	3G1,5	25	<b>3513</b>	H05 VV-F	1400	YES
	3G1,5	40	<b>3514</b>	H05 VV-F	1200	YES
	3G2,5	25	<b>3515</b>	H05 VV-F	2100	YES
2 sockets (blue) CEE 16A (plug CEE 16A 2P+T)	-	NO cable	<b>3517</b>	-	-	YES
	3G1,5	25	<b>3518</b>	H05 VV-F	1400	YES
	3G1,5	40	<b>3519</b>	H05 VV-F	1200	YES
	3G2,5	25	<b>3520</b>	H05 VV-F	2100	YES
2 sockets (red) CEE 16A 16 A 3P+T 380V (plug CEE 16A 3P+T)	3G2,5	40	<b>3521</b>	H05 VV-F	1800	YES
	3G2,5	30	<b>3526</b>	H07 RN-F	1800	YES
	-	NO cable	<b>3522</b>	-	-	NO
	4G1,5	25	<b>3523</b>	H05 VV-F	2200	YES
2 sockets (red) CEE 16A 16 A 3P+T 380V (plug CEE 16A 3P+T)	4G1,5	40	<b>3524</b>	H05 VV-F	1900	YES
	4G2,5	30	<b>3525</b>	H05 VV-F	2500	YES
	4G2,5	30	<b>3527</b>	H07 RN-F	2500	YES

