

union connector • *intermedio diritto* • unión directo intermedio

**UC**

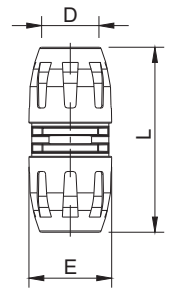

CODE	D	L	E	depth	weight (g)	
F-UC1600	16	81	37	38	50	1
F-UC2500	25	106	51	52	132	1
F-UC3200	32	124	61	62	212	1
F-UC4000	40	142	75	70	350	1
F-UC5000	50	161	87	79	505	1



reduced union connector • *intermedio diritto ridotto* • unión directo reducido intermedio

**G**



CODE	D	D1	L	E	E1	depth D	depth D1	weight (g)	
F-G3225	32	25	115	61	51	62	52	178	1
F-G4032	40	32	133	75	51	70	62	290	1
F-G5040	50	40	151	87	75	79	70	450	1

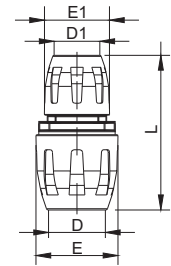

union elbow • *intermedio a gomito* • codo intermedio

**UL**



CODE	D	L	E	depth	weight (g)	
F-UL1600	16	72	37	38	70	1
F-UL2500	25	95	51	52	140	1
F-UL3200	32	122	61	62	240	1
F-UL4000	40	130	75	70	390	1
F-UL5000	50	152	87	79	580	1

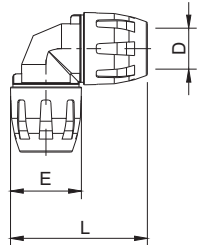

union elbow 45° • *intermedio a gomito a 45°* • codo intermedio 45°

**ULH**



CODE	D	L	H	E	depth	weight (g)	
F-ULH2500	25	115	81	51	52	145	1
F-ULH3200	32	137	97	61	62	235	1
F-ULH4000	40	160	115	75	70	375	1
F-ULH5000	50	185	134	87	79	540	1

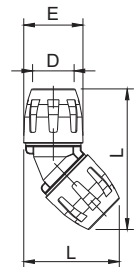

union tee • *intermedio a T* • te intermedia

**UT**



CODE	D	L	H	E	depth	weight (g)	
F-UT1600	16	109	73	37	38	90	1
F-UT2500	25	140	95	51	52	210	1
F-UT3200	32	170	122	61	62	360	1
F-UT4000	40	185	130	75	70	565	1
F-UT5000	50	216	152	87	79	230	1

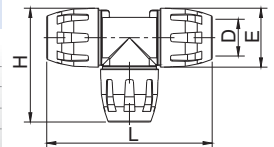

reduced union tee • *intermedio T ridotto* • te intermedia reducida

**GT**



CODE	D	D1	L	E	E1	H	depth D	depth D1	weight (g)	
F-GT2516	25	16	140	51	45	88	52	38	200	1
F-GT3225	32	25	170	61	51	113	62	52	340	1
F-GT4025	40	25	185	75	51	128	70	52	510	1
F-GT4032	40	32	185	75	61	131	70	62	540	1
F-GT5032	50	32	216	87	61	147	79	62	760	1
F-GT5040	50	40	216	87	75	150	79	70	820	1

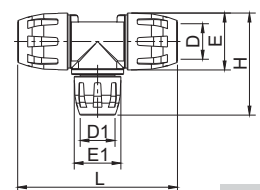

female plug • *tappo femmina* • tapón fin de línea

**PF**



CODE	D	L	E	depth	weight (g)	
F-PF1600	16	50	37	38	30	1
F-PF2500	25	60	51	52	75	1
F-PF3200	32	71	61	62	126	1
F-PF4000	40	78	75	70	200	1
F-PF5000	50	85	87	79	298	1

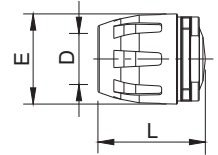

male connector • *diritto maschio* • directo macho

**CP**



CODE	D	T	L	E	depth	weight (g)	
F-CP1604	16	R 1/2"	64	37	38	30	1
F-CP2504	25	R 1/2"	71	51	52	80	1
F-CP2505	25	R 3/4"	73	51	52	80	1
F-CP2506	25	R 1"	76	51	52	80	1
F-CP3206	32	R 1"	85	61	62	120	1
F-CP3207	32	R 1 1/4"	87	61	62	130	1
F-CP4006	40	R 1"	96	75	70	200	1
F-CP4007	40	R 1 1/4"	97	75	70	200	1
F-CP4008	40	R 1 1/2"	98	75	70	200	1
F-CP5008	50	R 1 1/2"	108	87	79	300	1
F-CP5009	50	R 2"	111	87	79	290	1

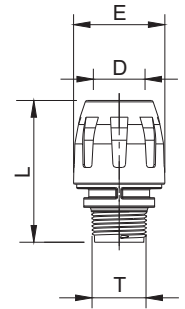

aluminum male connector • *diritto maschio in alluminio* • directo macho en aluminio

**CA**



CODE	D	T	L	E	depth	weight (g)	
F-CA2506	25	R 1"	76	51	52	130	1
F-CA3207	32	R 1 1/4"	87	61	62	220	1
F-CA4008	40	R 1 1/2"	98	75	70	420	1
F-CA5009	50	R 2"	111	87	79	580	1

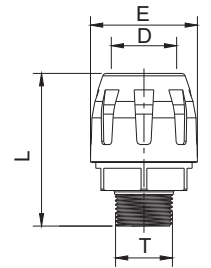

aluminum female connector • *diritto femmina in alluminio* • directo hembra en aluminio

**CF**



CODE	D	T	L	E	depth	weight (g)	
F-CF2506	25	G 1"	76	51	52	150	1
F-CF3207	32	G 1 1/4"	87	61	62	230	1
F-CF4008	40	G 1 1/2"	98	75	70	460	1
F-CF5009	50	G 2"	111	87	79	590	1

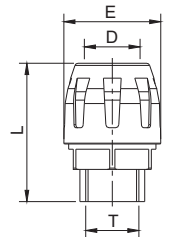

quick branch • *presa di derivazione rapida* • brida de derivación

**BR**



CODE	D	D1	L	E	La	Dp	weight (g)	
F-BR2516	25	16	113	37	52	16	210	1
F-BR3216	32	16	113	37	52	16	200	1
F-BR4016	40	16	125	37	52	20	250	1
F-BR4025	40	25	125	51	52	20	280	1
F-BR5016	50	16	145	37	60	20	420	1
F-BR5025	50	25	145	51	60	20	430	1

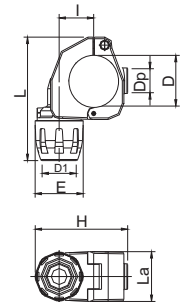

applique for wall installation • *presa a muro femmina* • aplique a pared

**WL**



CODE	T	P	R1	R2	L	F	
F-WL04	G 1/2"	36	83	51	95	53	1
F-WL05	G 3/4"	36	83	51	95	53	1

