

Product Catalogue 2022

The Toolflex System is a range of simple, flexible tool organizers that helps users effectively organize, efficiently store and quickly access a wide variety of tools of different sizes, shapes and contours.



Ergonomic

” 55% of all cleaning professionals suffer from back or neck pain.*

Storage in motion

No carrying tools between stops – the tools you need are readily available and can be safely transported on the cleaning cart.

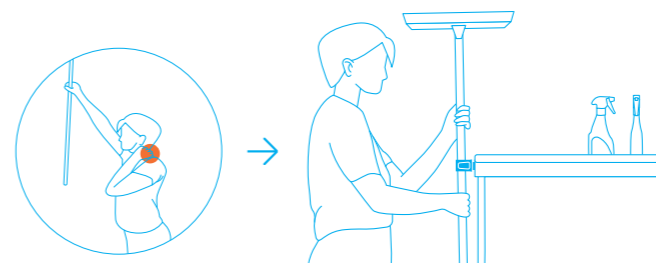
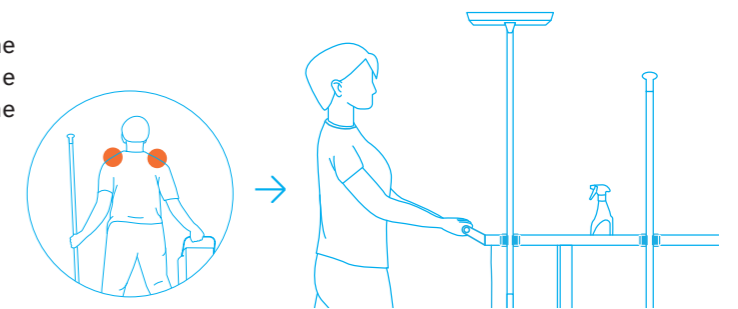

Comfortable / Smooth

Avoid harmful movements above the shoulders – secure tools at the right height and access them with a simple, one-handed motion (push in and pull-out feature).

Toolflex Motion holders rotate 360 degrees allowing users to precisely position tools on the cart.

Always at hand

With the right tools always at hand, users avoid bending and other harmful movements.

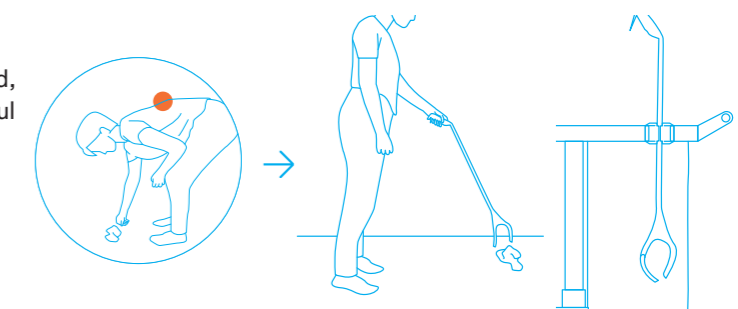

Toolflex Motion products featured on pages 6–7.

*Source: Swedish Work Environment Authority, Work environment statistics report 2020:2

Efficient

” If our cleaners spend 10 minutes per day searching for an item, we lose a lot of productive time.*

Inefficient

A messy work area is a source for delays, stress and safety hazards.

Efficient

Tools organized with everything in their place creates order from chaos to save time, reduce stress and promote safety.

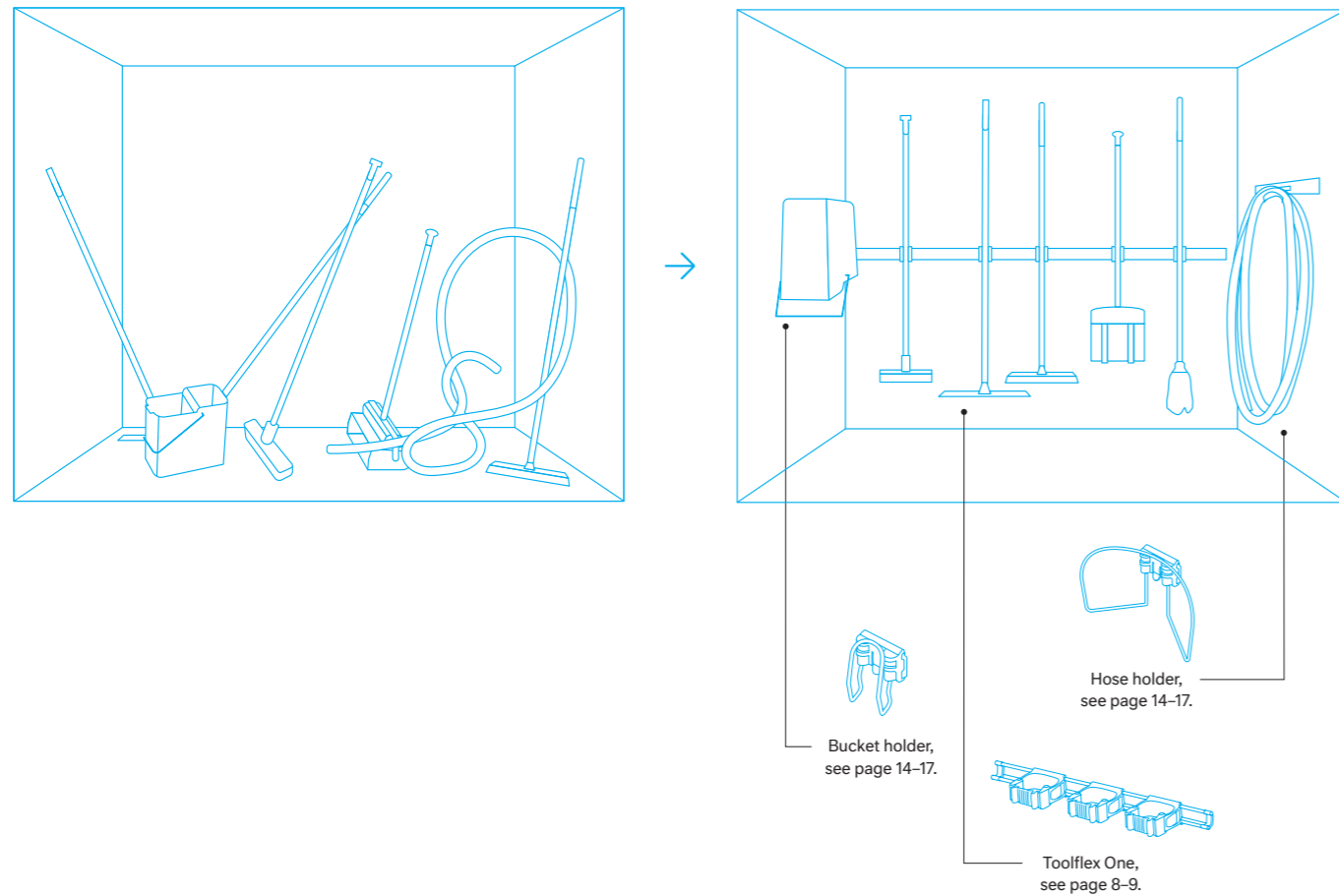

* Torbjörn Sporre, NT Service in Värnamo, Sweden, with 50 employed cleaners.

Hygienic

” We are required to segregate tools for workspaces, and there is no easier way than using different colours. It is difficult to make mistakes with this concept.*

Hygienic design

Innovative, hygienic design with smooth surfaces with extreme durability and performance.

Toolflex One is our NSF Certified system with one-size-fits-all, click-n-go holders that can be adjusted, repositioned or removed for cleaning by hand, in dishwasher or autoclave.

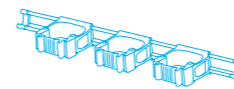
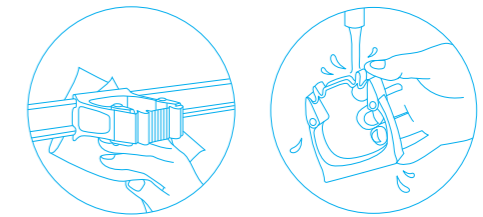

Toolflex One, see page 8-9.



Colour

- Available in 8 different colours
- HACCP compliant
- FDA approved materials
- NSF certified (Toolflex One)



* Daniel Sandgren, owner of Limhamn Fish Smokery and Shop

Toolflex Motion

Organisation on the Go

Toolflex Motion is for professional users requiring tool storage on the move – ideal for the maintenance trolley or cleaning cart. Secure tools, easily and quickly, before moving to the next location. Save time by having the right tools always at hand.

Toolflex has become the standard on cleaning carts and trolleys in the professional cleaning industry.

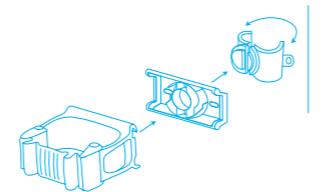
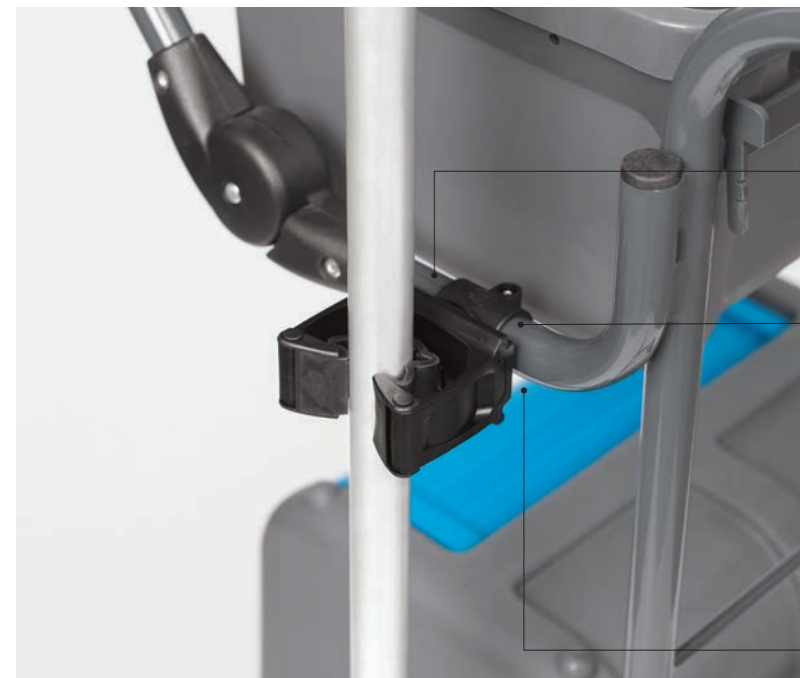

Toolflex One Motion includes Toolflex One holder, adapter and tube clamp.



Unique clamp function. Simple mounting with a standard Phillips screwdriver.

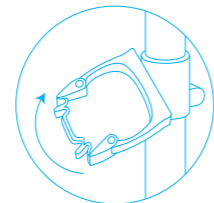

Unique tube clamp – 360° rotation.

Toolflex Motion is ideal for trolleys in various applications:

- Office cleaning
- Hotel cleaning
- Window cleaning
- Outdoor cleaning
- Staircase cleaning
- Waste collection

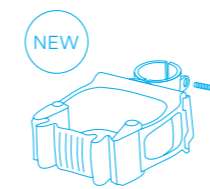

One Motion for handles Ø 15–35 mm

Tube clamp Ø	Art nr
19 mm	570-19-1
20 mm	570-20-1
22 mm	570-22-1
23 mm	570-23-1
25 mm	570-25-1
28 mm	570-28-1



Motion Cup

Tube clamp Ø	Art nr
19 mm	591-19-1
20 mm	591-20-1
22 mm	591-22-1
23 mm	591-23-1
25 mm	591-25-1
28 mm	591-28-1

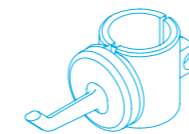

Motion Hook

Tube clamp Ø	Art nr
19 mm	534-19-1
20 mm	534-20-1
22 mm	534-22-1
23 mm	534-23-1
25 mm	534-25-1
28 mm	534-28-1



Motion Tube Clamp

Tube clamp Ø	Art nr
19 mm	540-19-1
20 mm	540-20-1
22 mm	540-22-1
23 mm	540-23-1
25 mm	540-25-1
28 mm	540-28-1

Other sizes on request.



Accessories

See page 14–17 for accessories to cleaning carts.

Tube diameter decision guide based on cleaning cart brands

Brand	mm Ø	Brand	mm Ø	Brand	mm Ø
Alpeios	20, 23	KBM	22	VDM	22
Gipeco	19	Numatic	25	Vermop	20, 22
Hygienteknik (Activa)	19, 22	Rekola	22	Vikan	28
Hörby Bruk (Feja)	22, 25	Röros	19, 22, 25	Vikur	22
IPC	22	Tina Trolleys	22	Vileda	19, 22

If unsure, use the detachable tape measure at the back page.

Subject to changes.

Mounting instructions



Scan the QR-code for download of mounting video or visit toolflex.com

Toolflex One

The ultimate tool holder system

Engineered and designed to the strictest hygienic and performance requirements, Toolflex One is the ultimate, most versatile storage system that helps users effectively organize, efficiently store and quickly access a wide variety of tools of different sizes (Ø15–35 mm), shapes and contours.

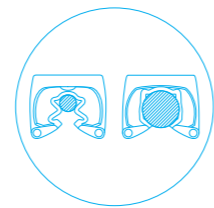
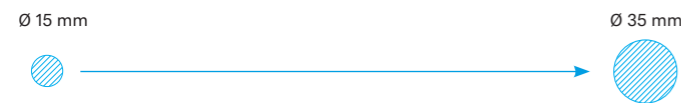

One size fits all tools (Ø 15–35mm).

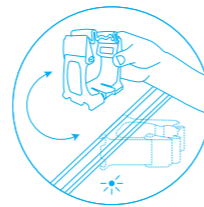

Click 'n Go function.

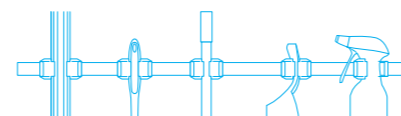

The unique and patented design assures that both small as well as large objects in different shapes are secured in a firm grip.

Toolflex One is ideal for

- Food and beverage processing
- Restaurants and hotels
- Convenience stores
- Hospitals and elderly care
- Commercial buildings
- Other specialty applications

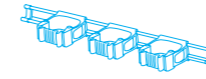
Handle dimension	Art nr
Ø 15–35 mm	5-3-X

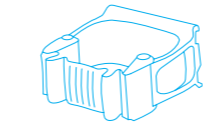

× 2

Handle dimension	Art nr
Ø 15–35 mm	TF1-X

Mounted on rail, alternatively on wall with adapter (separately purchased).

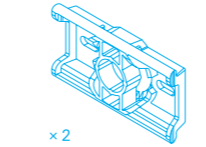

× 2

Handle dimension	Art nr
-	P01A-1

To be used with Toolflex One or Toolflex Accessories (see page 14–17). For mounting on wall alternatively on cleaning cart together with tube clamp (separately purchased, see page 7).



Handle dimension	Art nr
Ø 15–35 mm	9-5-X

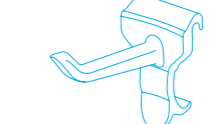

× 3

Handle dimension	Art nr
-	P01H-X

Mounted on rail.

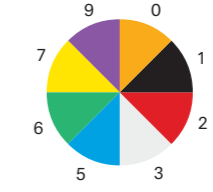

Colour coding

Available in 8 different colours.

X in art nr indicates chosen colour.
5-3-X (X= chosen colour)

Example:
5-3-5 (blue)

Hygiene and advantages

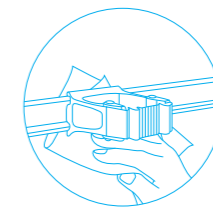

No stripes of dirt on the wall, the rail is mounted on distance supports.

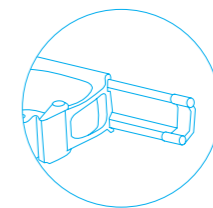

The hygienic design of the rail allows for dirt to just fall off or be dried off, no dirt traps.

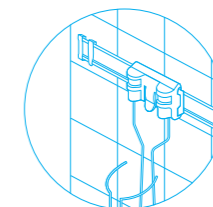

The hygienic rail is also used with Toolflex Accessories, for example with holders for disinfection bottles, gloves and masks, see pages 14–17.

Mounting instructions



Scan the QR-code for download of mounting video or visit toolflex.com



Toolflex Original Pro

Classic function

Toolflex Original Pro is our basic assortment of quality products suitable for professionals who want a simple, flexible storage solution. Available in four sizes. Holders can be mounted directly to the wall or onto the rail.



Direct mounting or onto rail.

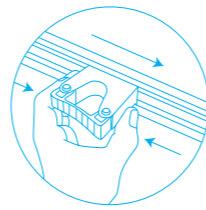

Slide function.

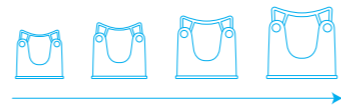

Four sizes.

Toolflex Original Pro is available in sizes that cover 15–40 mm

Small	(Ø 15–20 mm)
Medium	(Ø 20–30 mm)
Large	(Ø 25–35 mm)
X-Large	(Ø 30–40 mm)

Original Pro Small, 2-pack

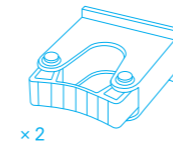

x 2

Handle size	Art nr
Ø 15–20 mm	602-X*

Original Pro Large, 2-pack

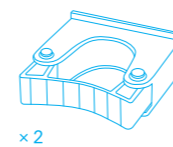

x 2

Handle size	Art nr
Ø 25–35 mm	622-X

Original Pro Rail 35/50/90 cm

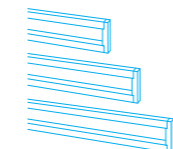

Length	Art nr
35 cm	3-0000-X
50 cm	5-0000-X
90 cm	9-0000-X

Original Pro 50 2M1XL

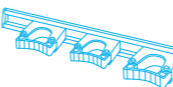

Content	Art nr
50 cm rail 2 x M 20–30 1 x XL 30–40	5-0201-X

Original Pro 90 3M2XL



Content	Art nr
90 cm rail 3 x M 20–30 2 x XL 30–40	9-0302-X

Original Pro Hook, 5-pack

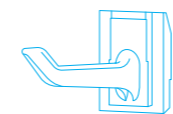

x 5

Handle size	Art nr
-	686-X

Mounted on rail.

Original Pro Medium, 2-pack

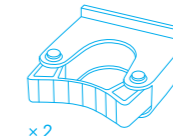

x 2

Handle size	Art nr
Ø 20–30 mm	612-X

Original Pro X-Large, 2-pack

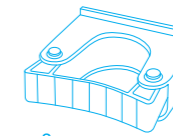

x 2

Handle size	Art nr
Ø 30–40 mm	632-X

Original Pro 50 3L

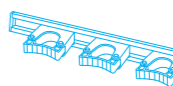

Content	Art nr
50 cm rail 3 x L 25–35	5-0030-X

Original Pro 90 6L



Content	Art nr
90 cm rail 6 x L 25–35	9-0060-X

Spare part kit for Original Pro

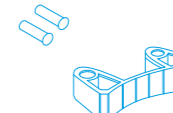

For holder	Art nr
Small 15–20 mm	R602-X+6*
Medium 20–30 mm	R612-X+6
Large 25–35 mm	R622-X+6
X-Large 30–40 mm	R632-X+6

Content: 5 x gripper and 10 x pins.

Mounting instructions



Scan the QR-code for download of mounting video or visit toolflex.com

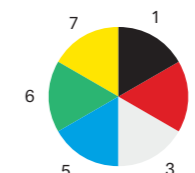

Colour coding

Available in 6 different colours. X in art nr indicates chosen colour. 612-X (X=chosen colour) Example: 612-5 (blue)

*Only available in black and white.

Toolflex Accessories

More options

Toolflex Accessories offers more storage options to your Toolflex System. With different holders that can easily be combined with Toolflex Motion and Toolflex One*, you will find it easy to store, for example, bottles, disposable gloves, hoses and buckets.

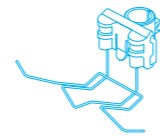

Dustpan & Broom holder, see page 16.



Universal holder, see page 16.

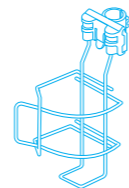

Canister holder, see page 16.

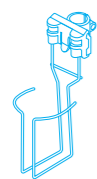

Bottle holder, see page 16.

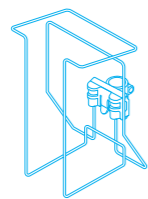

Glove holder, see page 16.

For Toolflex Motion

Accessories for Toolflex Motion – ideal for the maintenance trolley or cleaning cart. See page 16 for accessories for Toolflex Motion.

*Accessories for Toolflex Original Pro on request.

For Toolflex One

Simple mounting on existing Toolflex One rail. See page 17 for accessories for Toolflex One.



Bottle holder, see page 17.



For wall

Accessories for Toolflex One can be mounted directly on wall with screws/dowels enclosed in standard package. See page 17 for accessories for wall.



Canister holder, see page 17.

Something missing in our Toolflex Accessories program?

We have the possibility to produce customer-adapted storage solutions, based on different wire configurations.

Contact us at info@toolflex.com for more information.

Accessories for Toolflex Motion

1. Holder

Choose between uncoated stainless steel or powder coated steel, available in black and white.

2. Adapter (Included)

For mounting on cleaning cart (together with tube clamp).

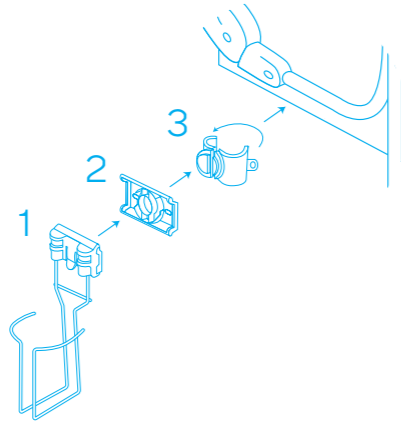

3. Tube Clamp (included)

For mounting on cleaning cart. **XX** in art nr indicates chosen tube diameter.

3311-**XX**-1 (**XX**=chosen diameter)
Example: 3311-22-1 (22 mm)

Tube diameter decision guide, see page 7.



Scan the QR-code to visit toolflex.com

Accessories for Toolflex One

1. Holder

Choose between uncoated stainless steel or powder coated steel, available in black and white. Can be mounted directly onto Toolflex One-rail.

2. Adapter (Included)

Mounted directly to the wall with included screws.

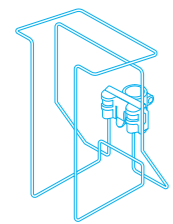
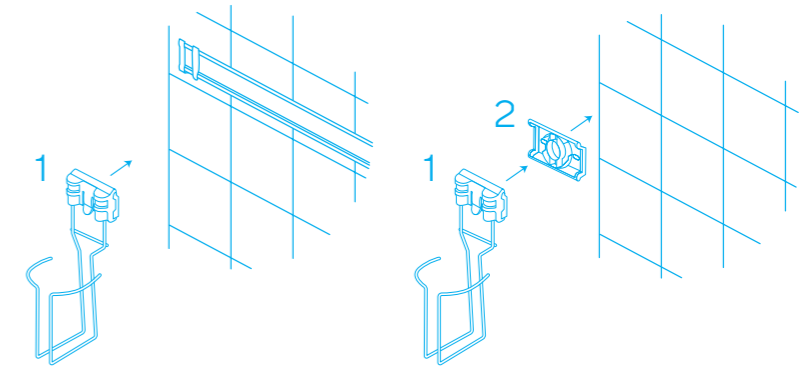

Glove holder (max H155 × D65 mm)

Wire	Art nr
Steel, Black	3311- XX -1
Steel, White	3311- XX -3

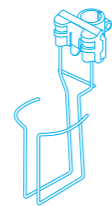

Bottle holder (Ø 60–75 mm)

Wire	Art nr
Steel, Black	3321- XX -1
Steel, White	3321- XX -3

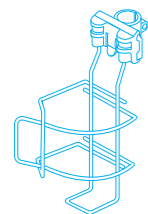

Canister holder (ca Ø 135 mm)

Wire	Art nr
Steel, Black	3331- XX -1
Steel, White	3331- XX -3

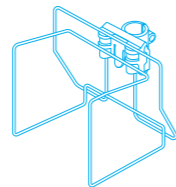

Face mask holder (max H120 × D100 mm)

Wire	Art nr
Steel, Black	3341- XX -1
Steel, White	3341- XX -3



Bucket holder

Wire	Art nr
Stainless Steel	3130- XX -UC
Steel, Black	3131- XX -1
Steel, White	3131- XX -3



Universal holder

Wire	Art nr
Stainless Steel	3160- XX -UC
Steel, Black	3161- XX -1
Steel, White	3161- XX -3

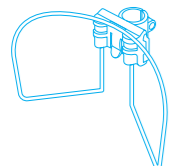

Hose holder

Wire	Art nr
Stainless Steel	3180- XX -UC
Steel, Black	3181- XX -1
Steel, White	3181- XX -3

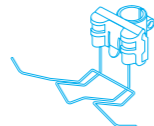

Dustpan & Broom holder

Wire	Art nr
Steel, Black	3191- XX -1
Steel, White	3191- XX -3

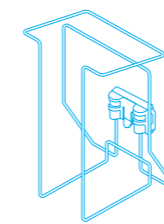

Glove holder (max H155 × D65 mm)

Wire	Art nr
Steel, Black	3311-1
Steel, White	3311-3

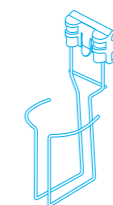

Bottle holder (Ø 60–75 mm)

Wire	Art nr
Steel, Black	3321-1
Steel, White	3321-3

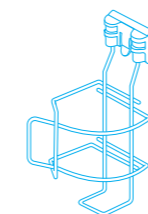

Canister holder (ca Ø 135 mm)

Wire	Art nr
Steel, Black	3331-1
Steel, White	3331-3

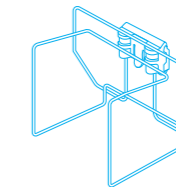

Face mask holder (max H120 × D100 mm)

Wire	Art nr
Steel, Black	3341-1
Steel, White	3341-3



Bucket holder

Wire	Art nr
Stainless Steel	3130-UC
Steel, Black	3131-1
Steel, White	3131-3



Universal holder

Wire	Art nr
Stainless Steel	3160-UC
Steel, Black	3161-1
Steel, White	3161-3

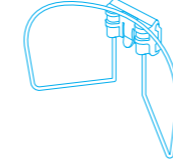

Hose holder

Wire	Art nr
Stainless Steel	3180-UC
Steel, Black	3181-1
Steel, White	3181-3

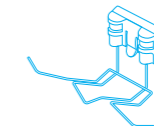

Dustpan & Broom holder

Wire	Art nr
Steel, Black	3191-1
Steel, White	3191-3

Made in Sweden

A sustainable storage system

Toolflex was founded in 1983, designed and produced in Sweden. Sustainability is a pillar of everything we do – from choosing high quality recyclable materials to the endeavor to work with sub-contractors located close to our factory in Småland, Sweden.

Distribution in over 40 countries

With over 50 million installed units since start, the Toolflex brand is offered and distributed to over 40 countries.

Please visit our website or contact us for additional information. Our full list of retailers and distributor partners can be found on our website.

www.toolflex.com

info@toolflex.com

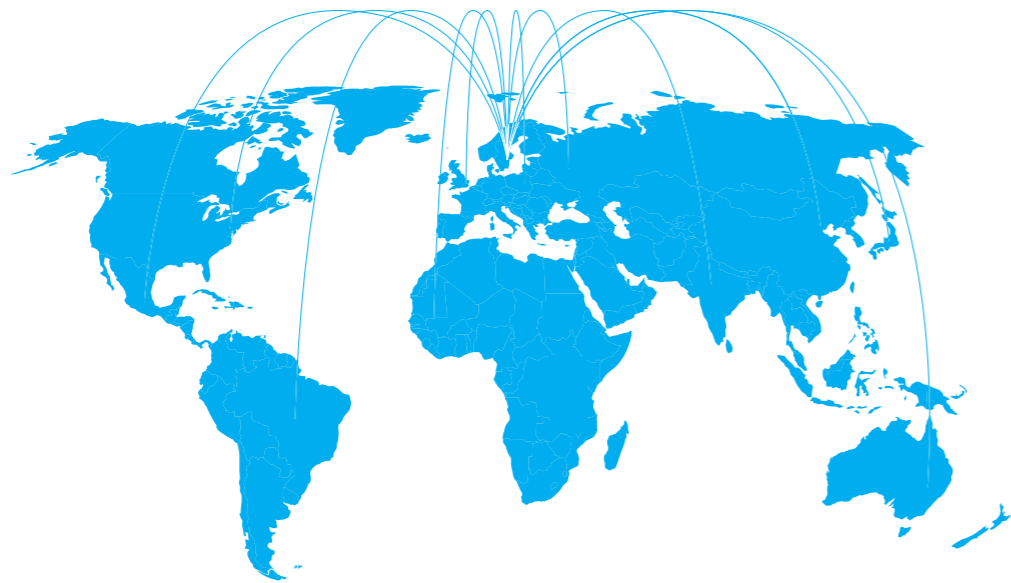

Everything in its place



Toolflex Professional System is a Swedish quality product from Delex Teknik AB. Delex is certified according to ISO 9001 and ISO 14001, which guarantees that all products from Delex are manufactured with a consistently high quality and with utmost consideration on environmental considerations.

Delex Teknik AB
Forsnäs väg 11
SE-331 71 Forsheda
+ 46 (0)370 37 46 00
info@toolflex.com

www.toolflex.com