

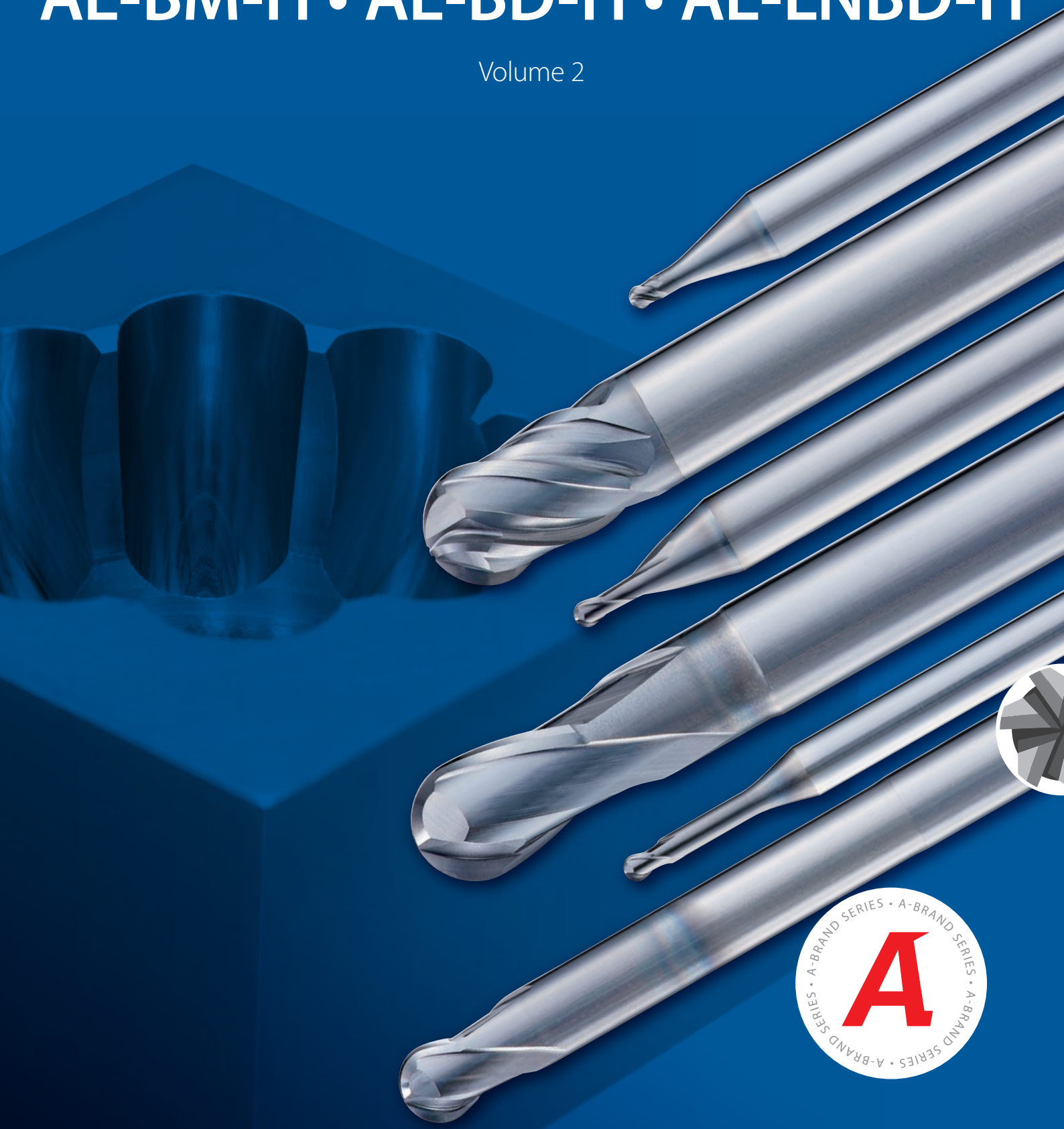

Carbide Ball End Mills for High Hardness Steels

# AE-BM-H • AE-BD-H • AE-LNBD-H

Volume 2



## AE-BM-H

4-flute type for high-efficiency processing

P.4

- R1~R6
- Total 8 items

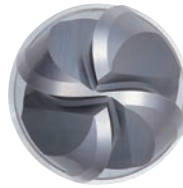

## AE-BD-H

2-flute type for high-precision finishing

P.10

- R0,5~R6
- Total 17 items



## AE-LNBD-H

2-flute long neck type for high-precision finishing

P.14

- R0,05~R3
- Total 261 items



## 3 types of end mills to accommodate a wide range of milling applications

Work Material: YXR3(60HRC)  
Coolant: MQL  
Machine: 5-axis Machining center  
Main Spindle: HSK63  
Maximum RPM: 25.000 min<sup>-1</sup>  
Holder: Shrink Fit

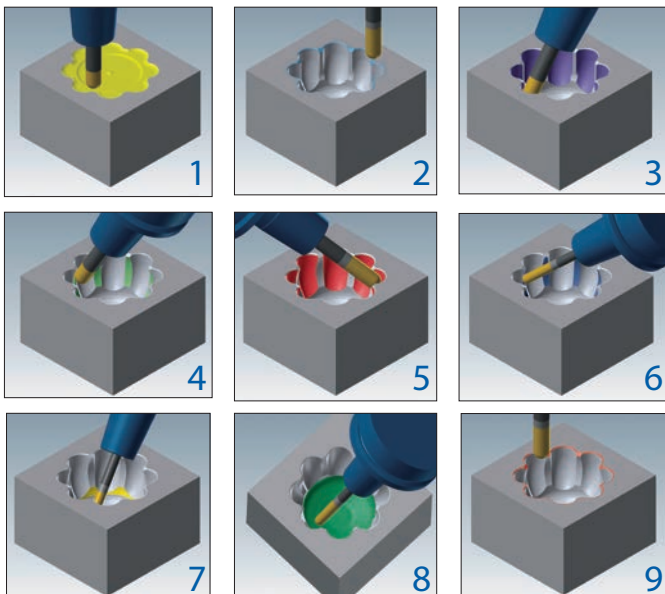

Process	Milling part	Milling method	Milling process	Tool
1	Overall	3-axis contouring line	High-efficiency roughing	AE-BM-H R5
2	Chamfer	3-axis contouring line	Semi-roughing	
3	Groove	5-axis profiling	Semi-roughing	
4	Ridge	5-axis turn milling	Roughing Semi-roughing	
5	Groove	5-axis profiling	High-precision finishing	AE-BD-H R5X30
6	Ridge	5-axis profiling	High-precision finishing	AE-LNBD-H R3X40X6
7	Middle bottom	5-axis turn milling	High-precision finishing	
8	Bottom	5-axis turn milling	High-precision finishing	
9	Chamfer	3-axis contouring line	High-precision finishing	AE-BD-H R5X30

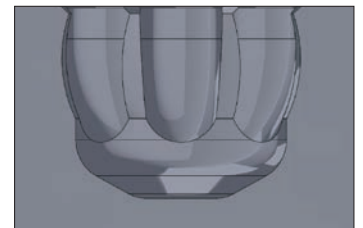
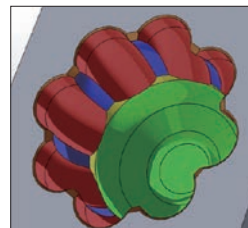

# KEY FEATURES & BENEFITS

## Main Features

AE-BD-H	AE-BM-H
 <p><b>High accuracy</b> finishing, 2 flutes R0,5 ~ R6 total 17 items</p> <ul style="list-style-type: none"> <li>• <b>Variable negative spiral gash</b> Strong negative point to suppress chipping &amp; negative outer cutting edge angle for excellent surface finish</li> <li>• <b>Core thickness</b> Improved core thickness suppresses cracks and chipping</li> <li>• <b>Excellent radius accuracy</b> Wide variety of finishing applications</li> <li>• <b>Also available as short shank type for shrink fit holders</b></li> <li>• <b>DUROREY coating</b> Excellent wear resistance for machining high hardness materials</li> <li>• <b>Smooth surface</b> High coating surface smoothness for improved work material surface</li> </ul>	 <p><b>High performance</b> 4 flutes type R1 ~ R6 total 8 items</p> <ul style="list-style-type: none"> <li>• <b>Unequal spacing</b> Multiflute type to suppress vibrations</li> <li>• <b>Strong spiral geometry</b> Low cutting resistance, high efficiency machining</li> <li>• <b>2 flutes center cut</b> - large chip pocket for improved chip evacuation - improved surface quality even on flat surfaces</li> <li>• <b>Excellent radius accuracy</b> High versatility from roughing to semi-finishing</li> <li>• <b>DUROREY coating</b> Excellent wear resistance for machining high hardness materials</li> </ul>

## DUROREY Coating

Newly developed DUROREY coating enables superior heat resistance and high toughness optimized for high-hardness steel milling!

Super heat resistant layer and ultra-fine periodic nano-layered structure provide superior toughness while maintaining high heat resistance and abrasion resistance. Also suppresses chipping even in high hardness milling and achieves long tool life.

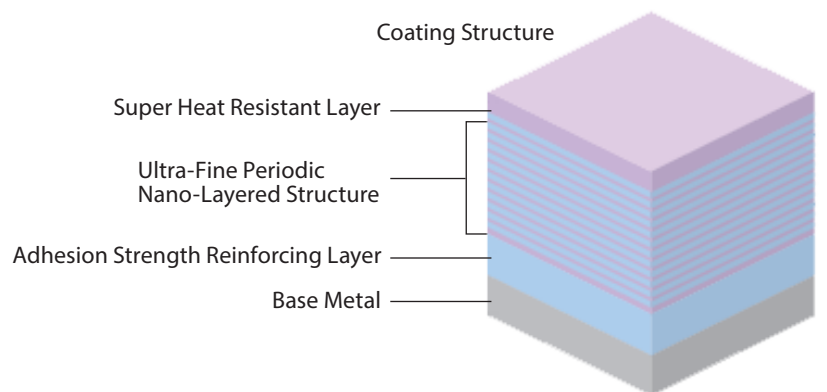

Coating Color	Coating Structure	Hardness (GPa)	Oxidation Temperature	Heat Resistance	Adhesion Strength	Surface Roughness	Wear Resistance	Welding Resistance	Toughness
Black Gray	Ultra-fine Periodic Nano-Layered	41	1.300	★	●	○	★	●	●

DUROREY is a registered trademark of OSG Corporation

○ → ● → ★  
Fair Best

Milling | Solid carbide



# KEY FEATURES & BENEFITS

## AE-BM-H

4 flutes high efficiency Carbide ball end mill for high-hardness steel

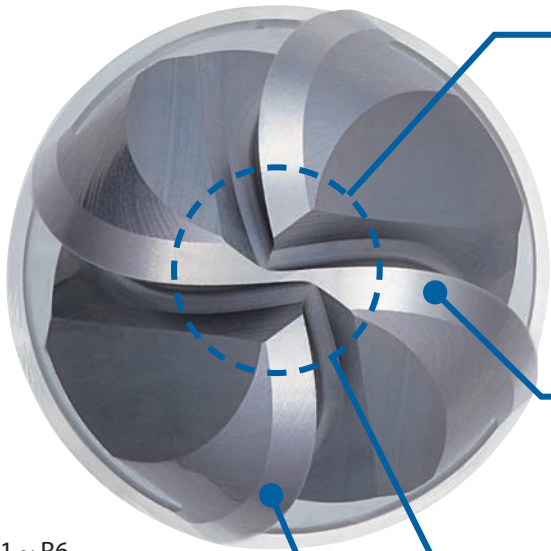

### Center 2 flute specification

Controls tear when milling flat areas to improve surface accuracy.  
Secures chip pockets with the center 2-flute specification to control the clogging of chips.

### Sharp spiral curve

Reduces cutting resistance and enables stable performance with extended tool life.

### Superior ball R precision

Suitable for a wide range of processes, from roughing to semi-roughing.

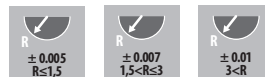

### Unequal flute spacing

Controls harmonic vibration commonly generated during milling with multiple flutes to enable high-efficiency milling.

R1 ~ R6  
total 8 items

Milling | Solid carbide



# AE-BM-H NEW

Milling | Solid carbide

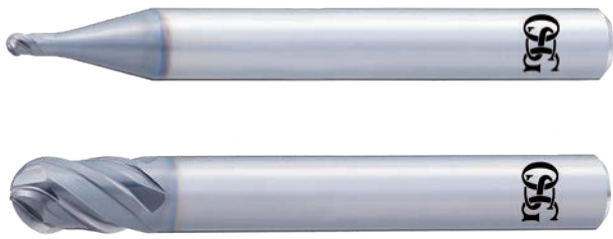

Type 1

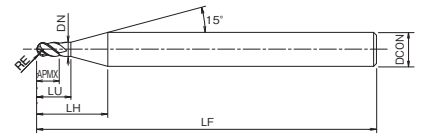

Type 2

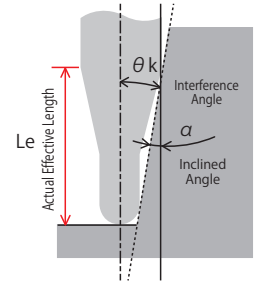

- First choice in quality and performance
- For high hardness materials
- 4 flutes, ball nose



EDP	ZEFP	DC	RE	LU	LF	APMX	DCON	DN	Φk	Effective length by inclined angles Le (α)*					Type	Price
										0,5°	1°	1,5°	2°	3°		
8549602	4	2	1	4	50	2	6	1,95	10,64°	4,19	4,3	4,42	4,55	4,85	1	
8549603	4	3	1,5	6	50	3	6	2,85	8,15°	6,44	6,61	6,79	7	7,45	1	
8549604	4	4	2	8	60	4	6	3,85	5,65°	8,49	8,71	8,96	9,22	9,81	1	
8549605	4	5	2,5	10	60	5	6	4,85	2,95°	10,54	10,82	11,12	11,45	-	1	
8549606	4	6	3	-	60	9	6	-	-	-	-	-	-	-	2	
8549608	4	8	4	-	70	12	8	-	-	-	-	-	-	-	2	
8549610	4	10	5	-	80	15	10	-	-	-	-	-	-	-	2	
8549612	4	12	6	-	90	18	12	-	-	-	-	-	-	-	2	

\* If there is no value in the actual effective length (Le column) for the work gradient angle α, it indicates no interference.



## Long tool life

Exhibits superior endurance in high-hardness steel milling.

Tool	AE-BM-H R5	Competitor
Work Material	SKD11 (60HRC)	
Milling method	Pocket milling	
Cutting Speed	55m/min (1.750 min <sup>-1</sup> )	
Feed Rate	875mm/min (0,125 mm/t)	
Depth of Cut	ap = 0,75mm Pf = 2,25mm	
Coolant	Air Blow	
Machine	Vertical Machining Center	

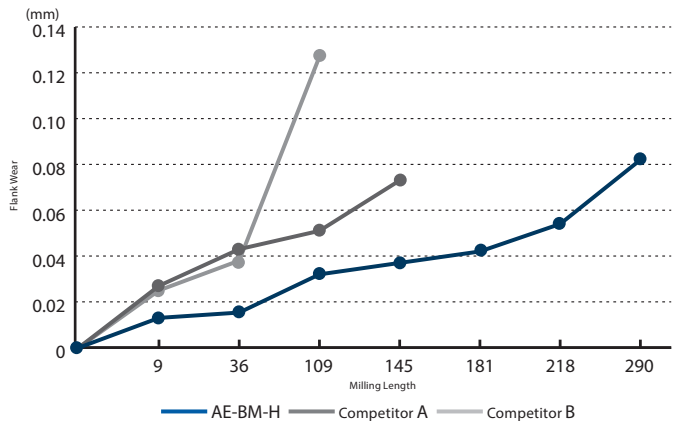

Tool	AE-BM-H R5	Conventional
Work Material	SKH51 (65HRC)	
Milling method	Pocket milling	
Cutting Speed	125m/min (4.000 min <sup>-1</sup> )	
Feed Rate	2.000mm/min (0,125 mm/t)	
Depth of Cut	ap = 0,3mm Pf = 1,2mm	
Coolant	Air Blow	
Machine	Horizontal Machining Center	

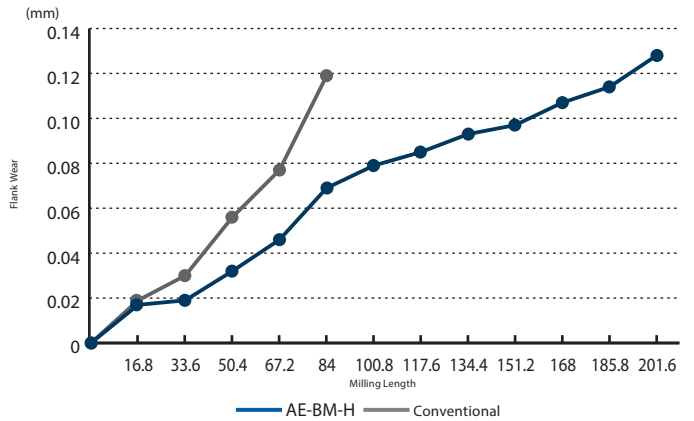

## Low cutting force

Effects of sharp spiral curve and unequal flute spacing enable stable milling with low resistance.

Tool	AE-BM-H R5	Conventional
Work Material	SKD11 (60HRC)	
Milling method	Corner R milling	
Cutting Speed	80m/min (2.550 min <sup>-1</sup> )	
Feed Rate	2.000mm/min (0,196 mm/t)	
Depth of Cut	ap = 5mm Pf = 0,1mm	
Coolant	Air Blow	
Machine	Vertical Machining Center	

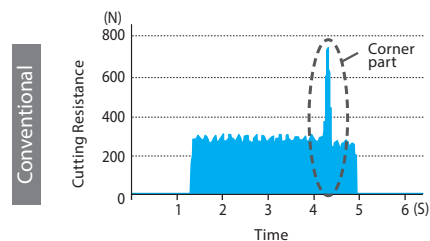
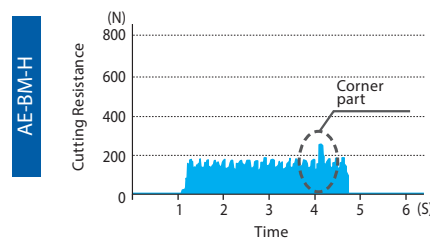
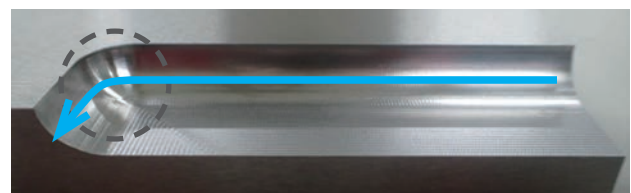

# CUTTING CONDITIONS

Milling | Endmills | Cutting conditions

## AE-BM-H

Roughing

The machining path is on condition of contouring line operation.

Vc	~45HRC		~55HRC		~62HRC		~66HRC		~70HRC	
	S (min <sup>-1</sup> )	F (mm/min)	S (min <sup>-1</sup> )	F (mm/min)	S (min <sup>-1</sup> )	F (mm/min)	S (min <sup>-1</sup> )	F (mm/min)	S (min <sup>-1</sup> )	F (mm/min)
R1	20.700	3.310	18.300	1.830	15.900	1.590	14.300	1.140	9.600	770
R1,5	13.800	2.760	12.200	1.710	10.600	1.480	9.600	1.150	6.400	770
R2	10.400	2.500	9.200	1.660	8.000	1.440	7.200	1.150	4.800	770
R2,5	8.300	2.660	7.300	1.900	6.400	1.660	5.700	1.370	3.800	910
R3	6.900	2.760	6.100	1.950	5.300	1.700	4.800	1.340	3.200	900
R4	5.200	2.500	4.600	1.840	4.000	1.600	3.600	1.300	2.400	860
R5	4.500	2.340	4.000	1.760	3.500	1.540	3.200	1.280	2.200	850
R6	4.000	2.240	3.600	1.730	3.200	1.540	2.900	1.160	2.100	840

Depth of cut	ap		Pf	
	RE<R3	0,15D	0,2D	0,2D
	R3≤RE	0,1D	0,2D	

Depth of cut	ap		Pf	
	RE<R3	0,12D	0,15D	0,15D
	R3≤RE	0,07D	0,15D	

1. Use a rigid and precise machine and holder.
2. We suggest using air blow or MQL (mist).
3. These milling conditions are for an end mill where the tool extension length is 4 times the diameter of the end mill. When length of the tool extension from the machine is long, reduce the speed and feed and milling depth.
4. The above condition shows an approximate standard for contouring operation (side milling) with a low machining load. If abnormal cutting sounds, vibration or chattering occur depending on the machining shape, cutting amount, rigidity of the machine or work holding condition, etc., please adjust the speed, feed and the depth of cut.
5. When the radius of curvature is less than 1.5 times the tool diameter, please reduce the speed to 50-80%, the feed rate to 50-80%, and the pick feed to 20-60% of the above shown cutting conditions.
6. When the machining incline angle (β) is more than 15°, please reduce the speed to 40-60%, the feed 30-50%, and the axial cutting depth to 30-60% of the above shown cutting conditions.
7. If the cutting depth is small, it is possible to further increase the speed and feed.

## AE-BM-H

Finishing

The machining path is on condition of contouring line operation.

Vc	~45HRC		~55HRC		~62HRC		~66HRC		~70HRC	
	S (min <sup>-1</sup> )	F (mm/min)	S (min <sup>-1</sup> )	F (mm/min)	S (min <sup>-1</sup> )	F (mm/min)	S (min <sup>-1</sup> )	F (mm/min)	S (min <sup>-1</sup> )	F (mm/min)
R1	27.100	4.340	24.700	2.470	22.300	1.780	18.300	1.460	13.500	1.080
R1,5	18.000	3.600	16.500	2.310	14.900	1.780	12.200	1.460	9.000	1.080
R2	13.500	3.240	12.300	2.210	11.100	1.780	9.200	1.470	6.800	1.090
R2,5	10.800	3.460	9.900	2.570	8.900	2.140	7.300	1.750	5.400	1.300
R3	9.000	3.600	8.200	2.620	7.400	2.070	6.100	1.710	4.500	1.260
R4	6.800	3.260	6.200	2.480	5.600	1.790	4.600	1.470	3.400	1.090
R5	5.700	2.960	5.300	2.330	4.800	1.730	4.000	1.440	3.000	1.080
R6	5.000	2.800	4.600	2.210	4.200	1.680	3.500	1.400	2.800	1.120

Depth of cut	ap		Pf	
	0,02D		0,05D	

Milling | Solid carbide



# CUTTING CONDITIONS

Milling | Endmills | Cutting conditions

## AE-BM-H

High Speed Roughing

The machining path is on condition of contouring line operation.

Vc	~45HRC		~55HRC		~62HRC		~66HRC		~70HRC	
	S (min <sup>-1</sup> )	F (mm/min)	S (min <sup>-1</sup> )	F (mm/min)	S (min <sup>-1</sup> )	F (mm/min)	S (min <sup>-1</sup> )	F (mm/min)	S (min <sup>-1</sup> )	F (mm/min)
R1	37.300	5.970	33.000	3.300	28.700	2.870	25.800	2.060	17.200	1.380
R1,5	24.800	4.960	22.000	3.080	19.100	2.670	17.200	2.060	11.500	1.380
R2	20.700	4.970	18.300	3.290	15.900	2.860	14.300	2.290	9.600	1.540
R2,5	16.600	5.310	14.600	3.800	12.700	3.300	11.500	2.760	7.600	1.820
R3	13.800	5.520	12.200	3.900	10.600	3.390	9.600	2.690	6.400	1.790
R4	10.400	4.990	9.200	3.680	8.000	3.200	7.200	2.590	4.800	1.730
R5	8.900	4.630	8.000	3.520	7.000	3.080	6.400	2.560	4.500	1.800
R6	8.000	4.480	7.200	3.460	6.400	3.070	5.800	2.320	4.200	1.680

Depth of cut	~45HRC		~55HRC		~62HRC		~66HRC		~70HRC	
	ap	Pf	ap	Pf	ap	Pf	ap	Pf	ap	Pf
	0,1D	0,2D	0,08D	0,2D					0,05D	0,1D

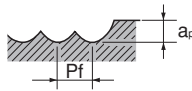
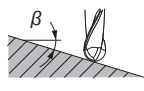
1. Use a rigid and precise machine and holder.  
 2. We suggest using air blow or MQL (mist).  
 3. These milling conditions are for an end mill where the tool extension length is 4 times the diameter of the end mill. When length of the tool extension from the machine is long, reduce the speed and feed and milling depth.  
 4. The above condition shows an approximate standard for contouring operation (side milling) with a low machining load. If abnormal cutting sounds, vibration or chattering occur depending on the machining shape, cutting amount, rigidity of the machine or work holding condition, etc., please adjust the speed, feed and the depth of cut.  
 5. When the radius of curvature is less than 1.5 times the tool diameter, please reduce the speed to 50-80%, the feed rate to 50-80%, and the pick feed to 20-60% of the above shown cutting conditions.  
 6. When the machining incline angle ( $\beta$ ) is more than 15° please reduce the speed to 40-60%, the feed 30-50%, and the axial cutting depth to 30-60% of the above shown cutting conditions.  
 7. If the cutting depth is small, it is possible to further increase the speed and feed.

## AE-BM-H

High Speed Finishing

The machining path is on condition of contouring line operation.

Vc	~45HRC		~55HRC		~62HRC		~66HRC		~70HRC	
	S (min <sup>-1</sup> )	F (mm/min)	S (min <sup>-1</sup> )	F (mm/min)	S (min <sup>-1</sup> )	F (mm/min)	S (min <sup>-1</sup> )	F (mm/min)	S (min <sup>-1</sup> )	F (mm/min)
R1	40.610	6.500	37.020	3.700	33.440	2.680	27.470	2.200	20.300	1.620
R1,5	27.070	5.410	24.680	3.460	22.290	2.670	18.310	2.200	13.540	1.620
R2	24.360	5.850	22.210	4.000	20.060	3.210	16.480	2.640	12.180	1.950
R2,5	19.490	6.240	17.770	4.620	16.050	3.850	13.180	3.160	9.750	2.340
R3	16.240	6.500	14.810	4.740	13.380	3.750	10.990	3.080	8.120	2.270
R4	12.180	5.850	11.110	4.440	10.030	3.210	8.240	2.640	6.090	1.950
R5	10.320	5.370	9.460	4.160	8.600	3.100	7.170	2.580	5.450	1.960
R6	9.080	5.080	8.360	4.010	7.640	3.060	6.210	2.480	5.020	2.010

Depth of cut	~45HRC		~55HRC		~62HRC		~66HRC		~70HRC	
	ap	Pf	ap	Pf	ap	Pf	ap	Pf	ap	Pf
									0,02D	0,05D

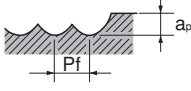
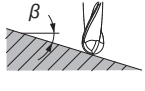
1. Use a rigid and precise machine and holder.  
 2. We suggest using air blow or MQL (mist).  
 3. These milling conditions are for an end mill where the tool extension length is 4 times the diameter of the end mill. When length of the tool extension from the machine is long, reduce the speed and feed and milling depth.  
 4. The above condition shows an approximate standard for contouring operation (side milling) with a low machining load. If abnormal cutting sounds, vibration or chattering occur depending on the machining shape, cutting amount, rigidity of the machine or work holding condition, etc., please adjust the speed, feed and the depth of cut.  
 5. When the radius of curvature is less than 1.5 times the tool diameter, please reduce the speed to 50-80%, the feed rate to 50-80%, and the pick feed to 20-60% of the above shown cutting conditions.  
 6. When the machining incline angle ( $\beta$ ) is more than 15° please reduce the speed to 40-60%, the feed 30-50%, and the axial cutting depth to 30-60% of the above shown cutting conditions.  
 7. If the cutting depth is small, it is possible to further increase the speed and feed.

Milling | Solid carbide







**DUROCESS**

**DURO**

For High hardness applications

**PROCESS**

With every tool and process

**SUCCESS**

Providing a total solution for success

# KEY FEATURES & BENEFITS

## AE-BD-H

2-flute high-precision finishing Carbide ball end mill for high hardness steel

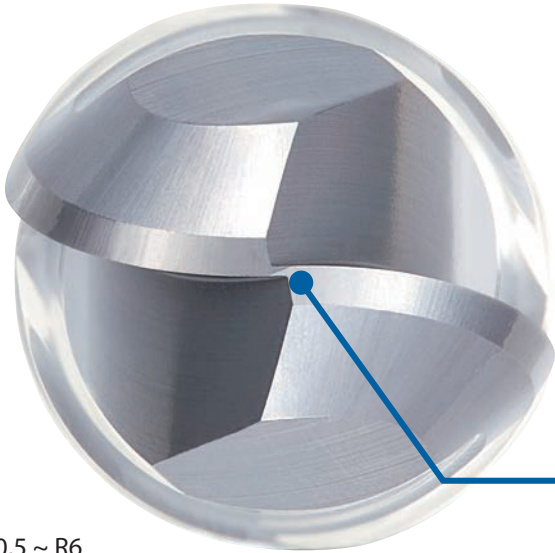

R0,5 ~ R6  
total 17 items

### Variable negative spiral gash

Controls chipping with larger negative angle at tip of cutting edge.

While securing cutting quality by making the negative angle weaker near the outer periphery, chipping resistance is enhanced in combination with the weaker helix angle specification.

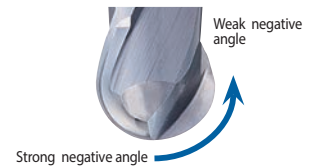

### Thickness at the center

Thickening of the center core to prevent deformation of the ball tip and improve control of chipping.

### Superior ball R precision

Secures stable R accuracy across 180°

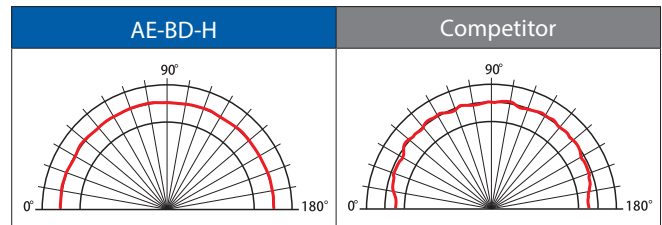

### Superior shank accuracy

Supports h4 tolerance (0/-0.004)

### Ideal for shrink fit holders

Lineup of short-shank type suitable for shrink fit holders are also available.

### Smooth Surface Treatment

Improves surface accuracy by smoothing the coating surface.

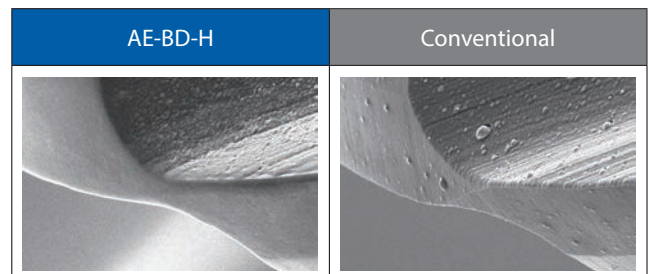

Milling | Solid carbide



# AE-BD-H NEW

Milling | Solid carbide



Type 1



Type 2

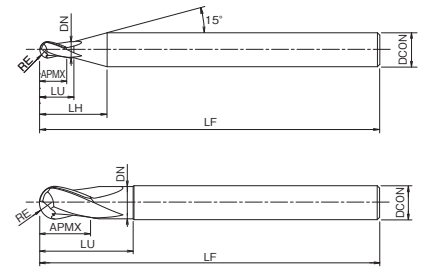

- First choice in quality and performance
- For high hardness materials
- 2 flutes, ball nose

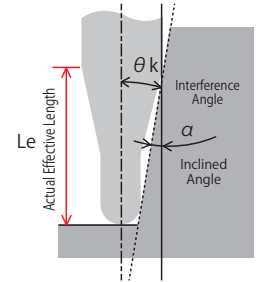

EDP	Short Shank	ZEFP	DC	RE	LU	LF	APMX	DCON	DN	Φk	Effective length by inclined angles Le (α)*					Type	Price
											0,5°	1°	1,5°	2°	3°		
3042001	-	2	1	0,5	2	50	0,8	4	0,95	11,71°	2,14	2,2	2,26	2,33	2,48	1	
3042002	-	2	1,5	0,75	3	50	1,2	4	1,45	10,03°	3,17	3,25	3,34	3,44	3,66	1	
3042003	-	2	2	1	4	50	1,6	6	1,95	10,64°	4,19	4,3	4,42	4,55	4,85	1	
3042004	-	2	3	1,5	6	60	2,4	6	2,85	8,15°	6,44	6,61	6,79	7	7,45	1	
3042005	-	2	4	2	8-4	60	3,2	4	3,85	-	-	-	-	-	-	2	
3042006	-	2	4	2	8	70	3,2	6	3,85	5,65°	8,49	8,71	8,96	9,22	9,81	1	
3042007	o	2	4	2	8-5	45	3,2	6	3,85	5,65°	8,49	8,71	8,96	9,22	9,81	1	
3042008	-	2	5	2,5	10	80	4	6	4,80	2,92°	10,63	10,9	11,22	11,55	-	1	
3042009	o	2	5	2,5	10-5	50	4	6	4,80	2,92°	10,63	10,9	11,22	11,55	-	1	
3042010	-	2	6	3	18	90	9	6	5,80	-	-	-	-	-	-	2	
3042011	o	2	6	3	18-5	55	9	6	5,80	-	-	-	-	-	-	2	
3042012	-	2	8	4	24	100	12	8	7,70	-	-	-	-	-	-	2	
3042013	o	2	8	4	24-5	75	12	8	7,70	-	-	-	-	-	-	2	
3042014	-	2	10	5	30	100	15	10	9,70	-	-	-	-	-	-	2	
3042015	o	2	10	5	30-5	75	15	10	9,70	-	-	-	-	-	-	2	
3042016	-	2	12	6	36	110	18	12	11,70	-	-	-	-	-	-	2	
3042017	o	2	12	6	36-5	80	18	12	11,70	-	-	-	-	-	-	2	

\* If there is no value in the actual effective length (Le column) for the work gradient angle α, it indicates no interference.



## Long tool life

Exhibits superior endurance in high-hardness steel milling.

Tool	AE-BD-H R5X30	Competitor
Work Material	SKD11 (60HRC)	
Milling method	Pocket milling	
Cutting Speed	150m/min (4.800 min <sup>-1</sup> )	
Feed Rate	870mm/min (0,09 mm/t)	
Depth of Cut	ap = 0,2mm Pf = 0,5mm	
Coolant	Air Blow	
Machine	Horizontal Machining Center	

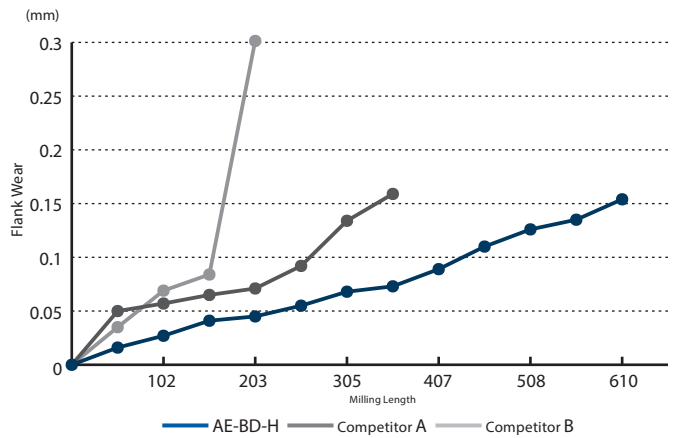

Tool	AE-BD-H R5X30	Competitor
Work Material	SKH51 (65HRC)	
Milling method	Pocket milling	
Cutting Speed	120m/min (3.850 min <sup>-1</sup> )	
Feed Rate	700mm/min (0,09 mm/t)	
Depth of Cut	ap = 0,2mm Pf = 0,5mm	
Coolant	Air Blow	
Machine	Horizontal Machining Center	

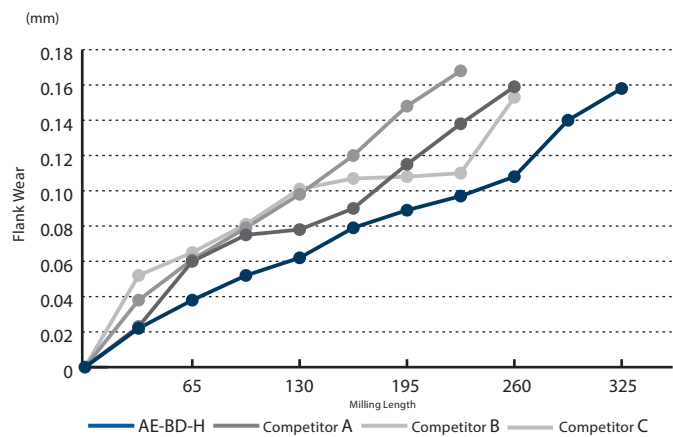

## High speed milling

Enables stable machining even in high-speed milling of STAVAX (53 HRC)

Tool	AE-BD-H R5X30	Competitor
Work Material	STAVAX (53HRC)	
Milling method	Pocket milling	
Cutting Speed	300m/min (9.550 min <sup>-1</sup> )	
Feed Rate	2.670mm/min (0,14 mm/t)	
Depth of Cut	ap = 0,2mm Pf = 0,5mm	
Coolant	Air Blow	
Machine	Horizontal Machining Center	

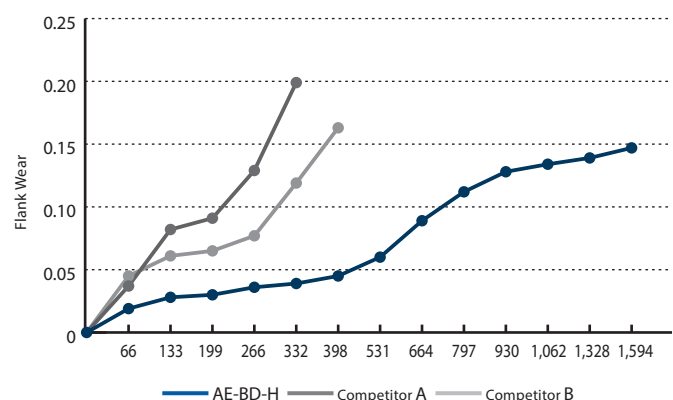

# CUTTING CONDITIONS

Milling | Endmills | Cutting conditions

## AE-BD-H

Finishing

The machining path is on condition of contouring line operation.

Vc	~45HRC		~55HRC		~62HRC		~66HRC		~70HRC	
	S (min <sup>-1</sup> )	F (mm/min)	S (min <sup>-1</sup> )	F (mm/min)	S (min <sup>-1</sup> )	F (mm/min)	S (min <sup>-1</sup> )	F (mm/min)	S (min <sup>-1</sup> )	F (mm/min)
R0,5	38.400	2.350	38.400	2.350	38.400	2.000	38.400	1.600	38.400	1.450
R0,75	38.400	3.050	38.400	3.050	38.400	2.500	31.800	1.900	25.200	1.450
R1	38.400	3.600	38.400	3.550	28.800	2.200	24.000	1.750	19.200	1.250
R1,5	31.800	4.000	25.200	3.200	19.200	2.000	16.200	1.600	12.600	1.200
R2	24.000	3.650	19.200	2.950	14.400	1.900	11.900	1.500	9.500	1.150
R2,5	19.200	3.500	15.000	2.650	11.500	1.700	9.500	1.350	7.600	1.000
R3	16.200	3.350	12.600	2.300	9.500	1.550	8.000	1.250	6.400	955
R4	11.900	2.850	9.500	2.050	7.100	1.350	5.900	1.050	4.800	830
R5	9.500	2.550	7.600	1.800	5.800	1.150	4.800	875	3.800	700
R6	8.000	2.400	6.400	1.650	4.800	955	4.000	795	3.200	635

Depth of cut	~45HRC		~55HRC		~62HRC		~66HRC		~70HRC	
	ap	Pf	ap	Pf	ap	Pf	ap	Pf	ap	Pf
	0,05D	0,1D			0,03D	0,1D			0,02D	0,5D

## AE-BD-H

High speed Finishing

The machining path is on condition of contouring line operation.

Vc	~45HRC		~55HRC		~62HRC		~66HRC		~70HRC	
	S (min <sup>-1</sup> )	F (mm/min)	S (min <sup>-1</sup> )	F (mm/min)	S (min <sup>-1</sup> )	F (mm/min)	S (min <sup>-1</sup> )	F (mm/min)	S (min <sup>-1</sup> )	F (mm/min)
R0,5	50.000	3.700	50.000	3.700	50.000	3.100	50.000	2.600	50.000	2.400
R0,75	50.000	4.800	50.000	4.800	50.000	3.900	50.000	3.050	38.400	2.300
R1	50.000	5.600	50.000	5.350	48.000	3.650	38.400	2.800	28.800	2.100
R1,5	49.800	6.200	38.400	4.800	31.800	3.350	25.200	2.550	19.200	1.900
R2	37.200	5.700	28.800	4.400	24.000	3.200	19.200	2.400	14.400	1.800
R2,5	30.000	5.450	22.800	4.000	19.200	2.850	15.600	2.150	11.500	1.600
R3	24.600	5.200	19.200	3.450	16.200	2.550	12.600	2.050	9.500	1.550
R4	18.600	4.450	14.400	3.050	11.900	2.250	9.500	1.800	7.100	1.350
R5	15.000	3.950	11.500	2.650	9.500	1.900	7.600	1.550	5.800	1.150
R6	12.600	3.700	9.500	2.500	8.000	1.600	6.400	1.350	4.800	995

Depth of cut	~45HRC		~55HRC		~62HRC		~66HRC		~70HRC	
	ap	Pf	ap	Pf	ap	Pf	ap	Pf	ap	Pf
	0,02D	0,05D					0,01D	0,05D		

1. Use a rigid and precise machine and holder.
2. We suggest using air blow or MQL (mist).
3. These milling conditions are for an end mill where the tool extension length is 4 times the diameter of the end mill. When length of the tool extension from the machine is long, reduce the speed and feed and milling depth.
4. The above condition shows an approximate standard for contouring operation (side milling) with a low machining load. If abnormal cutting sounds, vibration or chattering occur depending on the machining shape, cutting amount, rigidity of the machine or work holding condition, etc., please adjust the speed, feed and the depth of cut.
5. When the radius of curvature is less than 1.5 times the tool diameter, please reduce the speed to 50-80%, the feed rate to 50-80%, and the pick feed to 20-60% of the above shown cutting conditions.
6. When the machining incline angle (β) is more than 15°, please reduce the speed to 40-60%, the feed 30-50%, and the axial cutting depth to 30-60% of the above shown cutting conditions.
7. If the cutting depth is small, it is possible to further increase the speed and feed.

Milling | Solid carbide



# KEY FEATURES & BENEFITS

## AE-LNBD-H

2 flutes high-precision finishing long neck Carbide ball end mill for high-hardness steel

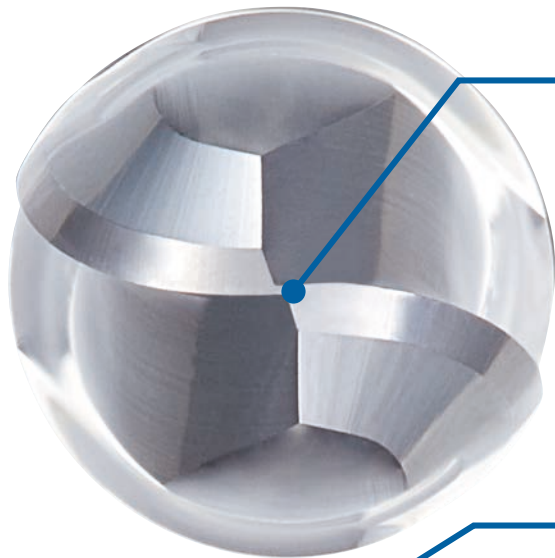

### Thickness at the center

Thickening of the center core to prevent deformation of the ball tip and improve control of chipping.

### Smooth Surface Treatment

Improves surface accuracy by smoothing the coating surface (R0,3 or above).

### Superior ball R precision

Secures stable R accuracy across 180°



### Teardrop-shaped outer periphery

Strong back taper geometry enables milling by point, which prevents chattering and chipping, resulting in improvement of surface accuracy.

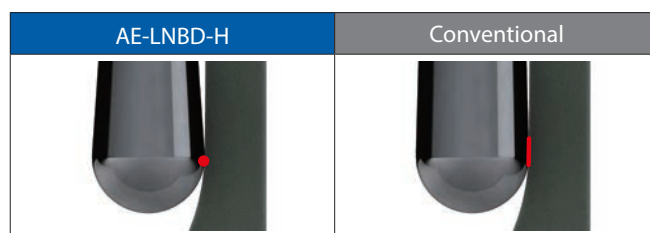

### Superior shank accuracy

Supports h4 tolerance (0/-0.004).

### Abundant variations

261 items (R0.05 to R3) are available to accommodate a wide range of applications.

Milling | Solid carbide









# AE-LNBD-H NEW

Milling | Solid carbide



Type 1

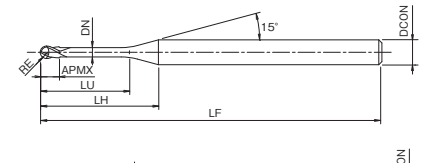

Type 2

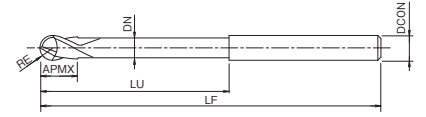

- First choice in quality and performance
- For high hardness materials
- 2 flutes, long neck type for high precision finishing

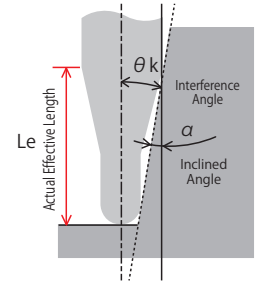

EDP	ZEFP	DC	RE	LU	LF	APMX	LH	DCON	DN	Øk	Effective length by inclined angles Le (α)*					Type	Price
											0,5°	1°	1,5°	2°	3°		
3056188	2	0,8	0,4	1	45	0,60	7,1	4	0,75	13,41°	1,11	1,14	1,16	1,19	1,26	1	
3056189	2	0,8	0,4	1,5	45	0,60	7,6	4	0,75	12,52°	1,63	1,67	1,72	1,77	1,88	1	
3056190	2	0,8	0,4	2	45	0,60	8,1	4	0,75	11,74°	2,15	2,21	2,27	2,34	2,5	1	
3056191	2	0,8	0,4	2	45	0,60	11,8	6	0,75	12,81°	2,15	2,21	2,27	2,34	2,5	1	
3056192	2	0,8	0,4	2,5	45	0,60	8,6	4	0,75	11,04°	2,66	2,74	2,83	2,92	3,12	1	
3056193	2	0,8	0,4	3	45	0,60	9,1	4	0,75	10,42°	3,18	3,28	3,38	3,49	3,75	1	
3056194	2	0,8	0,4	4	45	0,60	10,1	4	0,75	9,37°	4,21	4,35	4,49	4,64	4,99	1	
3056195	2	0,8	0,4	5	45	0,60	11,1	4	0,75	8,51°	5,25	5,42	5,6	5,79	6,23	1	
3056196	2	0,8	0,4	6	45	0,60	12,1	4	0,75	7,8°	6,28	6,49	6,71	6,94	7,48	1	
3056197	2	0,8	0,4	7	45	0,60	13,1	4	0,75	7,19°	7,31	7,55	7,81	8,09	8,72	1	
3056198	2	0,8	0,4	8	45	0,60	14,1	4	0,75	6,67°	8,35	8,62	8,92	9,24	9,96	1	
3056199	2	0,8	0,4	9	45	0,60	15,1	4	0,75	6,22°	9,38	9,69	10,03	10,39	11,2	1	
3056200	2	0,8	0,4	10	45	0,60	16,1	4	0,75	5,83°	10,41	10,76	11,14	11,54	12,45	1	
3056201	2	0,8	0,4	12	50	0,60	18,1	4	0,75	5,18°	12,48	12,9	13,36	13,84	14,93	1	
3056202	2	1	0,5	1,5	45	0,80	7,2	4	0,95	12,54°	1,63	1,66	1,71	1,75	1,86	1	
3056203	2	1	0,5	2	45	0,80	7,7	4	0,95	11,71°	2,14	2,2	2,26	2,33	2,48	1	
3056204	2	1	0,5	2	45	0,80	11,4	6	0,95	12,83°	2,14	2,2	2,26	2,33	2,48	1	
3056205	2	1	0,5	2,5	45	0,80	8,2	4	0,95	10,97°	2,66	2,73	2,82	2,9	3,1	1	
3056206	2	1	0,5	3	45	0,80	8,7	4	0,95	10,33°	3,18	3,27	3,37	3,48	3,72	1	
3056207	2	1	0,5	3	45	0,80	12,4	6	0,95	11,8°	3,18	3,27	3,37	3,48	3,72	1	
3056208	2	1	0,5	4	45	0,80	9,7	4	0,95	9,23°	4,21	4,34	4,48	4,63	4,97	1	
3056209	2	1	0,5	4	45	0,80	13,4	6	0,95	10,91°	4,21	4,34	4,48	4,63	4,97	1	
3056210	2	1	0,5	5	45	0,80	10,7	4	0,95	8,35°	5,24	5,41	5,59	5,78	6,21	1	
3056211	2	1	0,5	5	45	0,80	14,4	6	0,95	10,15°	5,24	5,41	5,59	5,78	6,21	1	
3056212	2	1	0,5	6	45	0,80	11,7	4	0,95	7,62°	6,28	6,48	6,69	6,93	7,45	1	
3056213	2	1	0,5	6	45	0,80	15,4	6	0,95	9,49°	6,28	6,48	6,69	6,93	7,45	1	
3056214	2	1	0,5	7	45	0,80	12,7	4	0,95	7°	7,31	7,55	7,8	8,08	8,69	1	
3056215	2	1	0,5	7	45	0,80	16,4	6	0,95	8,91°	7,31	7,55	7,8	8,08	8,69	1	
3056216	2	1	0,5	8	45	0,80	13,7	4	0,95	6,48°	8,34	8,62	8,91	9,23	9,94	1	
3056217	2	1	0,5	8	45	0,80	17,4	6	0,95	8,39°	8,34	8,62	8,91	9,23	9,94	1	
3056218	2	1	0,5	9	45	0,80	14,7	4	0,95	6,03°	9,38	9,69	10,02	10,38	11,18	1	
3056219	2	1	0,5	10	45	0,80	15,7	4	0,95	5,64°	10,41	10,76	11,13	11,53	12,42	1	
3056220	2	1	0,5	10	50	0,80	19,4	6	0,95	7,52°	10,41	10,76	11,13	11,53	12,42	1	
3056221	2	1	0,5	12	45	0,80	17,7	4	0,95	4,99°	12,48	12,9	13,34	13,83	14,91	1	
3056222	2	1	0,5	13	50	0,80	18,7	4	0,95	4,71°	13,51	13,97	14,45	14,98	16,15	1	
3056223	2	1	0,5	14	50	0,80	19,7	4	0,95	4,47°	14,55	15,04	15,56	16,13	17,4	1	
3056224	2	1	0,5	16	50	0,80	21,7	4	0,95	4,05°	16,61	17,18	17,78	18,43	19,88	1	
3056225	2	1	0,5	18	55	0,80	23,7	4	0,95	3,7°	18,68	19,31	19,99	20,73	22,37	1	
3056226	2	1	0,5	20	55	0,80	25,7	4	0,95	3,41°	20,75	21,45	22,21	23,03	24,86	1	
3056227	2	1	0,5	22	60	0,80	27,7	4	0,95	3,16°	22,82	23,59	24,43	25,33	27,34	1	
3056228	2	1	0,5	22	60	0,80	31,4	6	0,95	4,62°	22,82	23,59	24,43	25,33	27,34	1	
3056229	2	1,2	0,6	2	45	1,00	7,3	4	1,15	11,67°	2,14	2,19	2,25	2,31	2,46	1	
3056230	2	1,2	0,6	2	45	1,00	11,1	6	1,15	12,86°	2,14	2,19	2,25	2,31	2,46	1	
3056231	2	1,2	0,6	2,4	45	1,00	7,7	4	1,15	11,04°	2,55	2,62	2,69	2,77	2,95	1	

\* If there is no value in the actual effective length (Le column) for the work gradient angle α, it indicates no interference.

Milling | Solid carbide



# AE-LNBD-H NEW

Milling | Solid carbide



Type 1



Type 2

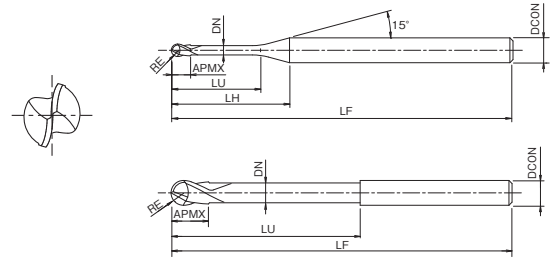

- First choice in quality and performance
- For high hardness materials
- 2 flutes, long neck type for high precision finishing

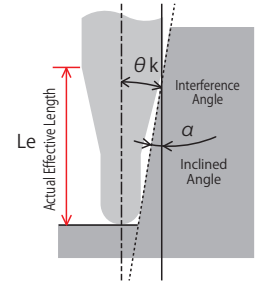

EDP	ZEFP	DC	RE	LU	LF	APMX	LH	DCON	DN	Φk	Effective length by inclined angles Le (α)*					Type	Price
											0,5°	1°	1,5°	2°	3°		
3056232	2	1,2	0,6	2,5	45	1,00	7,8	4	1,15	10,9°	2,66	2,73	2,81	2,89	3,08	1	
3056233	2	1,2	0,6	3	45	1,00	8,3	4	1,15	10,22°	3,17	3,26	3,36	3,46	3,7	1	
3056234	2	1,2	0,6	4	45	1,00	9,3	4	1,15	9,08°	4,21	4,33	4,47	4,61	4,94	1	
3056235	2	1,2	0,6	4	45	1,00	13,1	6	1,15	10,87°	4,21	4,33	4,47	4,61	4,94	1	
3056236	2	1,2	0,6	6	45	1,00	11,3	4	1,15	7,42°	6,27	6,47	6,68	6,91	7,43	1	
3056237	2	1,2	0,6	8	45	1,00	13,3	4	1,15	6,27°	8,34	8,61	8,9	9,21	9,91	1	
3056238	2	1,2	0,6	10	45	1,00	15,3	4	1,15	5,43°	10,41	10,75	11,12	11,51	12,4	1	
3056239	2	1,2	0,6	12	45	1,00	17,3	4	1,15	4,78°	12,48	12,89	13,33	13,81	14,89	1	
3056240	2	1,2	0,6	14	50	1,00	19,3	4	1,15	4,28°	14,54	15,03	15,55	16,11	17,37	1	
3056241	2	1,2	0,6	16	50	1,00	21,3	4	1,15	3,87°	16,61	17,17	17,77	18,41	19,86	1	
3056242	2	1,2	0,6	18	55	1,00	23,3	4	1,15	3,53°	18,68	19,31	19,98	20,71	22,35	1	
3056243	2	1,2	0,6	20	55	1,00	25,3	4	1,15	3,24°	20,74	21,45	22,2	23,01	24,83	1	
3056244	2	1,5	0,75	2	45	1,20	6,8	4	1,45	11,61°	2,13	2,18	2,23	2,29	2,42	1	
3056245	2	1,5	0,75	2,5	45	1,20	7,3	4	1,45	10,76°	2,65	2,72	2,79	2,87	3,04	1	
3056246	2	1,5	0,75	3	45	1,20	7,8	4	1,45	10,03°	3,17	3,25	3,34	3,44	3,66	1	
3056247	2	1,5	0,75	3	45	1,20	11,5	6	1,45	11,75°	3,17	3,25	3,34	3,44	3,66	1	
3056248	2	1,5	0,75	4	45	1,20	8,8	4	1,45	8,81°	4,2	4,32	4,45	4,59	4,91	1	
3056249	2	1,5	0,75	5	45	1,20	9,8	4	1,45	7,86°	5,23	5,39	5,56	5,74	6,15	1	
3056250	2	1,5	0,75	5	45	1,20	13,5	6	1,45	9,97°	5,23	5,39	5,56	5,74	6,15	1	
3056251	2	1,5	0,75	6	45	1,20	10,8	4	1,45	7,09°	6,27	6,46	6,67	6,89	7,39	1	
3056252	2	1,5	0,75	6	45	1,20	14,5	6	1,45	9,26°	6,27	6,46	6,67	6,89	7,39	1	
3056253	2	1,5	0,75	8	45	1,20	12,8	4	1,45	5,93°	8,34	8,6	8,88	9,19	9,88	1	
3056254	2	1,5	0,75	8	45	1,20	16,5	6	1,45	8,11°	8,34	8,6	8,88	9,19	9,88	1	
3056255	2	1,5	0,75	10	45	1,20	14,8	4	1,45	5,09°	10,4	10,74	11,1	11,49	12,36	1	
3056256	2	1,5	0,75	12	45	1,20	16,8	4	1,45	4,46°	12,47	12,88	13,32	13,79	14,85	1	
3056257	2	1,5	0,75	14	50	1,20	18,8	4	1,45	3,97°	14,54	15,02	15,53	16,09	17,34	1	
3056258	2	1,5	0,75	16	50	1,20	20,8	4	1,45	3,58°	16,6	17,16	17,75	18,39	19,82	1	
3056259	2	1,5	0,75	18	55	1,20	22,8	4	1,45	3,25°	18,67	19,3	19,97	20,69	22,31	1	
3056260	2	1,5	0,75	20	55	1,20	24,8	4	1,45	2,98°	20,74	21,44	22,18	22,99	-	1	
3056261	2	1,5	0,75	22	60	1,20	26,8	4	1,45	2,75°	22,81	23,58	24,4	25,29	-	1	
3056262	2	1,5	0,75	25	65	1,20	29,8	4	1,45	2,47°	25,91	26,79	27,73	28,74	-	1	
3056263	2	1,5	0,75	30	70	1,20	34,8	4	1,45	2,11°	31,08	32,13	33,27	34,49	-	1	
3056264	2	1,6	0,8	4	45	1,30	8,6	4	1,55	8,72°	4,2	4,32	4,45	4,58	4,89	1	
3056265	2	1,6	0,8	8	45	1,30	12,6	4	1,55	5,81°	8,33	8,6	8,88	9,18	9,87	1	
3056266	2	1,6	0,8	12	45	1,30	16,6	4	1,55	4,35°	12,47	12,88	13,31	13,78	14,84	1	
3056267	2	1,6	0,8	16	50	1,30	20,6	4	1,55	3,47°	16,6	17,15	17,75	18,38	19,81	1	
3056268	2	1,6	0,8	20	55	1,30	24,6	4	1,55	2,89°	20,74	21,43	22,18	22,98	-	1	
3056269	2	2	1	2,5	45	1,60	6,3	4	1,95	10,46°	2,64	2,7	2,76	2,83	2,98	1	
3056270	2	2	1	3	45	1,60	6,8	4	1,95	9,61°	3,16	3,23	3,32	3,4	3,6	1	
3056271	2	2	1	3	45	1,60	10,6	6	1,95	11,7°	3,16	3,23	3,32	3,4	3,6	1	
3056272	2	2	1	4	45	1,60	7,8	4	1,95	8,25°	4,19	4,3	4,42	4,55	4,85	1	
3056273	2	2	1	4	45	1,60	11,6	6	1,95	10,64°	4,19	4,3	4,42	4,55	4,85	1	
3056274	2	2	1	5	45	1,60	8,8	4	1,95	7,23°	5,23	5,37	5,53	5,7	6,09	1	
3056275	2	2	1	6	45	1,60	9,8	4	1,95	6,43°	6,26	6,44	6,64	6,85	7,33	1	

\* If there is no value in the actual effective length (Le column) for the work gradient angle α, it indicates no interference.

Milling | Solid carbide

# AE-LNBD-H NEW

Milling | Solid carbide

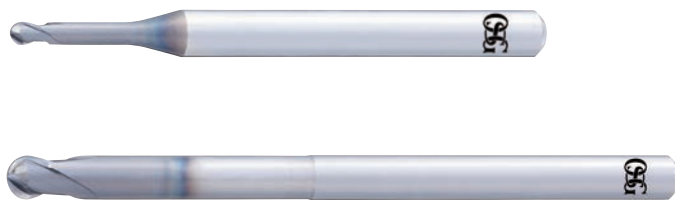

Type 1

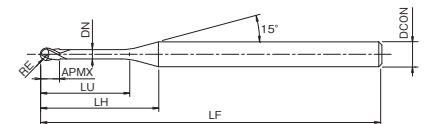

Type 2

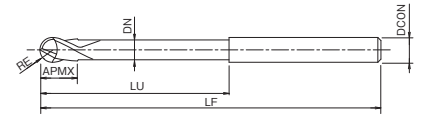

- First choice in quality and performance
- For high hardness materials
- 2 flutes, long neck type for high precision finishing

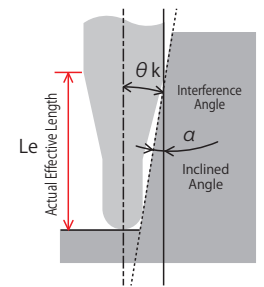

**P**  
~45 HRC

**P**  
~55 HRC

**M**  
~35 HRC

**K**  
~350 HB

**S**

**H**  
~60 HRC

**H**  
~65 HRC

**H**  
~70 HRC

**A**

CARBIDE

DUREX

30°

SHRINK  
FIT

SHRINK  
h4

± 0,003  
R ≤ 0,25

± 0,005  
0,25 < R

EDP	ZEFP	DC	RE	LU	LF	APMX	LH	DCON	DN	Φk	Effective length by inclined angles Le (α)*					Type	Price
											0,5°	1°	1,5°	2°	3°		
3056276	2	2	1	6	45	1,60	13,6	6	1,95	9°	6,26	6,44	6,64	6,85	7,33	1	
3056277	2	2	1	8	45	1,60	11,8	4	1,95	5,26°	8,33	8,58	8,86	9,15	9,82	1	
3056278	2	2	1	8	45	1,60	15,6	6	1,95	7,79°	8,33	8,58	8,86	9,15	9,82	1	
3056279	2	2	1	10	45	1,60	13,8	4	1,95	4,45°	10,39	10,72	11,07	11,45	12,31	1	
3056280	2	2	1	10	50	1,60	17,6	6	1,95	6,87°	10,39	10,72	11,07	11,45	12,31	1	
3056281	2	2	1	12	45	1,60	15,8	4	1,95	3,86°	12,46	12,86	13,29	13,75	14,79	1	
3056282	2	2	1	12	50	1,60	19,6	6	1,95	6,14°	12,46	12,86	13,29	13,75	14,79	1	
3056283	2	2	1	13	50	1,60	16,8	4	1,95	3,61°	13,5	13,93	14,4	14,9	16,04	1	
3056284	2	2	1	14	50	1,60	17,8	4	1,95	3,4°	14,53	15	15,51	16,05	17,28	1	
3056285	2	2	1	16	50	1,60	19,8	4	1,95	3,04°	16,6	17,14	17,72	18,35	19,76	1	
3056286	2	2	1	16	55	1,60	23,6	6	1,95	5,06°	16,6	17,14	17,72	18,35	19,76	1	
3056287	2	2	1	18	55	1,60	21,8	4	1,95	2,75°	18,66	19,28	19,94	20,65	-	1	
3056288	2	2	1	20	55	1,60	23,8	4	1,95	2,51°	20,73	21,42	22,16	22,95	-	1	
3056289	2	2	1	20	60	1,60	27,6	6	1,95	4,31°	20,73	21,42	22,16	22,95	24,74	1	
3056290	2	2	1	22	60	1,60	25,8	4	1,95	2,31°	22,8	23,56	24,37	25,25	-	1	
3056291	2	2	1	25	65	1,60	28,8	4	1,95	2,06°	25,9	26,77	27,7	28,7	-	1	
3056292	2	2	1	25	65	1,60	32,6	6	1,95	3,63°	25,9	26,77	27,7	28,7	30,95	1	
3056293	2	2	1	30	70	1,60	33,8	4	1,95	1,75°	31,07	32,12	33,24	-	-	1	
3056294	2	2	1	35	70	1,60	38,8	4	1,95	1,52°	36,24	37,46	38,78	-	-	1	
3056295	2	2	1	40	80	1,60	43,8	4	1,95	1,34°	41,4	42,81	-	-	-	1	
3056296	2	2,5	1,25	6	45	2,00	9,1	4	2,35	5,44°	6,44	6,63	6,82	7,03	7,51	1	
3056297	2	2,5	1,25	8	45	2,00	11,1	4	2,35	4,35°	8,51	8,77	9,04	9,33	9,99	1	
3056298	2	2,5	1,25	10	45	2,00	13,1	4	2,35	3,62°	10,58	10,9	11,25	11,63	12,48	1	
3056299	2	2,5	1,25	15	50	2,00	18,1	4	2,35	2,55°	15,75	16,25	16,8	17,38	-	1	
3056300	2	2,5	1,25	20	55	2,00	23,1	4	2,35	1,97°	20,92	21,6	22,34	-	-	1	
3056301	2	2,5	1,25	25	65	2,00	28,1	4	2,35	1,61°	26,08	26,95	27,88	-	-	1	
3056302	2	2,5	1,25	30	70	2,00	33,1	4	2,35	1,35°	31,25	32,3	-	-	-	1	
3056303	2	2,5	1,25	35	70	2,00	38,1	4	2,35	1,17°	36,42	37,65	-	-	-	1	
3056304	2	3	1,5	6	50	2,40	11,9	6	2,85	8,15°	6,44	6,61	6,79	7	7,45	1	
3056305	2	3	1,5	8	50	2,40	13,9	6	2,85	6,87°	8,5	8,75	9,01	9,29	9,93	1	
3056306	2	3	1,5	10	50	2,40	15,9	6	2,85	5,93°	10,57	10,89	11,23	11,59	12,42	1	
3056307	2	3	1,5	12	55	2,40	17,9	6	2,85	5,22°	12,64	13,03	13,44	13,89	14,91	1	
3056308	2	3	1,5	13	55	2,40	18,9	6	2,85	4,92°	13,67	14,1	14,55	15,04	16,15	1	
3056309	2	3	1,5	14	55	2,40	19,9	6	2,85	4,66°	14,71	15,17	15,66	16,19	17,39	1	
3056310	2	3	1,5	15	55	2,40	20,9	6	2,85	4,42°	15,74	16,24	16,77	17,34	18,63	1	
3056311	2	3	1,5	16	55	2,40	21,9	6	2,85	4,2°	16,77	17,31	17,88	18,49	19,88	1	
3056312	2	3	1,5	20	60	2,40	25,9	6	2,85	3,52°	20,91	21,58	22,31	23,09	24,85	1	
3056313	2	3	1,5	25	65	2,40	30,9	6	2,85	2,92°	26,08	26,93	27,85	28,84	-	1	
3056314	2	3	1,5	30	70	2,40	35,9	6	2,85	2,5°	31,24	32,28	33,39	34,59	-	1	
3056315	2	3	1,5	35	80	2,40	40,9	6	2,85	2,18°	36,41	37,63	38,94	40,34	-	1	
3056316	2	3	1,5	40	90	2,40	45,9	6	2,85	1,94°	41,58	42,98	44,48	-	-	1	
3056317	2	3,5	1,75	10	50	2,80	14,9	6	3,35	5,38°	10,56	10,87	11,2	11,56	12,36	1	
3056318	2	3,5	1,75	15	55	2,80	19,9	6	3,35	3,92°	15,73	16,22	16,74	17,31	18,58	1	
3056319	2	3,5	1,75	16	55	2,80	20,9	6	3,35	3,72°	16,76	17,29	17,85	18,46	19,82	1	

\* If there is no value in the actual effective length (Le column) for the work gradient angle α, it indicates no interference.



# AE-LNBD-H NEW

Milling | Solid carbide



Type 1



Type 2

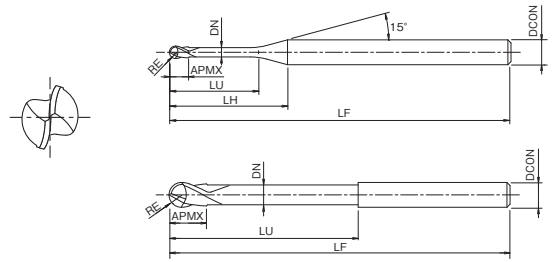

- First choice in quality and performance
- For high hardness materials
- 2 flutes, long neck type for high precision finishing

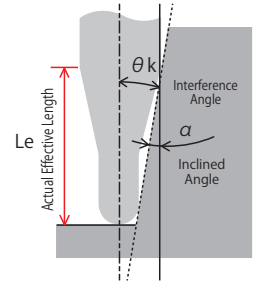

EDP	ZEFP	DC	RE	LU	LF	APMX	LH	DCON	DN	Φk	Effective length by inclined angles Le (α)*					Type	Price
											0,5°	1°	1,5°	2°	3°		
3056320	2	3,5	1,75	20	60	2,80	24,9	6	3,35	3,08°	20,9	21,57	22,28	23,06	24,79	1	
3056321	2	3,5	1,75	25	65	2,80	29,9	6	3,35	2,54°	26,07	26,92	27,83	28,81	-	1	
3056322	2	3,5	1,75	30	70	2,80	34,9	6	3,35	2,16°	31,24	32,26	33,37	34,55	-	1	
3056323	2	3,5	1,75	35	80	2,80	39,9	6	3,35	1,88°	36,4	37,61	38,91	-	-	1	
3056324	2	3,5	1,75	40	90	2,80	44,9	6	3,35	1,66°	41,57	42,96	44,45	-	-	1	
3056325	2	3,5	1,75	45	90	2,80	49,9	6	3,35	1,49°	46,74	48,31	-	-	-	1	
3056326	2	4	2	8	55	3,20	-	4	3,85	-	-	-	-	-	-	2	
3056327	2	4	2	8	55	3,20	12	6	3,85	5,65°	8,49	8,71	8,96	9,22	9,81	1	
3056328	2	4	2	10	60	3,20	14	6	3,85	4,73°	10,55	10,85	11,17	11,52	12,3	1	
3056329	2	4	2	12	60	3,20	16	6	3,85	4,07°	12,62	12,99	13,39	13,82	14,79	1	
3056330	2	4	2	13	60	3,20	17	6	3,85	3,8°	13,65	14,06	14,5	14,97	16,03	1	
3056331	2	4	2	14	60	3,20	18	6	3,85	3,56°	14,69	15,13	15,61	16,12	17,27	1	
3056332	2	4	2	15	60	3,20	19	6	3,85	3,36°	15,72	16,2	16,72	17,27	18,52	1	
3056333	2	4	2	16	60	3,20	20	6	3,85	3,17°	16,76	17,27	17,82	18,42	19,76	1	
3056334	2	4	2	20	65	3,20	24	6	3,85	2,6°	20,89	21,55	22,26	23,02	-	1	
3056335	2	4	2	25	70	3,20	29	6	3,85	2,12°	26,06	26,9	27,8	28,77	-	1	
3056336	2	4	2	30	80	3,20	34	6	3,85	1,79°	31,23	32,25	33,34	-	-	1	
3056337	2	4	2	35	80	3,20	39	6	3,85	1,55°	36,4	37,6	38,88	-	-	1	
3056338	2	4	2	40	90	3,20	44	6	3,85	1,37°	41,56	42,94	-	-	-	1	
3056339	2	4	2	45	90	3,20	49	6	3,85	1,22°	46,73	48,29	-	-	-	1	
3056340	2	4	2	50	100	3,20	54	6	3,85	1,11°	51,9	53,64	-	-	-	1	
3056341	2	5	2,5	10	60	4,00	12,1	6	4,85	2,95°	10,54	10,82	11,12	11,45	-	1	
3056342	2	5	2,5	15	60	4,00	17,1	6	4,85	1,95°	15,71	16,17	16,66	-	-	1	
3056343	2	5	2,5	20	70	4,00	22,1	6	4,85	1,46°	20,87	21,52	-	-	-	1	
3056344	2	5	2,5	25	70	4,00	27,1	6	4,85	1,17°	26,04	26,86	-	-	-	1	
3056345	2	5	2,5	30	80	4,00	32,1	6	4,85	0,97°	31,21	-	-	-	-	1	
3056346	2	5	2,5	35	80	4,00	37,1	6	4,85	0,83°	36,38	-	-	-	-	1	
3056347	2	5	2,5	40	90	4,00	42,1	6	4,85	0,73°	41,55	-	-	-	-	1	
3056348	2	5	2,5	45	100	4,00	47,1	6	4,85	0,65°	46,72	-	-	-	-	1	
3056349	2	5	2,5	50	100	4,00	52,1	6	4,85	0,58°	51,88	-	-	-	-	1	
3056350	2	6	3	10	60	4,80	-	6	5,85	-	-	-	-	-	-	2	
3056351	2	6	3	12	60	4,80	-	6	5,85	-	-	-	-	-	-	2	
3056352	2	6	3	15	65	4,80	-	6	5,85	-	-	-	-	-	-	2	
3056353	2	6	3	20	70	4,80	-	6	5,85	-	-	-	-	-	-	2	
3056354	2	6	3	25	70	4,80	-	6	5,85	-	-	-	-	-	-	2	
3056355	2	6	3	30	80	4,80	-	6	5,85	-	-	-	-	-	-	2	
3056356	2	6	3	35	80	4,80	-	6	5,85	-	-	-	-	-	-	2	
3056357	2	6	3	40	90	4,80	-	6	5,85	-	-	-	-	-	-	2	
3056358	2	6	3	45	100	4,80	-	6	5,85	-	-	-	-	-	-	2	
3056359	2	6	3	50	120	4,80	-	6	5,85	-	-	-	-	-	-	2	
3056360	2	6	3	60	120	4,80	-	6	5,85	-	-	-	-	-	-	2	

\* If there is no value in the actual effective length (Le column) for the work gradient angle α, it indicates no interference.

## Stable Performance

Exhibits superior durability in SKD11 (60 HRC).

Tool	AE-LNBD-H R1X10X4	Competitor
Work Material	SKD11 (60HRC)	
Milling method	Scanning line cutting	
Cutting Speed	107m/min (17.000 min <sup>-1</sup> )	
Feed Rate	1.400mm/min (0,041 mm/t)	
Depth of Cut	ap = 0,05mm Pf = 0,1mm	
Coolant	Air Blow	
Machine	Vertical Machining Center	

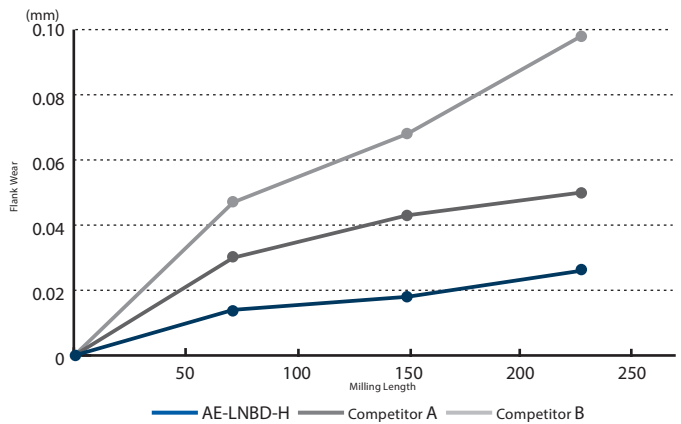

## Long Tool Life

Exhibits superior durability in hot die steel DH31S.

Tool	AE-LNBD-H R1X10X4	Competitor
Work Material	DH31S (43HRC)	
Milling method	Pocket milling	
Cutting Speed	88m/min (14.000 min <sup>-1</sup> )	
Feed Rate	1.000mm/min (0,036 mm/t)	
Depth of Cut	ap = 0,05mm Pf = 0,1mm	
Coolant	Air Blow	
Machine	Horizontal Machining Center	

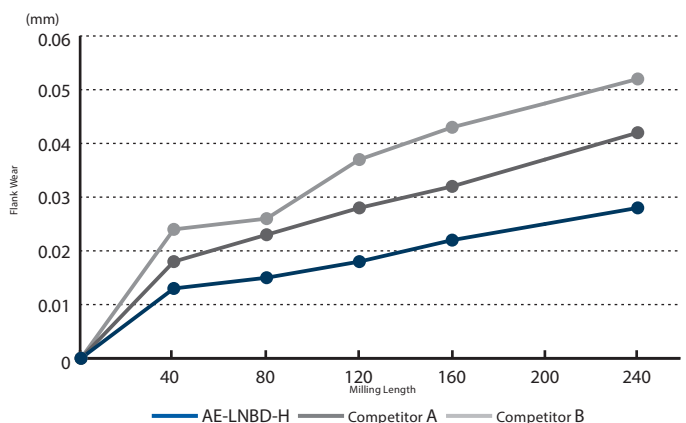

## Finishing

Enables excellent durability and surface finishing in STAVAX (53 HRC)

Tool	AE-LNBD-H R1X10X4	Competitor
Work Material	STAVAX (53 HRC)	
Milling method	Scanning line cutting	
Cutting Speed	150m/min (24.000 min <sup>-1</sup> )	
Feed Rate	2.400mm/min (0,05 mm/t)	
Depth of Cut	ap = 0,05mm Pf = 0,1mm	
Coolant	Air Blow	
Machine	Vertical Machining Center	

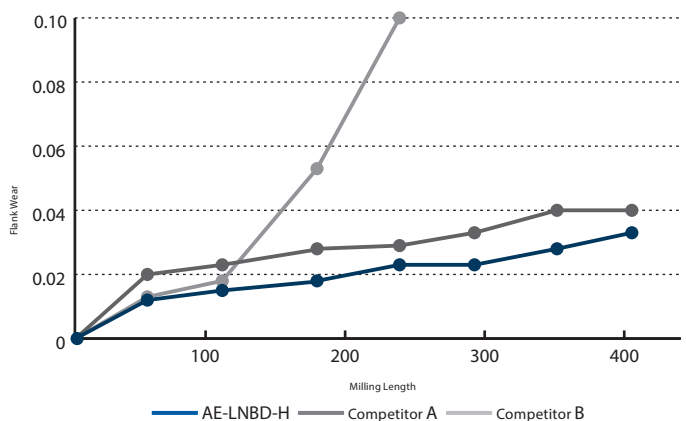









# CUTTING CONDITIONS

Milling | Endmills | Cutting conditions

## AE-LNBD-H

The machining path is on condition of contouring line operation.

RE		ToolSteel • Hardened Steel • Prehardened Steel SKD11 • SKD61 • NAK80				Hardened Steel															
		~45HRC				~55HRC				~62HRC				~66HRC				~70HRC			
LU	(mm)	S (min <sup>-1</sup> )	F (mm/min)	ap	Pf	S (min <sup>-1</sup> )	F (mm/min)	ap	Pf	S (min <sup>-1</sup> )	F (mm/min)	ap	Pf	S (min <sup>-1</sup> )	F (mm/min)	ap	Pf	S (min <sup>-1</sup> )	F (mm/min)	ap	Pf
R3	10	26.400	5.600	0,3	0,5	21.600	3.800	0,3	0,5	18.600	2.800	0,1	0,2	16.800	2.380	0,1	0,2	13.400	1.790	0,1	0,20
R3	12	24.000	5.200	0,3	0,5	19.200	3.400	0,3	0,5	16.200	2.500	0,1	0,2	14.600	2.130	0,1	0,2	11.700	1.600	0,1	0,20
R3	15	22.200	4.800	0,3	0,5	17.400	3.250	0,3	0,5	14.400	1.850	0,1	0,2	13.000	1.570	0,1	0,2	10.400	1.180	0,1	0,20
R3	20	19.200	3.900	0,3	0,5	14.400	3.000	0,3	0,5	9.600	1.600	0,1	0,2	8.700	1.360	0,1	0,2	7.000	1.020	0,1	0,20
R3	25	14.400	3.000	0,3	0,5	12.000	2.500	0,3	0,5	7.200	1.200	0,1	0,2	6.500	1.020	0,1	0,2	5.200	770	0,1	0,20
R3	30	12.000	2.400	0,3	0,5	10.800	2.100	0,3	0,5	4.800	740	0,1	0,2	4.400	630	0,1	0,2	3.500	470	0,1	0,20
R3	35	10.800	2.100	0,2	0,4	10.800	2.000	0,2	0,4	4.200	620	0,1	0,2	3.800	530	0,1	0,2	3.100	400	0,1	0,20
R3	40	10.800	1.900	0,2	0,3	10.800	1.800	0,2	0,3	3.600	480	0,1	0,2	3.300	410	0,1	0,2	2.600	310	0,1	0,20
R3	45	9.600	1.700	0,2	0,3	9.600	1.600	0,2	0,3	3.400	440	0,1	0,2	3.100	370	0,1	0,2	2.500	280	0,1	0,20
R3	50	8.400	1.500	0,2	0,3	8.400	1.400	0,2	0,3	3.000	400	0,1	0,2	2.700	340	0,1	0,2	2.200	260	0,1	0,20
R3	60	7.200	1.250	0,2	0,3	7.200	1.150	0,2	0,3	2.800	350	0,1	0,2	2.500	300	0,1	0,2	2.000	230	0,1	0,20

1. Use a rigid and precise machine and holder.
2. When machining carbon steels or hardened steels, using MQL (Minimum Quantity Lubrication / oil mist coolant) or air blow is recommended.
3. Use an air blow or a suitable cutting fluid with high smoke retardant properties.
4. The above cutting conditions are for contouring operation with low-load and stable condition. Refer to the table above to set the milling conditions in accordance with the actual situation.
5. Please adjust conditions based on machining accuracy, machining shape and machining path.
6. When using a tool with a diameter of  $\phi$  0.5 (R0.25) or less, or L/D (aspect ratio) is greater than 10, high loads can cause tool breakage. Therefore, adjust the cutting conditions based on the machining situation.
7. When RPM are insufficient, please reduce the RPM and feed rates at same ratio as listed above.

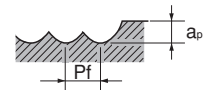

## SWEDEN

Branch office of OSG SCANDINAVIA  
Abrahams Gränd 8  
295 35 Bromölla  
Sweden  
Tel: +46 40 41 22 55  
osg@osg-scandinavia.com

## OSG SCANDINAVIA

(For Scandinavian countries)  
Langebjergvaenget 16  
4000 Roskilde  
Denmark  
Tel: +45 46 75 65 55  
osg@osg-scandinavia.com

## OSG NETHERLANDS

Bedrijfsweg 5  
3481 MG Harmelen  
The Netherlands  
Tel: +31 348 44 2764  
Fax: +31 348 44 2144  
info@osg-nl.com

## OSG UK

Shelton house, 5 Bentalls  
Pipps Hill Ind Est, Basildon Essex SS14 3BY  
United Kingdom  
Tel: +44 1268 567660  
Fax: +44 1268 567661  
sales@osg-uk.com

## OSG EUROPE LOGISTICS

Avenue Lavoisier 1  
B-1300 Z.I. Wavre - Nord  
Belgium  
Tel: +32 10 23 05 07  
Fax: +32 10 23 05 51  
info@osgeurope.com

## OSG BELUX

Avenue Lavoisier 1  
B-1300 Z.I. Wavre - Nord  
Belgium  
Tel: +32 10 23 05 11  
Fax: +32 10 23 05 31  
info@osg-belgium.com

## OSG IBÉRICA

Bekolarra 4  
E - 01010 Vitoria-Gasteiz  
Spain  
Tel: +34 945 242 400  
Fax: +34 945 228 883  
osg.iberica@osg-ib.com

## OSG FRANCE

Parc Icade, Paris Nord 2  
Immeuble "Le Rimbaud"  
22 Avenue des Nations  
CS66191 - 93420 Villepinte  
France  
Tel: +33 1 49 90 10 10  
Fax: +33 1 49 90 10 15  
sales@osg-france.com

## OSG ITALY

Via Cirenaica n. 52 int. 61/63  
I - 10142 Torino  
Italien  
Tel: +39 0117705211  
Fax: +39 0117705215  
info@osg-italia.it



# OSG IN EUROPE

## CZECH REPUBLIC, SLOVAKIA, HUNGARY

OSG Europe Logistics S. A.  
Slovakia, organizačná zložka  
Račianska 22/A, Bratislava 831 02  
Slovakia  
Tel.: +421 24 32 91 295  
info@osgeurope.com

## OSG POLAND

ul. Spółdzielcza 57  
05-074 Halinów  
Polska  
Tel: +22 760 82 71  
Mob. +48 570 677 711  
osg@osg-poland.com

## OSG RUSSIA

Butlerova street, 17B, office 5069  
117342 Moscow  
Russia  
Tel: +7 (495) 150 41 54  
info@osg-russia.com

## ROMSAN INTERNATIONAL CO. SRL

Reprezentant Exclusiv OSG  
25C, Bucuresti-Magurele Street  
051431 Bucuresti  
România  
Tel: +40 21 322 07 47  
Fax: +40 21 321 56 00  
romsan.int@romsan.ro

## OSG TURKEY

Rami Kışla Cad.No:56 Eyüp  
Istanbul 34056  
Turkey  
Tel: +90 212 565 24 00  
Fax: +90 212 565 44 00  
info@osg-turkey.com

## Vischer & Bolli AG

Machining and Workholding  
Im Schossacher 17  
CH-8600 Dübendorf  
Schweiz  
Tel.: +41 44 802 15 15  
Fax: +41 44 802 15 95  
info@vb-tools.com

## OSG GERMANY

Karl-Ehmann-Str. 25  
D - 73037 Göppingen  
Germany  
Tel: +49 7161 6064 - 0  
Fax: +49 7161 6064 - 444  
info@osg-germany.de



shaping your dreams

#### **OSG EUROPE LOGISTICS**

Avenue Lavoisier 1  
B-1300 Z.I. Wavre - Nord - Belgium  
Tel: +32 10 23 05 07  
Fax: +32 10 23 05 51  
info@osgeurope.com

#### **OSG BELUX**

Avenue Lavoisier 1  
B-1300 Z.I. Wavre - Nord - Belgium  
Tel: +32 10 23 05 11  
Fax: +32 10 23 05 31  
info@osg-belgium.com

#### **OSG FRANCE**

Parc Icade, Paris Nord 2  
Immeuble "Le Rimbaud"  
22 Avenue des Nations  
CS66191 - 93420 Villepinte - France  
Tel: +33 1 49 90 10 10  
Fax: +33 1 49 90 10 15  
sales@osg-france.com

#### **OSG NETHERLANDS**

Bedrijfsweg 5 - 3481 MG Harmelen  
Tel: +31 348 44 2764  
Fax: +31 348 44 2144  
info@osg-nl.com

#### **OSG UK**

Shelton house, 5 Bentalls  
Pipps Hill Ind Est, Basildon Essex SS14 3BY  
Tel: +44 1268 567 660  
Fax: +44 1268 567 661  
sales@osg-uk.com

#### **CZECH, SLOVAKIA, HUNGARY**

OSG Europe Logistics S.A.  
Slovakia organizacna zlozka  
Racianská 22/A, SK-83102 Bratislava  
Slovakia  
Tel. +421 24 32 91 295  
Orders-osgsvk@osgeurope.com

#### **OSG POLAND Sp. z.o.o.**

Spółdzielcza 57  
05-074 Halinów - Poland  
Tel: +22 760 82 71  
Fax: +22 760 82 71  
osg@osg-poland.com

#### **OSG GERMANY**

Karl-Ehmann-Str. 25  
D - 73037 Göppingen - Germany  
Tel: +49 7161 6064 - 0  
Fax: +49 7161 6064 - 444  
info@osg-germany.de

#### **OSG SCANDINAVIA**

(For Scandinavian countries)  
Langebjergvaenget 16  
4000 Roskilde - Denmark  
Tel: +45 46 75 65 55  
Fax: +45 46 75 67 00  
osg@osg-scandinavia.com

#### **SWEDEN**

Branch office of OSG SCANDINAVIA  
Abrahams Gränd 8  
295 35 Bromölla - Sweden  
Tel: +46 40 41 22 55  
Fax: +46 40 41 32 55  
osg@osg-scandinavia.com

#### **OSG IBERICA**

Bekolarra 4  
E - 01010 Vitoria-Gasteiz - Spain  
Tel: +34 945 242 400  
Fax: +34 945 228 883  
osg.iberica@osg-ib.com

#### **RUSSIA**

Butlerova street, 17B, office 5069  
117342 Moscow - Russia  
Tel: +7 (495) 150 41 54  
info@osg-russia.com

#### **OSG TURKEY**

Rami Kişla Cad.No:56 Eyüp  
Istanbul 34056 - Turkey  
Tel:+90 212 565 24 00  
Fax: +90 212 565 44 00  
info@osg-turkey.com

#### **ROMSAN INTERNATIONAL CO. SRL**

Reprezentant Exclusiv OSG  
25C, Bucuresti-Magurele Street  
051431 Bucuresti - România  
Tel: +40 21 322 07 47  
Fax: +40 21 321 56 00  
romsan.int@romsan.ro

#### **AUSTRIA**

Branch office of OSG GERMANY  
Messestraße 11  
A-6850 Dornbirn  
Tel: +49 7161 6064-0  
Fax: +49 7161 6064-444  
info@osg-germany.de

#### **OSG ITALIA**

Via Cirenaiica n. 52 int. 61/63  
I - 10142 Torino - Italy  
Tel: +39 0117705211  
Fax: +39 0117705215  
info@osg-italia.it

#### **Vischer & Bolli AG**

Machining and Workholding  
Im Schossacher 17  
CH-8600 Dübendorf  
T +41 44 802 15 15  
F +41 44 802 15 95  
info@vb-tools.com

#### **OSG EUROPE LOGISTICS S.A.**

01/2020 - All rights reserved. © OSG Europe 2020.

The contents of this catalogue are provided to you for viewing only. They are not intended for reproduction either in part or in whole in this or other medium. They cannot be copied, used to create derivation work or used for any reason, by means without the express, written permission of the copyright owner. If prices are stated, they are netto unit-prices and any eventual tax(es) have to be added. The company is not responsible for any printing error in technical, price and/or any other data.

Tool specifications subject to change without notice.

[www.osgeurope.com](http://www.osgeurope.com)