

Elevator Buckets

Cangilones Elevadores



www.go4b.com

Bucket Types

| | |
|-------------|---------------------|
| S | Starco |
| SPS | Super Starco |
| SJ | Starco Jumbo |
| J | American Grain |
| CC-S | American Grain |
| GB | Spidex Bottomless |
| G | Columbus |
| H | Continental |
| A | Shallow Pattern |
| B | Medium Pattern |
| C | Medium Deep Pattern |
| D | Deep Pattern |
| F | Angle Back Pattern |
| AA | Atlas |
| MF | Atlas |
| AD | Atlas |
| AM | Atlas |
| NBA | Polypenco |
| DIN | Polypenco |
| AA | Budd |



BETTER BY DESIGN

BUCKET Selection Guide

Guía de selección de cangilones



www.go4b.com

FREE Engineering Design Service -
 contact 4B or visit
www.go4b.co.uk/uk/elevator-design-service.asp

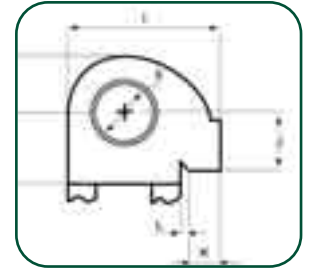

| Property | Mild Steel | Stainless 304 | Stainless 316 | HDP | Nylon 6 | Reinforced Nylon | Polyurethane | Nyrim |
|---------------------------------|------------|---------------|---------------|-------|---------|------------------|--------------|-----------|
| Cost | 1 | 3 | 4 | 1 | 2 | 3 | 4 | 4 |
| Wear Resistance | 3 | 4 | 4 | 1 | 2 | 3 | 3 | 4 |
| Impact Resistance | 2 | 2 | 2 | 1 | 2 | 3 | 2 | 4 |
| Non-Stick | 1 | 3 | 3 | 2 | 3 | 3 | 4 | 3 |
| FDA Food Approved | X | ✓ | ✓ | ✓ | ✓ | ✓ | X | X |
| Max Temp °C Continuous # | 180+ | 250+ | 250+ | 70 | 100 | 110 | 60 | 110 |
| Max Temp °C Peak # | 200 | 400 | 400 | 80 | 120 | 130 | 70 | 130 |
| Colour | Grey | Silver | Silver | White | Cream | Beige | Green* | Dark Grey |

Code 1 = Low 4 = high * Other colours on request # Refer to our technical department

| Material/Applications | Mild Steel | Stainless 304 | Stainless 316 | HDP | Nylon 6 | Reinforced Nylon | Polyurethane | Nyrim |
|---|---|--|---------------------------|--|--|------------------------------------|---|-------|
| General purpose, long life, cereals and industrial products | Food, corrosive and high temperature products | Food, highly corrosive and high temperature products | Cereals and food products | Hot, abrasive and sticky products (FDA approved) | Hot, highly abrasive and sticky industrial products (FDA on request) | Sharp, cutting and sticky products | Extremely abrasive, high impact industrial products | |

| Propiedad | Acero | Acero Inoxidable 304 | Acero Inoxidable 316 | HDP | Nylon 6 | Nylon Reforzado | Poliuretano | Nyrim |
|---------------------------------|-------|----------------------|----------------------|--------|---------|-----------------|-------------|-------------|
| Precio | 1 | 3 | 4 | 1 | 2 | 3 | 4 | 4 |
| Resistencia al desgaste | 3 | 4 | 4 | 1 | 2 | 3 | 3 | 4 |
| Resistencia al impacto | 2 | 2 | 2 | 1 | 2 | 3 | 2 | 4 |
| Antiadherente | 1 | 3 | 3 | 2 | 3 | 3 | 4 | 3 |
| Grado alimentario | X | ✓ | ✓ | ✓ | ✓ | ✓ | X | X |
| Temp Max °C de trabajo # | 180+ | 250+ | 250+ | 70 | 100 | 110 | 60 | 110 |
| Temp Max °C de pico # | 200 | 400 | 400 | 80 | 120 | 130 | 70 | 130 |
| Color | Gris | Plata | Plata | Blanco | Crema | Beige | Verde* | Gris Oscuro |

Codigo 1 = Bajo 4 = Alto * Otros colores a convenir # Consultar Dto. Técnico

| Material/Applicaciones | Acero | Acero Inox. 304 | Acero Inox. 316 | HDP | Nylon 6 | Nylon Reforzado | Poliuretano | Nyrim |
|---|--|--|-----------------------------------|--|--|---|---|-------|
| Aplicaciones generales, larga duración, cereales y productos industriales | Alimentación, corrosiva y productos a altas temperaturas | Alimentación, altamente corrosiva y productos a altas temperaturas | Cereales y productos alimenticios | Productos a altas temperaturas, abrasivos y adherentes (grado alimentario) | Productos industriales a altas temperaturas, muy abrasivos y adherentes (grado alimentario a pedido) | Productos cortantes, afilados y pegajosos | Productos industriales extremadamente abrasivos, buenas características contra el impacto | |

Options / Opciones

All our buckets can be punched to the customers own specification. The following options may be applied to any of our buckets.

Todos nuestros cangilones pueden ser perforados según las necesidades de nuestros clientes. Tenemos diferentes opciones que se pueden añadir a nuestra gama de cangilones.

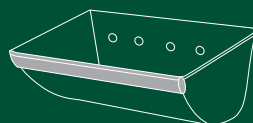

Front Only.
Refuerzo en la parte frontal.

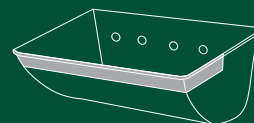

Front and part sides.
Refuerzo en la parte frontal y parcial en los lados.

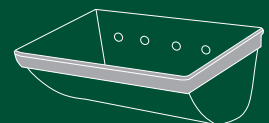

Front and full sides.
Refuerzo en la parte frontal y completo a los lados.

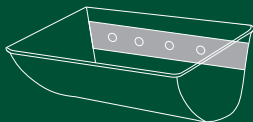

Rear reinforcing plate.
Chapa de refuerzo posterior.

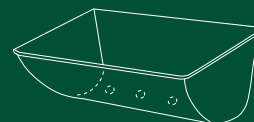

Bottom Drain Holes.
Agujeros inferiores de drenaje.

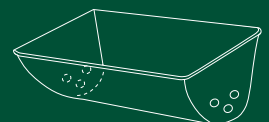

Side Drain Holes
Agujeros laterales de drenaje.

CONTENTS / CONTENIDOS

Product Suitability Key:
Clave Para el Uso de los Productos:



Cereals / Cereales



Sticky Materials / Productos Pegajosos



Light Industrial / Industriales Livianos



Pellets & Light Agricultural /
Gránulos y Agrícolas Ligeros



Cement / Cemento



Heavy Industrial / Industriales Pesados

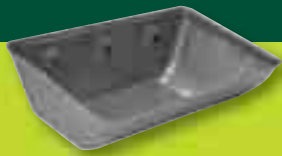
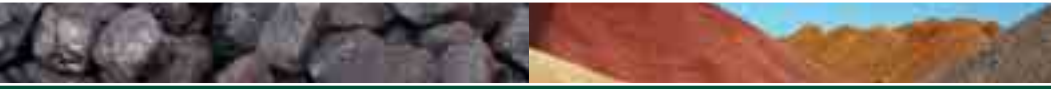

STARCO™
Steel
Agricultural
3

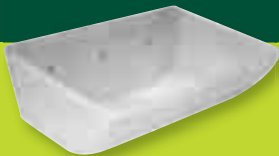

STARCO™
HDP/Nylon/Polyurethane
Agricultural
4

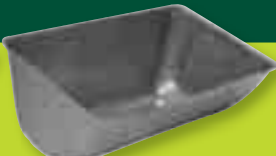

SUPER STARCO™
Steel
Agricultural & Industrial
5



SUPER STARCO™
HDP/Nylon/Polyurethane
Agricultural & Industrial
7

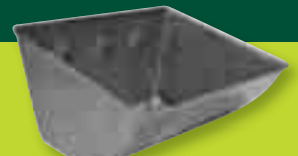

STARCO JUMBO™
Steel
Industrial
8

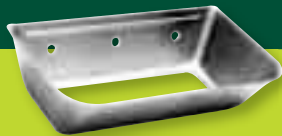

GB SPIDEX™ (Bottomless)
Steel
Agricultural
9



CC-S® (Stackable)
HDP/Nylon/Polyurethane
Agricultural
11



J TYPE
Steel
Agricultural
13



COLUMBUS DIN 15232
Steel
Agricultural
14



CONTINENTAL DIN 15233
Steel
Industrial
15

15/16. How to measure a bucket Como medir un cangilón

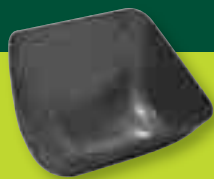

A TYPE
Shallow Pattern
Agricultural
16

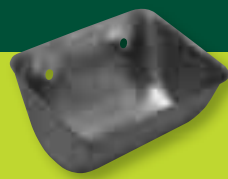

B TYPE
Medium Pattern
Agricultural & Industrial
17

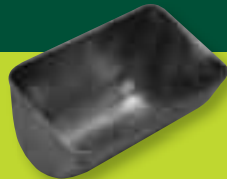

C TYPE
Medium Deep Pattern
Agricultural & Industrial
19



D TYPE
Deep Pattern
Industrial
21



F TYPE
Angle Back Pattern
Industrial
22



ATLAS AA
Nylon Zytel
Industrial/Sticky
23



ATLAS MF
Nylon Zytel
Industrial
24

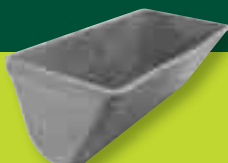

ATLAS AD
Nyrim
Industrial/Sticky
25



ATLAS AM
Nyrim
Agricultural & Industrial
26



POLYPENCO
Nylon
Industrial/Sticky
27



BUDD AA
Nylon
Industrial/Sticky
28

TYPE S

Starco™



www.go4b.com

FREE Engineering Design Service
www.go4b.com

The original STARCO™ Super Low Profile Elevator Bucket System - a bucket design for higher capacity at closer bucket spacing.

- **Higher capacity:** up to 100% capacity increase for existing elevators
- **More flexibility:** operates effectively over a wide speed range (from 1.25 m/s to 4.55 m/s)
- **Unique stream discharge pattern:** reduces product damage and dust

El sistema original STARCO™ de elevador de cangilones de perfil super bajo – un diseño mejor para más capacidad con un espaciado menor.

- **Más capacidad:** La capacidad puede aumentar hasta un 100% respecto a los modelos existentes
- **Más flexibilidad** opera eficientemente con un amplio rango de velocidad (de 1,25 m/s a 4,55 m/s)
- **Sistema de chorro de descarga único:** reduce daños al producto y el polvo

Pressed Seamless Steel /
Stainless Steel / Galvanised

Chapa de acero estampada, sin soldaduras /
Inoxidable / Galvanizado

AGRICULTURAL

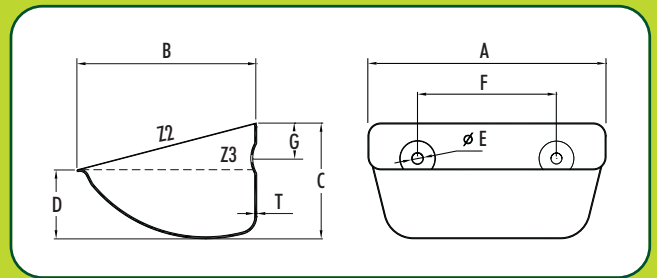

| No. | A (mm) | B (mm) | C (mm) | D (mm) | T (mm) | kg | Capacity (Litres) Capacidad (Litros) | | No. | Holes Agujeros | | | Max. Pcs/Mtr |
|---------------------|--------|--------|--------|--------|--------|------|---|------------|-----|-------------------|--------|--------|-----------------|
| | | | | | | | Z2 (total) | Z3 (water) | | E (Ø mm) | F (mm) | G (mm) | |
| S100-90 | 106 | 89 | 62 | 38 | 1.0 | 0.15 | 0.32 | 0.21 | 2 | 8.5 | 50 | 20 | 15 |
| S130-120 | 138 | 114 | 80 | 54 | 1.5 | 0.35 | 0.68 | 0.50 | 2 | 8.5 | 70 | 22 | 12 |
| S180-140 | 188 | 140 | 92 | 60 | 1.5 | 0.53 | 1.29 | 0.90 | 2 | 8.5 | 100 | 27 | 10.5 |
| S230-165 | 239 | 163 | 108 | 70 | 2.0 | 1.01 | 2.40 | 1.80 | 2 | 11.0 | 120 | 34 | 9 |
| S280-165 | 289 | 163 | 108 | 70 | 2.0 | 1.32 | 2.91 | 2.15 | 3 | 11.0 | 80 | 34 | 9 |
| S300-180 | 308 | 182 | 117 | 70 | 2.0 | 1.43 | 3.66 | 2.46 | 3 | 9.0 | 100* | 35 | 8.13 |
| S300-215 | 310 | 217 | 140 | 89 | 2.0 | 2.05 | 5.60 | 4.10 | 3 | 11.0 | 100 | 38 | 7.14 |
| S330-215/2.0 | 340 | 213 | 134 | 85 | 2.0 | 2.09 | 5.51 | 3.92 | 3 | 11.0 | 120 | 38 | 7.14 |
| S330-215/2.5 | 340 | 213 | 134 | 85 | 2.5 | 2.68 | 5.51 | 3.92 | 3 | 11.0 | 120 | 38 | 7.14 |
| S370-215/2.0 | 381 | 213 | 134 | 85 | 2.0 | 2.38 | 6.18 | 4.40 | 4 | 11.0 | 90 | 38 | 7.14 |
| S370-215/2.5 | 381 | 213 | 134 | 85 | 2.5 | 2.98 | 6.18 | 4.40 | 4 | 11.0 | 90 | 38 | 7.14 |
| S450-215 | 464 | 213 | 134 | 85 | 2.5 | 3.40 | 8.00 | 5.59 | 5 | 11.0 | 90** | 38 | 7.14 |

Special holes/thicknesses/wearbands - available on request
 * S300-180 Slotted holes for 100mm centres to 104mm centres.
 ** S450-215 Slotted holes for 88mm centres to 90mm centres.
 Wear band 3.0mm on 1 or 3 sides on request.

Agujeros especiales/Espesores diferentes/Refuerzos especiales - Sobre Pedido.
 * S300-180 Agujeros ovalados para centros de 100mm a 104mm.
 ** S450-215 Agujeros ovalados para centros de 87mm a 91mm.
 Pletina de refuerzo de 3mm de espesor en una cara o a los tres lados bajo pedido.

! For Stainless Steel, see price list for thickness options

! Para acero inoxidable, vea la lista de precios para opciones de espesor

TYPE S



HDP / Nylon / Polyurethane

HDP / Nylon / Poliuretano

AGRICULTURAL

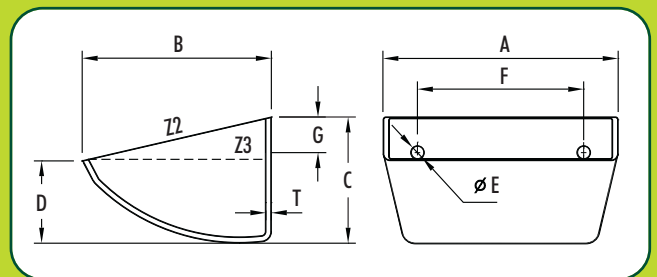

| No. | A (mm) | B (mm) | C (mm) | D (mm) | T (mm) | kg | Capacity (Litres) Capacidad (Litros) | | Recessed Holes Agujeros Embutidos | | | Max. Pcs/Mtr | |
|-----------------------|--------|--------|--------|--------|--------|------|---|------------|--------------------------------------|----------|--------|--------------|--------|
| | | | | | | | Z2 (total) | Z3 (water) | No. | E (Ø mm) | F (mm) | | G (mm) |
| S100-90HDP-MD | 109 | 90 | 62 | 39 | 4.0 | 0.06 | 0.35 | 0.23 | 2 | 8.5 | 50 | 17 | 14.28 |
| S130-120HDP-MD | 140 | 121 | 81 | 54 | 4.7 | 0.13 | 0.70 | 0.50 | 2 | 8.5 | 70 | 22 | 11.11 |
| S180-140HDP-MD | 190 | 148 | 94 | 55 | 5.5 | 0.21 | 1.30 | 0.88 | 2 | 8.5 | 100 | 30 | 10.5 |
| S230-170HDP-MD | 240 | 175 | 111 | 70 | 5.5 | 0.36 | 2.50 | 1.85 | 2 | 11.0 | 120 | 38 | 9 |
| S280-170HDP-MD | 290 | 173 | 111 | 75 | 6.0 | 0.45 | 3.00 | 2.28 | 3 | 11.0 | 80 | 38 | 9 |

All MD buckets come with recessed holes.

| No. | A (mm) | B (mm) | C (mm) | D (mm) | T (mm) | kg | Capacity (Litres) Capacidad (Litros) | | Flat Holes Agujeros Planos | | | Max. Pcs/Mtr | |
|--------------------|--------|--------|--------|--------|--------|------|---|------------|-------------------------------|----------|--------|--------------|--------|
| | | | | | | | Z2 (total) | Z3 (water) | No. | E (Ø mm) | F (mm) | | G (mm) |
| S150-110HDP | 159 | 113 | 78 | 51 | 5.2 | 0.17 | 0.72 | 0.49 | 2 | 9.0 | 89 | 24 | 12 |
| S180-140HDP | 190 | 146 | 94 | 56 | 6.0 | 0.22 | 1.30 | 0.97 | 2 | 9.0 | 100 | 30 | 10.5 |
| S225-140HDP | 235 | 140 | 94 | 60 | 6.0 | 0.34 | 1.67 | 1.16 | 2 | 9.0 | 120 | 30 | 10.5 |
| S230-170HDP | 240 | 173 | 110 | 70 | 6.0 | 0.43 | 2.32 | 1.75 | 2 | 11.0 | 120 | 38 | 9 |
| S280-170HDP | 290 | 173 | 113 | 72 | 6.0 | 0.50 | 3.00 | 2.28 | 3 | 11.0 | 80 | 38 | 9 |
| S300-180HDP | 314 | 181 | 124 | 81 | 6.0 | 0.58 | 3.85 | 2.70 | 3 | 9.0 | 102 | 35 | 8.13 |
| S350-180HDP | 367 | 181 | 124 | 85 | 7.0 | 0.79 | 4.51 | 3.30 | 4 | 9.0 | 90 | 35 | 8.13 |
| S330-215HDP | 342 | 222 | 141 | 92 | 8.5 | 0.93 | 5.90 | 4.51 | 3 | 11.0 | 120 | 38 | 7.14 |
| S370-215HDP | 380 | 218 | 141 | 90 | 9.0 | 1.07 | 6.30 | 4.60 | 4 | 11.0 | 90 | 38 | 7.14 |

Special holes - available on request.

Plastic buckets require a large flat fender washer (in place of standard washer) between the nut and the inside back of the bucket.

Agujeros Especiales - Bajo pedido.

Se recomienda el empleo de arandelas planas de gran diámetro para el montaje de cangilones plásticos. Estas van colocadas entre la tuerca y la parte interior del cangilón.

TYPE SPS

Super Starco™



www.go4b.com

FREE Engineering Design Service
Contact 4B

The new, extended range of the deep Super Starco™ buckets is the result of intensive research to achieve the maximum individual bucket capacity, while still maintaining the perfect fill and discharge characteristics of the original Starco bucket over a wide speed range.

El nuevo rango extendido del cangilón profundo Super Starco™, es el resultado de una búsqueda intensiva para conseguir la máxima capacidad individual por cangilón, mientras que mantiene las perfectas características de carga y descarga del cangilón Starco original sobre un amplio rango de velocidades.

- **Versatile bucket**, available in many sizes
- **Increased Volume**, with the same discharge characteristics as the Starco™ bucket
- **Less buckets required per metre**
- **Less bolts and punching required**
- **Reduced cost for belt & bucket installation**

- **Cangilón versátil**, disponible en muchas medidas.
- **Volumen aumentado**, con las mismas características de descarga que el modelo Starco
- Se requieren menos cangilones por metro
- Se requieren menos tornillos y menos agujeros
- **Se reduce el costo** por banda y por instalación de cangilón

Pressed Seamless Steel /
Stainless Steel

Chapa de acero estampada, sin
soldaduras / Inoxidable

AGRICULTURAL & INDUSTRIAL

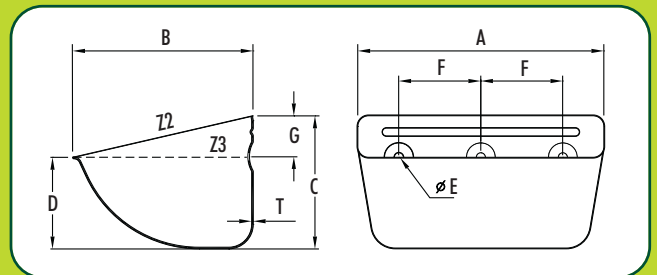

| No. | A (mm) | B (mm) | C (mm) | D (mm) | T / Kg | | | | | | Capacity (Litres) Capacidad (Litros) | | Recessed Holes Agujeros Embutidos | | | Max. Pcs/Mtr | |
|---------------------|-----------|-----------|-----------|-----------|--------|-------|-------|-------|-------|-------|---|---------------|--------------------------------------|-------------|-----------|-----------------|-----------|
| | | | | | 1.0mm | 1.2mm | 1.5mm | 2.0mm | 2.5mm | 3.0mm | Z2 (total) | Z3 (water) | No. | E (Ø mm) | F (mm) | | G (mm) |
| SPS80-80 | 85 | 80 | 58 | 39 | 0.11 | | | | | | 0.21 | 0.18 | 2 | 8.0 | 43 | 16 | 15.00 |
| SPS100-90 | 106 | 89 | 66 | 45 | 0.12 | | 0.18 | | | | 0.33 | 0.25 | 2 | 8.5 | 50 | 20 | 14.00 |
| SPS100-100 | 105 | 97 | 78 | 46 | 0.18 | | | | | | 0.42 | 0.29 | 2 | 8.5 | 50 | 25 | 12.00 |
| SPS120-100 | 125 | 105 | 77 | 53 | 0.22 | | 0.33 | | | | 0.58 | 0.44 | 2 | 8.0 | 67 | 25 | 12.00 |
| SPS140-110 | 146 | 112 | 91 | 40 | | | 0.43 | | | | 0.76 | 0.41 | 2 | 8.5 | 70 | 25 | 10.50 |
| SPS130-120 | 138 | 120 | 90 | 62 | | 0.30 | 0.38 | | | | 0.82 | 0.64 | 2 | 8.5 | 70 | 25 | 10.50 |
| SPS140-120 | 146 | 120 | 90 | 62 | | | 0.40 | | 0.80 | | 0.87 | 0.65 | 2 | 8.5 | 70/86* | 25 | 10.50 |
| SPS160-140 | 166 | 147 | 112 | 78 | | | 0.55 | | 1.10 | | 1.58 | 1.20 | 2 | 8.5 | 100 | 30 | 8.60 |
| SPS180-140 | 187 | 147 | 112 | 78 | | | 0.61 | | 1.22 | | 1.77 | 1.38 | 2 | 8.5 | 100 | 30 | 8.60 |
| SPS200-150 | 205 | 150 | 112 | 77 | | | 0.77 | | 1.54 | | 2.00 | 1.53 | 2 | 9.0 | 100/102* | 32 | 8.60 |
| SPS230-160/A | 233 | 160 | 122 | 85 | | | 0.86 | 1.15 | 1.72 | | 2.71 | 2.15 | 3 | 9.0 | 70 | 32 | 8.00 |
| SPS230-160/B | 233 | 160 | 122 | 85 | | | 0.86 | 1.15 | 1.72 | | 2.71 | 2.15 | 2 | 10.5 | 120 | 32 | 8.00 |
| SPS240-160/A | 247 | 165 | 130 | 92 | | | | 1.35 | 2.00 | | 3.08 | 2.40 | 3 | 10.5 | 70/77* | 35 | 7.40 |
| SPS240-160/B | 247 | 165 | 130 | 92 | | | | 1.35 | 2.00 | | 3.08 | 2.40 | 2 | 10.5 | 140 | 35 | 7.40 |
| SPS240-160/C | 247 | 165 | 130 | 92 | | | | 1.35 | 2.00 | | 3.08 | 2.40 | 2 | 10.5 | 120 | 35 | 7.40 |
| SPS260-165 | 262 | 165 | 130 | 92 | | | | 1.38 | 2.10 | | 3.28 | 2.55 | 3 | 10.5 | 77/80* | 35 | 7.40 |
| SPS280-165 | 288 | 165 | 130 | 93 | | | | 1.55 | 2.32 | | 3.60 | 2.82 | 3 | 10.5 | 80 | 38 | 7.40 |
| SPS300-165/A | 308 | 165 | 135 | 94 | | | | 1.65 | 2.50 | | 3.88 | 2.90 | 3 | 9.0 | 100/104* | 36 | 7.20 |
| SPS300-165/B | 308 | 165 | 135 | 94 | | | | 1.65 | 2.50 | | 3.88 | 2.90 | 3 | 11.0 | 100 | 36 | 7.20 |
| SPS330-165 | 340 | 165 | 135 | 97 | | | | 1.90 | 2.85 | | 4.40 | 3.50 | 3 | 11.0 | 110/120* | 38 | 7.20 |

TYPE SPS



| No. | A (mm) | B (mm) | C (mm) | D (mm) | T / Kg | | | | | | Capacity (Litres) Capacidad (Litros) | | Recessed Holes Agujeros Embutidos | | | Max. Pcs/Mtr | |
|---------------------|-----------|-----------|-----------|-----------|--------|-------|-------|-------|-------|-------|---|---------------|--------------------------------------|-------------|-----------|-----------------|-----------|
| | | | | | 1.0mm | 1.2mm | 1.5mm | 2.0mm | 2.5mm | 3.0mm | Z2 (total) | Z3 (water) | No. | E (Ø mm) | F (mm) | | G (mm) |
| | | | | | | | | | | | | | | | | | |
| SPS350-165/A | 360 | 165 | 135 | 94 | | | 2.12 | | | 3.20 | 4.50 | 3.65 | 4 | 9.0 | 90 | 38 | 7.20 |
| SPS350-165/B | 360 | 165 | 135 | 94 | | | 2.12 | | | 3.20 | 4.50 | 3.65 | 3 | 11 | 120 | 38 | 7.20 |
| SPS200-180 | 204 | 182 | 140 | 98 | | | 1.28 | | | | 2.84 | 2.17 | 2 | 11.0 | 110 | 44 | 7.00 |
| SPS260-180 | 270 | 188 | 140 | 96 | | | 2.00 | | | | 4.10 | 3.20 | 3 | 11.0 | 80 | 45 | 7.00 |
| SPS280-180 | 290 | 185 | 140 | 97 | | | 1.70 | | 2.55 | | 4.40 | 3.30 | 3 | 11.0 | 80 | 38 | 7.00 |
| SPS300-180/A | 308 | 182 | 140 | 95 | | | 1.80 | | 2.70 | | 4.50 | 3.50 | 3 | 9.0 | 100/104* | 36 | 7.00 |
| SPS300-180/B | 308 | 182 | 140 | 95 | | | 1.80 | | 2.70 | | 4.50 | 3.50 | 3 | 11.0 | 100 | 36 | 7.00 |
| SPS330-180 | 340 | 182 | 140 | 98 | | | 2.00 | | | | 5.20 | 4.00 | 3 | 11.0 | 110/120* | 38 | 7.00 |
| SPS350-180 | 362 | 182 | 140 | 98 | | | 2.10 | | 3.15 | | 5.40 | 4.20 | 3 | 11.0 | 120 | 38 | 7.00 |
| SPS370-180 | 385 | 195 | 140 | 95 | | | | 2.80 | | | 6.40 | 4.90 | 4 | 11.0 | 90 | 38 | 7.00 |
| SPS250-215 | 257 | 215 | 162 | 113 | | | 1.86 | | | | 5.30 | 4.10 | 3 | 11.0 | 85 | 49 | 5.88 |
| SPS280-215 | 294 | 215 | 163 | 114 | | | 1.55 | 2.86 | 2.32 | | 6.04 | 4.70 | 3 | 11.0 | 80 | 50 | 5.88 |
| SPS300-215 | 310 | 220 | 163 | 112 | | | 2.32 | | 3.48 | | 6.70 | 5.20 | 3 | 11.0 | 100 | 50 | 5.88 |
| SPS330-215 | 340 | 215 | 163 | 112 | | | | 2.97 | | | 7.20 | 5.65 | 3 | 11.0 | 120 | 50 | 5.88 |
| SPS350-215 | 362 | 215 | 163 | 112 | | | | 3.23 | | | 7.60 | 5.86 | 3 | 11.0 | 120 | 50 | 5.88 |
| SPS370-215 | 381 | 215 | 163 | 112 | | | | 3.32 | 4.00 | | 8.10 | 6.30 | 4 | 11.0 | 90 | 50 | 5.88 |
| SPS440-215 | 450 | 225 | 165 | 113 | | | 3.92 | | | | 9.83 | 7.44 | 4 | 11.0 | 110 | 50 | 5.88 |
| SPS450-215 | 464 | 215 | 163 | 113 | | | | 3.74 | 4.50 | | 10.10 | 7.70 | 5 | 11.0 | 88/90* | 50 | 5.88 |
| SPS470-215 | 480 | 225 | 165 | 113 | | | | | | | 10.56 | 8.06 | 4 | 11.0 | 120 | 50 | 5.88 |
| SPS500-215 | 515 | 215 | 163 | 113 | | | | 4.00 | 4.80 | | 11.25 | 8.80 | 5 | 11.0 | 100 | 50 | 5.88 |

Special holes/thicknesses/wearbands - available on request
Wear band size: 3.0mm on 1 or 3 sides on request.
* Slotted holes to fit alternate hole centres

Agujeros especiales/Espesores diferentes/Refuerzos especiales - Bajo Pedido.
Medidas de los refuerzos: 3mm sobre 1 o 3 lados - A pedido.
* Agujeros ovalados para ajustarse a distintas distancias entre centros.

! For Stainless Steel, see price list for thickness options

! Para acero inoxidable, vea la lista de precios para opciones de espesor

TYPE SPS

Super Starco™



www.go4b.com

FREE Engineering Design Service
www.go4b.com

The new, extended range of the deep Super Starco™ buckets is the result of intensive research to achieve the maximum individual bucket capacity, while still maintaining the perfect fill and discharge characteristics of the original Starco™ bucket over a wide speed range.

El nuevo rango extendido del cangilón profundo Super Starco™, es el resultado de una búsqueda intensiva para conseguir la máxima capacidad individual por cangilón, mientras que mantiene las perfectas características de carga y descarga del cangilón Starco™ original sobre un amplio rango de velocidades.

- **Versatile bucket**, available in many sizes
- **Increased Volume**, with the same discharge characteristics as the Starco™ bucket
- **Less buckets required per metre**
- **Less bolts and punching required**
- **Reduced cost for belt & bucket installation**

- **Cangilón versátil**, disponible en muchas medidas.
- **Volumen aumentado**, con las mismas características de descarga que el modelo Starco™
- Se requieren menos cangilones por metro
- Se requieren menos tornillos y menos agujeros
- **Se reduce el costo** por banda y por instalación de cangilón

HDP / Nylon / Polyurethane

HDP / Nylon / Poliuretano

AGRICULTURAL & INDUSTRIAL

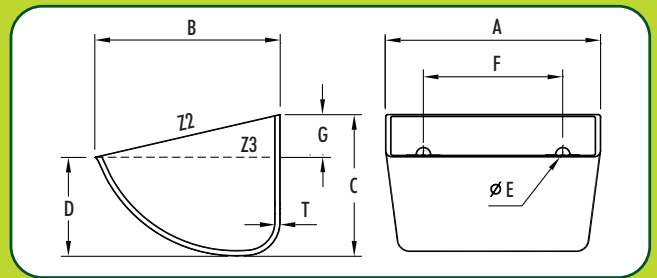

| No. | A (mm) | B (mm) | C (mm) | D (mm) | T (mm) | kg | Capacity (Litres) Capacidad (Litros) | | No. | Holes Agujeros | | | Max. Pcs/Mtr |
|-----------------------|--------|--------|--------|--------|--------|------|---|------------|-----|-------------------|---------|--------|-----------------|
| | | | | | | | Z2 (total) | Z3 (water) | | E (Ø mm) | F (mm) | G (mm) | |
| SPS80-80 HDP | 90 | 85 | 63 | 43 | 4 | 0.06 | 0.24 | 0.18 | 2 | 9.0* | 43 | 18 | 15.00 |
| SPS100-90 HDP | 110 | 100 | 67 | 44 | 5 | 0.09 | 0.38 | 0.29 | 2 | 9.0* | 50 | 20 | 14.00 |
| SPS120-100 HDP | 129 | 110 | 80 | 55 | 5 | 0.13 | 0.59 | 0.46 | 2 | 9.0* | 67 | 25 | 12.00 |
| SPS130-120 HDP | 135 | 120 | 85 | 57 | 5 | 0.18 | 0.70 | 0.52 | 2 | 9.0* | 70 | 25 | 11.00 |
| SPS140-120 HDP | 145 | 120 | 90 | 62 | 5 | 0.17 | 0.80 | 0.61 | 2 | 8.5* | 70 | 25 | 10.80 |
| SPS160-140 HDP | 172 | 152 | 113 | 78 | 6 | 0.30 | 1.58 | 1.22 | 2 | 9.0* | 100 | 30 | 8.60 |
| SPS180-140 HDP | 187 | 150 | 112 | 77 | 6 | 0.32 | 1.77 | 1.35 | 2 | 9.0* | 100 | 30 | 8.60 |
| SPS200-150 HDP | 205 | 150 | 112 | 75 | 6 | 0.35 | 1.82 | 1.39 | 2 | 9.0* | 100 | 32 | 8.60 |
| SPS300-150 HDP | 305 | 152 | 115 | 80 | 7 | 0.65 | 2.89 | 2.24 | 4 | 9.0* | 102 | 32 | 8.50 |
| SPS200-160 HDP | 210 | 158 | 115 | 79 | 7 | 0.39 | 2.09 | 1.61 | 2 | 9.0* | 100 | 32 | 8.50 |
| SPS240-165 HDP | 250 | 170 | 132 | 93 | 7 | 0.60 | 3.10 | 2.34 | 2 | 11.0* | 120 | 35 | 7.40 |
| SPS280-165 HDP | 290 | 170 | 132 | 93 | 7 | 0.69 | 3.60 | 2.80 | 3 | 11.0 | 80 | 36 | 7.40 |
| SPS280-180 HDP | 290 | 185 | 140 | 97 | 7 | 0.85 | 4.20 | 3.30 | 3 | 11.0 | 80 | 36 | 7.00 |
| SPS300-180 HDP | 316 | 185 | 140 | 97 | 8 | 0.92 | 4.60 | 3.60 | 3 | 11.0 | 100 | 36 | 7.00 |
| SPS330-180 HDP | 347 | 185 | 140 | 97 | 8 | 1.00 | 5.00 | 4.00 | 3 | 11.0 | 110/120 | 38 | 7.00 |
| SPS350-180 HDP | 367 | 186 | 140 | 97 | 9 | 1.12 | 5.25 | 4.10 | 3 | 11.0 | 120 | 38 | 7.00 |
| SPS300-215 HDP | 318 | 220 | 168 | 117 | 9 | 1.28 | 6.60 | 5.20 | 3 | 11.0 | 100 | 50 | 5.88 |
| SPS330-215 HDP | 343 | 220 | 168 | 117 | 9 | 1.37 | 7.17 | 5.66 | 3 | 11.0 | 120 | 50 | 5.88 |
| SPS350-215 HDP | 368 | 220 | 168 | 117 | 9 | 1.45 | 7.75 | 6.12 | 3/4 | 11.0 | 120/90 | 50 | 5.88 |
| SPS370-215 HDP | 390 | 220 | 168 | 117 | 9 | 1.52 | 8.25 | 6.52 | 4 | 11.0 | 90 | 50 | 5.88 |
| SPS400-215 HDP | 420 | 220 | 168 | 117 | 9 | 1.54 | 8.80 | 7.00 | 4 | 11.0 | 100 | 50 | 5.88 |
| SPS450-215 HDP | 470 | 220 | 165 | 115 | 9 | 1.60 | 9.50 | 7.70 | 5 | 11.0 | 90 | 50 | 5.88 |
| SPS500-215 HDP | 525 | 220 | 168 | 117 | 9 | 1.96 | 11.15 | 9.00 | 5 | 11.0 | 100 | 50 | 5.88 |

Plastic buckets require a large flat washer of minimum 30mm O/D between the hex nut and the inside of the bucket.

* Recessed Holes

Los cangilones Starco requieren grandes diámetros de arandelas, mínimo Ø 30mm, para su montaje.

* Agujeros Embutidos

TYPE SJ

Starco Jumbo™



www.go4b.com

FREE Engineering Design Service
Contact 4B

Developed to meet the needs of industrial elevators, particularly cement. Deep drawn solid steel bucket, designed and engineered to replace large fabricated buckets. Suitable for use with both standard rubber and steel cord belting.

- **Improved capacity:** Wingless design, improves fill and allows closer spacing
- **Greater strength/longer life:** Solid seamless construction with rounded corners for rigidity. No welds or joints to open up
- **Economic solution**
- **More buckets per metre:** More capacity, smaller casing

Desarrollado para cubrir las necesidades de elevadores industriales, el cemento en particular. Cangilón de acero sólido y profundo, diseñado para reemplazar grandes cangilones. Adecuados tanto para banda de goma como para banda steelcord.

- **Capacidad mejorada:** Diseño sin alas, mejora el llenado y permite un espaciado menor
- **Más duro/vida más larga:** Construcción sólida sin soldaduras con esquinas redondeadas para mayor rigidez. No hay puntos de soldadura que puedan soltarse o romperse
- **Solución económica**
- **Más cangilones por metro**

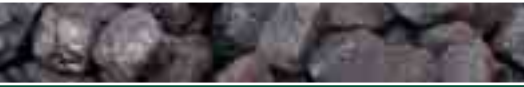

Pressed Seamless Steel

Chapa de acero estampada, sin soldaduras



INDUSTRIAL

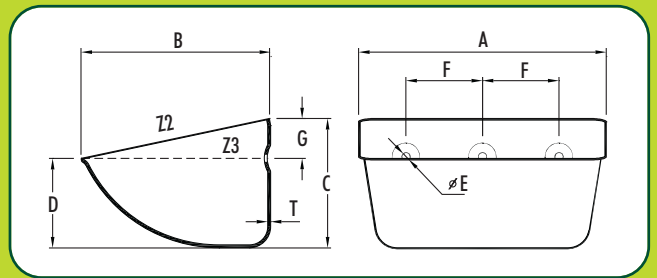

| No. | A (mm) | B (mm) | C (mm) | D (mm) | T (mm) | kg | Capacity (Litres) Capacidad (Litros) | | Recessed Holes Agujeros Embutidos | | | Max. Pcs/Mtr | |
|--------------------|--------|--------|--------|--------|--------|-----|---|------------|--------------------------------------|----------|--------|--------------|--------|
| | | | | | | | Z2 (total) | Z3 (water) | No. | E (Ø mm) | F (mm) | | G (mm) |
| SJ250-250/3 | 260 | 260 | 190 | 130 | 3.0 | 3.5 | 7.0 | 5.3 | 3 | 13 | 80 | 55 | 5 |
| SJ330-250/3 | 340 | 260 | 190 | 130 | 3.0 | 4.5 | 9.6 | 7.2 | 3 | 13 | 80 | 55 | 5 |
| SJ370-250/3 | 380 | 260 | 190 | 130 | 3.0 | 5.1 | 10.8 | 8.3 | 4 | 13 | 80 | 55 | 5 |
| SJ470-250/3 | 480 | 260 | 190 | 130 | 3.0 | 6.5 | 14.0 | 10.5 | 5 | 13 | 80 | 55 | 5 |
| SJ330-250/4 | 340 | 260 | 190 | 130 | 4.0 | 6.0 | 9.6 | 7.2 | 3 | 13 | 80 | 55 | 5 |
| SJ370-250/4 | 380 | 260 | 190 | 130 | 4.0 | 6.1 | 10.8 | 8.3 | 4 | 13 | 80 | 55 | 5 |
| SJ470-250/3 | 480 | 260 | 190 | 130 | 3.0 | 8.6 | 14.0 | 10.5 | 5 | 13 | 80 | 55 | 5 |
| SJ470-250/4 | 480 | 260 | 190 | 130 | 4.0 | 8.6 | 14.0 | 10.5 | 5 | 13 | 80 | 55 | 5 |

Special holes/thicknesses/wearbands - available on request

Agujeros especiales/Espesores diferentes/Refuerzos especiales - A pedido.



SJ Bucket and Steel Web Belting High Capacity System

A proven solution for the heavy industry

4B can offer an integrated system of Steel Web Belting, SJ Pressed Steel Buckets and FREE engineering for elevator designs with compact industrial elevators.

Advantages of using the SJ System and Steel Web Belt:

- Savings of up to 33% on component costs
- Heavy duty but lighter weight system
- Taller elevators are possible (up to 450ft/150m)
- Low maintenance costs
- Higher belt speeds are possible
- Closer bucket spacing
- Higher capacity and efficiency

Contact 4B for more information.

See Belt Catalogue
for Steel Web Belt Clamps

TYPE GB

GB / Spidex™ Bottomless



www.go4b.com

FREE Engineering Design Service
www.go4b.com

Bottomless elevator bucket system. GB Spidex™ buckets are closely spaced with a series of buckets without bottoms followed by one bucket with a bottom. The material is lifted in a continuous column and the carrying space normally wasted between conventional buckets is fully utilized to achieve much greater capacity. The buckets pick up and discharge conventionally, but care must be taken in the design of the boot and the head.

- Optimum possible capacity for a given elevator case
- Cost effective increase in leg capacity
- Self-cleaning, vented system - ideal for sticky and powdery products



Pressed Seamless Steel /
Stainless Steel

Fabricado en acero al carbono /
acero inoxidable embutido



AGRICULTURAL

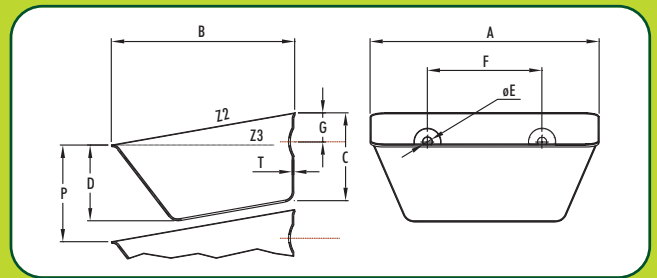

| Code No. | A (mm) | B (mm) | C (mm) | T (mm) | kg | Capacity (Litres) Capacidad (Litros) | | Recessed Holes Agujeros Embudidos | | | P** (mm) | Pcs/Mtr |
|--|-----------|-----------|-----------|-----------|------|---|-----|--------------------------------------|-----------|-----------|-------------|---------|
| | | | | | | Z2 (total) | No. | E (Ø mm) | F (mm) | G (mm) | | |
| STANDARD RANGE / GAMA GB STANDARD | | | | | | | | | | | | |
| GB130-110-B | 136 | 114 | 51 | 1.5 | 0.30 | 0.50 | 2 | 8.5 | 70 | 22 | 57 | 17.5 |
| GB130-110+B | 136 | 114 | 51 | 1.5 | 0.36 | 0.50 | 2 | 8.5 | 70 | 22 | 57 | 17.5 |
| GB180-140-B | 185 | 139 | 65 | 1.5 | 0.45 | 1.18 | 2 | 9.0 | 100 | 32 | 71 | 14.0 |
| GB180-140+B | 185 | 139 | 65 | 1.5 | 0.55 | 1.18 | 2 | 9.0 | 100 | 32 | 71 | 14.0 |
| GB230-165-B | 237 | 163 | 71 | 2.0 | 0.83 | 2.10 | 2 | 10.0 | 120 | 32 | 80 | 12.5 |
| GB230-165+B | 237 | 163 | 71 | 2.0 | 1.12 | 2.10 | 2 | 10.0 | 120 | 32 | 80 | 12.5 |
| GB300-165-B | 305 | 166 | 80 | 2.0 | 1.10 | 2.75 | 3 | 10.5 | 90* | 36 | 88 | 11.4 |
| GB300-165+B | 305 | 166 | 80 | 2.0 | 1.40 | 2.75 | 3 | 10.5 | 90* | 36 | 88 | 11.4 |
| GB350-200-B | 355 | 200 | 100 | 2.5 | 1.95 | 4.75 | 4 | 11.0 | 90 | 42 | 111 | 9.0 |
| GB350-200+B | 355 | 200 | 100 | 2.5 | 2.50 | 4.75 | 4 | 11.0 | 90 | 42 | 111 | 9.0 |
| GB400-220-B | 410 | 218 | 115 | 3.0 | 2.30 | 6.91 | 4 | 11.0 | 100 | 45 | 125 | 8.0 |
| GB400-220+B | 410 | 218 | 115 | 3.0 | 2.95 | 6.91 | 4 | 11.0 | 100 | 45 | 125 | 8.0 |

** Bucket spacing for free flowing granular products only.

* Fixing Holes GB300-165. Alternative hole punching available: Slotted for 101mm to 104mm centres

** Paso de los cangilones solamente para productos que fluyan bien.

* Agujeros para cangilón GB300-165. Disponibles como alternativa agujeros ovalados de 101 a 104mm entre centros.

| | | | | | | | | | | | | |
|--------------------------------------|-----|-----|----|-----|------|------|---|-----|-----|----|-----|------|
| SPECIAL RANGE / GAMA ESPECIAL | | | | | | | | | | | | |
| GB215-95-B | 220 | 93 | 63 | 1.5 | 0.40 | 0.95 | 2 | 8.5 | 127 | 25 | 67 | 14.9 |
| GB215-95+B | 220 | 93 | 63 | 1.5 | 0.50 | 0.95 | 2 | 8.5 | 127 | 25 | 67 | 14.9 |
| GB380-165-B | 380 | 165 | 80 | 2.5 | 1.70 | 3.50 | 4 | 9.0 | * | 36 | 88 | 11.4 |
| GB380-165+B | 380 | 165 | 80 | 2.5 | 2.15 | 3.50 | 4 | 9.0 | * | 36 | 88 | 11.4 |
| GB325-190-B | 335 | 191 | 88 | 2.5 | 1.65 | 3.60 | 3 | 9.0 | 100 | 25 | 100 | 10.5 |
| GB325-190+B | 335 | 191 | 88 | 2.5 | 2.11 | 3.60 | 3 | 9.0 | 100 | 25 | 100 | 10.5 |
| GB400-200-B | 410 | 200 | 97 | 2.0 | 1.66 | 5.40 | 4 | 9.0 | 94 | 32 | 105 | 9.5 |
| GB400-200+B | 410 | 200 | 97 | 2.0 | 2.20 | 5.40 | 4 | 9.0 | 94 | 32 | 105 | 9.5 |
| GB430-200-B | 437 | 200 | 95 | 2.0 | 1.77 | 5.56 | 4 | 9.0 | 94 | 32 | 105 | 9.5 |
| GB430-200+B | 437 | 200 | 95 | 2.0 | 2.30 | 5.56 | 4 | 9.0 | 94 | 32 | 105 | 9.5 |

** Bucket spacing for free flowing granular products only.

* Fixing Holes GB380-165, hole centres 76-127-76mm

** Paso de los cangilones solamente para productos que fluyan bien.

* Agujeros para cangilón GB380-165, entre centros 76-127-76mm.

TYPE GB

Sistema de elevador de cangilones sin fondo. Los cangilones GB Spidex™ se espacian ligeramente con una serie de cangilones sin fondo seguidos por uno con fondo. El material es elevado por columna continua y el espacio que se pierde entre los cangilones convencionales se utiliza para alcanzar una capacidad mayor.

Los cangilones cargan y descargan de la forma convencional pero hay que tener en cuenta el diseño de los pies y la cabeza del elevador

- Capacidad máxima para un elevador ya existente
- Eficiente de costos y mejora la capacidad de la caña
- Autolimpieza por venteo - ideal para productos pegajosos y polvorientos



| Code No. | A (mm) | B (mm) | C (mm) | T (mm) | kg | Capacity (Litres) Capacidad (Litros) | | Recessed Holes Agujeros Embutidos | | | P** (mm) | Pcs/Mtr |
|-----------------------------------|-----------|-----------|-----------|-----------|------|---|-----|--------------------------------------|-----------|-----------|-------------|---------|
| | | | | | | Z2 (total) | No. | E (Ø mm) | F (mm) | G (mm) | | |
| SPIDEX RANGE / GAMA SPIDEX | | | | | | | | | | | | |
| Spidex 100-90-B | 106 | 88 | 45 | 0.9 | 0.10 | 0.23 | 2 | 8.5 | 50 | 17 | 50 | 20.0 |
| Spidex 100-90+B | 106 | 88 | 45 | 0.9 | 0.12 | 0.23 | 2 | 8.5 | 50 | 17 | 50 | 20.0 |
| Spidex 130-110-B | 136 | 114 | 51 | 1.5 | 0.26 | 0.50 | 2 | 8.5 | 70 | 22 | 57 | 17.5 |
| Spidex 130-110+B | 136 | 114 | 51 | 1.5 | 0.31 | 0.50 | 2 | 8.5 | 70 | 22 | 57 | 17.5 |
| Spidex 180-140-B | 185 | 139 | 65 | 1.5 | 0.41 | 1.08 | 2 | 9.0 | 100 | 32 | 71 | 14.0 |
| Spidex 180-140+B | 185 | 139 | 65 | 1.5 | 0.50 | 1.08 | 2 | 9.0 | 100 | 32 | 71 | 14.0 |
| Spidex 230-165-B | 237 | 160 | 71 | 2.0 | 0.79 | 2.00 | 2 | 11.0 | 120 | 32 | 80 | 12.5 |
| Spidex 230-165+B | 237 | 160 | 71 | 2.0 | 1.09 | 2.00 | 2 | 11.0 | 120 | 32 | 80 | 12.5 |
| Spidex 280-165-B | 291 | 165 | 80 | 2.0 | 0.99 | 2.67 | 3 | 11.0 | 90 | 36 | 87 | 11.5 |
| Spidex 280-165+B | 291 | 165 | 80 | 2.0 | 1.32 | 2.67 | 3 | 11.0 | 90 | 36 | 87 | 11.5 |
| Spidex 330-190-B | 341 | 192 | 99 | 3.0 | 2.07 | 4.50 | 3 | 12.0 | 100 | 49 | 105 | 9.5 |
| Spidex 330-190+B | 341 | 192 | 99 | 3.0 | 2.82 | 4.50 | 3 | 12.0 | 100 | 49 | 105 | 9.5 |

Note: Spidex 100-90, Spidex 130-110 and Spidex 180-140 buckets have plain punched holes with notched back.

Nota: Los cangilones Spidex 100-90, Spidex 130-110 y Spidex 180-140 tienen agujeros planos, con una muesca en la parte trasera.



TYPE CC-S CC-S[®] American Grain



www.go4b.com

FREE Engineering Design Service
Contact 4B

A big volume, heavy duty bucket offering greater capacities. Moulded from premium virgin white polymer for ultimate strength and durability.

- **Stackable design** saves freight and storage costs
- **Maximum impact resistance**
- **Thickest front lip in the grain industry** for no bowing and backlegging
- **"Iceberg edge"[™]** ensures clean and consistent discharge
- **"Engineered" for longer life and better performance**

Un cangilón de gran volumen, resistente y de mayor capacidad. Moldeado con polímero blanco virgen de primera calidad para una dureza máxima y durabilidad.

- **Diseño apilable**, ahorra costes de envío y de almacenaje
- **Resistencia al impacto máximo**
- **Tiene el labio frontal más ancho del mercado de granos** para evitar el abombado de la parte frontal y la mala descarga
- El **"Borde Iceberg"[™]** asegura la limpieza y la descarga continua
- Diseñado para una vida **más larga y un mayor rendimiento**

Stackable CC-S Style
HDP / Nylon / Polyurethane

Estilo Apilable CC-S
HDP / Nylon / Poliuretano

AGRICULTURAL

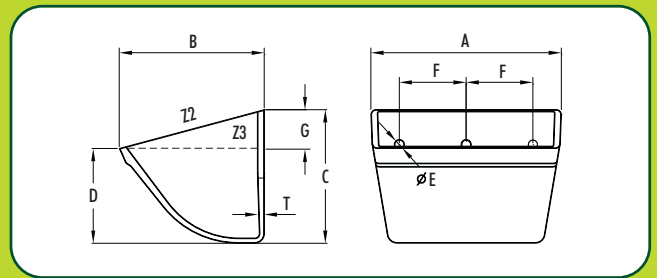

| No. | A (mm) | B (mm) | C (mm) | D (mm) | T (mm) | kg | Capacity (Litres) Capacidad (Litros) | | | Holes Agujeros | | | Max. Pcs/Mtr |
|-----------|--------|--------|--------|--------|--------|------|---|--------|------------|---|----------|--------|-----------------|
| | | | | | | | Z2 (total) | Z3+10% | Z3 (water) | No. | E (Ø mm) | F (mm) | |
| CC-S 3x2 | 85 | 64 | 53 | 35 | 4.5 | 0.05 | 0.13 | 0.14 | 0.10 | To customer specification Según especificaciones del cliente | | | 15.75 |
| CC-S 4x3 | 112 | 89 | 78 | 54 | 5.0 | 0.11 | 0.37 | 0.32 | 0.29 | | | | 11.25 |
| CC-S 5x4 | 135 | 115 | 103 | 72 | 5.0 | 0.20 | 0.80 | 0.66 | 0.60 | | | | 8.75 |
| CC-S 6x4 | 161 | 115 | 103 | 72 | 5.0 | 0.23 | 0.96 | 0.81 | 0.74 | | | | 8.75 |
| CC-S 7x4 | 186 | 115 | 103 | 72 | 5.0 | 0.26 | 1.13 | 0.96 | 0.87 | | | | 8.75 |
| CC-S 6x5 | 163 | 141 | 131 | 93 | 6.0 | 0.37 | 1.48 | 1.27 | 1.15 | | | | 7.15 |
| CC-S 7x5 | 189 | 141 | 131 | 93 | 6.0 | 0.41 | 1.74 | 1.49 | 1.35 | | | | 7.15 |
| CC-S 8x5 | 214 | 141 | 131 | 93 | 6.0 | 0.45 | 2.00 | 1.72 | 1.56 | | | | 7.15 |
| CC-S 9x5 | 240 | 141 | 131 | 93 | 6.0 | 0.50 | 2.22 | 1.88 | 1.71 | | | | 7.15 |
| CC-S 10x5 | 265 | 141 | 131 | 93 | 6.0 | 0.54 | 2.53 | 2.17 | 1.97 | | | | 7.15 |
| CC-S 11x5 | 290 | 141 | 131 | 93 | 6.0 | 0.59 | 2.78 | 2.39 | 2.17 | | | | 7.15 |
| CC-S 12x5 | 316 | 141 | 131 | 93 | 6.0 | 0.62 | 3.05 | 2.62 | 2.38 | | | | 7.15 |
| CC-S 8x6 | 213 | 169 | 154 | 109 | 6.0 | 0.56 | 2.76 | 2.31 | 2.10 | | | | 6.00 |
| CC-S 9x6 | 239 | 169 | 154 | 109 | 6.0 | 0.64 | 2.95 | 2.59 | 2.35 | | | | 6.00 |
| CC-S 10x6 | 264 | 169 | 154 | 109 | 6.0 | 0.68 | 3.38 | 3.03 | 2.75 | | | | 6.00 |
| CC-S 11x6 | 289 | 169 | 154 | 109 | 6.0 | 0.72 | 3.85 | 3.41 | 3.10 | | | 6.00 | |
| CC-S 12x6 | 315 | 169 | 154 | 109 | 6.0 | 0.78 | 4.30 | 3.63 | 3.30 | | | 6.00 | |
| CC-S 13x6 | 340 | 169 | 154 | 109 | 6.0 | 0.84 | 4.60 | 3.96 | 3.60 | | | 6.00 | |
| CC-S 14x6 | 358 | 169 | 154 | 109 | 6.0 | 0.90 | 5.05 | 4.35 | 3.95 | | | 6.00 | |
| CC-S 10x7 | 273 | 200 | 180 | 127 | 8.0 | 1.05 | 5.12 | 4.36 | 3.96 | | | 5.25 | |
| CC-S 11x7 | 299 | 200 | 180 | 127 | 8.0 | 1.10 | 5.60 | 4.80 | 4.40 | | | 5.25 | |
| CC-S 12x7 | 324 | 200 | 180 | 127 | 8.0 | 1.20 | 6.18 | 5.27 | 4.79 | | | 5.25 | |

TYPE CC-S



| No. | A (mm) | B (mm) | C (mm) | D (mm) | T (mm) | kg | Capacity (Litres) Capacidad (Litros) | | | Holes Agujeros | | | Max. Pcs/Mtr |
|-----------|-----------|-----------|-----------|-----------|-----------|------|---|--------|---------------|---|-------------|-----------|-----------------|
| | | | | | | | Z2 (total) | Z3+10% | Z3 (water) | No. | E (Ø mm) | F (mm) | |
| CC-S 13x7 | 350 | 200 | 180 | 127 | 8.0 | 1.28 | 6.71 | 5.72 | 5.20 | To customer specification Según especificaciones del cliente | | | 5.25 |
| CC-S 14x7 | 375 | 200 | 180 | 127 | 8.0 | 1.37 | 7.25 | 6.18 | 5.62 | | | | 5.25 |
| CC-S 15x7 | 400 | 200 | 180 | 127 | 8.0 | 1.45 | 7.76 | 6.63 | 6.03 | | | | 5.25 |
| CC-S 16x7 | 426 | 200 | 180 | 127 | 8.0 | 1.53 | 8.30 | 7.08 | 6.44 | | | | 5.25 |
| CC-S 10x8 | 275 | 228 | 210 | 149 | 10.0 | 1.44 | 6.66 | 5.71 | 5.19 | | | | 4.60 |
| CC-S 11x8 | 300 | 228 | 210 | 149 | 10.0 | 1.55 | 7.35 | 6.30 | 5.73 | | | | 4.60 |
| CC-S 12x8 | 326 | 228 | 210 | 149 | 10.0 | 1.66 | 8.07 | 6.92 | 6.29 | | | | 4.60 |
| CC-S 13x8 | 351 | 228 | 210 | 149 | 10.0 | 1.76 | 8.75 | 7.51 | 6.83 | | | | 4.60 |
| CC-S 14x8 | 377 | 228 | 210 | 149 | 10.0 | 1.88 | 9.47 | 8.14 | 7.40 | | | | 4.60 |
| CC-S 15x8 | 402 | 228 | 210 | 149 | 10.0 | 1.97 | 10.16 | 8.73 | 7.94 | | | | 4.60 |
| CC-S 16x8 | 427 | 228 | 210 | 149 | 10.0 | 2.05 | 10.85 | 9.33 | 8.48 | | | | 4.60 |
| CC-S 18x8 | 479 | 228 | 210 | 149 | 10.0 | 2.30 | 12.28 | 10.57 | 9.61 | | | | 4.60 |
| CC-S 20x8 | 529 | 228 | 210 | 149 | 10.0 | 2.50 | 13.65 | 11.77 | 10.70 | | | | 4.60 |

**STACKABLE DESIGN
FOR REDUCED SHIPPING & STORAGE COSTS**

**DISEÑO APILABLE
AHORRA COSTES DE ENVÍO Y DE ALMACENAJE**



TYPE J



www.go4b.com

FREE Engineering Design Service
www.go4b.com

American Grain

A big volume, CC-style steel bucket designed for use with free flowing materials. For use in medium and high speed elevators

- **High capacity:** Wingless design, improves fill and allows closer spacing on belt
- **Greater strength/longer life:** Solid seamless construction with rounded corners for rigidity. No welds or joints to open up
- **Fully interchangeable** with CC style buckets

De gran volumen, cangilón estilo CC diseñado para materiales de fácil fluidez. Para elevadores de media y alta velocidad

- **Alta capacidad:** Diseño sin alas, mejora el llenado y permite un menor espaciado en la banda
- **Más duro/vida más larga:** Construcción sólida sin soldaduras y cantos redondeados para mayor rigidez. No hay puntos de soldadura que puedan romper
- **Totalmente intercambiables** con los cangilones tipo CC



Pressed Seamless Steel /
Stainless Steel

Chapa de acero estampada,
sin soldaduras / Inoxidable

AGRICULTURAL

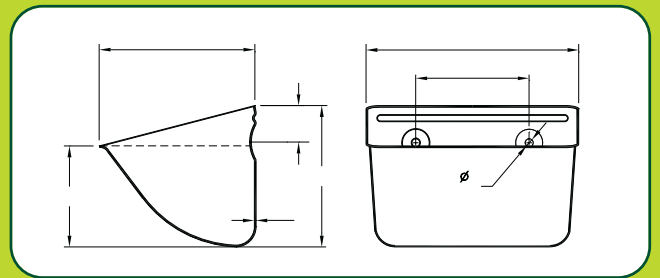

| No. | A (mm) | B (mm) | C (mm) | D (mm) | T (mm) | kg | Capacity (Litres) Capacidad (Litros) | | | Recessed Holes Agujeros Embutidos | | | Max. Pcs/Mtr | |
|------|-----------|-----------|-----------|-----------|-----------|------|---|--------------|---------------|---|-------------|-----------|-----------------|-----------|
| | | | | | | | Z2 (total) | Z3 Z3+10% | Z3 (water) | No. | E (Ø mm) | F (mm) | | G (mm) |
| J64 | 161 | 110 | 100 | 71 | 1.2 | 0.45 | 1.00 | 0.85 | 0.77 | To customer specification Según especificaciones del cliente | | | | 8.75 |
| J75 | 190 | 138 | 121 | 76 | 1.5 | 0.69 | 1.74 | 1.36 | 1.24 | | | | | 7.15 |
| J85 | 213 | 141 | 121 | 83 | 1.5 | 0.82 | 2.10 | 1.78 | 1.62 | | | | | 7.15 |
| J95 | 235 | 137 | 120 | 76 | 1.5 | 1.02 | 2.57 | 1.8 | 1.63 | | | | | 7.15 |
| J96 | 235 | 160 | 150 | 92 | 2.0 | 1.46 | 3.26 | 2.48 | 2.25 | | | | | 6.00 |
| J106 | 262 | 160 | 150 | 92 | 2.0 | 1.66 | 3.87 | 2.87 | 2.61 | | | | | 6.00 |
| J116 | 287 | 163 | 154 | 95 | 2.0 | 1.85 | 4.08 | 3.24 | 2.95 | | | | | 6.00 |
| J126 | 313 | 160 | 150 | 92 | 2.0 | 2.03 | 4.34 | 3.44 | 3.13 | | | | | 6.00 |
| J117 | 290 | 191 | 171 | 107 | 2.0 | 2.10 | 5.74 | 4.40 | 4.00 | | | | | 5.25 |
| J127 | 316 | 191 | 171 | 107 | 2.0 | 2.24 | 6.06 | 4.77 | 4.34 | | | | | 5.25 |
| J147 | 367 | 191 | 171 | 107 | 2.0 | 2.49 | 7.34 | 5.46 | 4.96 | | | | | 5.25 |
| J167 | 417 | 191 | 171 | 107 | 2.0 | 2.83 | 8.39 | 6.24 | 5.67 | | | | | 5.25 |
| J148 | 362 | 210 | 203 | 121 | 2.0 | 2.89 | 9.00 | 7.00 | 6.36 | | | | | 4.60 |
| J168 | 413 | 210 | 203 | 121 | 2.0 | 3.40 | 10.32 | 8.00 | 7.26 | | | | | 4.60 |



TYPE G

Columbus DIN 15232



www.go4b.com

FREE Engineering Design Service
Contact 4B

Agricultural Pressed Steel Bucket.

- Supplied complete with standard recessed holes
- Ideal for free flowing materials on medium speed elevators

Cangilón de acero estampado para uso agrícola.

- Se entrega con agujeros abombados
- Ideal para materiales fluidos en elevadores de velocidad media

Pressed Steel / Stainless Steel

Chapa de acero estampada,
sin soldaduras / Inoxidable



AGRICULTURAL

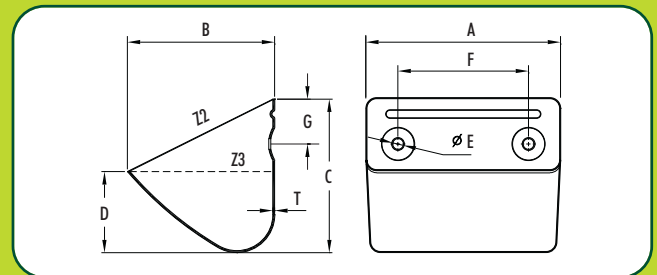

| No. | A* (mm) | B* (mm) | C* (mm) | D* (mm) | T (mm) | kg | Capacity (Litres) Capacidad (Litros) | | Recessed Holes Agujeros Embutidos | | | |
|---------------------------------------|------------|------------|------------|------------|-----------|------|---|---------------|--------------------------------------|-------------|-----------|-----------|
| | | | | | | | Z2 (total) | Z3 (water) | No. | E (Ø mm) | F (mm) | G (mm) |
| STANDARD RANGE / GAMA STANDARD | | | | | | | | | | | | |
| G80 | 80 | 75 | 80 | 40 | 1.0 | 0.13 | 0.25 | 0.16 | 2 | 8.0 | 43 | 19 |
| G90 | 90 | 80 | 85 | 45 | 1.0 | 0.16 | 0.33 | 0.22 | 2 | 8.0 | 46 | 19 |
| G100 | 100 | 90 | 91 | 48 | 1.0 | 0.18 | 0.42 | 0.27 | 2 | 8.0 | 58 | 23 |
| G110 | 110 | 95 | 95 | 50 | 1.0 | 0.21 | 0.51 | 0.33 | 2 | 8.0 | 64 | 26 |
| G120 | 120 | 100 | 105 | 55 | 1.0 | 0.25 | 0.70 | 0.41 | 2 | 8.0 | 67 | 29 |
| G130 | 130 | 105 | 110 | 58 | 1.0 | 0.30 | 0.81 | 0.49 | 2 | 8.0 | 78 | 32 |
| G140 | 140 | 115 | 117 | 63 | 1.0 | 0.33 | 1.05 | 0.62 | 2 | 8.0 | 86 | 35 |
| G150 | 150 | 125 | 123 | 66 | 1.0 | 0.36 | 1.21 | 0.75 | 2 | 8.0 | 87 | 33 |
| G160/1.5 | 160 | 125 | 126 | 70 | 1.5 | 0.57 | 1.31 | 0.89 | 2 | 9.5 | 101 | 36 |
| G160/2.0 | 160 | 125 | 126 | 70 | 2.0 | 0.76 | 1.31 | 0.89 | 2 | 9.5 | 101 | 35 |
| G180/1.5 | 180 | 130 | 130 | 76 | 1.5 | 0.67 | 1.62 | 1.04 | 2 | 9.5 | 110 | 39 |
| G180/2.0 | 180 | 130 | 130 | 76 | 2.0 | 0.89 | 1.62 | 1.04 | 2 | 9.5 | 110 | 39 |
| G200/1.5 | 200 | 140 | 145 | 88 | 1.5 | 0.84 | 2.25 | 1.50 | 2 | 9.5 | 131 | 45 |
| G200/2.0 | 200 | 140 | 145 | 88 | 2.0 | 1.12 | 2.25 | 1.50 | 2 | 9.5 | 131 | 45 |
| G225/1.5 | 225 | 145 | 153 | 90 | 1.5 | 1.01 | 2.81 | 1.80 | 3 | 9.5 | 70 | 40 |
| G225/2.0 | 225 | 145 | 153 | 90 | 2.0 | 1.30 | 2.81 | 1.80 | 3 | 9.5 | 70 | 40 |
| G250/1.5 | 250 | 150 | 158 | 92 | 1.5 | 1.13 | 3.15 | 2.07 | 3 | 9.5 | 77 | 45 |
| G250/2.0 | 250 | 150 | 158 | 92 | 2.0 | 1.46 | 3.15 | 2.07 | 3 | 9.5 | 77 | 45 |
| G300/1.5 | 300 | 155 | 160 | 95 | 1.5 | 1.35 | 4.20 | 2.75 | 3 | 9.5 | 104 | 48 |
| G300/2.0 | 300 | 155 | 160 | 95 | 2.0 | 1.74 | 4.20 | 2.75 | 3 | 9.5 | 104 | 48 |
| G350/1.5 | 350 | 180 | 190 | 100 | 1.5 | 1.86 | 6.37 | 4.03 | 4 | 11.0 | 90 | 54 |
| G350/2.0 | 350 | 180 | 190 | 100 | 2.0 | 2.35 | 6.37 | 4.03 | 4 | 11.0 | 90 | 54 |
| G400/2.0 | 400 | 200 | 212 | 112 | 2.0 | 3.00 | 8.17 | 5.32 | 4 | 11.0 | 100 | 80 |
| G400/2.5 | 400 | 200 | 212 | 112 | 2.5 | 3.75 | 8.17 | 5.32 | 4 | 11.0 | 100 | 80 |
| G500 | 500 | 224 | 236 | 125 | 3.0 | 6.00 | 14.50 | 9.50 | 5 | 14.0 | 100 | 90 |
| SPECIAL RANGE / GAMA ESPECIAL | | | | | | | | | | | | |
| GS350-230 | 359 | 232 | 236 | 108 | 2.5 | 3.85 | 9.97 | 5.22 | 4 | 12.0 | 80 | 90 |
| GS350-240 | 359 | 244 | 236 | 125 | 2.5 | 3.91 | 10.25 | 6.80 | 4 | 12.0 | 80 | 90 |
| GS500/1 HDP | 500 | 226 | 247 | 117 | 9.0 | 2.35 | 13.35 | 6.90 | | | | |
| GS500HDP | 500 | 240 | 253 | 117 | 8.5 | 2.44 | 14.58 | 7.98 | | | | |

* Note: Dimensions for G Type measured internally in accordance with DIN Norm.

* Nota: dimensiones interiores según norma DIN.

TYPE H

Continental DIN 15233



www.go4b.com

FREE Engineering Design Service
www.go4b.com

Industrial Pressed Steel Bucket

- Supplied complete with standard recessed holes
- Low front and open profile
- Ideal for handling difficult, sticky industrial materials

Cangilón de acero estampado para uso industrial

- Servido completo con agujeros estándar abombados
- Frente bajo y perfil abierto
- Ideal para llevar materiales pegajosos industriales



Pressed Seamless Steel

Chapa de acero estampada,
sin soldaduras



INDUSTRIAL

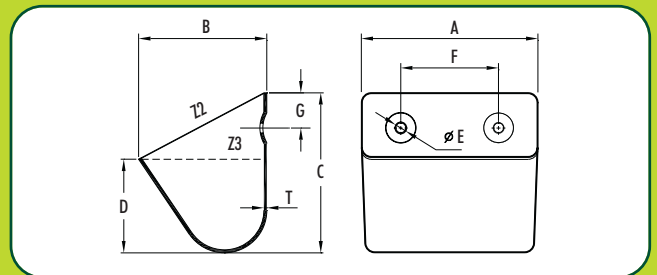

| No. | A* (mm) | B* (mm) | C* (mm) | D* (mm) | T (mm) | Capacity (Litres) Capacidad (Litros) | | | Recessed Holes Agujeros Embutidos | | | |
|-------------------|------------|------------|------------|------------|-----------|---|---------------|---------------|--------------------------------------|-------------|-----------|-----------|
| | | | | | | kg | Z2 (total) | Z3 (Water) | No. | E (Ø mm) | F (mm) | G (mm) |
| H160 | 162 | 140 | 160 | 63 | 2.0 | 0.98 | 1.80 | 0.80 | 2 | 9.5 | 80 | 56 |
| H200 | 200 | 160 | 180 | 71 | 2.0 | 1.30 | 2.84 | 1.29 | 2 | 11.5 | 125 | 63 |
| H250 | 253 | 182 | 200 | 80 | 2.0 | 1.71 | 4.45 | 2.06 | 3 | 11.5 | 80 | 71 |
| H315/2.0 | 315 | 202 | 224 | 90 | 2.0 | 2.40 | 6.50 | 3.20 | 3 | 11.5 | 112 | 80 |
| H315/3.0 | 315 | 202 | 224 | 90 | 3.0 | 3.60 | 6.50 | 3.20 | 3 | 11.5 | 112 | 80 |
| H400/2.0** | 407 | 240 | 275 | 113 | 2.0 | 4.00 | 13.40 | 6.50 | 4 | 11.5 | 100 | 90 |
| H400/3.0** | 407 | 240 | 275 | 113 | 3.0 | 6.00 | 13.40 | 6.50 | 4 | 11.5 | 100 | 90 |

* Note: Dimensions for H Types measured internally in accordance with DIN Norm.
** Not to DIN Norm

* Nota: las dimensiones interiores según norma DIN.
** No son según norma DIN.

How to measure a bucket Como tomar las medidas de su cangilón



With elevator bucket back laid flat, measure overall length (A).
Con la espalda del cangilón plano, medir el largo completo (A).



With elevator bucket back laid flat, measure the horizontal projection of the elevator bucket (B).
Con la espalda del cangilón plano, medir la proyección horizontal (B).



With elevator bucket back laid flat, measure back height (C).
Con la espalda del cangilón plano, medir la profundidad (C).

TYPE A



www.go4b.com

FREE Engineering Design Service
Contact 4B

Shallow Pattern

Pressed Seamless Steel Bucket

- For sticky materials at slow speeds
- For free flowing materials at higher speeds and closer spacing

Diseño poco profundo

Cangilón de acero estampado

- Para materiales pegajosos a bajas velocidades
- Para materiales de caída libre a velocidades más altas y con un espaciado menor



Pressed Seamless Steel



Chapa de acero estampada,
sin soldaduras



AGRICULTURAL

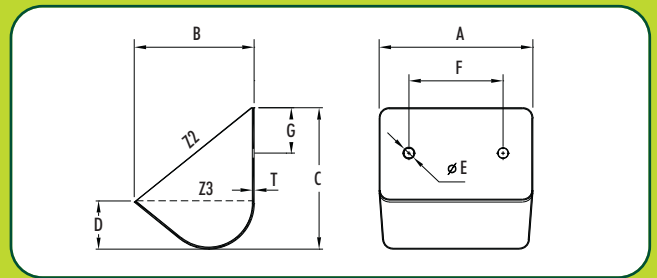

| No. | A (mm) | B (mm) | C (mm) | D (mm) | T (mm) | Capacity (Litres) Capacidad (Litros) | | | Bolt Holes Agujeros | | | |
|------------|--------|--------|--------|--------|--------|---|------------|------------|---|----------|--------|--------|
| | | | | | | kg | Z2 (total) | Z3 (water) | No. | E (Ø mm) | F (mm) | G (mm) |
| A1P | 92 | 57 | 64 | 19 | 0.9 | 0.09 | 0.15 | 0.05 | 2 | 3.5 | 50 | 25 |
| A12 | 127 | 83 | 95 | 32 | 1.5 | 0.31 | 0.49 | 0.20 | To customer specification Según especificaciones del cliente | | | |
| A26 | 127 | 108 | 124 | 38 | 1.2 | 0.32 | 0.84 | 0.29 | | | | |
| A29 | 152 | 108 | 124 | 38 | 1.2 | 0.39 | 0.96 | 0.34 | | | | |
| A32 | 178 | 108 | 124 | 38 | 1.5 | 0.57 | 1.20 | 0.44 | | | | |
| A59 | 229 | 121 | 143 | 48 | 3.0 | 1.70 | 1.88 | 0.75 | | | | |
| A69 | 254 | 149 | 187 | 67 | 3.0 | 2.31 | 3.65 | 1.47 | | | | |
| A72 | 305 | 168 | 229 | 86 | 3.0 | 3.27 | 3.24 | 2.50 | | | | |



(D) With the elevator bucket back held vertical, measure height to front lip (D).
Con la espalda del cangilón vertical, medir la altura hasta el labio frontal (D).



(E) Using a micrometer, measure the thickness of the steel bucket. Use a micrometer or ruler for plastic buckets.
Usando un micrómetro, medir el espesor del cangilón de chapa. Usar una micrómetro o una regla para los cangilones plásticos.

Looking for a replacement elevator bucket?

Send us the bucket measurements and ideally a picture – and we'll find the matching bucket for you.

TYPE B



www.go4b.com

FREE Engineering Design Service
www.go4b.com

Medium Pattern

Pressed Seamless Steel / Stainless Steel / HDP

- Good versatile medium capacity bucket
- For sticky materials at slow speeds
- For free flowing materials at higher speeds and closer spacing

Diseño medio

Acero estampado / Inoxidable / HDP

- Cangilón de media capacidad muy versátil
- Para materiales pegajosos a velocidades lentas
- Para materiales de caída libre a velocidades más altas y con un espaciado menor



Pressed Steel / Stainless Steel / HDP

Chapa de acero estampada,
sin soldaduras / Inoxidable / HDP

AGRICULTURAL & INDUSTRIAL

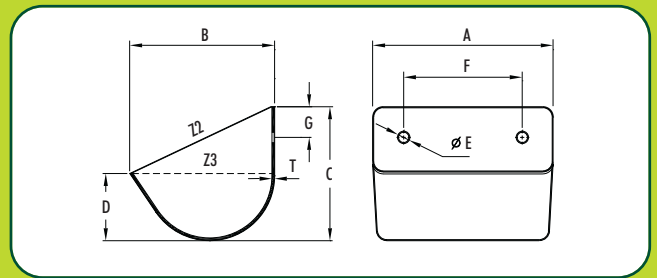

| No. | A (mm) | B (mm) | C (mm) | D (mm) | T (mm) | Capacity (Litres) Capacidad (Litros) | | | Bolt Holes Agujeros | | | | |
|-----------------|--------|--------|--------|--------|--------|---|------------|------------|---|----------|--------|--------|----|
| | | | | | | kg | Z2 (total) | Z3 (water) | No. | E (Ø mm) | F (mm) | G (mm) | |
| B10 | 64 | 51 | 57 | 32 | 1.2 | 00.8 | 0.10 | 0.06 | To customer specification Según especificaciones del cliente | | | | |
| B17 | 76 | 70 | 67 | 35 | 0.9 | 0.10 | 0.18 | 0.10 | | | | | |
| B21 | 95 | 70 | 67 | 35 | 1.2 | 0.14 | 0.22 | 0.13 | | | | | |
| B345 | 76 | 83 | 76 | 35 | 1.2 | 0.14 | 0.24 | 0.13 | | | | | |
| B38 | 102 | 86 | 83 | 35 | 1.2 | 0.18 | 0.38 | 0.20 | | | | | |
| B44 | 127 | 86 | 83 | 35 | 1.2 | 0.23 | 0.46 | 0.23 | | | | | |
| B59 | 114 | 89 | 89 | 38 | 1.2 | 0.23 | 0.46 | 0.23 | | | | | |
| B63 | 127 | 89 | 89 | 38 | 1.2 | 0.27 | 0.55 | 0.30 | | | | | |
| B66 | 140 | 89 | 89 | 38 | 1.2 | 0.29 | 0.62 | 0.32 | | | | | |
| B70 | 152 | 89 | 89 | 38 | 1.2 | 0.32 | 0.64 | 0.34 | | | | | |
| B114 P+R | 152 | 95 | 98 | 38 | 1.5 | 0.41 | 0.75 | 0.42 | 2 | 8.7 | 83 | 25 | |
| B114 | 152 | 95 | 98 | 38 | 1.5 | 0.41 | 0.75 | 0.42 | To customer specification Según especificaciones del cliente | | | | |
| B117 | 152 | 95 | 98 | 38 | 3.0 | 0.79 | 0.75 | 0.42 | | | | | |
| B130 | 203 | 95 | 98 | 38 | 1.5 | 0.50 | 1.06 | 0.55 | To customer specification Según especificaciones del cliente | | | | |
| B130 P+R | 203 | 95 | 998 | 38 | 1.5 | 0.50 | 1.06 | 0.55 | | 2 | 8.7 | 127 | 25 |
| B132 | 203 | 95 | 98 | 38 | 3.0 | 0.98 | 1.06 | 0.55 | To customer specification | | | | |
| B134 HDP | 220 | 106 | 104 | 50 | 4.0 | 0.18 | 1.15 | 0.62 | 2 | 8.7 | 127 | 36 | |
| B134 P+R | 216 | 95 | 98 | 38 | 1.5 | 0.57 | 1.15 | 0.57 | 2 | 8.7 | 127 | 25 | |
| B135 | 229 | 95 | 98 | 38 | 1.5 | 0.59 | 1.25 | 0.60 | - | - | - | - | |
| B135 P+R | 229 | 95 | 98 | 38 | 1.5 | 0.59 | 1.25 | 0.60 | 2 | 8.7 | 127 | 25 | |
| B147 | 152 | 117 | 108 | 54 | 1.5 | 0.52 | 1.10 | 0.59 | To customer specification Según especificaciones del cliente | | | | |
| B149 | 152 | 117 | 108 | 54 | 3.0 | 0.98 | 1.10 | 0.59 | | | | | |
| B151 | 178 | 117 | 108 | 54 | 1.5 | 0.54 | 1.15 | 0.65 | | | | | |
| B153 | 178 | 117 | 108 | 54 | 3.0 | 1.02 | 1.15 | 0.65 | | | | | |
| B155 | 203 | 117 | 108 | 54 | 1.5 | 0.64 | 1.40 | 0.83 | | | | | |
| B157 | 203 | 117 | 108 | 54 | 3.0 | 1.20 | 1.40 | 0.83 | | | | | |
| B166 | 127 | 121 | 114 | 54 | 1.2 | 0.36 | 0.95 | 0.50 | | | | | |
| B167 | 127 | 121 | 114 | 54 | 1.5 | 0.43 | 0.95 | 0.50 | | | | | |
| B167 P+R | 127 | 121 | 114 | 54 | 1.5 | 0.43 | 0.95 | 0.50 | | 2 | 8.7 | 70 | 32 |
| B175 | 152 | 121 | 114 | 54 | 1.5 | 0.54 | 1.10 | 0.64 | | | | | |
| B188 | 191 | 121 | 114 | 54 | 2.0 | 0.77 | 1.40 | 0.83 | To customer specification Según especificaciones del cliente | | | | |
| B198 | 229 | 121 | 114 | 54 | 1.2 | 0.57 | 1.75 | 1.00 | | | | | |
| B200 | 229 | 121 | 114 | 54 | 2.0 | 0.88 | 1.75 | 1.00 | | | | | |
| B201 | 229 | 121 | 114 | 54 | 3.0 | 1.29 | 1.75 | 1.00 | | | | | |
| B205 | 254 | 120 | 114 | 55 | 1.5 | 0.82 | 1.9 | 1.1 | | | | | |

HDP - High Density polyethylene with standard recessed holes.
P + R - With standard recessed hole.

HDP - Polietileno de alta densidad con agujeros embutidos
P + R - Agujeros embutidos

TYPE B



| No. | A (mm) | B (mm) | C (mm) | D (mm) | T (mm) | Capacity (Litres) Capacidad (Litros) | | | Bolt Holes Agujeros | | | | |
|-----------------|-----------|-----------|-----------|-----------|-----------|---|---------------|---------------|---|-------------|-----------|-----------|----|
| | | | | | | kg | Z2 (total) | Z3 (water) | No. | E (Ø mm) | F (mm) | G (mm) | |
| B211 | 178 | 130 | 114 | 54 | 1.5 | 0.59 | 1.45 | 0.80 | To customer specification Según especificaciones del cliente | | | | |
| B219 | 203 | 130 | 114 | 54 | 1.5 | 0.64 | 1.65 | 0.92 | | | | | |
| B221 | 203 | 130 | 114 | 54 | 3.0 | 1.29 | 1.65 | 0.92 | | | | | |
| B234 | 241 | 130 | 114 | 54 | 3.0 | 1.56 | 2.00 | 1.15 | | | | | |
| B237 | 254 | 130 | 114 | 54 | 2.0 | 1.09 | 2.10 | 1.25 | | | | | |
| B238 | 254 | 130 | 114 | 54 | 3.0 | 1.54 | 2.10 | 1.25 | | | | | |
| B242 | 279 | 130 | 114 | 54 | 3.0 | 1.72 | 2.35 | 1.35 | | | | | |
| B258 | 203 | 133 | 127 | 54 | 1.5 | 0.79 | 1.85 | 0.90 | | | | | |
| B263 | 229 | 133 | 127 | 54 | 1.5 | 0.86 | 2.00 | 1.00 | | | | | |
| B266 | 229 | 133 | 127 | 54 | 3.0 | 1.56 | 2.00 | 1.00 | | | | | |
| B269 | 254 | 133 | 127 | 54 | 2.0 | 1.13 | 2.25 | 1.15 | | | | | |
| B278 | 305 | 133 | 127 | 54 | 1.5 | 1.00 | 2.80 | 1.35 | | | | | |
| B281 | 305 | 133 | 127 | 54 | 3.0 | 2.00 | 2.80 | 1.35 | | | | | |
| B283* | 333 | 140 | 140 | 60 | 1.5 | 1.18 | 3.75 | 2.00 | | | | | |
| B297 | 203 | 152 | 149 | 57 | 3.0 | 1.63 | 2.25 | 1.00 | | | | | |
| B301 | 254 | 152 | 149 | 57 | 3.0 | 2.00 | 2.75 | 1.40 | | | | | |
| B303 | 305 | 152 | 149 | 57 | 1.5 | 1.18 | 3.50 | 1.75 | | | | | |
| B304 HDP | 298 | 145 | 149 | 48 | 6.5 | 0.47 | 3.00 | 1.18 | | | | | |
| B304 P+R | 305 | 152 | 149 | 57 | 2.0 | 1.56 | 3.50 | 1.75 | | 4 | 8.7 | 51-102-51 | 44 |
| B305 | 305 | 152 | 149 | 57 | 3.0 | 2.31 | 3.5 | 1.75 | | - | - | - | - |
| B307 | 381 | 152 | 152 | 67 | 2.0 | 1.93 | 4.85 | 2.50 | - | - | - | - | |
| B307 P+R | 381 | 152 | 152 | 67 | 2.0 | 1.93 | 4.85 | 2.50 | 4 | 8.7 | 76-127-76 | - | |
| B364 | 254 | 152 | 178 | 83 | 2.0 | 1.54 | 3.60 | 2.00 | - | - | - | - | |
| B365 | 254 | 152 | 178 | 83 | 3.0 | 2.27 | 3.60 | 2.00 | To customer specification Según especificaciones del cliente | | | | |
| B323 | 305 | 178 | 181 | 79 | 3.0 | 2.83 | 5.50 | 2.75 | | | | | |
| B328 | 356 | 178 | 181 | 79 | 3.0 | 3.52 | 6.52 | 3.25 | | | | | |
| B335 | 305 | 178 | 206 | 79 | 3.0 | 3.02 | 5.75 | 2.50 | | | | | |
| B339 | 381 | 210 | 184 | 86 | 3.0 | 4.08 | 8.00 | 4.25 | | | | | |
| B340 | 457 | 235 | 210 | 102 | 3.0 | 5.08 | 13.00 | 7.00 | | | | | |
| B341 | 457 | 235 | 210 | 102 | 4.7 | 6.26 | 13.00 | 7.00 | | | | | |

* Non stock item - Only made to order.
HDP - High density polyethylene with standard recessed holes.
P + R - With standard recessed holes.

* Hecho bajo pedido.
HDP - Polietileno de alta densidad con agujeros embutidos.
P + R - Agujeros embutidos.

TYPE C

Medium Deep Pattern Diseño medio profundo



www.go4b.com

FREE Engineering Design Service
Contact 4B

Pressed Seamless Steel

- For free flowing materials
- For other materials at slower speeds

Acero estampado

- Para materiales de caída libre
- Para otros materiales a velocidades más lentas

Pressed Seamless Steel

Chapa de acero estampada,
sin soldaduras

AGRICULTURAL & INDUSTRIAL

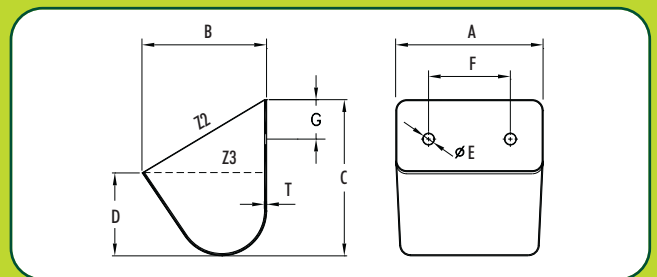

| No. | A (mm) | B (mm) | C (mm) | D (mm) | T (mm) | Capacity (Litres) Capacidad (Litros) | | | Bolt Holes Agujeros | | | |
|-------------|--------|--------|--------|--------|--------|---|------------|------------|---|----------|--------|--------|
| | | | | | | kg | Z2 (total) | Z3 (water) | No. | E (Ø mm) | F (mm) | G (mm) |
| C8 | 76 | 79 | 92 | 51 | 1.2 | 0.16 | 0.30 | 0.18 | To customer specification Según especificaciones del cliente | | | |
| C240 | 89 | 79 | 92 | 51 | 1.2 | 0.18 | 0.35 | 0.21 | | | | |
| C12 | 102 | 79 | 92 | 51 | 1.2 | 0.20 | 0.40 | 0.24 | | | | |
| C14 | 102 | 79 | 92 | 51 | 2.0 | 0.36 | 0.40 | 0.24 | | | | |
| C16 | 127 | 79 | 92 | 51 | 1.2 | 0.25 | 0.49 | 0.30 | | | | |
| C19 | 127 | 79 | 92 | 51 | 3.0 | 0.50 | 0.49 | 0.30 | | | | |
| C22 | 152 | 79 | 92 | 51 | 1.5 | 0.36 | 0.59 | 0.36 | | | | |
| C22P | 152 | 79 | 92 | 51 | 1.5 | 0.36 | 0.59 | 0.36 | 2 | 7.0 | 54 | 38 |
| C27 | 102 | 89 | 108 | 57 | 2.0 | 0.39 | 0.52 | 0.32 | To customer specification Según especificaciones del cliente | | | |
| C30 | 127 | 89 | 108 | 57 | 1.2 | 0.29 | 0.66 | 0.40 | | | | |
| C33 | 127 | 89 | 108 | 57 | 3.0 | 0.68 | 0.66 | 0.40 | | | | |
| C37 | 152 | 89 | 108 | 57 | 2.0 | 0.53 | 0.78 | 0.50 | | | | |
| C38 | 152 | 89 | 108 | 57 | 3.0 | 0.79 | 0.78 | 0.50 | | | | |
| C42 | 178 | 89 | 108 | 57 | 2.0 | 0.68 | 0.96 | 0.60 | | | | |
| C47 | 203 | 89 | 108 | 57 | 2.0 | 0.70 | 1.10 | 0.68 | | | | |
| C193 | 140 | 95 | 111 | 57 | 1.2 | 0.32 | 0.79 | 0.46 | | | | |
| C98 | 127 | 102 | 127 | 67 | 1.2 | 0.34 | 0.89 | 0.55 | | | | |
| C104 | 152 | 102 | 127 | 67 | 1.5 | 1.02 | 1.10 | 0.66 | | | | |
| C106 | 152 | 102 | 127 | 67 | 3.0 | 1.02 | 1.10 | 0.66 | | | | |
| C108 | 178 | 102 | 127 | 67 | 1.2 | 0.45 | 1.25 | 0.75 | | | | |
| C111 | 178 | 102 | 127 | 67 | 3.0 | 1.13 | 1.25 | 0.75 | | | | |
| C116 | 203 | 102 | 127 | 67 | 3.0 | 1.25 | 1.50 | 0.92 | | | | |
| C119 | 229 | 102 | 127 | 67 | 1.5 | 0.79 | 1.80 | 1.10 | | | | |

TYPE C



| No. | A (mm) | B (mm) | C (mm) | D (mm) | T (mm) | Capacity (Litres) Capacidad (Litros) | | | Bolt Holes Agujeros | | | |
|------|-----------|-----------|-----------|-----------|-----------|---|---------------|---------------|------------------------|-------------|-----------|-----------|
| | | | | | | kg | Z2 (total) | Z3 (water) | No. | E (Ø mm) | F (mm) | G (mm) |
| C123 | 127 | 114 | 143 | 76 | 1.2 | 0.43 | 1.15 | 0.70 | | | | |
| C129 | 152 | 114 | 143 | 76 | 1.5 | 0.61 | 1.35 | 0.85 | | | | |
| C131 | 152 | 114 | 143 | 76 | 3.0 | 1.16 | 1.35 | 0.85 | | | | |
| C135 | 178 | 114 | 143 | 76 | 1.5 | 0.68 | 1.60 | 1.00 | | | | |
| C138 | 178 | 114 | 143 | 76 | 3.0 | 1.34 | 1.60 | 1.00 | | | | |
| C141 | 203 | 114 | 143 | 76 | 1.5 | 0.73 | 1.81 | 1.06 | | | | |
| C144 | 203 | 114 | 143 | 76 | 3.0 | 1.45 | 1.81 | 1.06 | | | | |
| C147 | 229 | 114 | 143 | 76 | 1.5 | 0.84 | 2.10 | 1.30 | | | | |
| C150 | 229 | 114 | 143 | 76 | 3.0 | 1.63 | 2.10 | 1.30 | | | | |
| C154 | 254 | 114 | 143 | 76 | 1.5 | 0.93 | 2.30 | 1.40 | | | | |
| C156 | 254 | 114 | 143 | 76 | 3.0 | 1.81 | 2.30 | 1.40 | | | | |
| C159 | 152 | 140 | 159 | 95 | 2.0 | 1.07 | 1.80 | 1.20 | | | | |
| C162 | 178 | 140 | 159 | 95 | 1.5 | 0.84 | 2.15 | 1.40 | | | | |
| C166 | 203 | 140 | 159 | 95 | 1.5 | 0.95 | 2.45 | 1.65 | | | | |
| C168 | 203 | 140 | 159 | 95 | 3.0 | 1.72 | 2.45 | 1.65 | | | | |
| C170 | 229 | 140 | 159 | 95 | 1.5 | 1.07 | 2.85 | 1.85 | | | | |
| C171 | 229 | 140 | 159 | 95 | 2.0 | 1.36 | 2.85 | 1.85 | | | | |
| C172 | 229 | 140 | 159 | 95 | 3.0 | 1.97 | 2.85 | 1.85 | | | | |
| C175 | 254 | 140 | 159 | 95 | 2.0 | 1.43 | 3.10 | 2.00 | | | | |
| C176 | 254 | 140 | 159 | 95 | 3.0 | 2.04 | 3.10 | 2.00 | | | | |
| C179 | 279 | 140 | 159 | 95 | 1.5 | 1.20 | 3.55 | 2.35 | | | | |
| C181 | 279 | 140 | 159 | 95 | 3.0 | 1.86 | 3.55 | 2.35 | | | | |
| C184 | 305 | 140 | 159 | 95 | 2.0 | 1.77 | 4.05 | 2.70 | | | | |
| C185 | 305 | 140 | 159 | 95 | 3.0 | 2.54 | 4.05 | 2.70 | | | | |
| C213 | 305 | 165 | 206 | 156 | 3.0 | 3.63 | 6.45 | 5.25 | | | | |
| C231 | 356 | 181 | 181 | 117 | 3.0 | 3.61 | 6.55 | 4.70 | | | | |

To customer
specification
Según especificaciones
del cliente

TYPE D



www.go4b.com

FREE Engineering Design Service
www.go4b.com

Deep Pattern

Pressed Seamless Steel Bucket

- For free flowing materials
- For materials elevated at slower speeds with gravity discharge
- Mainly for heavy duty applications

Diseño profundo

Cangilón de acero estampado

- Para materiales de caída libre
- Para materiales elevados a velocidades más lentas y con descarga por gravedad
- Principalmente para aplicaciones pesadas

Pressed Seamless Steel

Chapa de acero estampada,
sin soldaduras



INDUSTRIAL

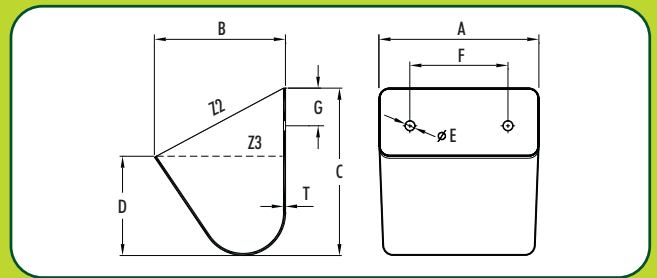

| No. | A (mm) | B (mm) | C (mm) | D (mm) | T (mm) | Capacity (Litres) Capacidad (Litros) | | | Bolt Holes Agujeros | | |
|------|--------|--------|--------|--------|--------|---|------------|------------|---|----------|--------|
| | | | | | | kg | Z2 (total) | Z3 (water) | No. | E (Ø mm) | F (mm) |
| D8 | 152 | 102 | 130 | 79 | 2.0 | 0.68 | 1.15 | 0.75 | To customer specification Según especificaciones del cliente | | |
| D18 | 178 | 114 | 152 | 92 | 3.0 | 1.50 | 1.70 | 1.15 | | | |
| D21 | 203 | 127 | 146 | 86 | 3.0 | 1.50 | 2.10 | 1.35 | | | |
| D55 | 229 | 152 | 200 | 111 | 3.0 | 2.59 | 3.95 | 2.40 | | | |
| D58 | 254 | 152 | 200 | 111 | 2.0 | 1.84 | 4.40 | 2.65 | | | |
| D61 | 254 | 152 | 200 | 111 | 3.0 | 2.59 | 4.40 | 2.65 | | | |
| D64 | 279 | 152 | 200 | 111 | 3.0 | 2.77 | 4.85 | 3.00 | | | |
| D66 | 305 | 152 | 200 | 111 | 1.5 | 1.54 | 5.20 | 3.20 | | | |
| D69 | 305 | 152 | 200 | 111 | 3.0 | 3.02 | 5.20 | 3.20 | | | |
| D70 | 305 | 152 | 200 | 111 | 4.7 | 4.74 | 5.20 | 3.20 | | | |
| D86 | 305 | 171 | 225 | 117 | 3.0 | 3.36 | 6.40 | 3.70 | | | |
| D96 | 356 | 184 | 229 | 108 | 3.0 | 3.99 | 7.80 | 4.35 | | | |
| D106 | 381 | 184 | 229 | 108 | 3.0 | 4.26 | 8.50 | 4.60 | | | |
| D108 | 381 | 184 | 229 | 108 | 4.7 | 6.71 | 8.5 | 4.60 | | | |
| D118 | 457 | 191 | 254 | 133 | 3.0 | 5.76 | 12.20 | 7.65 | | | |
| D120 | 457 | 191 | 254 | 133 | 4.7 | 9.00 | 12.20 | 7.65 | | | |
| D160 | 406 | 197 | 244 | 140 | 3.0 | 5.17 | 10.75 | 7.20 | | | |
| D180 | 406 | 197 | 244 | 140 | 4.7 | 7.89 | 10.75 | 7.20 | | | |
| D123 | 508 | 203 | 273 | 149 | 4.7 | 10.54 | 15.25 | 9.25 | | | |
| D131 | 619 | 210 | 298 | 127 | 3.0 | 7.80 | 20.00 | 9.50 | | | |
| D132 | 619 | 210 | 298 | 127 | 4.7 | 12.61 | 20.00 | 9.50 | | | |
| D181 | 381 | 222 | 254 | 140 | 4.7 | 7.94 | 12.15 | 7.35 | | | |

TYPE F



www.go4b.com

FREE Engineering Design Service
Contact 4B

Angle Back Pattern

Pressed Seamless Steel Bucket

- For free flowing materials only
- For liquid materials elevated at slower speeds with gravity discharge

Diseño de ángulo trasero

Cangilón de acero estampado

- Sólo para materiales de caída libre
- Para materiales líquidos elevados a velocidades más lentas y con descarga por gravedad.

Pressed Seamless Steel

Chapa de acero estampada,
sin soldaduras



INDUSTRIAL

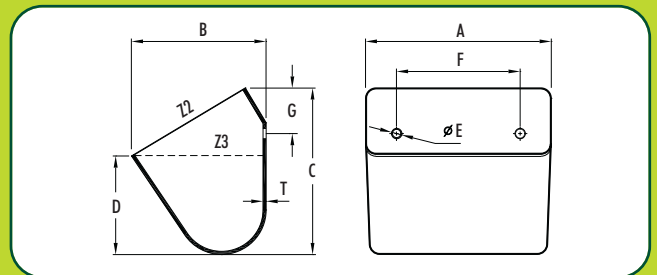

| No. | A (mm) | B (mm) | C (mm) | D (mm) | T (mm) | Capacity (Litres) Capacidad (Litros) | | | Bolt Holes Agujeros | | |
|-------------|-----------|-----------|-----------|-----------|-----------|---|---------------|---------------|---|-------------|-----------|
| | | | | | | kg | Z2 (total) | Z3 (water) | No. | E (Ø mm) | F (mm) |
| F3 | 152 | 114 | 146 | 79 | 1.5 | 0.64 | 1.40 | 0.86 | To customer specification Según especificaciones del cliente | | |
| F9 | 203 | 130 | 171 | 95 | 3.0 | 1.86 | 2.40 | 1.50 | | | |
| F12 | 229 | 133 | 181 | 98 | 2.0 | 1.38 | 3.15 | 1.90 | | | |
| F15 | 254 | 152 | 203 | 114 | 3.0 | 2.63 | 4.80 | 2.60 | | | |
| F34* | 305 | 171 | 229 | 127 | 3.0 | 3.47 | 6.40 | 4.00 | | | |
| F33 | 356 | 171 | 229 | 127 | 3.0 | 4.17 | 8.00 | 5.10 | | | |
| F19 | 381 | 171 | 229 | 127 | 3.0 | 4.67 | 8.50 | 5.30 | | | |
| F25 | 457 | 184 | 254 | 140 | 3.0 | 5.67 | 12.00 | 7.00 | | | |

* Non stock item - Only made to order

* Hecho bajo pedido





www.go4b.com

FREE Engineering Design Service
www.go4b.com

Atlas AA

Heavy Duty Toughened Nylon Buckets. "AA" Style and "Continuous" Style Heavy Duty Injection Moulded Nylon.

- **Solid construction:** manufactured from DuPont 'Zytel' ST super-tough nylon, urethane or high density polyethylene.
- **Solid through and through:** no occlusions within the structure (injection moulded to achieve uniformly high physical properties)
- **Corrosion and abrasion resistant**
- For use in **applications between -50°C and 150°C**
- For applications in: sand, aggregate, cement, coal, sugar, fertilizer, salt, glass
- Also available in food grade HDP or Nylon to meet USDA/FDA standards

Cangilones de nylon endurecidos y resistentes. Tipo "AA" y "Continuous" nylon resistente moldeado e inyectado.

- **Construcción sólida:** Fabricado por DuPont 'Zytel' ST nylon, poliuretano o HDP superduros
- **Completamente sólido:** Sin occlusiones en la estructura (molde inyectado para alcanzar una correcta uniformidad)
- **Resistente a la corrosión y a la abrasión**
- **Para aplicaciones entre -50°C y 150°C**
- Para materiales diversos: arena, agregados, cemento, carbón, azúcar, fertilizantes, sal, vidrio/cristal
- Disponible también en grado alimenticio FDA o en Nylon para cumplir con las normas USDA y FDA

Nylon 'Zytel'

Nylon 'Zytel'



INDUSTRIAL/STICKY

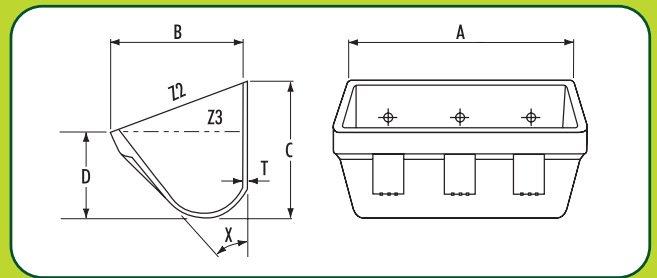

| No. | Nominal Size Medida Nominal (mm) | A (mm) | B (mm) | C (mm) | D (mm) | T (mm) | X° | Capacity (Litres) Capacidad (Litros) | | |
|-----------|--|-----------|-----------|-----------|-----------|-----------|----|---|---------------|---------------|
| | | | | | | | | kg | Z2 (total) | Z3 (water) |
| AA43TN | 110 x 80 | 103 | 78 | 78 | 51 | 5.5 | 37 | 0.09 | 0.27 | 0.21 |
| AA54TN | 130 x 100 | 134 | 105 | 105 | 74 | 7 | 37 | 0.23 | 0.74 | 0.57 |
| AA64TN | 150 x 100 | 160 | 105 | 105 | 74 | 7 | 37 | 0.27 | 0.89 | 0.68 |
| AA74TN | 180 x 100 | 184 | 105 | 105 | 74 | 7 | 37 | 0.30 | 1.07 | 0.84 |
| AA75TN | 180 x 130 | 180 | 130 | 134 | 93 | 8 | 37 | 0.44 | 1.55 | 1.26 |
| AA85TN | 200 x 130 | 206 | 130 | 134 | 93 | 8 | 37 | 0.50 | 1.83 | 1.47 |
| AA95TN | 230 x 130 | 232 | 130 | 134 | 93 | 8 | 37 | 0.54 | 2.00 | 1.66 |
| AA96TN | 230 x 150 | 238 | 156 | 156 | 108 | 8.5 | 37 | 0.67 | 2.80 | 2.17 |
| AA106TN | 250 x 150 | 264 | 156 | 156 | 108 | 8.5 | 37 | 0.73 | 3.14 | 2.43 |
| AA116TN | 280 x 150 | 290 | 156 | 156 | 108 | 8.5 | 37 | 0.77 | 3.43 | 2.68 |
| AA126TN | 300 x 150 | 320 | 165 | 160 | 108 | 8.5 | 38 | 0.95 | 4.10 | 3.08 |
| AA127TN/S | 300 x 180 | 305 | 178 | 178 | 98 | 7 | 37 | 0.92 | 4.10 | 2.95 |
| AA127TN | 300 x 180 | 314 | 180 | 180 | 125 | 9 | 37 | 1.13 | 5.25 | 4.00 |
| AA147TN | 350 x 180 | 365 | 180 | 180 | 125 | 9 | 37 | 1.25 | 6.30 | 4.89 |
| AA148TN | 350 x 200 | 365 | 206 | 206 | 142 | 11 | 37 | 1.94 | 7.60 | 5.76 |
| AA168TN | 400 x 200 | 416 | 206 | 206 | 142 | 12.5 | 37 | 2.10 | 8.85 | 6.66 |
| AA188TN | 450 x 200 | 460 | 206 | 206 | 142 | 12.5 | 37 | 2.38 | 10.15 | 7.66 |
| AA1810TN | 450 x 250 | 460 | 258 | 258 | 168 | 12.5 | 37 | 3.60 | 14.80 | 11.00 |

Mounting holes and venting to customer specification

Agujeros de fijación y venteo según medidas del cliente.

Atlas MF

Industrial Duty Toughened Nylon Buckets.
"Continuous" Style Heavy Duty Injection Moulded Nylon.

- **Solid construction:** manufactured from DuPont 'Zytel' ST super-tough nylon urethane or high density polyethylene.
- **Solid through and through:** no occlusions within the structure
- **Medium front** for use in continuous discharge elevators
- **Corrosion and abrasion resistant**
- For use in applications up to 110°C

Cangilones industriales de Nylon moldeado inyectado extraduro.

- **Construcción sólida:** Hecho de 'Zytel' de DuPont, de poliuretano muy duro o de HDP
- **Larga durabilidad** y sin oclusiones en la estructura
- **Frontal medio** para elevadores de descarga continua
- **Resistente a la abrasión y a la corrosión**
- Puede ser utilizada para aplicaciones hasta 110°C



Nylon 'Zytel'

Nylon 'Zytel'



INDUSTRIAL

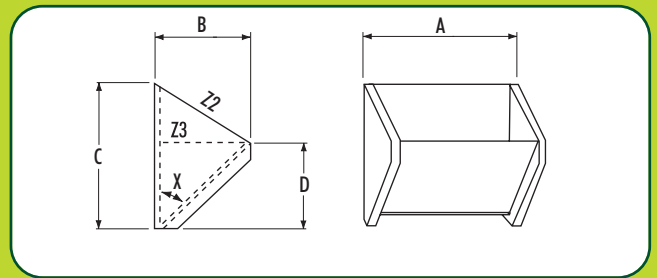

| No. | Nominal Size Medida Nominal (mm) | A (mm) | B (mm) | C (mm) | D (mm) | T (mm) | X° | Capacity (Litres) Capacidad (Litros) | | |
|--------------|--|-----------|-----------|-----------|-----------|-----------|----|---|---------------|---------------|
| | | | | | | | | kg | Z2 (total) | Z3 (water) |
| MF85 | 200 x 130 | 210 | 140 | 190 | 118 | 8 | 50 | 0.88 | 2.04 | 1.22 |
| MF105 | 250 x 130 | 260 | 140 | 190 | 118 | 8 | 50 | 1.07 | 2.50 | 1.55 |
| MF128 | 300 x 200 | 310 | 216 | 300 | 175 | 8 | 50 | 2.17 | 8.01 | 4.77 |
| MF148 | 350 x 200 | 362 | 216 | 300 | 175 | 8 | 50 | 2.36 | 9.01 | 5.51 |
| MF168 | 400 x 200 | 413 | 216 | 300 | 175 | 8 | 50 | 2.61 | 10.55 | 6.42 |
| MF188 | 450 x 200 | 463 | 216 | 300 | 175 | 8 | 50 | 2.85 | 12.10 | 7.24 |

Mounting holes and venting to customer specification.

Agujeros de fijación y venteo según medidas del cliente.





www.go4b.com

FREE Engineering Design Service
Contact 4B

Atlas AD

DIN 15234 'Nyrim' Super Tough Industrial Duty Elevator Bucket High capacity.

- **Solid construction:** manufactured from 'Nyrim', a high-grade nylon/rubber reaction moulding.
- **Maximum impact, corrosion and abrasion resistant**
- **Long bucket life**
- **Suitable for use with elevator belting and chain:** The reduced weight of the bucket enables extended chain life.
- **Ideal for industrial applications,** such as aggregates, cement, gypsum, coal, sand, etc

Cangilón de elevador industrial superduro según DIN 15234 en 'Nyrim' de alta capacidad.

- **Construcción sólida:** Hecho de 'Nyrim', un Nylon de alto grado
- **Resistente al máximo impacto, abrasión y corrosión**
- **Cangilón de larga duración**
- **Utilizable tanto en elevadores a banda como a cadena:** El reducido peso del cangilón alarga la vida de la cadena
- **Ideal para aplicaciones industriales,** como carbón, cemento, yeso, arenas, etc

DIN 15234 in 'Nyrim'

DIN 15234 en 'Nyrim'

INDUSTRIAL/STICKY

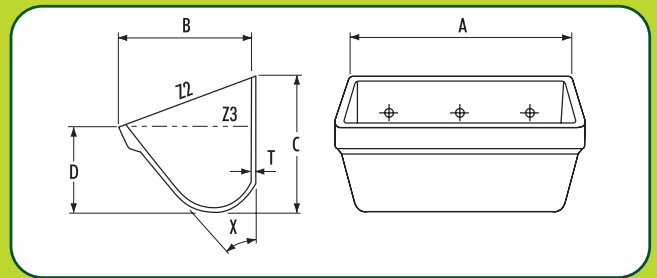

| No. | Nominal Size Medida Nominal (mm) | A (mm) | B (mm) | C (mm) | D (mm) | T (mm) | X° | Capacity (Litres) Capacidad (Litros) | | |
|--------------|--|-----------|-----------|-----------|-----------|-----------|----|---|---------------|---------------|
| | | | | | | | | kg | Z2 (total) | Z3 (water) |
| AD300 | 300 x 200 | 361 | 202 | 215 | 111 | 14 | 43 | 1.70 | 6.75 | 4.135 |
| AD400 | 400 x 224 | 424 | 247 | 286 | 156 | 11 | 39 | 2.75 | 14.33 | 9.00 |
| AD500 | 500 x 250 | 524 | 274 | 321 | 174 | 12 | 39 | 3.80 | 23.20 | 15.00 |
| AD630 | 630 x 280 | 654 | 306 | 363 | 196 | 12 | 39 | 6.80 | 36.00 | 23.40 |

Bolt Holes drilled to customer specification.

Agujeros según medidas del cliente.





www.go4b.com

FREE Engineering Design Service
www.go4b.com

Atlas AM

NEW

Heavy Duty Nyrin Buckets.

- **Antistatic material** with excellent surface resistivity dissipating properties, ideal for ATEX applications
- **Non-stick properties** are enhanced by smooth surface finish and open bucket design
- **Ultra heavy duty design and construction:** material up to 6 times stronger than other industrial plastic buckets
- **Versatile bucket:** suitable for heavy industrial, grain and sticky material applications

Cangilones de Nyrin para tareas pesadas.

- **Material antiestático** con una excelente resistencia en la superficie con propiedades disipativas, ideal para aplicaciones ATEX.
- **Las propiedades antipegajosas** se han mejorado gracias a su superficie de acabado suave y fino y un diseño de cangilón abierto.
- **Construcción y diseño para las tareas más duras,** material hasta 6 veces más fuerte que otros cangilones de plástico industriales.
- **Cangilón versátil,** adecuado para industria pesada, granos y aplicaciones con materiales pegajosos.



Nyrin



Nyrin



AGRICULTURAL & INDUSTRIAL

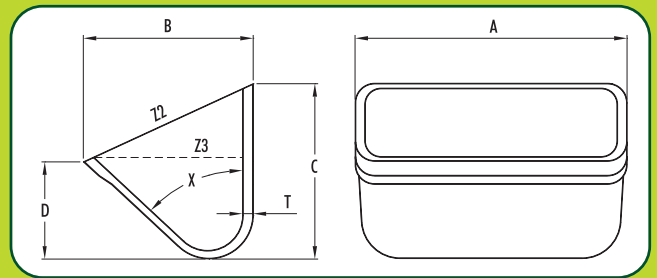

| No. | A (mm) | B (mm) | C (mm) | D (mm) | T (mm) | X° | Capacity (Litres) Capacidad (Litros) | | |
|--------------|--------|--------|--------|--------|--------|----|---|------------|------------|
| | | | | | | | kg | Z2 (total) | Z3 (water) |
| AM320 | 325 | 262 | 270 | 155 | 17 | 47 | 2.9 | 9.4 | 6.4 |
| AM420 | 425 | 262 | 270 | 155 | 17 | 47 | 3.5 | 13.9 | 9.6 |
| AM520 | 525 | 262 | 270 | 155 | 17 | 47 | 4.2 | 16.6 | 11.5 |
| AM620 | 625 | 262 | 270 | 155 | 17 | 47 | 4.9 | 20.0 | 13.8 |

Bolt holes drilled to customer specification.

Agujeros según medidas del cliente.



POLYPENCO



www.go4b.com

**FREE Engineering
Design Service
Contact 4B**

Polypenco 'Nylatron' cast nylon buckets are designed for tough long-life solutions for industrial applications. Polypenco buckets can be used in new installations or in retro-fit situations and are available in 2 styles/ranges: NBA - for use in relatively narrow elevator legs DIN - for elevators designed around DIN NORM 15234

- **Heavy-duty construction** with thick bucket walls.
- **Impact, corrosion and abrasion resistant** for a long working life
- **Non-stick quality** reducing product build-up and reserving maximum elevator capacity
- **Suitable for both chain and bucket or belt and bucket applications**
- **Temperature resistant:** handles products up to max. 110°C

Los cangilones Polypenco "Nylatron" están diseñados para una vida larga y dura para aplicaciones industriales. Los cangilones Polypenco pueden ser usados en nuevas instalaciones o ya existentes y están disponibles en 2 estilos diferenciados:

- **NBA** – para cañas de elevador relativamente estrechas. DIN – para elevadores diseñados según la norma DIN NORM 15234
- **Construcción resistente con paredes gruesas.**
- **Resistente al impacto, corrosión y abrasión** para una larga vida útil.
- **Calidad antiadherente** para reducir la acumulación del producto y mantener al máximo el rendimiento del elevador.
- **Utilizable tanto en elevador a cadena como en banda.**
- **Resistente a la temperatura hasta 110°C.**

NBA & DIN 15234

Impact-wear-corrosion resistant cast Nylatron

NBA & DIN 15234

INDUSTRIAL/STICKY

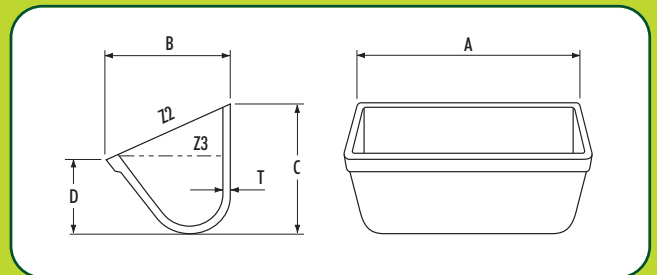

| No. | A (mm) | B (mm) | C (mm) | D (mm) | T (mm) | Kg | Capacity (Litres) Capacidad (Litros) | |
|--------------------|--------|--------|--------|--------|--------|------|---|-------|
| | | | | | | | Z2 | Z3 |
| NBA 8 | 206 | 111 | 127 | 73 | 8 | 0.59 | 1.20 | 0.98 |
| NBA 10 | 254 | 123 | 141 | 82 | 8 | 0.79 | 1.85 | 1.44 |
| NBA 12 | 318 | 167 | 164 | 93 | 8 | 1.13 | 4.50 | 2.70 |
| NBA 14 | 362 | 179 | 190 | 109 | 8 | 1.53 | 6.10 | 4.00 |
| NBA 16 | 413 | 210 | 203 | 113 | 8 | 1.81 | 9.30 | 5.60 |
| NBA 18 | 457 | 198 | 229 | 143 | 8 | 2.50 | 11.10 | 7.50 |
| DIN 200/160 | 224 | 178 | 209 | 109 | 8 | 1.25 | 3.65 | 2.23 |
| DIN 250/180 | 274 | 199 | 233 | 121 | 8 | 1.59 | 5.60 | 3.54 |
| DIN 315/200 | 339 | 219 | 260 | 135 | 8 | 2.38 | 9.90 | 5.39 |
| DIN 400/225 | 426 | 244 | 291 | 153 | 8 | 3.18 | 15.20 | 9.05 |
| DIN 500/250 | 526 | 269 | 328 | 176 | 8 | 4.20 | 23.92 | 14.38 |
| DIN 630/280 | 656 | 301 | 364 | 193 | 8 | 5.44 | 37.20 | 22.70 |

Bolt holes drilled to customer specification.

Agujeros según medidas del cliente.



BUDD AA

Budd Cast Nylon



www.go4b.com

FREE Engineering Design Service
www.go4b.com

Industrial Cast Nylon Bucket
Tough long-life solution for industrial applications.
Proven performance in hot, sticky industrial applications.

- **Construction:** extra thick wear lip and sides
- **Impact, corrosion and abrasion resistant** for a long working life
- **Anti-stick quality** reducing product build-up and preserving maximum elevator capacity
- **Temperature resistant** between -10°C and +150°C

Cangilón de Nylon industrial.
Larga vida para aplicaciones industriales severas. Rendimiento comprobado en aplicaciones con temperatura y pegajosas.

- **Construcción:** Cantos extra anchos
- **Resistente al impacto a la abrasión** y a la corrosión para una larga duración
- **Calidad antiadherente**, reduce el apelmazamiento del producto y mantiene la capacidad del cangilón
- **Rango de aplicación:** entre -10°C y +150°C

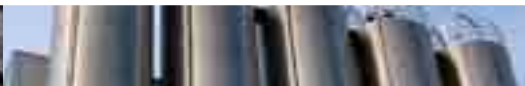

Nylon

Nylon

INDUSTRIAL/STICKY

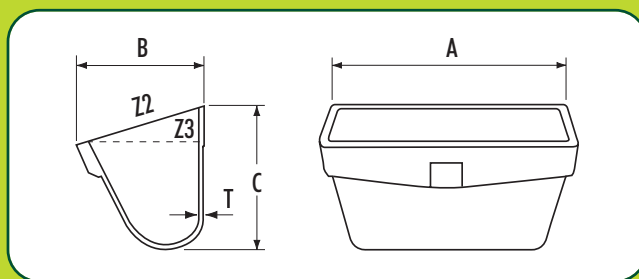

| No. | A (mm) | B (mm) | C (mm) | T (mm) | kg | Capacity (Litres) Capacidad (Litros) | |
|----------------|--------|--------|--------|--------|-------|---|------------|
| | | | | | | Z2 (total) | Z3 (water) |
| BUDD AA064 CN | 164 | 103 | 110 | 4.8 | 0.50 | 0.79 | 0.51 |
| BUDD AA085 CN | 214 | 127 | 140 | 6.4 | 1.16 | 1.62 | 1.05 |
| BUDD AA093 CN | 243 | 84 | 87 | 6.4 | 0.28 | 0.68 | 0.25 |
| BUDD AA106 CN | 268 | 154 | 159 | 7.1 | 1.92 | 2.88 | 1.86 |
| BUDD AA127 CN | 315 | 191 | 186 | 9.5 | 2.79 | 4.42 | 3.21 |
| BUDD AA147 CN | 374 | 193 | 188 | 9.5 | 3.60 | 6.12 | 3.96 |
| BUDD AA148 CN | 369 | 205 | 215 | 9.5 | 4.83 | 7.25 | 4.58 |
| BUDD AA155 CN | 400 | 138 | 145 | 11.1 | 2.20 | 3.43 | 2.29 |
| BUDD AA168 CN | 422 | 204 | 217 | 12.7 | 5.73 | 8.22 | 5.38 |
| BUDD AA188 CN | 451 | 204 | 215 | 12.7 | 5.98 | 8.75 | 5.95 |
| BUDD AA1810 CN | 478 | 259 | 268 | 12.7 | 7.16 | 13.76 | 8.84 |
| BUDD AA195 CN | 505 | 133 | 131 | 11.1 | 2.36 | 3.74 | 2.41 |
| BUDD AA248 CN | 611 | 220 | 220 | 14.2 | 7.16 | 10.23 | 7.31 |
| BUDD AA2413 CN | 610 | 323 | 323 | 19 | 14.65 | 28.32 | 15.52 |



ELEVATOR BOLTS TORNILLOS DE ELEVADOR

Ask for our complete
Bolts catalogue



EURO BOLT DIN 15237

For steel buckets with recessed holes use:
Bolt, hexagon nut and large domed washer.

Para cangilones de acero con agujeros embutidos: tornillo, tuerca autoblocante y arandela cóncava.



EURO BOLT DIN 15237

For steel buckets with plain holes use:
Bolt, hexagon nut, small flat washer.

Para cangilones de acero con agujeros planos: tornillo, tuerca autoblocante y arandela plana pequeña.



EURO BOLT DIN 15237

For plastic buckets you must use: Bolt, hexagon nut and large flat washer.

Para cangilones de plástico: tornillo, tuerca autoblocante y arandela plana de gran diámetro.



4B REF 70



4B LARGE OVAL WASHER



4B FANG



4B EASIFIT

SUPERGRIP BELT FASTENERS GRAPAS PARA ELEVADORES

- Easy to fit modular system of 50mm segments
- 4 versions available for belts up to 1250 kN/m without thickness limitation
- Each assembly comprises 2 half joints, high tensile bolt & self-locking nut
- With standard nylon nuts - max temp. 80° C, for temp. 80° C+ specify Philidas nuts
- Available in stainless steel
- Fácil de instalar, segmentos de 50 mm
- 4 versiones disponibles para bandas de hasta 1250 kN/m sin límite de espesor
- Cada grapa está compuesta de 2 medias grapas, tornillo de alto tensado y tuerca autobloc
- Para tuercas de nylon, temp. máxima: 80° C; para temperaturas de más de 80° C hay que especificar tuercas Philidas
- Disponible en acero inoxidable

See Belt Catalogue
for Steel Web Belt Clamps

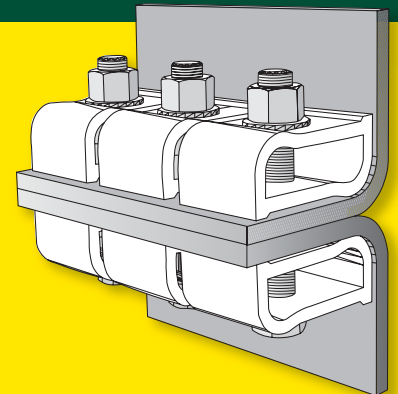

Example of joint using 3 Supergrips on a belt of 150 to 195mm wide.

Ejemplo de una unión utilizando 3 Supergrips en una banda de 150 a 195 mm de ancho.

SPECIFICATIONS / ESPECIFICACIONES

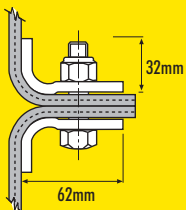

Supergrip No.1

Belt Strength - 500kN/m max.
Fuerza de rotura de la banda

Weight Peso - 0.5Kgs

M14 Bolts

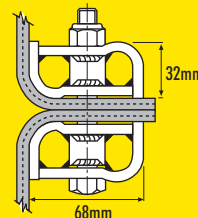

Supergrip No.3

Belt Strength - 1000kN/m max.
Fuerza de rotura de la banda

Weight Peso - 0.85Kgs

M14 Bolts

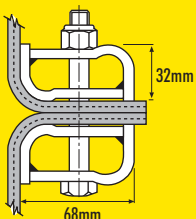

Supergrip No.2

Belt Strength - 800kN/m max.
Fuerza de rotura de la banda

Weight Peso - 0.8Kgs

M14 Bolts

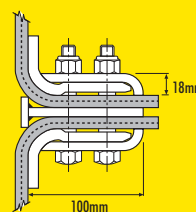

Supergrip No.4

Belt Strength - 1250kN/m max.
Fuerza de rotura de la banda

Weight Peso - 1.83Kgs

M16 Bolts

Bespoke belt clamps available for belts over 1250kN/m. Contact 4B's technical department.

Disponibles grapas de banda hechas a medida para tornillos por encima de 1250Kn/m. Contacte con el departamento técnico de 4B.

ALSO IN THE 4B RANGE



www.go4b.com

Ask for our catalogues



4B ELEVATOR BELTING

- SBR – Low Stretch / Anti Abrasive
- NBR – Low Stretch / Oil Resistant
- FRASOR – ISO 340/284
Flame Retardant / Anti-Static / Oil Resistant
- HOT OIL / Fire Retardant
- FDA – White Food Quality
- T150 – High Heat Belt
- STEEL WEB BELTING



4B CHAINS & SPROCKETS

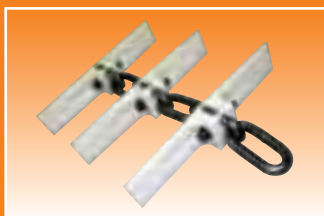

4B HAZARD MONITORS & LEVEL CONTROLS

- Misalignment Monitors
- Speed Switches
- Bearing Temperature Controls
- Level & Choke Switches
- BUS Systems
- Inductive Sensors



IECEX

4B BRAIME ELEVATOR COMPONENTS

Headquarters
Hunslet Road
Leeds LS10 1JZ
UK
Tel: +44 (0) 113 246 1800
Fax: +44 (0) 113 243 5021
Email: 4b-uk@go4b.com

4B SETEM

9 Route de Corbie
80800 Lamotte Warfusée
FRANCE
Tel: +33 (0) 3 22 42 32 26
Fax: +33 (0) 3 22 42 37 33
Email: 4b-france@go4b.com

4B COMPONENTS

729 Sabrina Drive
East Peoria, IL 61611-3578
USA
Tel: 309-698-5611
Fax: 309-698-5615
Email: 4b-usa@go4b.com

4B DEUTSCHLAND

9 Route de Corbie
F-80800 Lamotte Warfusée
FRANCE
Tel: +49 (0) 700 2242 4091
Fax: +49 (0) 700 2242 3733
Email: 4b-deutschland@go4b.com

4B ASIA PACIFIC

12/6 Moo 7, Bang Na Trad,
K.M 17 Bangplee, Samutprakarn 10540
THAILAND
Tel: 00 662 750 9602
Fax: 00 662 750 9601
Email: 4b-asiapacific@go4b.com

4B SUDAMERICA

Paraguay 610, Piso 15,
C1057AAH, Buenos Aires,
ARGENTINA
Tel: (54) 11 4115-6999
Fax: (54) 11 4313-0505
Email: 4b-sudamerica@go4b.com

4B AFRICA

PO Box 1489
Jukskei Park
Johannesburg 2153
SOUTH AFRICA
Tel: +27 (0) 11 708 6114
Fax: +27 (0) 11 708 1654
Email: 4b-africa@go4b.com

4B AUSTRALIA

Unit 3
24 Rodwell Street
Archerfield
Queensland 4108
AUSTRALIA
Tel: +61 (0) 7 3277 4429
Fax: +61 (0) 7 3277 4123
Email: 4b-australia@go4b.com



Please contact us on: +44 (0) 113 246 1800
4b-uk@go4b.com

4B catalogues also available:

- Elevator Belting
- Bolts & Fasteners
- Forged Chains
- Electronics



www.go4b.com